



00241494

STATE OF COLORADO
OIL AND GAS CONSERVATION COMMISSION
DEPARTMENT OF NATURAL RESOURCES

RECEIVED

2

NOV 27 1981

COLO. OIL & GAS CONS. COMM.

APPLICATION
FOR PERMIT TO DRILL, DEEPEN, OR RE-ENTER AND OPERATE

1a. TYPE OF WORK DRILL <input checked="" type="checkbox"/> DEEPEN <input type="checkbox"/> RE-ENTER <input type="checkbox"/>		5. LEASE DESIGNATION AND SERIAL NO.	
b. TYPE OF WELL OIL WELL <input checked="" type="checkbox"/> GAS WELL <input type="checkbox"/> OTHER <input type="checkbox"/> SINGLE ZONE <input checked="" type="checkbox"/> MULTIPLE ZONE <input type="checkbox"/>		6. IF INDIAN, ALLOTTEE OR TRIBE NAME	
2. NAME OF OPERATOR Ladd & Lukowicz, Inc.		7. UNIT AGREEMENT NAME	
3. ADDRESS OF OPERATOR 1600 Broadway, Ste. 1730, Denver, CO 80202		8. FARM OR LEASE NAME Horsefly	
4. LOCATION OF WELL (Report location clearly and in accordance with any State requirements.) At surface 660' FNL 1980' FEL (NW NE) At proposed prod. zone		9. WELL NO. #1-1	
14. DISTANCE IN MILES AND DIRECTION FROM NEAREST TOWN OR POST OFFICE 12 miles north of Benson, Colorado		10. FIELD AND POOL, OR WILDCAT Wildcat	
15. DISTANCE FROM PROPOSED LOCATION TO NEAREST PROPERTY OR LEASE LINE, FT. (Also to nearest drlg. line, if any) 660'		11. SEC., T., R., M., OR BLK. AND SURVEY OR AREA Sec. 1, T9N, R54W	
16. NO. OF ACRES IN LEASE* 240		12. COUNTY Logan	
17. NO. OF ACRES AND/OR DRILLING UNIT ASSIGNED TO THIS WELL 160		13. STATE Colorado	
18. DISTANCE FROM PROPOSED LOCATION TO NEAREST WELL, DRILLING, COMPLETED, OR APPLIED FOR, ON THIS LEASE, FT. None		20. ROTARY OR CABLE TOOLS Rotary	
19. PROPOSED DEPTH 5200'		22. APPROX. DATE WORK WILL START 12-1-81	
21. ELEVATIONS (Show whether DF, RT, GR, etc.) 4174' GR			

23. PROPOSED CASING AND CEMENTING PROGRAM

SIZE OF HOLE	SIZE OF CASING	WEIGHT PER FOOT	SETTING DEPTH	QUANTITY OF CEMENT
12-1/4"	8-5/8"	24# K-55 ST&C	150' ✓	Surface
7-7/8"	4-1/2"	10.5# K-55 ST&C	5200'	150 sx 50-50 Pozmix w/2% gel 10% salt

24. IS SURFACE OWNER A PARTY TO LEASING AGREEMENT? YES ☐ NO ☒
If NO, surface bond must be on file.

* DESCRIBE LEASE

NE/4, N/2 SE/4

1. Drill 12-1/4" hole & set 8-5/8" surface casing to 150' with good returns.
2. Log BOP checks in daily drill reports & drill 7-7/8" hole to 5200'.
3. Run tests if warranted & run 4-1/2" casing if productive.
4. Run logs, as needed, & perforate & stimulate as needed.

24.

SIGNED

TITLE

Manager of Operations

DATE

11-25-81

(This space for Federal or State Office use)

PERMIT NO.

812143

APPROVAL DATE

EXPIRATION DATE

APR 1 1982

APPROVED BY

TITLE

DIRECTOR

O & G Cons. Comm.

DATE

DEC 2 1981

CONDITIONS OF APPROVAL, IF ANY:

A.P.I. NUMBER

05 075 8951



RECEIVED

NOV 27 1981

COLO. OIL & GAS CONS. COMM.

R. 54W

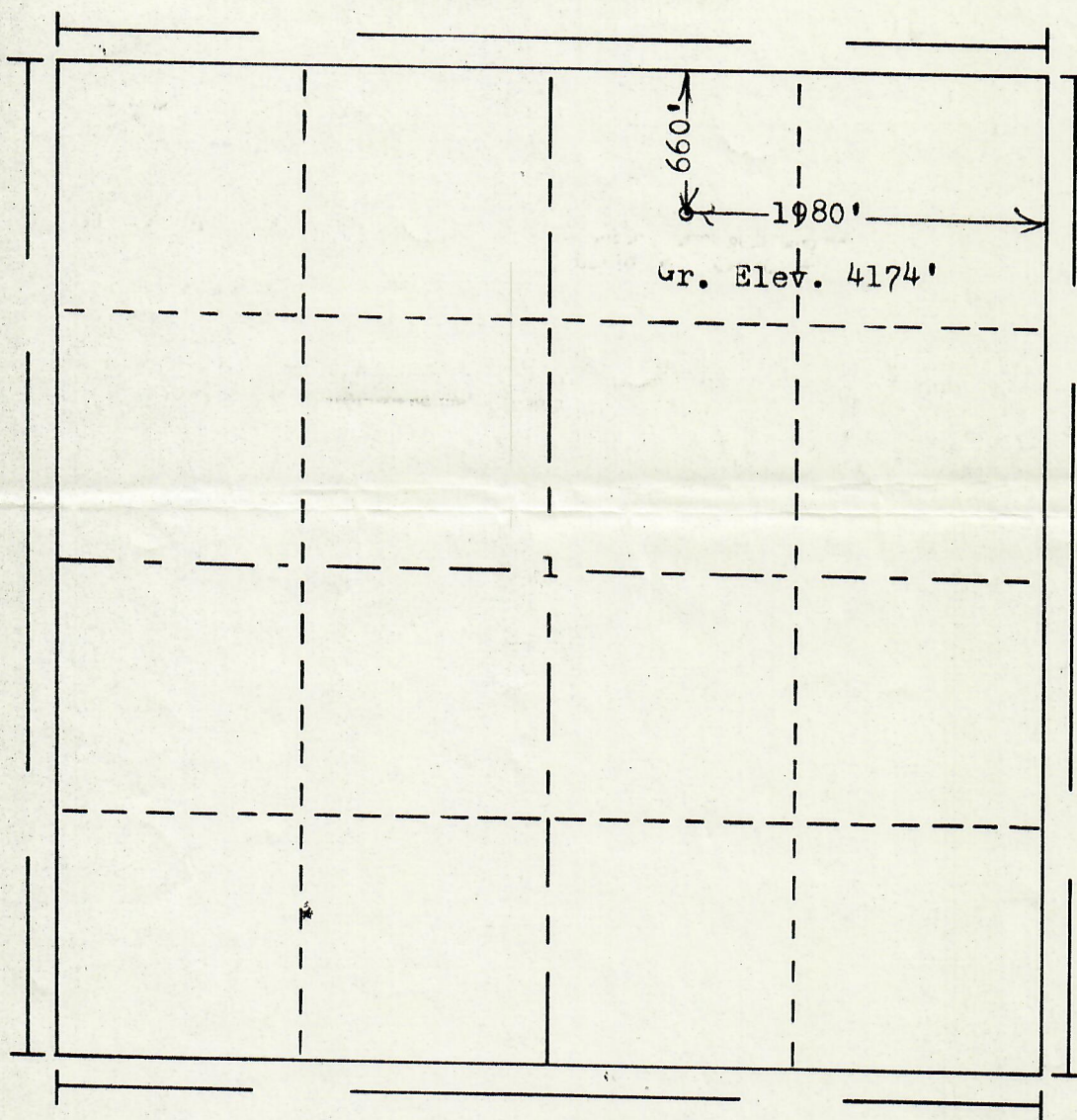
T.
9
N

Scale... 1" = 1000'

Powers Elevation of Denver, Colorado

has in accordance with a request from Mr. Brown
for Ladd & Lukowicz, Inc.

determined the location of No.1-1 Horsefly
to be CNW NE Section 1 Township 9N
Range 54W of the 6th Principal Meridian
Logan County, Colorado

I hereby certify that this plat is an
accurate representation of a correct
survey showing the location of

Date: 10-15-81

Brian D. Homan
Licensed Land Surveyor No. 2853
State of Colorado