



FORM F-106



00254975

RECEIVED
DEC 18 1975 N
COLO. OIL & GAS CONS. COMM.

R. 52W

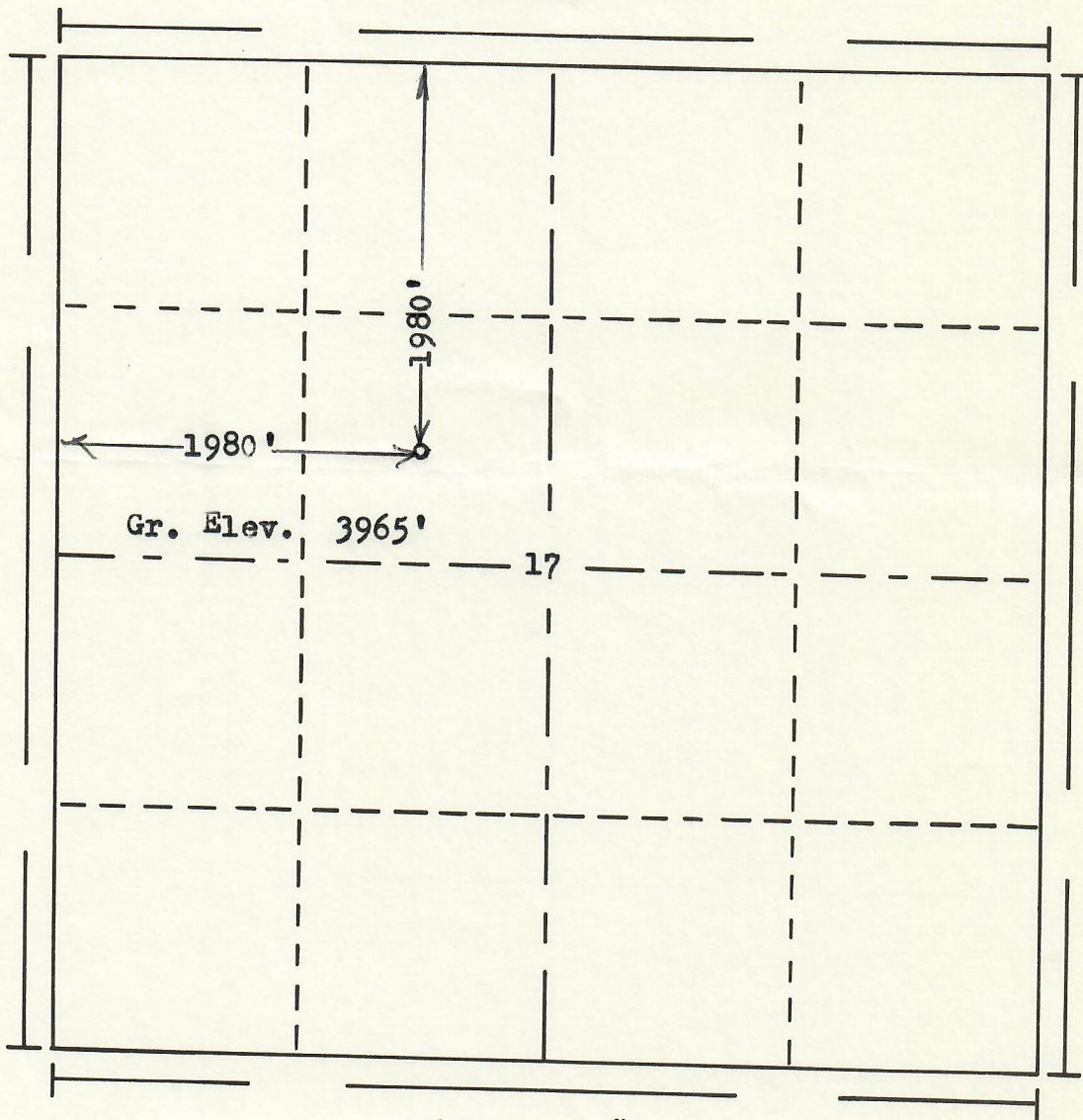

Scale... 1" = 1000'

Powers Elevation Company, Inc. of Denver, Colorado
has in accordance with a request from Michelle
for LeClair-Westwood & Warren Knight
determined the location of No.1 Dickinson-Ramey
to be CSE NW Section 17 Township 9N
Range 52W of the 6th Principal Meridian
Logan County, Colorado

I hereby certify that this plat is an
accurate representation of a correct
survey showing the location of

Date: 12-10-75

Billy G. Hoenes
Licensed Land Surveyor No. 2853
State of Colorado