

BMP LEGEND

- DD DIVERSION DITCH
- ECB EROSION CONTROL BLANKET
- RRC RRB FOR CULVERT PROTECTION
- SB SEDIMENT BASIN
- SCL SEDIMENT CONTROL LOG
- SM SEEDING AND MULCHING
- LOC LIMITS OF CONSTRUCTION
- RRA RIP-RAP APRON

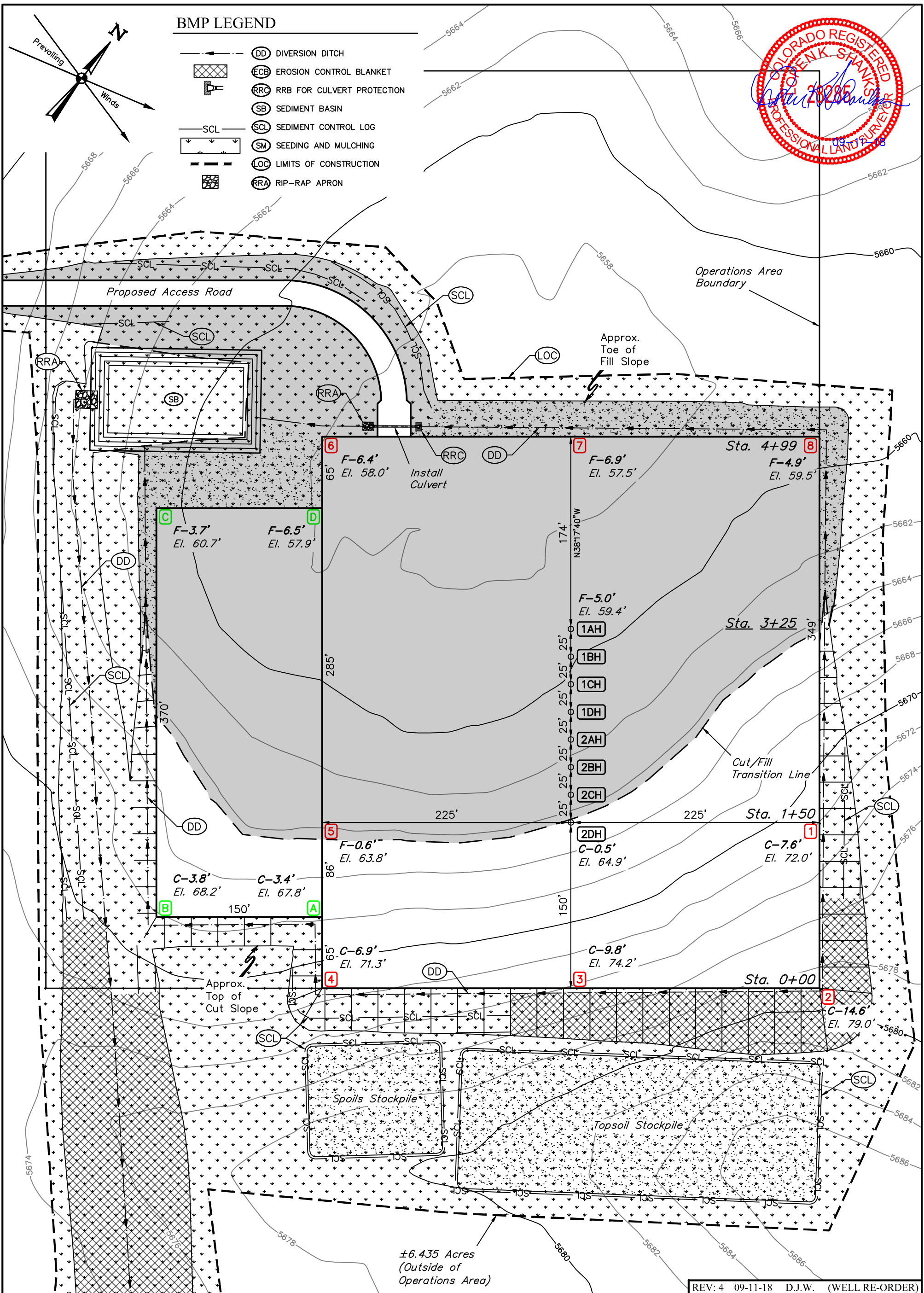

FINISHED GRADE ELEVATION = 5664.4'

NOTE: Earthwork calculations require a fill @ some location stakes for balance. All fill is to be compacted to a minimum of 95% of the maximum dry density obtained by AASHTO method t-99.

NOTES:

- Construct diversion ditches as needed.
- Contours shown at 2' intervals.
- Cut/Fill slopes 3:1 (Typ.)
- This location was not designed by UELS. It has been shown here visually for permitting purposes. For construction or engineering use, please reference the design plans prepared by CVL Engineering.

UELS, LLC
Corporate Office * 85 South 200 East
Vernal, UT 84078 * (435) 789-1017

ConocoPhillips Company

GRANDE #4-65 20-19 1AH, 1BH, 1CH, 1DH, 2AH, 2BH, 2CH & 2DH
NW 1/4 NW 1/4, SECTION 21, T4S, R65W, 6th P.M. ARAPAHOE COUNTY, COLORADO

SURVEYED BY	CHAD MEIERS, O.R.	08-24-18	SCALE
DRAWN BY	K.B.	07-17-17	1" = 80'

CONSTRUCTION LAYOUT **FIGURE #1**

1" = 40'
X-Section
Scale
1" = 100'

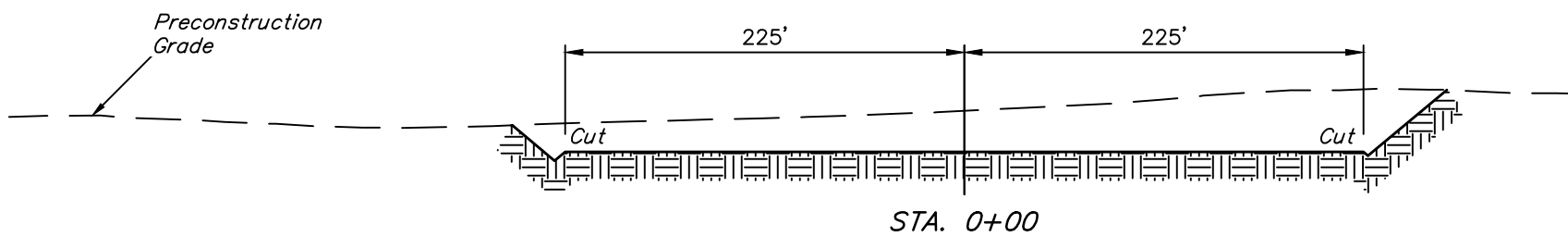
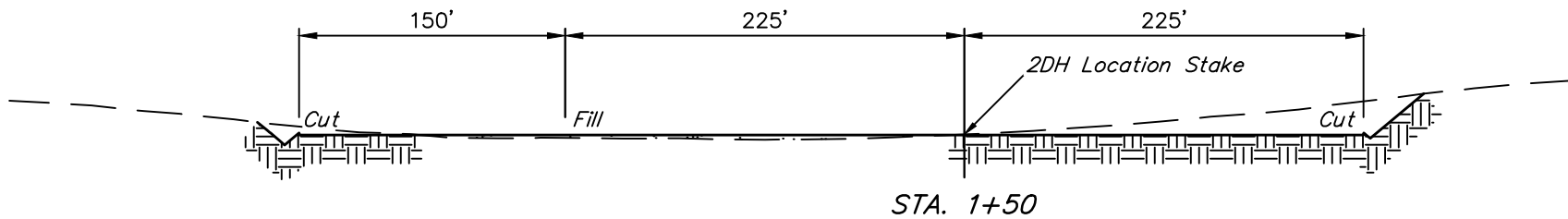
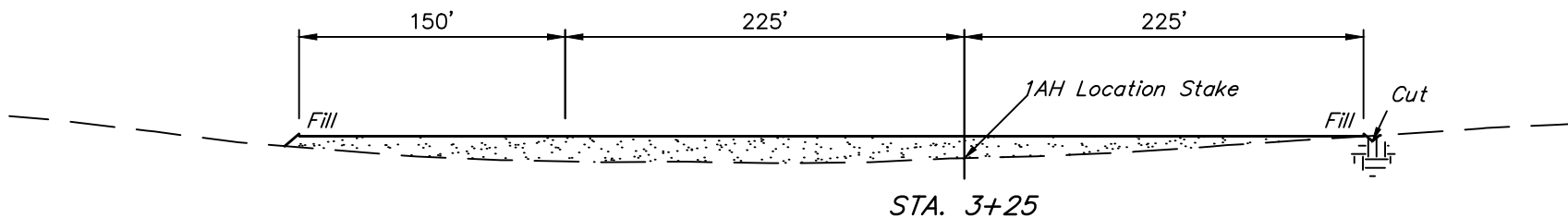
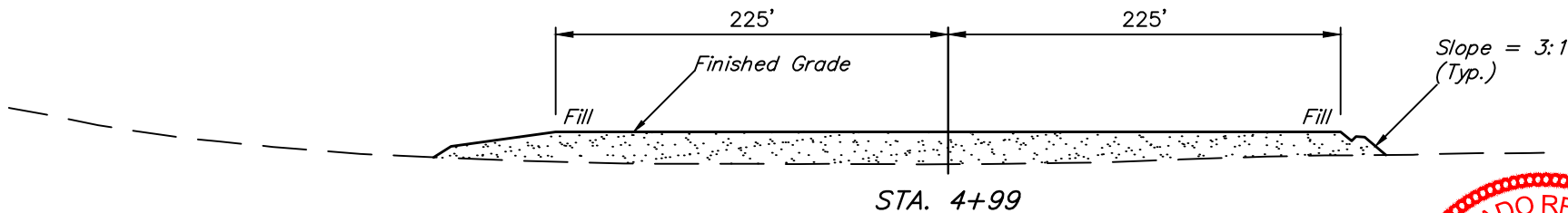

APPROXIMATE EARTHWORK QUANTITIES	
(6") TOPSOIL STRIPPING	9,522 Cu. Yds.
REMAINING LOCATION	45,444 Cu. Yds.
TOTAL CUT	54,966 Cu. Yds.
FILL	43,178 Cu. Yds.
EXCESS MATERIAL	11,788 Cu. Yds.
TOPSOIL	9,522 Cu. Yds.
EXCESS UNBALANCE (After Interim Rehabilitation)	2,266 Cu. Yds.

APPROXIMATE SURFACE DISTURBANCE AREAS		
	DISTANCE	ACRES
WELL SITE DISTURBANCE	NA	±15.42
ACCESS ROAD R-O-W DISTURBANCE	±598'	±0.89
TOTAL SURFACE USE AREA		±16.31

REV: 4 09-11-18 D.J.W. (WELL RE-ORDER)

- NOTES:**
- Fill quantity includes 10% for compaction.
 - Calculations based on 6" of topsoil stripping.
 - Cut/Fill slopes 3:1 (Typ.)



UELS, LLC
Corporate Office * 85 South 200 East
Vernal, UT 84078 * (435) 789-1017

ConocoPhillips Company

**GRANDE #4-65 20-19 1AH, 1BH, 1CH,
1DH, 2AH, 2BH, 2CH & 2DH
NW 1/4 NW 1/4, SECTION 21, T4S, R65W, 6th P.M.
ARAPAHOE COUNTY, COLORADO**

SURVEYED BY	CHAD MEIERS, O.R.	08-24-18	SCALE
DRAWN BY	K.B.	07-17-17	AS SHOWN

CONSTRUCTION LAYOUT CROSS SECTIONS **FIGURE #2**