

REV: 3 08-27-18 J.L.G. (PAD MOVE)

LEGEND:

● PROPOSED LOCATION



UELS, LLC
 Corporate Office * 85 South 200 East
 Vernal, UT 84078 * (435) 789-1017



ConocoPhillips Company

GRANDE #4-65 20-19 1AH, 1BH, 1CH, 1DH,
 2AH, 2BH, 2CH & 2DH
 NW 1/4 NW 1/4, SECTION 21, T4S, R65W, 6th P.M.
 ARAPAHOE COUNTY, COLORADO

SURVEYED BY	C.M., O.R.	08-24-18	SCALE
DRAWN BY	J.B.	07-11-17	1 : 100,000
ACCESS ROAD MAP			TOPO A

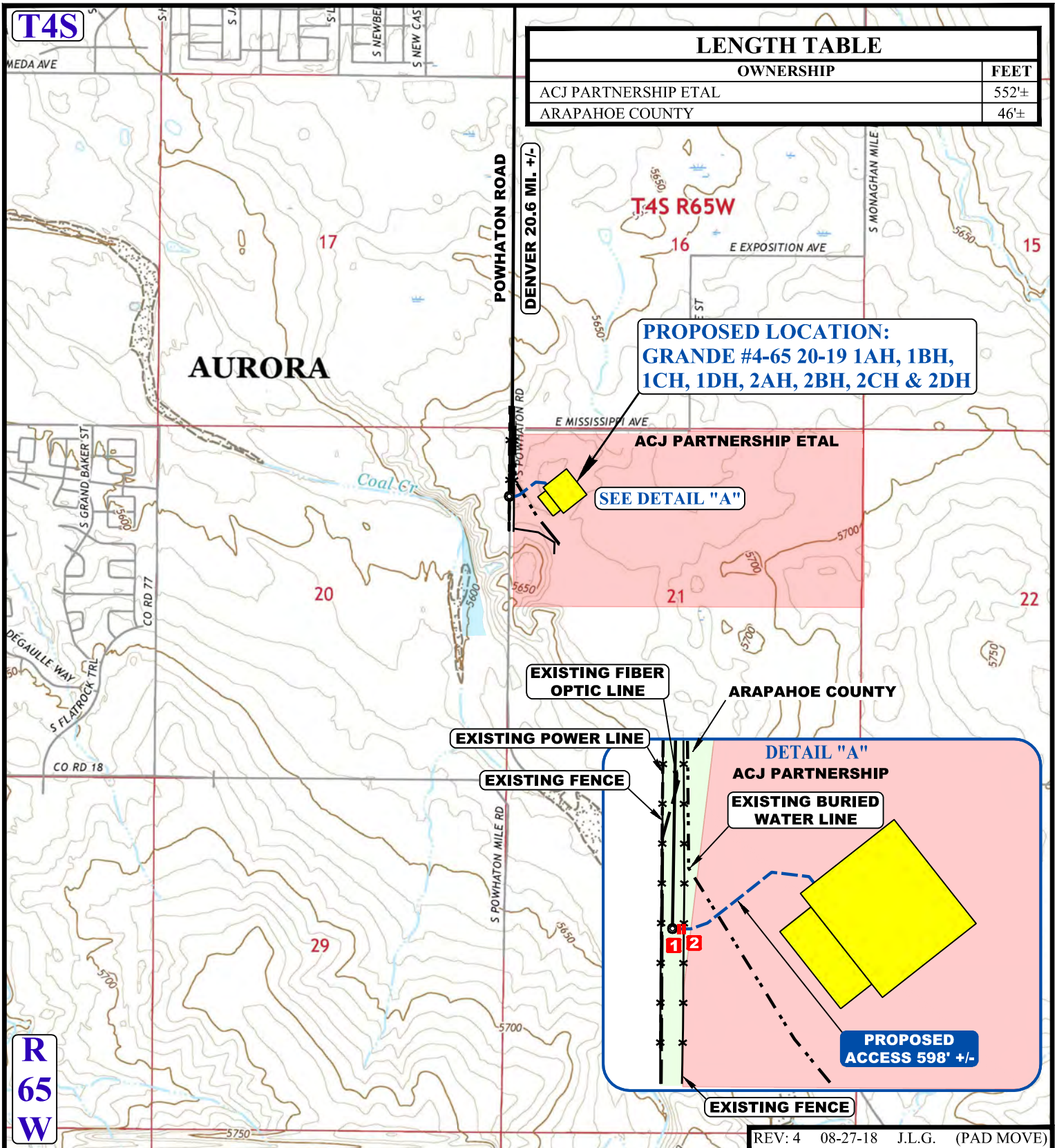

NOTE: PARCEL DATA SHOWN HAS BEEN OBTAINED FROM VARIOUS SOURCES AND SHOULD BE USED FOR MAPPING, GRAPHIC AND PLANNING PURPOSES ONLY. NO WARRANTY IS MADE BY UINTAH ENGINEERING AND LAND SURVEYING (UELS) FOR ACCURACY OF THE PARCEL DATA.

LEGEND:

- EXISTING ROAD
- PROPOSED ROAD
- EXISTING POWER LINE
- EXISTING FIBER OPTICS LINE
- EXISTING BURIED WATER LINE
- EXISTING FENCE

- 1** INSTALL 18" CULVERT
- 2** INSTALL CATTLE GUARD



UELS, LLC
Corporate Office * 85 South 200 East
Vernal, UT 84078 * (435) 789-1017

ConocoPhillips Company

GRANDE #4-65 20-19 1AH, 1BH, 1CH, 1DH,
2AH, 2BH, 2CH & 2DH
NW 1/4 NW 1/4, SECTION 21, T4S, R65W, 6th P.M.
ARAPAHOE COUNTY, COLORADO

SURVEYED BY	C.M., O.R.	08-24-18	SCALE
DRAWN BY	J.B.	07-11-17	1 : 24,000
ACCESS ROAD MAP			TOPO B