



PROJECT DETAILS: Weld County, CO (NAD83)  
Geodetic System: US State Plane 1983  
Datum: North American Datum 1983  
Ellipsoid: GRS 1980  
Zone: Colorado Northern Zone  
System Datum: Mean Sea Level  
Local North: True

WELL DETAILS: RSU Anschutz Fed 4-61-05-4040C

Ground Elevation:: 4501.50  
RKB Elevation: KB @ 4518.00usft (Cade 23)  
Rig Name: Cade 23



Northing	Easting	Latitude	Longitude
1371389.60	3355586.45	40.345844	-104.224231

HighPoint Resources  
Project: Weld County, CO (NAD83)  
Site: Sec 04-T04N-R61W  
Well: RSU Anschutz Fed 4-61-05-4040C  
Wellbore: Wellbore #1  
Plan: Plan #1 (RSU Anschutz Fed 4-61-05-4040C/Wellbore #1)  
Cade 23

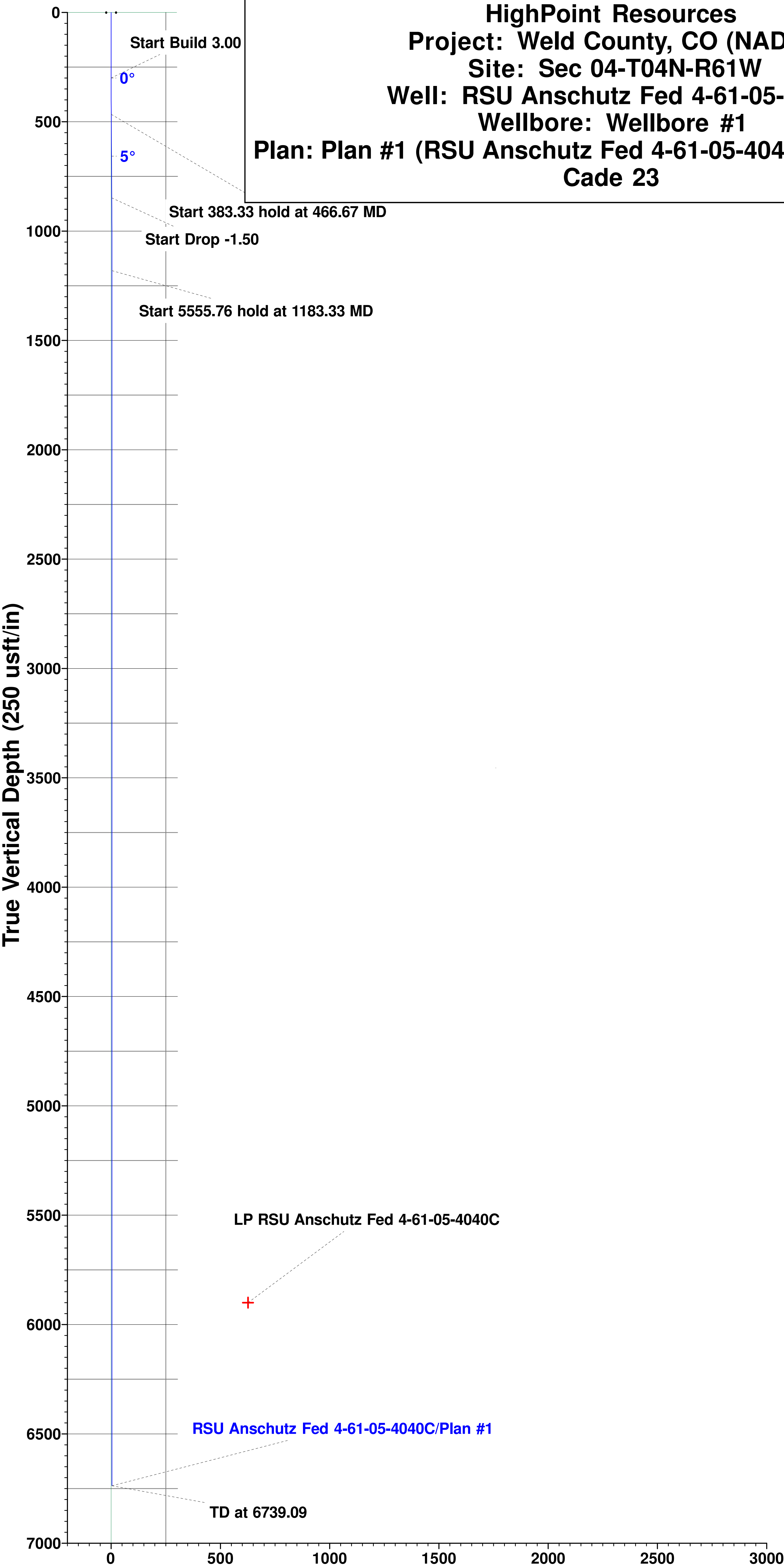

Vertical Section at 269.47° (250 usft/in)

SECTION DETAILS

Sec	MD	Inc	Azi	TVD	+N/-S	+E/-W	Dleg	TFace	VSect	Annotation
1	0.00	0.00	0.00	0.00	0.00	0.00	0.00	0.00	0.00	
2	300.00	0.00	0.00	300.00	0.00	0.00	0.00	0.00	0.00	Start Build 3.00
3	466.67	5.00	183.57	466.46	-7.25	-0.45	3.00	183.57	0.52	Start 383.33 hold at 466.67 MD
4	850.00	5.00	183.57	848.33	-40.60	-2.53	0.00	0.00	2.91	Start Drop -1.50
5	1183.33	0.00	0.00	1181.24	-55.11	-3.44	1.50	180.00	3.95	Start 5555.76 hold at 1183.33 MD
6	6739.09	0.00	0.00	6737.00	-55.11	-3.44	0.00	0.00	3.95	TD at 6739.09

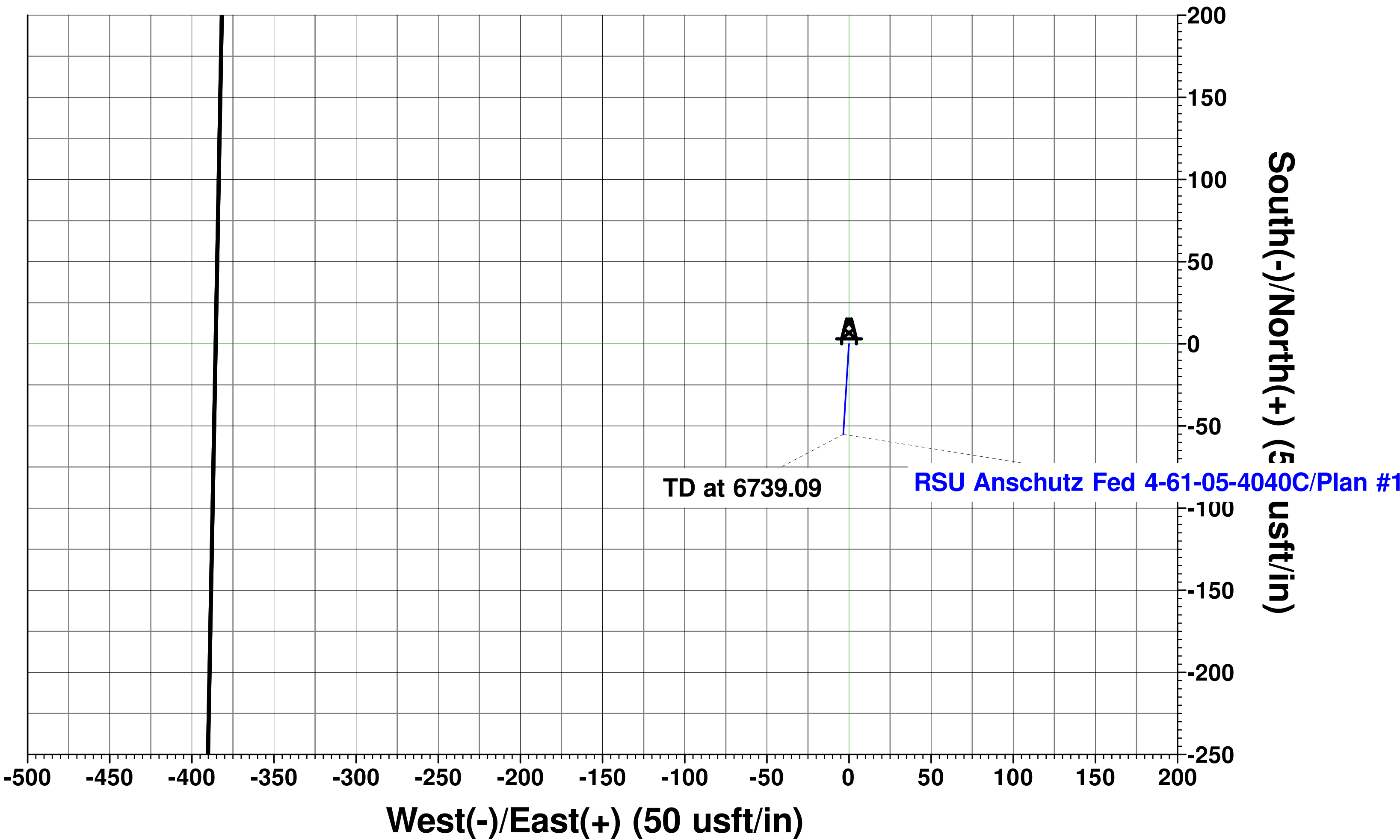

T

↑

⊙

Mazimuths to True North  
Magnetic North: 7.71°

Magnetic Field  
Strength: 52200.7nT  
Dip Angle: 66.84°  
Date: 5/27/2019  
Model: IGRF2015

# **HighPoint Resources**

**Weld County, CO (NAD83)**

**Sec 04-T04N-R61W**

**RSU Anschutz Fed 4-61-05-4040C**

**Wellbore #1**

**Plan: Plan #1**

## **Standard Planning Report**

**29 May, 2019**

## Planning Report

<b>Database:</b>	EDM 5000.15 Single User Db	<b>Local Co-ordinate Reference:</b>	Well RSU Anschutz Fed 4-61-05-4040C
<b>Company:</b>	HighPoint Resources	<b>TVD Reference:</b>	KB @ 4518.00usft (Cade 23)
<b>Project:</b>	Weld County, CO (NAD83)	<b>MD Reference:</b>	KB @ 4518.00usft (Cade 23)
<b>Site:</b>	Sec 04-T04N-R61W	<b>North Reference:</b>	True
<b>Well:</b>	RSU Anschutz Fed 4-61-05-4040C	<b>Survey Calculation Method:</b>	Minimum Curvature
<b>Wellbore:</b>	Wellbore #1		
<b>Design:</b>	Plan #1		

<b>Project</b>	Weld County, CO (NAD83)		
<b>Map System:</b>	US State Plane 1983	<b>System Datum:</b>	Mean Sea Level
<b>Geo Datum:</b>	North American Datum 1983		
<b>Map Zone:</b>	Colorado Northern Zone		

<b>Site</b>	Sec 04-T04N-R61W			
<b>Site Position:</b>		<b>Northing:</b>	1,372,892.85 usft	<b>Latitude:</b> 40.349985
<b>From:</b>	Lat/Long	<b>Easting:</b>	3,355,207.48 usft	<b>Longitude:</b> -104.225513
<b>Position Uncertainty:</b>	0.00 usft	<b>Slot Radius:</b>	13-3/16 "	<b>Grid Convergence:</b> 0.82 °

<b>Well</b>	RSU Anschutz Fed 4-61-05-4040C			
<b>Well Position</b>	<b>+N/-S</b>	-1,508.54 usft	<b>Northing:</b>	1,371,389.60 usft
	<b>+E/-W</b>	357.34 usft	<b>Easting:</b>	3,355,586.45 usft
<b>Position Uncertainty</b>		0.00 usft	<b>Wellhead Elevation:</b>	<b>Latitude:</b> 40.345844
				<b>Longitude:</b> -104.224231
				<b>Ground Level:</b> 4,501.50 usft

<b>Wellbore</b>	Wellbore #1				
<b>Magnetics</b>	<b>Model Name</b>	<b>Sample Date</b>	<b>Declination (°)</b>	<b>Dip Angle (°)</b>	<b>Field Strength (nT)</b>
	IGRF2015	5/27/2019	7.71	66.84	52,200.72466260

<b>Design</b>	Plan #1			
<b>Audit Notes:</b>				
<b>Version:</b>	<b>Phase:</b>	PROTOTYPE	<b>Tie On Depth:</b>	0.00
<b>Vertical Section:</b>	<b>Depth From (TVD) (usft)</b>	<b>+N/-S (usft)</b>	<b>+E/-W (usft)</b>	<b>Direction (°)</b>
	0.00	0.00	0.00	269.47

<b>Plan Survey Tool Program</b>	<b>Date</b>	5/29/2019		
<b>Depth From (usft)</b>	<b>Depth To (usft)</b>	<b>Survey (Wellbore)</b>	<b>Tool Name</b>	<b>Remarks</b>
1	0.00	6,739.09	Plan #1 (Wellbore #1)	MWD
				MWD - Standard

<b>Plan Sections</b>										
<b>Measured Depth (usft)</b>	<b>Inclination (°)</b>	<b>Azimuth (°)</b>	<b>Vertical Depth (usft)</b>	<b>+N/-S (usft)</b>	<b>+E/-W (usft)</b>	<b>Dogleg Rate (°/100usft)</b>	<b>Build Rate (°/100usft)</b>	<b>Turn Rate (°/100usft)</b>	<b>TFO (°)</b>	<b>Target</b>
0.00	0.00	0.00	0.00	0.00	0.00	0.00	0.00	0.00	0.00	
300.00	0.00	0.00	300.00	0.00	0.00	0.00	0.00	0.00	0.00	
466.67	5.00	183.57	466.46	-7.25	-0.45	3.00	3.00	0.00	183.57	
850.00	5.00	183.57	848.33	-40.60	-2.53	0.00	0.00	0.00	0.00	
1,183.33	0.00	0.00	1,181.24	-55.11	-3.44	1.50	-1.50	0.00	180.00	
6,739.09	0.00	0.00	6,737.00	-55.11	-3.44	0.00	0.00	0.00	0.00	

# Planning Report

<b>Database:</b>	EDM 5000.15 Single User Db	<b>Local Co-ordinate Reference:</b>	Well RSU Anschutz Fed 4-61-05-4040C
<b>Company:</b>	HighPoint Resources	<b>TVD Reference:</b>	KB @ 4518.00usft (Cade 23)
<b>Project:</b>	Weld County, CO (NAD83)	<b>MD Reference:</b>	KB @ 4518.00usft (Cade 23)
<b>Site:</b>	Sec 04-T04N-R61W	<b>North Reference:</b>	True
<b>Well:</b>	RSU Anschutz Fed 4-61-05-4040C	<b>Survey Calculation Method:</b>	Minimum Curvature
<b>Wellbore:</b>	Wellbore #1		
<b>Design:</b>	Plan #1		

Planned Survey									
Measured Depth (usft)	Inclination (°)	Azimuth (°)	Vertical Depth (usft)	+N/-S (usft)	+E/-W (usft)	Vertical Section (usft)	Dogleg Rate (°/100usft)	Build Rate (°/100usft)	Turn Rate (°/100usft)
0.00	0.00	0.00	0.00	0.00	0.00	0.00	0.00	0.00	0.00
100.00	0.00	0.00	100.00	0.00	0.00	0.00	0.00	0.00	0.00
200.00	0.00	0.00	200.00	0.00	0.00	0.00	0.00	0.00	0.00
300.00	0.00	0.00	300.00	0.00	0.00	0.00	0.00	0.00	0.00
Start Build 3.00									
400.00	3.00	183.57	399.95	-2.61	-0.16	0.19	3.00	3.00	0.00
466.67	5.00	183.57	466.46	-7.25	-0.45	0.52	3.00	3.00	0.00
Start 383.33 hold at 466.67 MD									
500.00	5.00	183.57	499.66	-10.15	-0.63	0.73	0.00	0.00	0.00
600.00	5.00	183.57	599.28	-18.85	-1.18	1.35	0.00	0.00	0.00
700.00	5.00	183.57	698.90	-27.55	-1.72	1.97	0.00	0.00	0.00
800.00	5.00	183.57	798.52	-36.25	-2.26	2.60	0.00	0.00	0.00
850.00	5.00	183.57	848.33	-40.60	-2.53	2.91	0.00	0.00	0.00
Start Drop -1.50									
900.00	4.25	183.57	898.17	-44.62	-2.78	3.20	1.50	-1.50	0.00
1,000.00	2.75	183.57	997.98	-50.72	-3.16	3.63	1.50	-1.50	0.00
1,100.00	1.25	183.57	1,097.91	-54.20	-3.38	3.88	1.50	-1.50	0.00
1,183.33	0.00	0.00	1,181.24	-55.11	-3.44	3.95	1.50	-1.50	0.00
Start 5555.76 hold at 1183.33 MD									
1,200.00	0.00	0.00	1,197.91	-55.11	-3.44	3.95	0.00	0.00	0.00
1,300.00	0.00	0.00	1,297.91	-55.11	-3.44	3.95	0.00	0.00	0.00
1,400.00	0.00	0.00	1,397.91	-55.11	-3.44	3.95	0.00	0.00	0.00
1,500.00	0.00	0.00	1,497.91	-55.11	-3.44	3.95	0.00	0.00	0.00
1,600.00	0.00	0.00	1,597.91	-55.11	-3.44	3.95	0.00	0.00	0.00
1,700.00	0.00	0.00	1,697.91	-55.11	-3.44	3.95	0.00	0.00	0.00
1,800.00	0.00	0.00	1,797.91	-55.11	-3.44	3.95	0.00	0.00	0.00
1,900.00	0.00	0.00	1,897.91	-55.11	-3.44	3.95	0.00	0.00	0.00
2,000.00	0.00	0.00	1,997.91	-55.11	-3.44	3.95	0.00	0.00	0.00
2,100.00	0.00	0.00	2,097.91	-55.11	-3.44	3.95	0.00	0.00	0.00
2,200.00	0.00	0.00	2,197.91	-55.11	-3.44	3.95	0.00	0.00	0.00
2,300.00	0.00	0.00	2,297.91	-55.11	-3.44	3.95	0.00	0.00	0.00
2,400.00	0.00	0.00	2,397.91	-55.11	-3.44	3.95	0.00	0.00	0.00
2,500.00	0.00	0.00	2,497.91	-55.11	-3.44	3.95	0.00	0.00	0.00
2,600.00	0.00	0.00	2,597.91	-55.11	-3.44	3.95	0.00	0.00	0.00
2,700.00	0.00	0.00	2,697.91	-55.11	-3.44	3.95	0.00	0.00	0.00
2,800.00	0.00	0.00	2,797.91	-55.11	-3.44	3.95	0.00	0.00	0.00
2,900.00	0.00	0.00	2,897.91	-55.11	-3.44	3.95	0.00	0.00	0.00
3,000.00	0.00	0.00	2,997.91	-55.11	-3.44	3.95	0.00	0.00	0.00
3,100.00	0.00	0.00	3,097.91	-55.11	-3.44	3.95	0.00	0.00	0.00
3,200.00	0.00	0.00	3,197.91	-55.11	-3.44	3.95	0.00	0.00	0.00
3,300.00	0.00	0.00	3,297.91	-55.11	-3.44	3.95	0.00	0.00	0.00
3,400.00	0.00	0.00	3,397.91	-55.11	-3.44	3.95	0.00	0.00	0.00
3,500.00	0.00	0.00	3,497.91	-55.11	-3.44	3.95	0.00	0.00	0.00
3,600.00	0.00	0.00	3,597.91	-55.11	-3.44	3.95	0.00	0.00	0.00
3,700.00	0.00	0.00	3,697.91	-55.11	-3.44	3.95	0.00	0.00	0.00
3,800.00	0.00	0.00	3,797.91	-55.11	-3.44	3.95	0.00	0.00	0.00
3,900.00	0.00	0.00	3,897.91	-55.11	-3.44	3.95	0.00	0.00	0.00
4,000.00	0.00	0.00	3,997.91	-55.11	-3.44	3.95	0.00	0.00	0.00
4,100.00	0.00	0.00	4,097.91	-55.11	-3.44	3.95	0.00	0.00	0.00
4,200.00	0.00	0.00	4,197.91	-55.11	-3.44	3.95	0.00	0.00	0.00
4,300.00	0.00	0.00	4,297.91	-55.11	-3.44	3.95	0.00	0.00	0.00
4,400.00	0.00	0.00	4,397.91	-55.11	-3.44	3.95	0.00	0.00	0.00
4,500.00	0.00	0.00	4,497.91	-55.11	-3.44	3.95	0.00	0.00	0.00

## Planning Report

<b>Database:</b>	EDM 5000.15 Single User Db	<b>Local Co-ordinate Reference:</b>	Well RSU Anschutz Fed 4-61-05-4040C
<b>Company:</b>	HighPoint Resources	<b>TVD Reference:</b>	KB @ 4518.00usft (Cade 23)
<b>Project:</b>	Weld County, CO (NAD83)	<b>MD Reference:</b>	KB @ 4518.00usft (Cade 23)
<b>Site:</b>	Sec 04-T04N-R61W	<b>North Reference:</b>	True
<b>Well:</b>	RSU Anschutz Fed 4-61-05-4040C	<b>Survey Calculation Method:</b>	Minimum Curvature
<b>Wellbore:</b>	Wellbore #1		
<b>Design:</b>	Plan #1		

Planned Survey									
Measured Depth (usft)	Inclination (°)	Azimuth (°)	Vertical Depth (usft)	+N/-S (usft)	+E/-W (usft)	Vertical Section (usft)	Dogleg Rate (°/100usft)	Build Rate (°/100usft)	Turn Rate (°/100usft)
4,600.00	0.00	0.00	4,597.91	-55.11	-3.44	3.95	0.00	0.00	0.00
4,700.00	0.00	0.00	4,697.91	-55.11	-3.44	3.95	0.00	0.00	0.00
4,800.00	0.00	0.00	4,797.91	-55.11	-3.44	3.95	0.00	0.00	0.00
4,900.00	0.00	0.00	4,897.91	-55.11	-3.44	3.95	0.00	0.00	0.00
5,000.00	0.00	0.00	4,997.91	-55.11	-3.44	3.95	0.00	0.00	0.00
5,100.00	0.00	0.00	5,097.91	-55.11	-3.44	3.95	0.00	0.00	0.00
5,200.00	0.00	0.00	5,197.91	-55.11	-3.44	3.95	0.00	0.00	0.00
5,300.00	0.00	0.00	5,297.91	-55.11	-3.44	3.95	0.00	0.00	0.00
5,400.00	0.00	0.00	5,397.91	-55.11	-3.44	3.95	0.00	0.00	0.00
5,500.00	0.00	0.00	5,497.91	-55.11	-3.44	3.95	0.00	0.00	0.00
5,600.00	0.00	0.00	5,597.91	-55.11	-3.44	3.95	0.00	0.00	0.00
5,700.00	0.00	0.00	5,697.91	-55.11	-3.44	3.95	0.00	0.00	0.00
5,800.00	0.00	0.00	5,797.91	-55.11	-3.44	3.95	0.00	0.00	0.00
5,900.00	0.00	0.00	5,897.91	-55.11	-3.44	3.95	0.00	0.00	0.00
6,000.00	0.00	0.00	5,997.91	-55.11	-3.44	3.95	0.00	0.00	0.00
6,100.00	0.00	0.00	6,097.91	-55.11	-3.44	3.95	0.00	0.00	0.00
6,200.00	0.00	0.00	6,197.91	-55.11	-3.44	3.95	0.00	0.00	0.00
6,300.00	0.00	0.00	6,297.91	-55.11	-3.44	3.95	0.00	0.00	0.00
6,400.00	0.00	0.00	6,397.91	-55.11	-3.44	3.95	0.00	0.00	0.00
6,500.00	0.00	0.00	6,497.91	-55.11	-3.44	3.95	0.00	0.00	0.00
6,600.00	0.00	0.00	6,597.91	-55.11	-3.44	3.95	0.00	0.00	0.00
6,700.00	0.00	0.00	6,697.91	-55.11	-3.44	3.95	0.00	0.00	0.00
6,739.09	0.00	0.00	6,737.00	-55.11	-3.44	3.95	0.00	0.00	0.00
TD at 6739.09									

Design Targets									
Target Name	Dip Angle (°)	Dip Dir. (°)	TVD (usft)	+N/-S (usft)	+E/-W (usft)	Northing (usft)	Easting (usft)	Latitude	Longitude
LP RSU Anschutz Fed 4	0.00	0.00	5,900.00	-1,475.37	-612.69	1,369,905.57	3,354,995.05	40.341794	-104.226429
- hit/miss target									
- Shape									
- Point									
PBHL RSU Anschutz Fe	0.00	0.00	5,900.00	-1,555.85	-11,320.89	1,369,671.05	3,344,289.12	40.341566	-104.264844
- plan misses target center by 11416.52usft at 5902.09usft MD (5900.00 TVD, -55.11 N, -3.44 E)									
- Point									

Plan Annotations					
Measured Depth (usft)	Vertical Depth (usft)	Local Coordinates			
		+N/-S (usft)	+E/-W (usft)	Comment	
300.00	300.00	0.00	0.00	Start Build 3.00	
466.67	466.46	-7.25	-0.45	Start 383.33 hold at 466.67 MD	
850.00	848.33	-40.60	-2.53	Start Drop -1.50	
1,183.33	1,181.24	-55.11	-3.44	Start 555.76 hold at 1183.33 MD	
6,739.09	6,737.00	-55.11	-3.44	TD at 6739.09	