

SHOVERLER PAD
MULTI-WELL PLAN

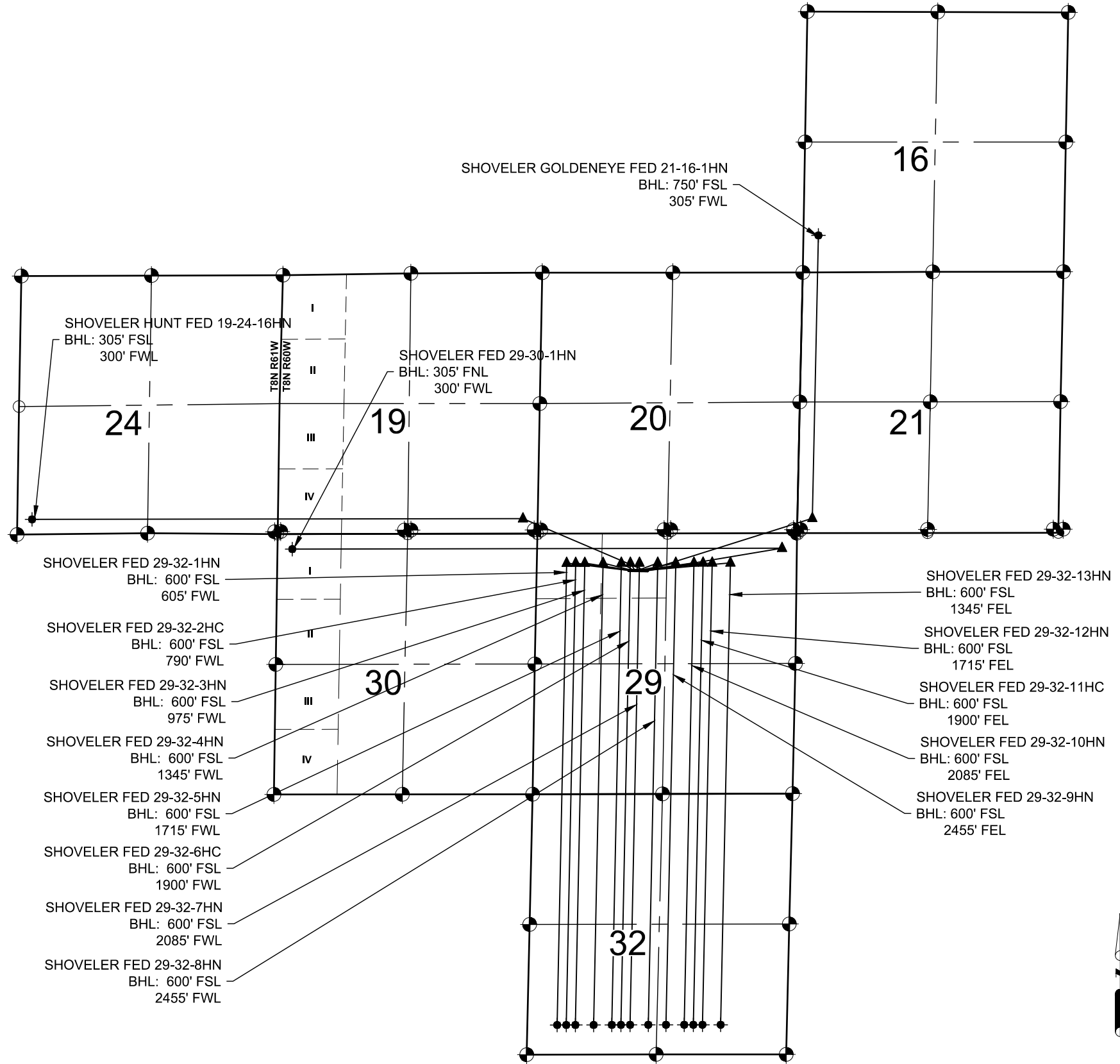

- NOTES:
1. THIS FIELD SURVEY CONFORMS TO THE MINIMUM STANDARDS SET BY THE C.O.G.C.C., RULE NO. 215
 2. BEARINGS ARE BASED ON THE ASSUMPTION THAT THE SOUTH LINE OF THE SOUTHEAST QUARTER OF SECTION 32, BEARS N89°58'47"W BETWEEN THE MONUMENTS SHOWN HEREON.
 3. ALL DISTANCES AND BEARINGS SHOWN HEREON ARE GROUND VALUES AS GPS MEASURED IN THE FIELD, WITH TIES TO WELLS MEASURED PERPENDICULAR TO SECTION LINES. THIS LOW DISTORTION PROJECTION (LDP) IS BASED ON THE NORTH AMERICAN DATUM OF 1983, U.S. SURVEY FOOT WITH A LATITUDE ORIGIN OF 40.655085°N, A CENTRAL MERIDIAN LONGITUDE OF 104.086861°W, AND A SCALE FACTOR ON THE CENTRAL MERIDIAN OF 1.000232 (EXACT). THE LDP BASIS OF BEARINGS IS GEODETIC NORTH.

- NOTES:
- SHOVERLER FED 29-32-1HN TO BE AT 751' FNL & 1872' FWL.
BOTTOM HOLE AT 600' FSL & 605' FWL, SEC. 32.
- SHOVERLER FED 29-32-2HC TO BE AT 751' FNL & 1897' FWL.
BOTTOM HOLE AT 600' FSL & 790' FWL, SEC. 32.
- SHOVERLER FED 29-32-3HN TO BE AT 752' FNL & 1922' FWL.
BOTTOM HOLE AT 600' FSL & 975' FWL, SEC. 32.
- SHOVERLER FED 29-32-4HN TO BE AT 752' FNL & 1947' FWL.
BOTTOM HOLE AT 600' FSL & 1345' FWL, SEC. 32.
- SHOVERLER FED 29-32-5HN TO BE AT 753' FNL & 1972' FWL.
BOTTOM HOLE AT 600' FSL & 1715' FWL, SEC. 32.
- SHOVERLER FED 29-32-6HC TO BE AT 753' FNL & 1997' FWL.
BOTTOM HOLE AT 600' FSL & 1900' FWL, SEC. 32.
- SHOVERLER FED 29-32-7HN TO BE AT 753' FNL & 2022' FWL.
BOTTOM HOLE AT 600' FSL & 2085' FWL, SEC. 32.
- SHOVERLER FED 29-32-8HN TO BE AT 754' FNL & 2047' FWL.
BOTTOM HOLE AT 600' FSL & 2455' FWL, SEC. 32.
- SHOVERLER FED 29-32-9HN TO BE AT 754' FNL & 2072' FWL.
BOTTOM HOLE AT 600' FSL & 2455' FWL, SEC. 32.
- SHOVERLER FED 29-32-10HN TO BE AT 755' FNL & 2097' FWL.
BOTTOM HOLE AT 600' FSL & 2085' FEL, SEC. 32.
- SHOVERLER FED 29-32-11HC TO BE AT 755' FNL & 2122' FWL.
BOTTOM HOLE AT 600' FSL & 1900' FEL, SEC. 32.
- SHOVERLER FED 29-32-12HN TO BE AT 756' FNL & 2147' FWL.
BOTTOM HOLE AT 600' FSL & 1715' FEL, SEC. 32.
- SHOVERLER FED 29-32-13HN TO BE AT 756' FNL & 2172' FWL.
BOTTOM HOLE AT 600' FSL & 1345' FEL, SEC. 32.
- SHOVERLER HUNT FED 19-24-16HN TO BE AT 757' FNL & 2197' FWL.
BOTTOM HOLE A 305' FSL & 300' FWL, SEC. 24, T8N, R61W.
- SHOVERLER GOLENEYE FED 21-16-1HN TO BE AT 757' FNL & 2222' FWL.
BOTTOM HOLE AT 750' FSL & 305' FWL, SEC. 16.
- SHOVERLER FED 29-30-1HN TO BE AT 757' FNL & 2247' FWL.
BOTTOM HOLE AT 305' FNL & 300' FWL, SEC. 30.

LEGEND

- = EXISTING MONUMENT ▲ = LANDING POINT
○ = CALCULATED POSITION ◆ = EXISTING WELL
● = PROPOSED WELL BHL = BOTTOM HOLE
⬮ = BOTTOM HOLE

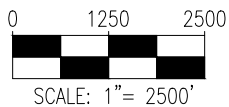

FIELD DATE:
08-10-17

DRAWING DATE:
10-03-19

BY:
IJM

CHECKED:
CSG

WELL NAME:
SHOVERLER PAD

SURFACE LOCATION:
NE 1/4 NW 1/4 SEC. 29, T8N, R60W, 6TH P.M.
WELD COUNTY, COLORADO

PREPARED FOR:

