



# SRC Energy

## Rev 1

# Schlumberger

Borehole:	Well:	Field:	Structure:
Original Hole	Golden Eagle 21C-1-M	CO, Weld County (NAD 83 NZ) - SRC	SRC Energy 06-06N-66W (Golden Eagle 1-6 Pad)

Gravity & Magnetic Parameters					Surface Location				NAD83 Colorado State Plane, Northern Zone, US Feet				Miscellaneous		
Model:	HDGM 2019	Dip:	66.869°	Date:	19-Jun-2019	Lat:	N 40 31 14.20	Northings:	1433235.98ftUS	Grid Conv:	0.4429°	Slot:	Golden Eagle 21C-1-M	TVD Ref:	KB 25ft(4897ft above MSL)
MagDec:	8.138°	FS:	52247.277nT	Gravity FS:	999.046mgn (9.80665 Based)	Lon:	W 104 48 52.59	Easting:	3190546.98ftUS	Scale Fact:	0.99996791	Plan:	Golden Eagle 21C-1-M IFR 0' to 15300' Definitive		

### Final PvA

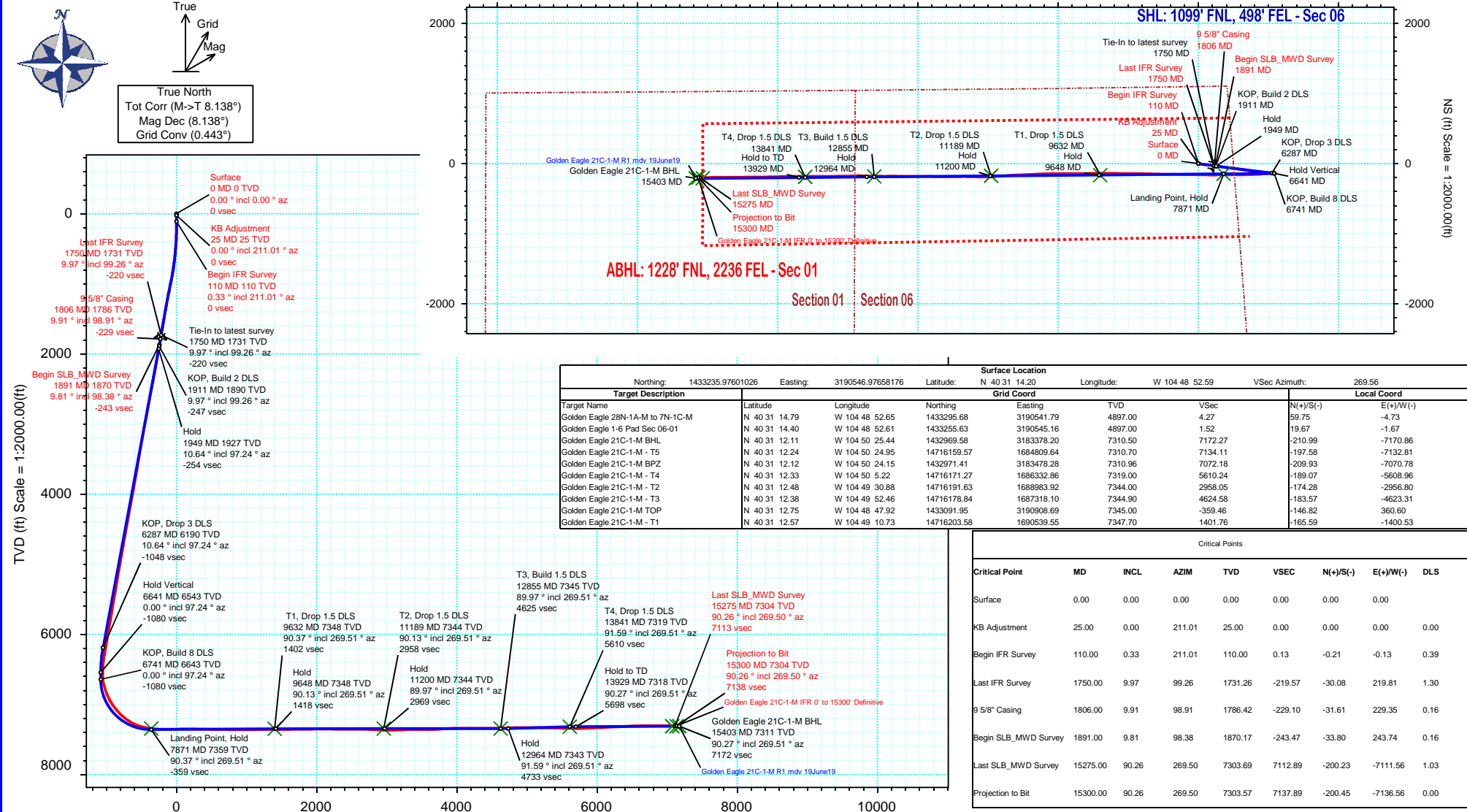

## Golden Eagle 21C-1-M IFR 0' to 15300' Definitive Survey Geodetic Report

## (Def Survey)

**Report Date:** July 18, 2019 - 11:07 AM  
**Client:** SRC Energy  
**Field:** CO, Weld County (NAD 83 NZ) - SRC  
**Structure / Slot:** SRC Energy 06-06N-66W (Golden Eagle 1-6 Pad) / Golden Eagle 21C-1-M  
**Well:** Golden Eagle 21C-1-M  
**Borehole:** Original Hole  
**UWI / API#:** Unknown / 05-123-50126  
**Survey Name:** Golden Eagle 21C-1-M IFR 0' to 15300' Definitive  
**Survey Date:** May 22, 2019  
**Tort / AHD / DDI / ERD Ratio:** 248.210 ° / 9259.971 ft / 6.679 / 1.257  
**Coordinate Reference System:** NAD83 Colorado State Plane, Northern Zone, US Feet  
**Location Lat / Long:** N 40° 31' 14.20320", W 104° 48' 52.59240"  
**Location Grid N/E Y/X:** N 1433235.976 ftUS, E 3190546.977 ftUS  
**CRS Grid Convergence Angle:** 0.4429 °  
**Grid Scale Factor:** 0.99996791  
**Version / Patch:** 2.10.760.0

**Survey / DLS Computation:** Minimum Curvature / Lubinski  
**Vertical Section Azimuth:** 269.560 ° (True North)  
**Vertical Section Origin:** 0.000 ft, 0.000 ft  
**TVD Reference Datum:** KB 25ft  
**TVD Reference Elevation:** 4897.000 ft above MSL  
**Seabed / Ground Elevation:** 4872.000 ft above MSL  
**Magnetic Declination:** 8.138 °  
**Total Gravity Field Strength:** 999.0459mgn (9.80665 Based)  
**Gravity Model:** GARM  
**Total Magnetic Field Strength:** 52247.277 nT  
**Magnetic Dip Angle:** 66.869 °  
**Declination Date:** June 19, 2019  
**Magnetic Declination Model:** HDGM 2019  
**North Reference:** True North  
**Grid Convergence Used:** 0.0000 °  
**Total Corr Mag North→True North:** 8.1380 °  
**Local Coord Referenced To:** Well Head

Comments	MD (ft)	Incl (°)	Azim True (°)	TVD (ft)	VSEC (ft)	NS (ft)	EW (ft)	DLS (°/100ft)	Northing (ftUS)	Easting (ftUS)	Latitude (°)	Longitude (°)
Surface	0.00	0.00	0.00	0.00	0.00	0.00	0.00	N/A	1433235.98	3190546.98	40.520612	-104.814609
KB Adjustment	25.00	0.00	211.01	25.00	0.00	0.00	0.00	0.00	1433235.98	3190546.98	40.520612	-104.814609
Begin IFR Survey	110.00	0.33	211.01	110.00	0.13	-0.21	-0.13	0.39	1433235.77	3190546.85	40.520611	-104.814609
	199.00	0.59	221.47	199.00	0.57	-0.77	-0.56	0.31	1433235.20	3190546.42	40.520610	-104.814611
	289.00	1.52	102.32	288.99	-0.29	-1.37	0.30	2.09	1433234.60	3190547.28	40.520608	-104.814608
	379.00	2.96	93.20	378.92	-3.77	-1.76	3.78	1.64	1433234.25	3190550.77	40.520607	-104.814595
	469.00	4.44	94.71	468.73	-9.56	-2.17	9.58	1.65	1433233.88	3190556.57	40.520606	-104.814575
	559.00	5.52	90.43	558.38	-17.36	-2.49	17.38	1.27	1433233.62	3190564.37	40.520605	-104.814546
	649.00	6.70	102.87	647.88	-26.80	-3.70	26.82	1.96	1433232.49	3190573.83	40.520602	-104.814513
	739.00	8.25	101.87	737.11	-38.21	-6.19	38.26	1.73	1433230.08	3190585.29	40.520595	-104.814471
	829.00	9.44	101.68	826.04	-51.74	-9.02	51.81	1.32	1433227.36	3190598.85	40.520587	-104.814423
	919.00	11.18	98.35	914.58	-67.58	-11.78	67.67	2.04	1433224.72	3190614.74	40.520580	-104.814366
	1009.00	11.78	94.40	1002.78	-85.36	-13.75	85.47	1.10	1433222.89	3190632.54	40.520574	-104.814302
	1099.00	11.45	94.70	1090.94	-103.41	-15.19	103.53	0.37	1433221.59	3190650.62	40.520570	-104.814237
	1189.00	10.90	95.51	1179.23	-120.77	-16.74	120.90	0.64	1433220.18	3190668.00	40.520566	-104.814174
	1279.00	10.73	94.73	1267.63	-137.58	-18.24	137.72	0.25	1433218.80	3190684.83	40.520562	-104.814114
	1369.00	10.01	95.98	1356.16	-153.69	-19.75	153.85	0.84	1433217.42	3190700.97	40.520558	-104.814056
	1459.00	9.96	97.98	1444.80	-169.17	-21.64	169.34	0.39	1433215.64	3190716.47	40.520553	-104.814000
	1549.00	10.35	99.97	1533.39	-184.82	-24.12	185.01	0.58	1433213.28	3190732.16	40.520546	-104.813944
	1639.00	9.94	99.80	1621.98	-200.41	-26.85	200.63	0.46	1433210.68	3190747.80	40.520538	-104.813887
	1729.00	10.24	99.45	1710.59	-215.94	-29.48	216.17	0.34	1433208.17	3190763.36	40.520531	-104.813831
Last IFR Survey	1750.00	9.97	99.26	1731.26	-219.57	-30.08	219.81	1.30	1433207.60	3190767.00	40.520529	-104.813818
9 5/8" Casing	1806.00	9.91	98.91	1786.42	-229.10	-31.61	229.35	0.16	1433206.14	3190776.56	40.520525	-104.813784
Begin												
SLB_MWD	1891.00	9.81	98.38	1870.17	-243.47	-33.80	243.74	0.16	1433204.07	3190790.96	40.520519	-104.813732
Survey												
	1981.00	9.70	99.21	1958.87	-258.52	-36.13	258.81	0.20	1433201.85	3190806.05	40.520513	-104.813678
	2071.00	9.93	97.38	2047.55	-273.68	-38.34	273.99	0.43	1433199.76	3190821.24	40.520507	-104.813624
	2160.00	9.96	96.62	2135.21	-288.92	-40.21	289.24	0.15	1433198.00	3190836.51	40.520502	-104.813569
	2250.00	10.96	97.53	2223.72	-305.12	-42.23	305.46	1.13	1433196.11	3190852.74	40.520496	-104.813510
	2340.00	11.32	98.47	2312.02	-322.32	-44.65	322.67	0.45	1433193.82	3190869.98	40.520489	-104.813448
	2429.00	10.22	96.71	2399.45	-338.79	-46.86	339.16	1.29	1433191.74	3190886.47	40.520483	-104.813389
	2519.00	11.10	101.02	2487.90	-355.20	-49.45	355.59	1.32	1433189.28	3190902.93	40.520476	-104.813330
	2608.00	11.13	99.42	2575.23	-372.06	-52.49	372.47	0.35	1433186.37	3190919.83	40.520468	-104.813269
	2698.00	10.30	96.33	2663.66	-388.61	-54.80	389.04	1.12	1433184.19	3190936.42	40.520462	-104.813210
	2787.00	10.90	97.68	2751.14	-404.84	-56.80	405.29	0.73	1433182.31	3190952.68	40.520456	-104.813151
	2877.00	10.62	97.95	2839.56	-421.47	-59.09	421.93	0.32	1433180.15	3190969.34	40.520450	-104.813091
	2967.00	10.58	98.69	2928.02	-437.83	-61.48	438.32	0.16	1433177.88	3190985.74	40.520443	-104.813032
	3056.00	10.09	99.53	3015.58	-453.58	-64.01	454.08	0.58	1433175.48	3191001.52	40.520436	-104.812976
	3146.00	10.71	98.03	3104.10	-469.61	-66.48	470.14	0.75	1433173.13	3191017.60	40.520430	-104.812918
	3236.00	9.84	95.01	3192.66	-485.54	-68.32	486.08	1.14	1433171.42	3191033.55	40.520424	-104.812861
	3326.00	9.81	96.47	3281.34	-500.81	-69.86	501.36	0.28	1433170.00	3191048.84	40.520420	-104.812806
	3415.00	9.76	94.69	3369.04	-515.85	-71.33	516.41	0.34	1433168.64	3191063.91	40.520416	-104.812752
	3505.00	10.59	97.37	3457.63	-531.64	-73.01	532.22	1.06	1433167.08	3191079.72	40.520412	-104.812695
	3595.00	9.65	99.14	3546.23	-547.27	-75.27	547.87	1.10	1433164.94	3191095.39	40.520405	-104.812638
	3684.00	9.30	98.39	3634.01	-561.73	-77.51	562.34	0.42	1433162.82	3191109.88	40.520399	-104.812586
	3774.00	10.01	96.64	3722.74	-576.68	-79.47	577.31	0.85	1433160.97	3191124.86	40.520394	-104.812533
	3864.00	10.73	99.63	3811.27	-592.69	-81.78	593.34	1.00	1433158.79	3191140.91	40.520388	-104.812475
	3953.00	10.08	95.18	3898.80	-608.60	-83.87	609.26	1.16	1433156.82	3191156.85	40.520382	-104.812418
	4043.00	10.70	100.10	3987.33	-624.65	-86.04	625.33	1.20	1433154.77	3191172.94	40.520376	-104.812360
	4133.00	10.22	99.94	4075.83	-640.72	-88.89	641.42	0.53	1433152.05	3191189.05	40.520368	-104.812302
	4222.00	10.68	97.97	4163.36	-656.65	-91.39	657.37	0.65	1433149.67	3191205.01	40.520361	-104.812245
	4312.00	10.49	97.95	4251.83	-673.00	-93.68	673.74	0.21	1433147.51	3191221.40	40.520355	-104.812186
	4402.00	10.35	97.81	4340.34	-689.11	-95.91	689.87	0.16	1433145.40	3191237.54	40.520349	-104.812128
	4491.00	10.32	98.40	4427.90	-704.90	-98.17	705.67	0.12	1433143.27	3191253.36	40.520343	-104.812071
	4581.00	10.33	97.69	4516.44	-720.85	-100.42	721.64	0.14	1433141.14	3191269.35	40.520336	-104.812013
	4671.00	10.52	97.84	4604.95	-736.97	-102.62	737.78	0.21	1433139.06	3191285.50	40.520330	-104.811955
	4760.00	9.89	96.47	4692.55	-752.60	-104.59	753.42	0.76	1433137.21	3191301.16	40.520325	-104.811899
	4850.00	10.15	96.62	4781.17	-768.14	-106.38	768.98	0.29	1433135.55	3191316.73	40.520320	-104.811843
	4940.00	9.85	95.64	4869.81	-783.67	-108.05	784.52	0.38	1433134.00	3191332.28	40.520315	-104.811787
	5029.00	10.38	98.76	4957.42	-799.15	-110.02	800.02	0.86	1433132.15	3191347.79	40.520310	-104.811731
	5119.00	10.37	96.97	5045.95	-815.19	-112.24	816.07	0.36	1433130.05	3191363.86	40.520304	-104.811674
	5209.00	9.58	94.25	5134.59	-830.68	-113.77	831.58	1.02	1433128.64	3191379.38	40.520300	-104.811618
	5298.00	9.61	96.50	5222.35	-845.44	-115.16	846.35	0.42	1433127.36	3191394.16	40.520296	-104.811565
	5388.00	9.33	95.27	5311.12	-860.16	-116.68	861.08	0.38	1433125.95	3191408.90	40.520292	-104.811512
	5478.00	10.24	96.37	5399.81	-875.36	-118.24	876.29	1.03	1433124.51	3191424.13	40.520287	-104.811457
	5567.00	10.16	96.80	5487.40	-891.00	-120.05	891.95	0.12	1433122.83	3191439.80	40.520282	-104.811401
	5657.00	9.14	93.35	5576.13	-906.01	-121.41	906.97	1.30	1433121.59	3191454.82	40.520279	-104.811347
	5746.00	9.48	95.07	5663.96	-920.36	-122.47	921.32	0.49	1433120.64	3191469.19	40.520276	-104.811295
	5835.00	9.85	94.46	5751.69	-935.24	-123.71	936.22	0.43	1433119.51	3191484.09	40.520272	-104.811242
	5924.00	10.18	96.41	5839.34	-950.63	-125.18	951.62	0.53	1433118.16	3191499.50	40.520268	-104.811186
	6014.00	10.03	94.74	5927.94	-966.33	-126.71	967.33	0.37	1433116.75	3191515.23	40.520264	-104.811130
	6103.00	9.63	94.17	6015.63	-981.47	-127.89	982.48	0.46	1433115.68	3191530.39	40.520261	-104.811075
	6193.00	9.12	96.36	6104.43	-996.06	-129.23	997.08	0.69	1433114.46	3191544.99	40.520257	-104.811023
	6283.00	9.97	95.17	6193.19	-1010.89	-130.72	1011.93	0.97	1433113.08	3191559.85	40.520253	-104.810969
	6372.00	10.33	96.26	6280.79	-1026.49	-132.29	1027.53	0.46	1433111.64	3191575.47	40.520249	-104.8

Comments	MD (ft)	Incl (°)	Azim True (°)	TVD (ft)	VSEC (ft)	NS (ft)	EW (ft)	DLS (°/100ft)	Northing (ftUS)	Easting (ftUS)	Latitude (°)	Longitude (°)
	6551.00	3.47	78.65	6458.23	-1049.18	-133.04	1050.23	4.97	1433111.06	3191598.17	40.520247	-104.810832
	6641.00	1.74	70.84	6548.13	-1053.15	-132.06	1054.19	1.96	1433112.07	3191602.12	40.520249	-104.810817
	6730.00	5.26	273.37	6637.03	-1050.36	-131.37	1051.40	7.75	1433112.74	3191599.32	40.520251	-104.810827
	6820.00	15.08	267.49	6725.51	-1034.50	-131.65	1035.54	10.96	1433112.34	3191583.47	40.520251	-104.810884
	6909.00	19.29	260.19	6810.53	-1008.41	-134.66	1009.47	5.31	1433109.13	3191557.43	40.520242	-104.810978
	6999.00	25.09	261.97	6893.83	-974.80	-139.86	975.90	6.49	1433103.67	3191523.90	40.520228	-104.811099
	7088.00	31.47	262.89	6972.17	-932.98	-145.38	934.12	7.19	1433097.83	3191482.16	40.520213	-104.811249
	7178.00	38.73	265.27	7045.75	-881.50	-150.62	882.68	8.21	1433092.19	3191430.76	40.520199	-104.811434
	7267.00	41.90	268.65	7113.62	-824.00	-153.61	825.20	4.33	1433088.75	3191373.31	40.520190	-104.811641
	7357.00	49.80	269.01	7176.25	-759.48	-154.92	760.69	8.78	1433086.95	3191308.81	40.520187	-104.811873
	7446.00	56.31	267.73	7229.72	-688.40	-156.97	689.63	7.40	1433084.34	3191237.78	40.520181	-104.812129
	7536.00	63.32	268.49	7274.94	-610.68	-159.52	611.92	7.82	1433081.20	3191160.10	40.520174	-104.812408
	7625.00	71.65	269.73	7309.00	-528.54	-160.77	529.79	9.45	1433079.31	3191077.98	40.520171	-104.812703
	7715.00	78.89	270.74	7331.87	-441.57	-160.40	442.81	8.12	1433079.01	3190991.00	40.520172	-104.813016
	7804.00	83.75	269.67	7345.29	-353.62	-160.09	354.86	5.59	1433078.64	3190903.05	40.520173	-104.813333
	7893.00	87.12	269.19	7352.38	-264.91	-160.97	266.16	3.82	1433077.07	3190814.36	40.520170	-104.813652
	7983.00	90.32	270.66	7354.39	-174.95	-161.09	176.19	3.91	1433076.26	3190724.40	40.520170	-104.813975
	8120.00	90.25	270.76	7353.70	-37.98	-159.39	39.21	0.09	1433076.90	3190587.41	40.520174	-104.814468
	8209.00	91.53	271.53	7352.32	50.97	-157.61	-49.76	1.68	1433077.99	3190498.44	40.520179	-104.814788
	8299.00	90.28	270.65	7350.90	140.93	-155.90	-139.73	1.70	1433079.00	3190408.46	40.520184	-104.815112
	8388.00	89.56	270.45	7351.02	229.91	-155.05	-228.73	0.84	1433079.17	3190319.46	40.520186	-104.815432
	8478.00	88.06	270.67	7352.89	319.88	-154.17	-318.70	1.68	1433079.35	3190228.49	40.520189	-104.815755
	8567.00	89.07	270.78	7355.12	408.83	-153.04	-407.66	1.14	1433079.79	3190140.52	40.520192	-104.816075
	8657.00	88.93	271.03	7356.69	498.79	-151.62	-497.64	0.32	1433080.52	3190050.54	40.520196	-104.816399
	8746.00	89.35	271.54	7358.03	587.74	-149.63	-586.61	0.74	1433081.83	3189961.56	40.520201	-104.816719
	8836.00	89.54	271.38	7358.90	677.68	-147.33	-676.57	0.28	1433083.42	3189871.59	40.520208	-104.817042
	8925.00	89.35	271.73	7359.76	766.63	-144.92	-765.54	0.45	1433085.15	3189782.61	40.520214	-104.817362
	9015.00	90.38	271.00	7359.98	856.58	-142.77	-855.51	1.40	1433086.60	3189692.63	40.520220	-104.817686
	9104.00	89.91	270.25	7359.75	945.56	-141.80	-944.50	0.99	1433086.88	3189603.63	40.520223	-104.818006
	9193.00	90.06	269.87	7359.77	1034.56	-141.71	-1033.50	0.46	1433086.29	3189514.64	40.520223	-104.818326
	9283.00	90.25	270.84	7359.53	1124.55	-141.15	-1123.50	1.10	1433086.15	3189424.64	40.520224	-104.818650
	9372.00	90.06	270.84	7359.29	1213.53	-139.85	-1212.49	0.21	1433086.77	3189335.65	40.520228	-104.818970
	9462.00	90.02	269.88	7359.23	1303.52	-139.28	-1302.49	1.07	1433086.64	3189245.65	40.520230	-104.819294
	9551.00	89.81	269.10	7359.36	1392.52	-140.07	-1391.48	0.91	1433085.16	3189156.67	40.520227	-104.819614
	9641.00	90.83	270.14	7358.86	1482.51	-140.67	-1481.48	1.62	1433083.86	3189066.68	40.520226	-104.819938
	9730.00	91.27	269.44	7357.22	1571.50	-141.00	-1570.46	0.93	1433082.85	3188977.71	40.520225	-104.820258
	9819.00	90.36	269.14	7355.96	1660.49	-142.10	-1659.44	1.08	1433081.06	3188888.74	40.520222	-104.820578
	9909.00	90.53	270.12	7355.26	1750.48	-142.68	-1749.44	1.11	1433079.78	3188798.75	40.520220	-104.820901
	9998.00	90.59	270.02	7354.39	1839.47	-142.57	-1838.43	0.13	1433079.20	3188709.79	40.520220	-104.821221
	10088.00	91.05	270.81	7353.10	1929.45	-141.92	-1928.42	1.02	1433079.16	3188619.78	40.520222	-104.821545
	10177.00	89.79	269.17	7352.45	2018.44	-141.94	-2017.41	2.32	1433078.46	3188530.79	40.520222	-104.821865
	10267.00	89.94	268.60	7352.66	2108.44	-143.69	-2107.40	0.65	1433076.01	3188440.83	40.520217	-104.822189
	10357.00	90.05	267.82	7352.67	2198.41	-146.50	-2197.35	0.88	1433072.50	3188350.50	40.520210	-104.822512
	10446.00	89.16	266.69	7353.28	2287.33	-150.76	-2286.24	1.62	1433067.55	3188262.04	40.520198	-104.822832
	10536.00	90.12	267.94	7353.85	2377.26	-154.98	-2376.14	1.75	1433062.64	3188172.19	40.520186	-104.823155
	10625.00	90.31	267.31	7353.51	2466.21	-158.66	-2465.06	0.74	1433058.27	3188083.30	40.520176	-104.823475
	10714.00	90.05	267.88	7353.23	2555.16	-162.40	-2553.98	0.70	1433053.85	3187994.41	40.520166	-104.823795
	10893.00	87.47	265.65	7357.11	2733.87	-172.49	-2732.63	1.90	1433042.37	3187815.85	40.520138	-104.824438
	10983.00	87.55	266.15	7361.02	2823.61	-178.92	-2822.32	0.56	1433035.25	3187726.22	40.520120	-104.824760
	11072.00	86.74	265.84	7365.45	2912.32	-185.13	-2910.99	0.97	1433028.36	3187637.61	40.520103	-104.825079
	11161.00	90.02	269.12	7367.97	3001.20	-189.04	-2999.84	5.21	1433023.76	3187548.79	40.520093	-104.825399
	11251.00	91.11	270.88	7367.08	3091.19	-189.04	-3089.83	2.30	1433023.07	3187458.80	40.520093	-104.825722
	11340.00	92.48	271.21	7364.29	3180.12	-187.42	-3178.77	1.58	1433024.00	3187369.86	40.520097	-104.826042
	11430.00	93.02	271.60	7359.97	3269.97	-185.21	-3268.64	0.74	1433025.51	3187279.98	40.520103	-104.826366
	11519.00	90.48	269.65	7357.26	3358.90	-184.24	-3357.58	3.60	1433025.79	3187191.03	40.520106	-104.826685
	11609.00	90.61	268.79	7356.40	3448.89	-185.47	-3447.57	0.97	1433023.87	3187101.06	40.520102	-104.827009
	11698.00	87.69	270.64	7357.72	3537.87	-185.91	-3536.54	3.88	1433022.74	3187012.10	40.520101	-104.827329
	11787.00	91.00	270.27	7358.74	3626.84	-185.21	-3625.52	3.74	1433022.76	3186923.12	40.520103	-104.827649
	11877.00	93.35	270.11	7355.32	3716.76	-184.91	-3715.45	2.62	1433022.36	3186833.93	40.520104	-104.827973
	11967.00	94.06	271.24	7349.51	3806.55	-183.85	-3805.25	1.48	1433022.73	3186743.39	40.520107	-104.828296
	12057.00	92.65	269.85	7344.24	3896.38	-183.00	-3895.09	2.20	1433022.89	3186653.55	40.520109	-104.828619
	12146.00	90.21	269.74	7342.02	3985.35	-183.32	-3984.06	2.74	1433021.88	3186564.59	40.520108	-104.828939
	12236.00	90.14	270.59	7341.74	4075.34	-183.06	-4074.06	0.95	1433021.44	3186474.60	40.520109	-104.829262
	12326.00	90.30	271.17	7341.40	4165.32	-181.67	-4164.04	0.67	1433022.13	3186384.60	40.520112	-104.829586
	12416.00	89.95	269.64	7341.20	4255.30	-181.04	-4254.04	1.74	1433022.07	3186294.61	40.520114	-104.829910
	12505.00	89.92	270.95	7341.30	4344.29	-180.58	-4343.03	1.47	1433021.84	3186205.62	40.520115	-104.830230
	12595.00	89.12	268.80	7342.06	4434.28	-180.78	-4433.03	2.55	1433020.95	3186115.63	40.520115	-104.830554
	12685.00	90.33	271.10	7342.49	4524.27	-180.85	-4523.02	2.89	1433020.18	3186025.65	40.520114	-104.830877
	12774.00	91.91	271.02	7340.75	4613.22	-179.21	-4611.98	1.78	1433021.13	3185936.67	40.520119	-104.831197
	12864.00	92.77	270.31	7337.07	4703.13	-178.16	-4701.90	1.24	1433021.48	3185846.76	40.520122	-104.831521
	12953.00	92.23	271.19	7333.19	4792.02	-177.00	-4790.81	1.16	1433021.96	3185757.85	40.520125	-104.831840
	13042.00	90.11	269.41	7331.38	4880.99	-176.53	-4879.78	3.11	1433021.74	3185668.88	40.520126	-104.832160
	13132.00	89.81	268.78	7331.44	4970.99	-177.96	-4969.77	0.78	1433019.62	3185578.90	40.520122	-104.832484
	13221.00	90.43	269.42	7331.25	5059.98	-179.35	-5058.75	1.00	1433017.53	3185489.93	40.520118	-104.832804
	13311.00	88.68	268.58	7331.95	5149.97	-180.92	-5148.73	2.16	1433015.27	3185399.97	40.520114	-104.833128
	13400.00	88.97	269.64	7333.78	5238.95	-182.31	-5237.70	1.23	1433013.20	3185311.02	40.520110	-104.833448
	13490.00	88.89	269.91	7335.46	5328.93	-182.66	-5327.69	0.31	1433012.15	3185221.04	40.520109	-104.833772
	13580.00	88.41	270.02	7337.58	5418.90	-182.72	-5417.66	0.55	1433011.40	3185131.08	40.520109	-10

Comments	MD (ft)	Incl (°)	Azim True (°)	TVD (ft)	VSEC (ft)	NS (ft)	EW (ft)	DLS (°/100ft)	Northing (ftUS)	Easting (ftUS)	Latitude (°)	Longitude (°)
Description	Part	MD From (ft)	MD To (ft)	EOU Freq (ft)	Hole Size	Casing Diameter (in)	Survey Tool Type	Borehole / Survey				
	1	0.000	25.000	1/98.425	13.500	9.625	NAL_MWD_IFR1-Depth Only	Original Hole / Golden Eagle 21C-1-M IFR 0' to 15300' Definitive				
	1	25.000	25.000	Act Stns	13.500	9.625	NAL_MWD_IFR1-Depth Only	Original Hole / Golden Eagle 21C-1-M IFR 0' to 15300' Definitive				
	1	25.000	1806.000	Act Stns	13.500	9.625	NAL_MWD_IFR1	Original Hole / Golden Eagle 21C-1-M IFR 0' to 15300' Definitive				
	1	1806.000	15300.000	Act Stns	8.500	5.500	NAL_MWD_IFR1+MS	Original Hole / Golden Eagle 21C-1-M IFR 0' to 15300' Definitive				