



FORM F-106



00264178

RECEIVED

MAR 23 1979

COLO. OIL &amp; GAS CONS. COMM.

R. 52W

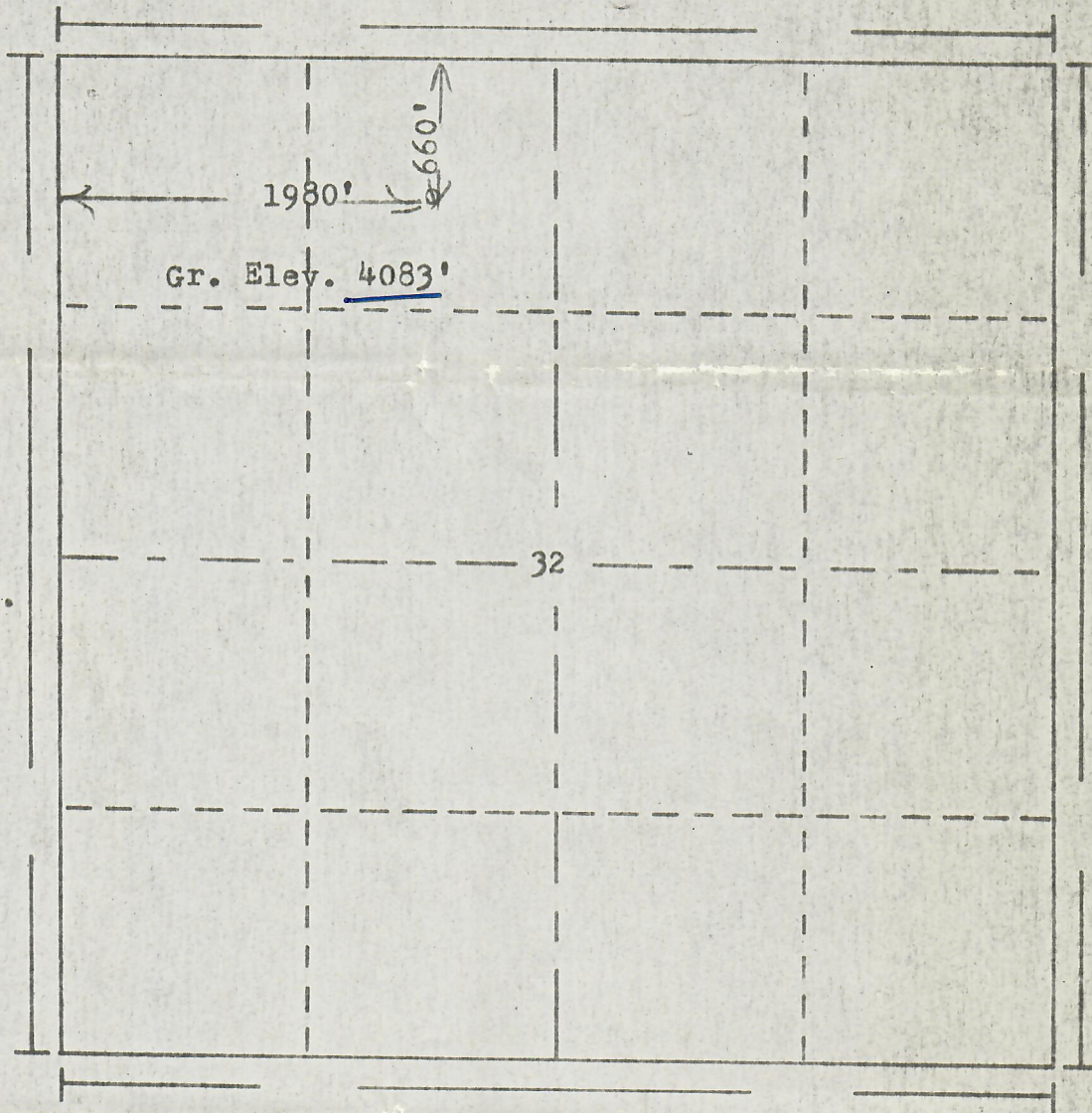

Scale... 1" = 1000'

Powers Elevation Company, Inc. of Denver, Colorado  
has in accordance with a request from Mr. Jacobs  
for Exal Inc.

determined the location of No.1 Harley  
to be CNE NW Section 32 Township 9N  
Range 52W of the 6th Principal Meridian  
Logan County, Colorado

I hereby certify that this plat is an  
accurate representation of a correct  
survey showing the location of

Date: 3-17-79

*B. J. H. H.*  
Licensed Land Surveyor No. 2853  
State of Colorado