

GOLDENEYE CENTER PAD HYDROLOGY MAP

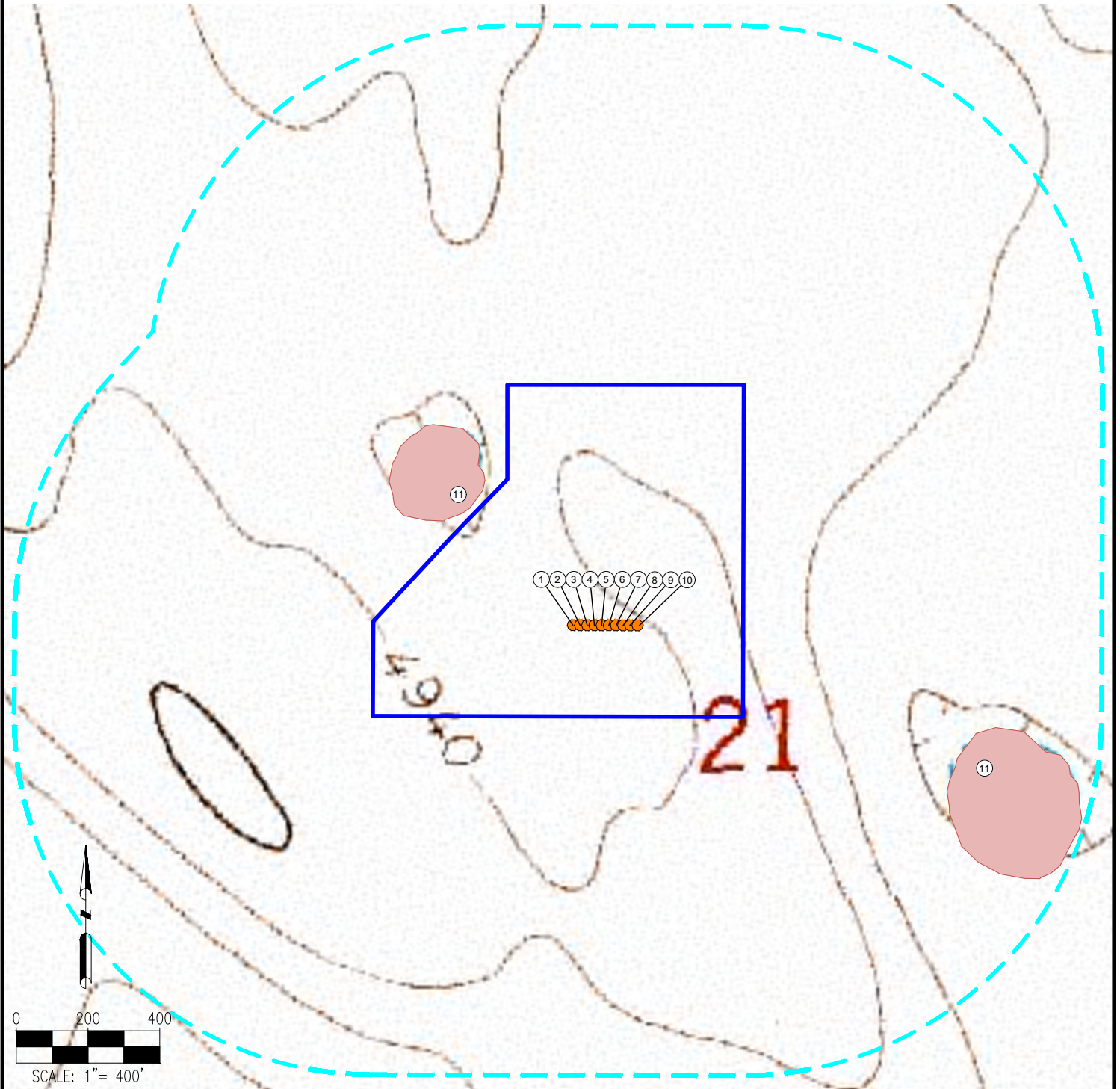

MEASUREMENTS ARE MADE FROM THE NEAREST EDGE OF THE DISTURBANCE AREA.

- | | | |
|----------------------------|----------------------------|--|
| 1. GOLDENEYE FED 21-16-1HN | 5. GOLDENEYE FED 21-16-5HC | 9. GC FED 2 |
| 2. GOLDENEYE FED 21-16-2HN | 6. GOLDENEYE FED 21-16-6HN | 10. GC FED 3 |
| 3. GOLDENEYE FED 21-16-3HN | 7. GOLDENEYE FED 21-16-7HN | 11. LOW LYING AREA ARE $\pm 19^{\circ}$ NW, $\pm 603^{\circ}$ SE |
| 4. GOLDENEYE FED 21-16-4HN | 8. GC FED 1 | |

LEGEND:

- | | |
|---|--|
|  = PROPOSED WELL |  = DISTURBANCE AREA |
|  = LOW LYING AREA |  = 1000' RADIUS |

DISCLAIMER:
THIS PLOT DOES NOT REPRESENT A MONUMENTED LAND SURVEY AND SHOULD NOT BE RELIED UPON TO DETERMINE BOUNDARY LINES, PROPERTY OWNERSHIP OR OTHER PROPERTY INTERESTS. PARCEL LINES, IF DEPICTED HAVE NOT BEEN FIELD VERIFIED AND MAY BE BASED UPON PUBLICLY AVAILABLE DATA THAT ALSO HAS NOT BEEN INDEPENDENTLY VERIFIED.

DATA SOURCE:
TOPO MAP: USGS
NHD: USGS
PUBLICLY AVAILABLE DATA SOURCES HAVE NOT BEEN INDEPENDENTLY VERIFIED BY ASCENT.



FIELD DATE:
08-22-19
DRAWING DATE:
09-05-19
BY:
SJH
CHECKED:
IJM

SITE NAME:
GOLDENEYE CENTER PAD
SURFACE LOCATION:
SE 1/4 NW 1/4 SEC. 21, T8N, R60W, 6TH P.M.
WELD COUNTY, COLORADO

