

RECEIVED

AUG 16 1985

COLO. OIL & GAS CONS. COMM.

The accompanying plat is an accurate representation showing the location of a proposed well. This location may be described as a point 660 feet north of the south line, and 1932 east of the west line of Section 31, Township 8 N Range 58 W of the 6th P.M., WELD County, COLORADO. The surface elevation at this point is 4832 feet m.s.l.



00253472

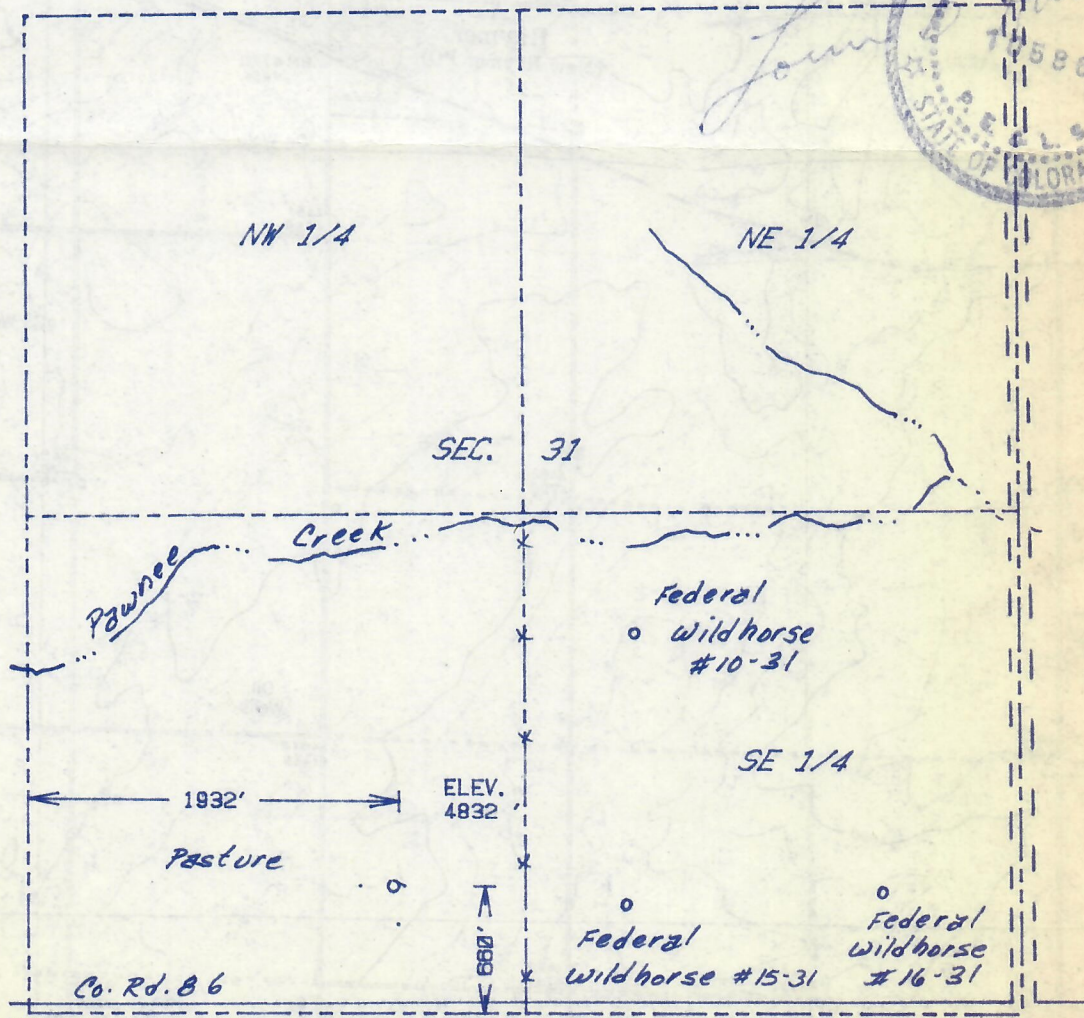
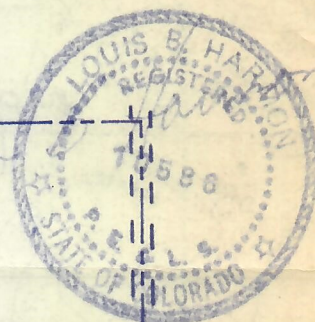

SCALE - 1"=1000'

- SURVEYED POINT
- REFERENCE STAKE (200 'S, 200 'W)
- SW 1/4 SEC. 31 , T 8 N , R 58 W

Co. Rd. 123
 1 mi S to Colo 14
 3 mi E to New Raymer

HARMON
ENGINEERING
SERVICES

SEIFRIED #14-31

DIVERSIFIED RESOURCES LTD

WELD CO., COLORADO 1 AUG 1985

