

GOLDENEYE EAST PAD LOCATION DRAWING

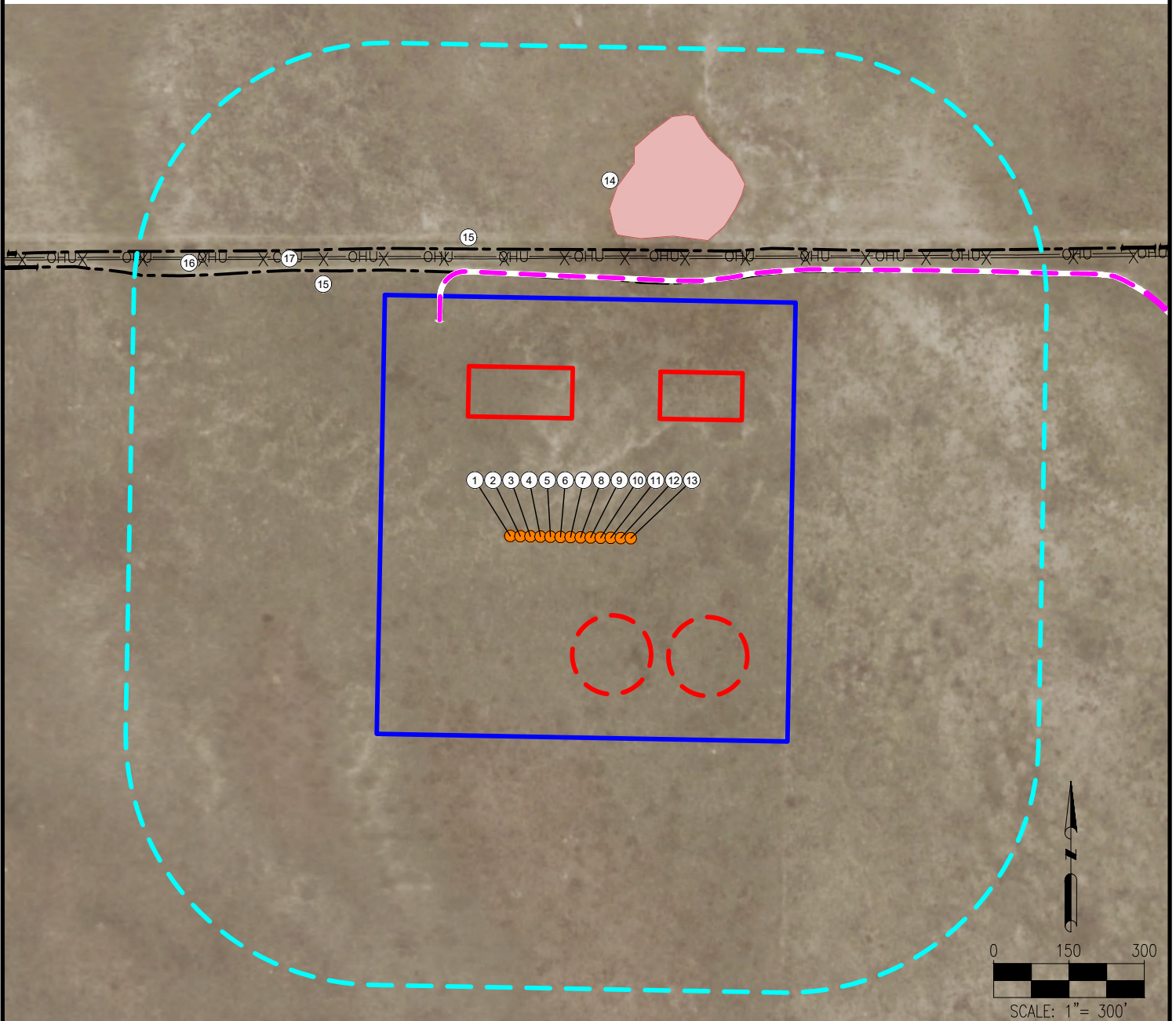

- | | | |
|-------------------------|--|--------------------------------------|
| 1. GE FED 1 | 9. GOLDENEYE FED 21-4HN | 17. OVERHEAD UTILITY IS $\pm 559'$ N |
| 2. GE FED 2 | 10. GOLDENEYE FED 21-5HN | |
| 3. GE FED 3 | 11. GOLDENEYE FED 21-6HN | |
| 4. GE FED 4 | 12. GOLDENEYE FED 21-7HC | |
| 5. GE FED 5 | 13. GOLDENEYE FED 21-8HN | |
| 6. GOLDENEYE FED 21-1HC | 14. LOW LYING AREA IS $\pm 609'$ N | |
| 7. GOLDENEYE FED 21-2HN | 15. PRIVATE ROADS ARE $\pm 516'$ N, $\pm 573'$ N | |
| 8. GOLDENEYE FED 21-3HN | 16. FENCE IS $\pm 555'$ N | |

LEGEND:

- | | | |
|--------------------------|----------------------------|--------------------|
| ● = PROPOSED WELL | — OHU — = OVERHEAD UTILITY | = DISTURBANCE AREA |
| — = PROPOSED ACCESS ROAD | = LOW LYING AREA | = 1000' RADIUS |
| — = EXISTING ROAD | = PROPOSED FACILITY | = MLVT |
| — X — = FENCE | | |

MEASURED FROM NEAREST WELL OR FACILITY:

- | | |
|------------------------------------|----------------|
| BUILDING | $\pm 5280'$ SE |
| BUILDING UNIT | $\pm 5280'$ NW |
| PUBLIC ROAD (WELD COUNTY ROAD 103) | $\pm 2760'$ E |
| PROPERTY LINE (USA) | $\pm 119'$ N |
| UTILITY (POWERLINE) | $\pm 142'$ N |
| RAILROAD | $\pm 5280'$ S |

MEASURED FROM NEAREST EDGE OF DISTURBANCE:

- | | |
|--------------------------------|--------------|
| SURFACE WATER (LOW LYING AREA) | $\pm 120'$ N |
|--------------------------------|--------------|

REFERENCE LOCATION

****GOLDENEYE FED 21-10HN****

LAT: 40.653550° N
LONG: 104.098062° W
ELEVATION: 4934'
558' FNL & 2192' FWL
PDOP: 1.6
GPS OPERATOR: RYAN DESMOND

DISCLAIMER:
THIS PLOT DOES NOT REPRESENT A MONUMENTED LAND SURVEY AND SHOULD NOT BE RELIED UPON TO DETERMINE BOUNDARY LINES, PROPERTY OWNERSHIP OR OTHER PROPERTY INTERESTS. PARCEL LINES, IF DEPICTED HAVE NOT BEEN FIELD VERIFIED AND MAY BE BASED UPON PUBLICLY AVAILABLE DATA THAT ALSO HAS NOT BEEN INDEPENDENTLY VERIFIED.

DATA SOURCE:
AERIAL IMAGERY: NAIP 2017
WATER WELLS: COLORADO DWR
NHD: USGS

PUBLICLY AVAILABLE DATA SOURCES HAVE NOT BEEN INDEPENDENTLY VERIFIED BY ASCENT.

MEASURED FROM NEAREST EDGE OF DISTURBANCE:

WATER WELL $\pm 4041'$ NE SWL = 32'

PERMIT: 284024 RECEIPT: 0049249

DISTURBANCE ACREAGE:

16.4 ACRES DRILLING OPERATIONS
8.5 ACRES INTERIM RECLAIM
CURRENT SURFACE USE: RANGELAND
FUTURE SURFACE USE: RANGELAND

PREPARED FOR:



7535 Hilltop Circle
Denver, CO 80221
(303) 928-7128
www.ascentgeomatics.com

FIELD DATE:
04-27-18

DRAWING DATE:
09-12-19

BY:
VQD

CHECKED:
MJE

SITE NAME:
GOLDENEYE EAST PAD

SURFACE LOCATION:

**NE 1/4 NW 1/4 SEC. 21, T8N, R60W, 6TH P.M.
WELD COUNTY, COLORADO**