

Earthen Skim Pit Closure -- Schematic Diagram

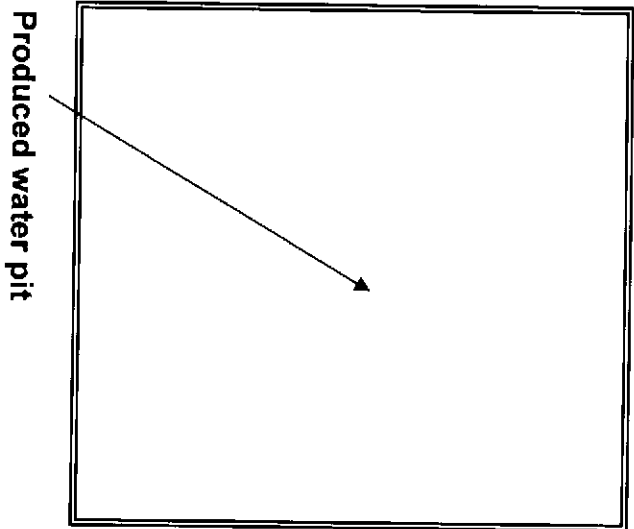

Skim tank to replace skim pit

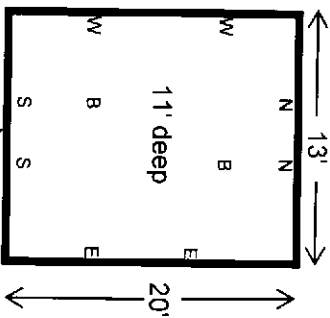

Skim pit after excavation of oil-stained soil
[Pre-excavation pit dimensions were 9' wide x 15' long x 8' deep]

Soil sample locations
[two sites on each side of the pit excavation near the middle of the pit wall, and in the base of the pit, were collected and mixed]

Location	Date of Sample Collection	Total TPH-GRO + TPH-DRO
Base [B]	10/28/2014	332 mg/kg
North [N]	11/17/2014	193 mg/kg
South [S]	10/28/2014	343 mg/kg
East [E]	10/15/2014	33 mg/kg
West [W]	10/15/2014	217 mg/kg