



FRANE SURVEYING INC.

Physical Address: 34834 Annie Cir.
Mail to: Box 2372, Elizabeth, CO 80107
Ph. 303-243-0037
www.franesurveying.com

Job # 19-092-UPRR Baughman Farms #1

Frane Surveying, in accordance with a request from **Kuenzler & Flora Reserve Corp.** has determined the location of **UPRR Baughman Farms #1 (capped well)** to be **681 Feet FSL**, and **675 Feet FEL**, (90° off Section lines) of Section **1**, Township **15s**, Range **45w** of the 6th Principal Meridian, **Cheyenne County**, Colorado.

Date: Staked on 04/26/19 drawn on 04/29/19.
Rev: 08/22/19

Re: Staked by Elijah Frane
Drawn: Drawn by Elijah Frane

1000' HYDROLOGY MAP

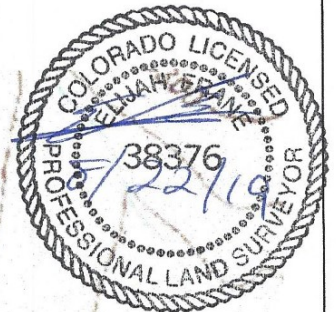

There are no apparent surface water areas or riparian areas within 1000' of proposed Well Pad.

Oil Well

6

1

Oil Well

Kuenzler & Flora Reserve Corp.
UPRR Baughman Farms #1 (capped well)
SE 1/4 Sec. 1-15S-45W
Cheyenne, CO, Colorado

LADDER



1000'

4250'

FIELD

4205'

4250'

Oil Well

ell