



Lat40°, Inc. 6250 W. 10th Street, Unit 2, Greeley, CO 970-515-5294

# PROPOSED SCALED FACILITY DRAWING

AKBARY 1-A PAD

SECTION: 1  
TOWNSHIP: 8N  
RANGE: 67W  
6TH. P.M.  
WELD COUNTY, CO

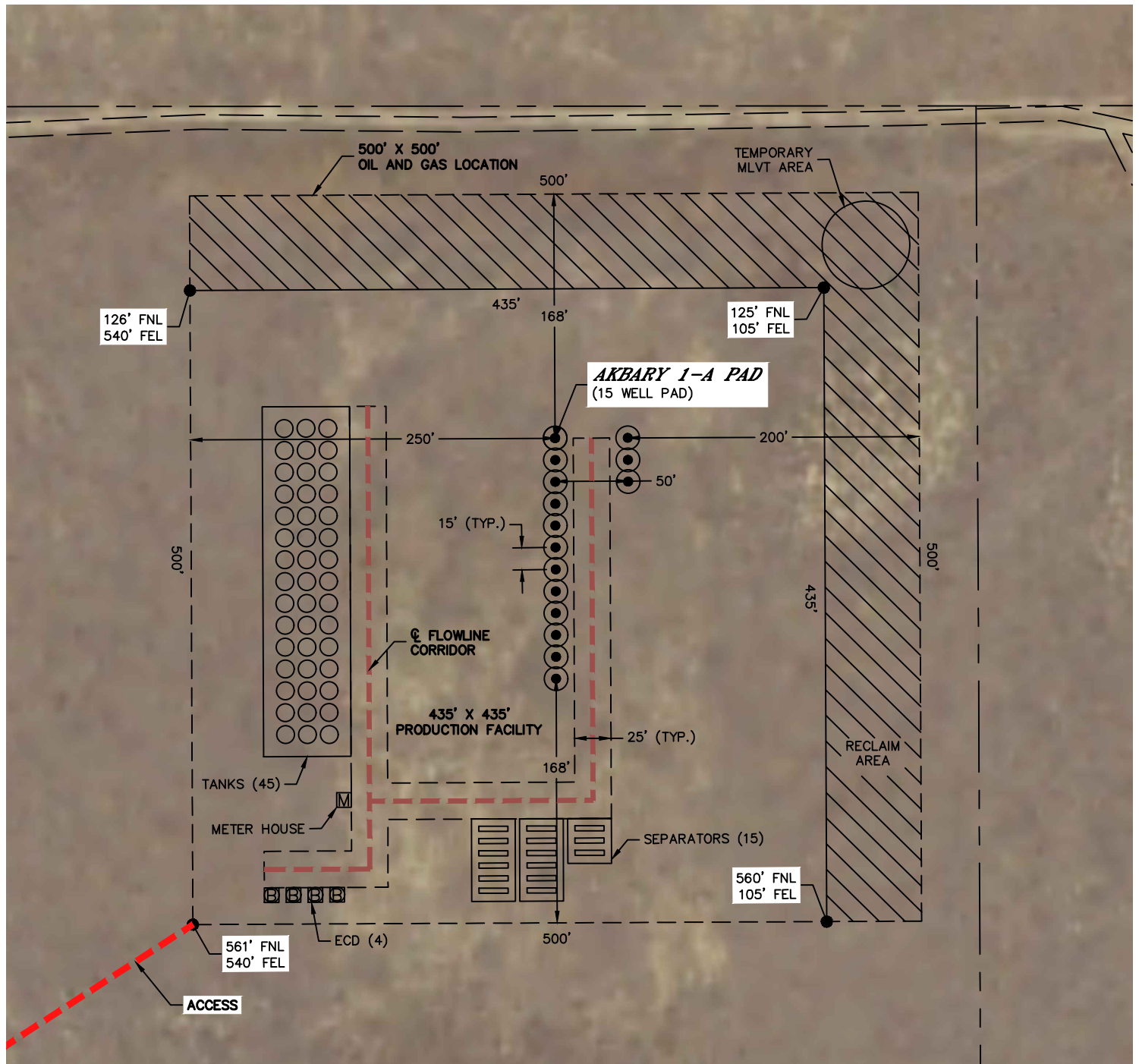

## LEGEND

- PROPOSED WELL HEAD
- TANK
- SEPARATOR
- ECD
- METER HOUSE
- BUILDING UNIT
- BUILDING

**TOTAL DISTURBED AREA OF LOCATION: ±5.7 ACRES**  
**TOTAL SIZE OF LOCATION AFTER RECLAMATION: ±4.3 ACRES**

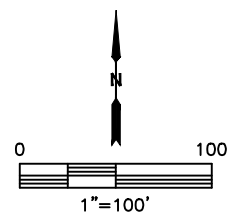

DATE: 6/28/2019  
PROJECT#: 2018061