



Lat40°, Inc. 6250 W. 10th Street, Unit 2, Greeley, CO 970-515-5294

# LOCATION DRAWING

AKBARY 1-A PAD

SECTION: 1  
TOWNSHIP: 8N  
RANGE: 67W  
6TH. P.M.  
WELD COUNTY, CO

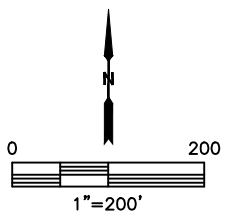
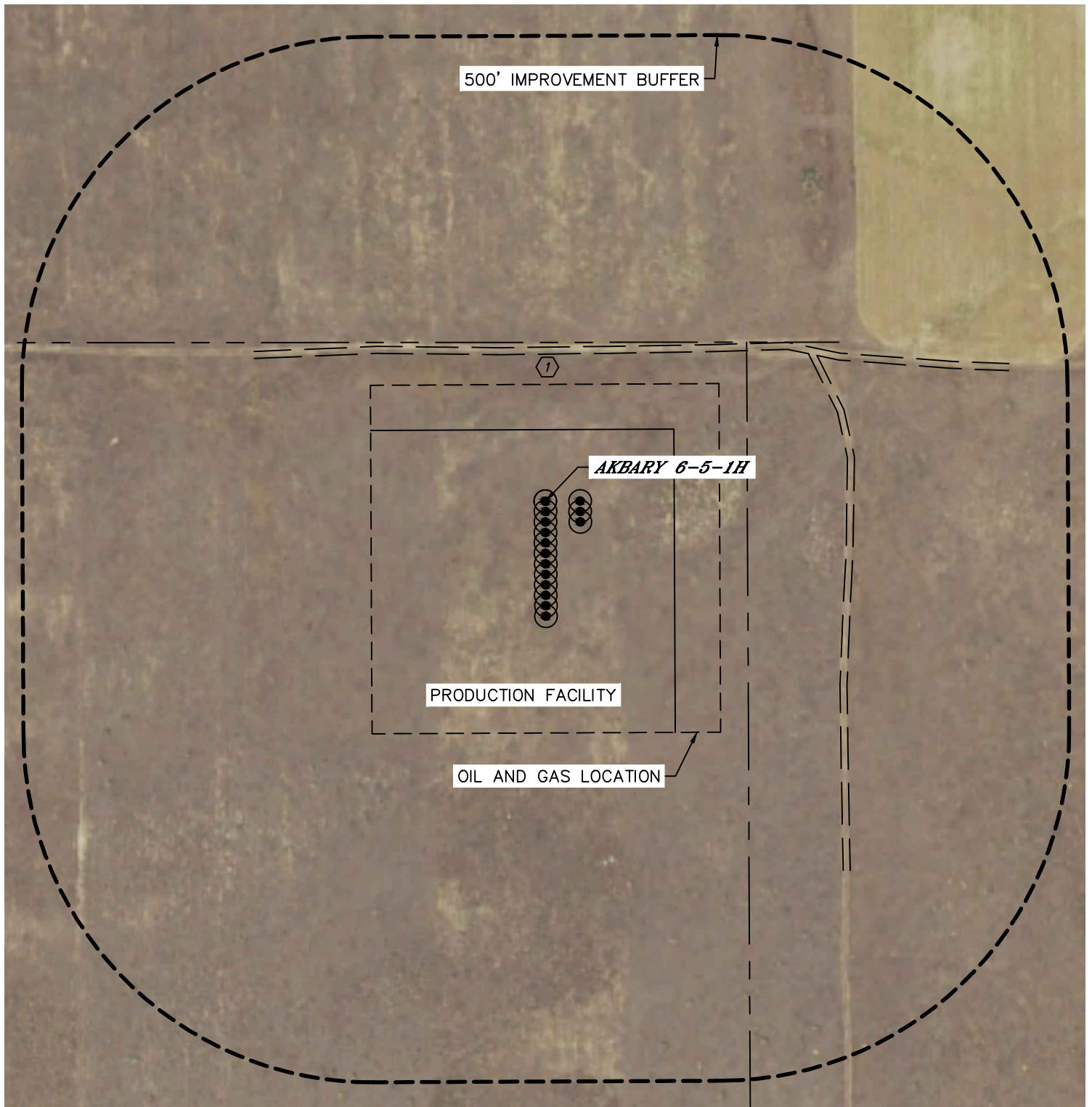



Lat40°, Inc. 6250 W. 10th Street, Unit 2, Greeley, CO 970-515-5294

## LOCATION DRAWING

AKBARY 1-A PAD

SECTION: 1  
TOWNSHIP: 8N  
RANGE: 67W  
6TH. P.M.  
WELD COUNTY, CO

### IMPROVEMENTS:

(MEASURED FROM THE PROPOSED AKBARY 6-5-1H WELL LOCATION)

 NO BUILDING UNITS WITHIN 500' IMPROVEMENT BUFFER

 NO BUILDINGS WITHIN 500' IMPROVEMENT BUFFER

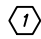
 ROAD 211' N, 433' E