

VULCAN 6-64 10-8 PAD LOCATION DRAWING

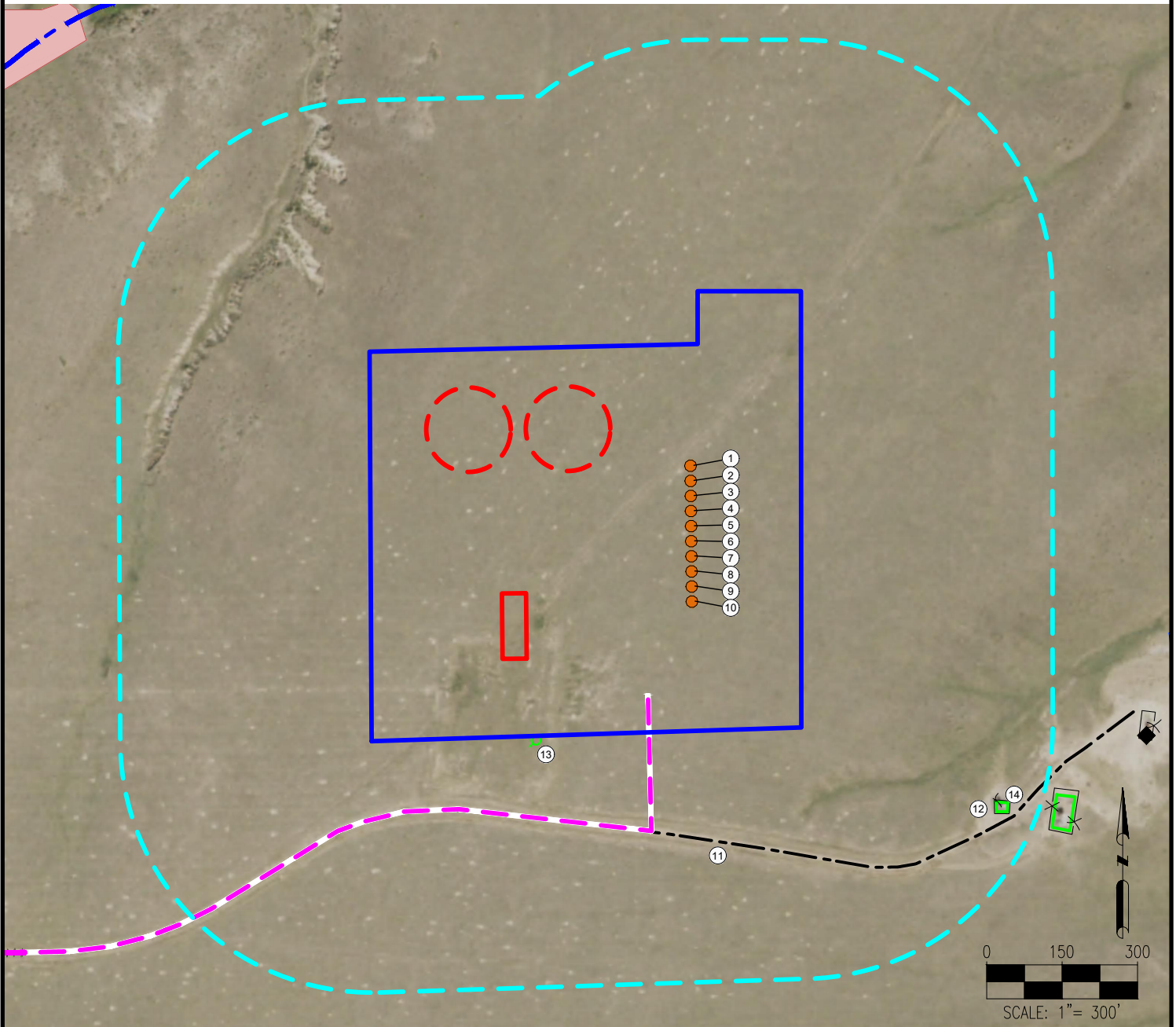

- | | | |
|-------------------------|---------------------------|--|
| 1. VULCAN 6-64 10-8 1HN | 6. VULCAN 6-64 10-8 6HN | 11. PRIVATE ROAD IS $\pm 613'$ S |
| 2. VULCAN 6-64 10-8 2HN | 7. VULCAN 6-64 10-8 7HN | 12. FENCE IS $\pm 812'$ SE |
| 3. VULCAN 6-64 10-8 3HN | 8. VULCAN 6-64 10-8 8HN | 13. EXISTING WELL (NORDMAN ESTATE 1-10) IS $\pm 526'$ SW |
| 4. VULCAN 6-64 10-8 4HN | 9. VULCAN 6-64 10-8 9HN | 14. EXISTING FACILITY IS $\pm 818'$ SE |
| 5. VULCAN 6-64 10-8 5HN | 10. VULCAN 6-64 10-8 10HN | |

LEGEND:

	= PROPOSED WELL		= PROPOSED ACCESS ROAD		= PROPOSED MLVT
	= PLUGGED & ABANDONED WELL		= DISTURBANCE AREA		= STREAM
	= PRODUCING WELL		= EXISTING FACILITY BERM		= EXISTING ROAD
			= 500' RADIUS		= FENCE
			= LOW LYING AREA		
			= PROPOSED FACILITY BERM		

MEASURED FROM NEAREST WELL OR FACILITY:

BUILDING	$\pm 2451'$ NE
BUILDING UNIT	$\pm 4163'$ SE
PUBLIC ROAD (ELBERT COUNTY ROAD 29)	$\pm 3495'$ SE
PROPERTY LINE (GRAVES JOHN P JR)	$\pm 735'$ S
UTILITY (POWERLINE)	$\pm 1184'$ E
RAILROAD	$\pm 5280'$ N
SCHOOL PROPERTY LINE	$\pm 5280'$ NW
SCHOOL FACILITY	$\pm 5280'$ NW
CHILD CARE CENTER	$\pm 5280'$ NW

REFERENCE LOCATION

****VULCAN 6-64 10-8 5HN****

LAT: 39.545483° N
LONG: 104.542233° W
ELEVATION: 6072'
1650' FNL & 2260' FWL
PDOP: 1.6
GPS OPERATOR: RYAN DESMOND

DISCLAIMER:
THIS PLOT DOES NOT REPRESENT A MONUMENTED LAND SURVEY AND SHOULD NOT BE RELIED UPON TO DETERMINE BOUNDARY LINES, PROPERTY OWNERSHIP OR OTHER PROPERTY INTERESTS. PARCEL LINES, IF DEPICTED HAVE NOT BEEN FIELD VERIFIED AND MAY BE BASED UPON PUBLICLY AVAILABLE DATA THAT ALSO HAS NOT BEEN INDEPENDENTLY VERIFIED.

DATA SOURCE:
AERIAL IMAGERY: NAIP 2017
WATER WELLS: COLORADO DWR
NHD: USGS
PUBLICLY AVAILABLE DATA SOURCES HAVE NOT BEEN INDEPENDENTLY VERIFIED BY ASCENT.

MEASURED FROM NEAREST EDGE OF DISTURBANCE:

SURFACE WATER (INTERMITTENT POND)	$\pm 732'$ E
-----------------------------------	--------------

MEASURED FROM NEAREST EDGE OF DISTURBANCE:

WATER WELL	$\pm 957'$ SW	SWL = 194'
PERMIT:	101640	RECEIPT: 0095086

DISTURBANCE ACREAGE:

15.6 ACRES DRILLING OPERATIONS
8.6 ACRES INTERIM RECLAIM

CURRENT SURFACE USE: RANGELAND
FUTURE SURFACE USE: RANGELAND

PREPARED FOR:

GMT
Exploration Company LLC

ASCENT
GEOMATICS SOLUTIONS
8620 Wolff Court
Westminster, CO 80031
(303) 928-7128
www.ascentgeomatics.com

FIELD DATE:
09-28-18

DRAWING DATE:
07-10-19

BY:
SJH

CHECKED:
DNS

SITE NAME:
VULCAN 6-64 10-8 PAD

SURFACE LOCATION:

**SE 1/4 NW 1/4 SEC. 10, T6S, R64W, 6TH P.M.
ELBERT COUNTY, COLORADO**