

# BONANZA CREEK OIL COMPANY

Location: COLORADO Slot: SLOT#05 STATE PRONGHORN T44-P41-16HNB (491'FSL & 2243'FEL, SEC.16)  
Field: WELD COUNTY Well: STATE PRONGHORN T44-P41-16HNB  
Facility: SEC.16-T05N-R61W Wellbore: STATE PRONGHORN T44-P41-16HNB PWB

Plot reference wellpath is STATE PRONGHORN T44-P41-16HNB PWB (REV-A.0)	Grid System: NAD83 / Lambert Colorado SP, Northern Zone (501), US feet
True vertical depths are referenced to RIG (17) (RKB)	North Reference: True north
Measured depths are referenced to RIG (17) (RKB)	Scale: True distance
RIG (17) (RKB) to Mean Sea Level: 4660 feet	Depths are in feet
Mean Sea Level to Ground level (At Slot: SLOT#05 STATE PRONGHORN T44-P41-16HNB (491'FSL & 2243'FEL, SEC.16)): 0 feet	Created by: rblais01 on 2018-11-01
Coordinates are in feet referenced to Slot	Database: WADENVER

## Location Information

Facility Name			Grid East (US ft)	Grid North (US ft)	Latitude	Longitude
SEC.16-T05N-R61W			3358525.170	1389358.084	40°23'42.167"N	104°12'45.912"W
Slot	Local N (ft)	Local E (ft)	Grid East (US ft)	Grid North (US ft)	Latitude	Longitude
SLOT#05 STATE PRONGHORN T44-P41-16HNB (491'FSL & 2243'FEL, SEC.16)	-0.44	79.96	3358605.130	1389358.810	40°23'42.162"N	104°12'44.878"W
RIG (17) (RKB) to Ground level (At Slot: SLOT#05 STATE PRONGHORN T44-P41-16HNB (491'FSL & 2243'FEL, SEC.16))						4660ft
Mean Sea Level to Ground level (At Slot: SLOT#05 STATE PRONGHORN T44-P41-16HNB (491'FSL & 2243'FEL, SEC.16))						0ft
RIG (17) (RKB) to Mean Sea Level						4660ft

## Survey Program

Start MD (ft)	End MD (ft)	Tool	Model	Log Name/Comment	Wellbore
17.00	1550.00	BHI NavTrak	BHI NavTrak (Rotating+Axial Corr)		STATE PRONGHORN T44-P41-16HNB PWB
1550.00	11615.09	BHI AutoTrak Curve	BHI AutoTrak Curve (Axial Corr, Short spacing)		STATE PRONGHORN T44-P41-16HNB PWB

## Hole and Casing Sections

Name	Start MD (ft)	End MD (ft)	Interval (ft)	Start TVD (ft)	End TVD (ft)	Start Local N (ft)	Start Local E (ft)	End Local N (ft)	End Local E (ft)	Wellbore
13.5in Open Hole	17.00	1550.00	1533.00	17.00	1550.00	0.00	0.00	0.00	0.00	STATE PRONGHORN T44-P41-16HNB PWB
9.625in Casing Surface	17.00	1550.00	1533.00	17.00	1550.00	0.00	0.00	0.00	0.00	STATE PRONGHORN T44-P41-16HNB PWB
8.5in Open Hole	1550.00	11615.09	10065.09	1550.00	N/A	0.00	0.00	N/A	N/A	STATE PRONGHORN T44-P41-16HNB PWB

## Well Profile Data

Design Comment	MD (ft)	Inc (°)	Az (°)	TVD (ft)	Local N (ft)	Local E (ft)	DLS (°/100ft)	VS (ft)
Tie On	17.00	0.000	122.650	17.00	0.00	0.00	0.00	0.00
End of Tangent	1600.00	0.000	122.650	1600.00	0.00	0.00	0.00	0.00
End of Build (XS)	2503.04	18.061	122.650	2488.16	-76.15	118.85	2.00	-44.49
End of Tangent (XS)	5649.24	18.061	122.650	5479.34	-602.39	940.13	0.00	-351.96
End of 3D Arc (XS)	6641.78	90.000	1.405	6120.00	-41.44	1132.56	10.00	239.12
End of Tangent (XS)	11615.09	90.000	1.405	6120.00	4930.38	1254.53	0.00	5087.48

## Bottom Hole Location

MD (ft)	Inc (°)	Az (°)	TVD (ft)	Local N (ft)	Local E (ft)	Grid East (US ft)	Grid North (US ft)	Latitude	Longitude
11615.09	90.000	1.405	6120.00	4930.38	1254.53	3359787.89	1394306.67	40°24'30.882"N	104°12'28.661"W

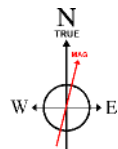
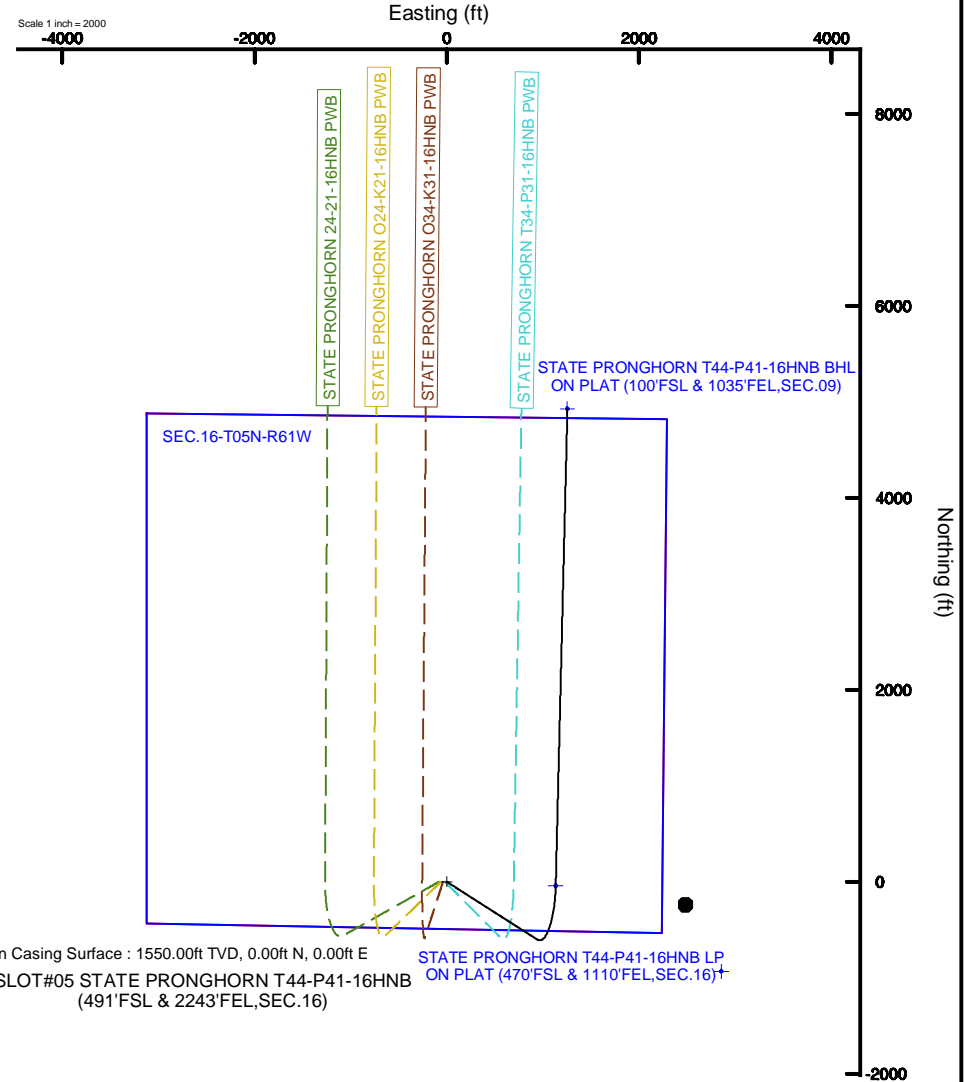
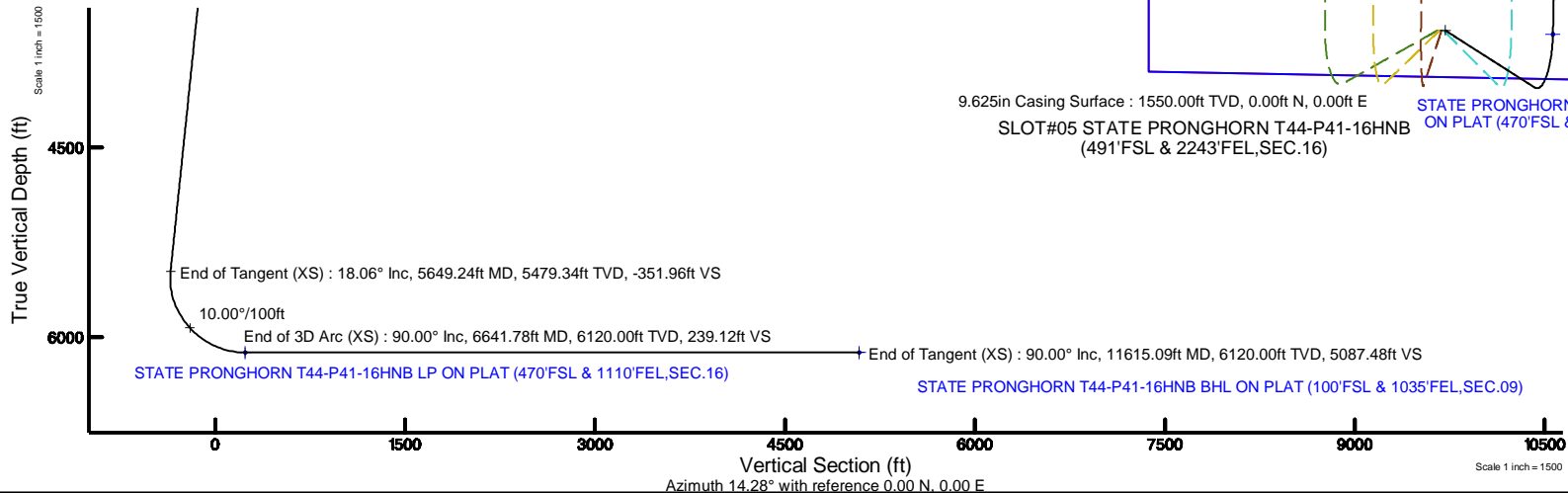

BGGM (1900.0 to 2019.0) Dip: 66.89° Field: 52332 nT  
Magnetic North is 7.95 degrees East of True North (at 11/1/2018)

To correct azimuth from Magnetic to True add 7.95 degrees



**Planned Wellpath Report**  
STATE PRONGHORN T44-P41-16HNB PWP (REV-A.0)  
Page 1 of 6



REFERENCE WELLPATH IDENTIFICATION			
Operator	BONANZA CREEK OIL COMPANY	Slot	SLOT#05 STATE PRONGHORN T44-P41-16HNB (491'FSL & 2243'FEL,SEC.16)
Area	COLORADO	Well	STATE PRONGHORN T44-P41-16HNB
Field	WELD COUNTY	Wellbore	STATE PRONGHORN T44-P41-16HNB PWB
Facility	SEC.16-T05N-R61W		

REPORT SETUP INFORMATION			
Projection System	NAD83 / Lambert Colorado SP, Northern Zone (501), US feet	Software System	WellArchitect® 5.1
North Reference	True	User	Robiale01
Scale	0.999960	Report Generated	11/1/2018 at 5:02:14 PM
Convergence at slot	0.83° East	Database/Source file	WA DENVER/STATE_PRONGHORN_T44-P41-16HNB_PWP__REV-A.0_.xml

WELLPATH LOCATION						
	Local coordinates		Grid coordinates		Geographic coordinates	
	North[ft]	East[ft]	Easting[US ft]	Northing[US ft]	Latitude	Longitude
Slot Location	-0.44	79.96	3358605.13	1389358.81	40°23'42.162"N	104°12'44.878"W
Facility Reference Pt			3358525.17	1389358.08	40°23'42.167"N	104°12'45.912"W
Field Reference Pt			3224525.77	1254425.87	40°01'44.400"N	104°41'53.556"W

WELLPATH DATUM			
Calculation method	Minimum curvature	RIG (17') (RKB) to Facility Vertical Datum	4660.00ft
Horizontal Reference Pt	Slot	RIG (17') (RKB) to Mean Sea Level	4660.00ft
Vertical Reference Pt	RIG (17') (RKB)	RIG (17') (RKB) to Ground Level at Slot (SLOT#05 STATE PRONGHORN T44-P41-16HNB (491'FSL & 2243'FEL,SEC.16))	4660.00ft
MD Reference Pt	RIG (17') (RKB)	Section Origin	N 0.00, E 0.00 ft
Field Vertical Reference	Mean Sea Level	Section Azimuth	14.28°



**Planned Wellpath Report**  
**STATE PRONGHORN T44-P41-16HNB PWP (REV-A.0)**  
Page 2 of 6



REFERENCE WELLPATH IDENTIFICATION			
Operator	BONANZA CREEK OIL COMPANY	Slot	SLOT#05 STATE PRONGHORN T44-P41-16HNB (491'FSL & 2243'FEL,SEC.16)
Area	COLORADO	Well	STATE PRONGHORN T44-P41-16HNB
Field	WELD COUNTY	Wellbore	STATE PRONGHORN T44-P41-16HNB PWB
Facility	SEC.16-T05N-R61W		

WELLPATH DATA (122 stations) † = interpolated/extrapolated station												
MD [ft]	Inclination [°]	Azimuth [°]	TVD [ft]	Vert Sect [ft]	North [ft]	East [ft]	Latitude		Longitude		DLS [°/100ft]	Comments
0.00†	0.000	122.650	0.00	0.00	0.00	0.00	40°23'42.162"N		104°12'44.878"W		0.00	
17.00	0.000	122.650	17.00	0.00	0.00	0.00	40°23'42.162"N		104°12'44.878"W		0.00	Tie On
117.00†	0.000	122.650	117.00	0.00	0.00	0.00	40°23'42.162"N		104°12'44.878"W		0.00	
217.00†	0.000	122.650	217.00	0.00	0.00	0.00	40°23'42.162"N		104°12'44.878"W		0.00	
317.00†	0.000	122.650	317.00	0.00	0.00	0.00	40°23'42.162"N		104°12'44.878"W		0.00	
417.00†	0.000	122.650	417.00	0.00	0.00	0.00	40°23'42.162"N		104°12'44.878"W		0.00	
517.00†	0.000	122.650	517.00	0.00	0.00	0.00	40°23'42.162"N		104°12'44.878"W		0.00	
617.00†	0.000	122.650	617.00	0.00	0.00	0.00	40°23'42.162"N		104°12'44.878"W		0.00	
717.00†	0.000	122.650	717.00	0.00	0.00	0.00	40°23'42.162"N		104°12'44.878"W		0.00	
817.00†	0.000	122.650	817.00	0.00	0.00	0.00	40°23'42.162"N		104°12'44.878"W		0.00	
917.00†	0.000	122.650	917.00	0.00	0.00	0.00	40°23'42.162"N		104°12'44.878"W		0.00	
1017.00†	0.000	122.650	1017.00	0.00	0.00	0.00	40°23'42.162"N		104°12'44.878"W		0.00	
1117.00†	0.000	122.650	1117.00	0.00	0.00	0.00	40°23'42.162"N		104°12'44.878"W		0.00	
1217.00†	0.000	122.650	1217.00	0.00	0.00	0.00	40°23'42.162"N		104°12'44.878"W		0.00	
1317.00†	0.000	122.650	1317.00	0.00	0.00	0.00	40°23'42.162"N		104°12'44.878"W		0.00	
1417.00†	0.000	122.650	1417.00	0.00	0.00	0.00	40°23'42.162"N		104°12'44.878"W		0.00	
1517.00†	0.000	122.650	1517.00	0.00	0.00	0.00	40°23'42.162"N		104°12'44.878"W		0.00	
1600.00	0.000	122.650	1600.00	0.00	0.00	0.00	40°23'42.162"N		104°12'44.878"W		0.00	End of Tangent
1617.00†	0.340	122.650	1617.00	-0.02	-0.03	0.04	40°23'42.162"N		104°12'44.877"W		2.00	
1717.00†	2.340	122.650	1716.97	-0.75	-1.29	2.01	40°23'42.150"N		104°12'44.852"W		2.00	
1817.00†	4.340	122.650	1816.79	-2.59	-4.43	6.92	40°23'42.119"N		104°12'44.789"W		2.00	
1917.00†	6.340	122.650	1916.35	-5.52	-9.45	14.75	40°23'42.069"N		104°12'44.687"W		2.00	
2017.00†	8.340	122.650	2015.53	-9.55	-16.34	25.51	40°23'42.001"N		104°12'44.548"W		2.00	
2117.00†	10.340	122.650	2114.20	-14.67	-25.10	39.17	40°23'41.914"N		104°12'44.372"W		2.00	
2217.00†	12.340	122.650	2212.24	-20.86	-35.71	55.73	40°23'41.810"N		104°12'44.158"W		2.00	
2317.00†	14.340	122.650	2309.54	-28.14	-48.15	75.15	40°23'41.687"N		104°12'43.907"W		2.00	
2417.00†	16.340	122.650	2405.97	-36.47	-62.43	97.43	40°23'41.546"N		104°12'43.619"W		2.00	
2503.04	18.061	122.650	2488.16	-44.49	-76.15	118.85	40°23'41.410"N		104°12'43.342"W		2.00	End of Build (XS)
2517.00†	18.061	122.650	2501.43	-45.86	-78.49	122.49	40°23'41.387"N		104°12'43.295"W		0.00	
2617.00†	18.061	122.650	2596.50	-55.63	-95.21	148.60	40°23'41.222"N		104°12'42.957"W		0.00	
2717.00†	18.061	122.650	2691.58	-65.40	-111.94	174.70	40°23'41.056"N		104°12'42.620"W		0.00	
2817.00†	18.061	122.650	2786.65	-75.18	-128.67	200.80	40°23'40.891"N		104°12'42.283"W		0.00	
2917.00†	18.061	122.650	2881.72	-84.95	-145.39	226.91	40°23'40.726"N		104°12'41.945"W		0.00	
3017.00†	18.061	122.650	2976.80	-94.72	-162.12	253.01	40°23'40.560"N		104°12'41.608"W		0.00	
3117.00†	18.061	122.650	3071.87	-104.49	-178.84	279.12	40°23'40.395"N		104°12'41.271"W		0.00	
3217.00†	18.061	122.650	3166.94	-114.27	-195.57	305.22	40°23'40.230"N		104°12'40.933"W		0.00	



WELLPATH DATA (122 stations) † = interpolated/extrapolated station										
MD [ft]	Inclination [°]	Azimuth [°]	TVD [ft]	Vert Sect [ft]	North [ft]	East [ft]	Latitude	Longitude	DLS [°/100ft]	Comments
3317.00†	18.061	122.650	3262.01	-124.04	-212.30	331.32	40°23'40.065"N	104°12'40.596"W	0.00	
3417.00†	18.061	122.650	3357.09	-133.81	-229.02	357.43	40°23'39.899"N	104°12'40.258"W	0.00	
3517.00†	18.061	122.650	3452.16	-143.58	-245.75	383.53	40°23'39.734"N	104°12'39.921"W	0.00	
3617.00†	18.061	122.650	3547.23	-153.36	-262.47	409.64	40°23'39.569"N	104°12'39.584"W	0.00	
3717.00†	18.061	122.650	3642.30	-163.13	-279.20	435.74	40°23'39.403"N	104°12'39.246"W	0.00	
3817.00†	18.061	122.650	3737.38	-172.90	-295.93	461.84	40°23'39.238"N	104°12'38.909"W	0.00	
3917.00†	18.061	122.650	3832.45	-182.67	-312.65	487.95	40°23'39.073"N	104°12'38.572"W	0.00	
4017.00†	18.061	122.650	3927.52	-192.45	-329.38	514.05	40°23'38.908"N	104°12'38.234"W	0.00	
4117.00†	18.061	122.650	4022.60	-202.22	-346.10	540.15	40°23'38.742"N	104°12'37.897"W	0.00	



**Planned Wellpath Report**  
STATE PRONGHORN T44-P41-16HNB PWP (REV-A.0)  
Page 3 of 6



## REFERENCE WELLPATH IDENTIFICATION

Operator	BONANZA CREEK OIL COMPANY	Slot	SLOT#05 STATE PRONGHORN T44-P41-16HNB (491'FSL & 2243'FEL,SEC.16)
Area	COLORADO	Well	STATE PRONGHORN T44-P41-16HNB
Field	WELD COUNTY	Wellbore	STATE PRONGHORN T44-P41-16HNB PWB
Facility	SEC.16-T05N-R61W		

**WELLPATH DATA (122 stations)** † = interpolated/extrapolated station

MD [ft]	Inclination [°]	Azimuth [°]	TVD [ft]	Vert Sect [ft]	North [ft]	East [ft]	Latitude	Longitude	DLS [°/100ft]	Comments
4217.00†	18.061	122.650	4117.67	-211.99	-362.83	566.26	40°23'38.577"N	104°12'37.560"W	0.00	
4317.00†	18.061	122.650	4212.74	-221.76	-379.56	592.36	40°23'38.412"N	104°12'37.222"W	0.00	
4417.00†	18.061	122.650	4307.81	-231.54	-396.28	618.47	40°23'38.246"N	104°12'36.885"W	0.00	
4517.00†	18.061	122.650	4402.89	-241.31	-413.01	644.57	40°23'38.081"N	104°12'36.547"W	0.00	
4617.00†	18.061	122.650	4497.96	-251.08	-429.73	670.67	40°23'37.916"N	104°12'36.210"W	0.00	
4717.00†	18.061	122.650	4593.03	-260.85	-446.46	696.78	40°23'37.751"N	104°12'35.873"W	0.00	
4817.00†	18.061	122.650	4688.10	-270.63	-463.19	722.88	40°23'37.585"N	104°12'35.535"W	0.00	
4917.00†	18.061	122.650	4783.18	-280.40	-479.91	748.98	40°23'37.420"N	104°12'35.198"W	0.00	
5017.00†	18.061	122.650	4878.25	-290.17	-496.64	775.09	40°23'37.255"N	104°12'34.861"W	0.00	
5117.00†	18.061	122.650	4973.32	-299.94	-513.36	801.19	40°23'37.089"N	104°12'34.523"W	0.00	
5217.00†	18.061	122.650	5068.40	-309.72	-530.09	827.30	40°23'36.924"N	104°12'34.186"W	0.00	
5317.00†	18.061	122.650	5163.47	-319.49	-546.82	853.40	40°23'36.759"N	104°12'33.849"W	0.00	
5417.00†	18.061	122.650	5258.54	-329.26	-563.54	879.50	40°23'36.594"N	104°12'33.511"W	0.00	
5517.00†	18.061	122.650	5353.61	-339.03	-580.27	905.61	40°23'36.428"N	104°12'33.174"W	0.00	
5617.00†	18.061	122.650	5448.69	-348.81	-596.99	931.71	40°23'36.263"N	104°12'32.836"W	0.00	
5649.24	18.061	122.650	5479.34	-351.96	-602.39	940.13	40°23'36.210"N	104°12'32.728"W	0.00	End of Tangent (XS)
5717.00†	15.769	100.559	5544.23	-354.67	-609.75	958.04	40°23'36.137"N	104°12'32.496"W	10.00	
5817.00†	17.259	65.223	5640.34	-344.42	-606.01	984.94	40°23'36.174"N	104°12'32.149"W	10.00	
5917.00†	23.282	41.790	5734.26	-317.48	-585.01	1011.65	40°23'36.381"N	104°12'31.803"W	10.00	
6017.00†	31.323	28.672	5823.12	-274.67	-547.37	1037.35	40°23'36.753"N	104°12'31.471"W	10.00	
6117.00†	40.184	20.681	5904.24	-217.28	-494.25	1061.28	40°23'37.278"N	104°12'31.162"W	10.00	
6217.00†	49.421	15.220	5975.14	-147.07	-427.25	1082.70	40°23'37.940"N	104°12'30.885"W	10.00	
6317.00†	58.852	11.106	6033.68	-66.17	-348.42	1100.95	40°23'38.719"N	104°12'30.649"W	10.00	
6417.00†	68.390	7.746	6078.07	22.97	-260.14	1115.50	40°23'39.592"N	104°12'30.461"W	10.00	
6517.00†	77.988	4.806	6106.96	117.63	-165.10	1125.89	40°23'40.531"N	104°12'30.327"W	10.00	
6617.00†	87.613	2.071	6119.48	214.94	-66.20	1131.81	40°23'41.508"N	104°12'30.250"W	10.00	
6641.78	90.000	1.405	6120.00 <sup>1</sup>	239.12	-41.44	1132.56	40°23'41.753"N	104°12'30.240"W	10.00	End of 3D Arc (XS)
6717.00†	90.000	1.405	6120.00	312.45	33.76	1134.40	40°23'42.496"N	104°12'30.216"W	0.00	
6817.00†	90.000	1.405	6120.00	409.94	133.73	1136.86	40°23'43.484"N	104°12'30.185"W	0.00	
6917.00†	90.000	1.405	6120.00	507.43	233.70	1139.31	40°23'44.472"N	104°12'30.153"W	0.00	
7017.00†	90.000	1.405	6120.00	604.92	333.67	1141.76	40°23'45.459"N	104°12'30.121"W	0.00	
7117.00†	90.000	1.405	6120.00	702.40	433.64	1144.21	40°23'46.447"N	104°12'30.089"W	0.00	
7217.00†	90.000	1.405	6120.00	799.89	533.61	1146.67	40°23'47.435"N	104°12'30.058"W	0.00	
7317.00†	90.000	1.405	6120.00	897.38	633.58	1149.12	40°23'48.423"N	104°12'30.026"W	0.00	
7417.00†	90.000	1.405	6120.00	994.87	733.55	1151.57	40°23'49.411"N	104°12'29.994"W	0.00	



WELLPATH DATA (122 stations) † = interpolated/extrapolated station										
MD [ft]	Inclination [°]	Azimuth [°]	TVD [ft]	Vert Sect [ft]	North [ft]	East [ft]	Latitude	Longitude	DLS [°/100ft]	Comments
7517.00†	90.000	1.405	6120.00	1092.35	833.52	1154.02	40°23'50.399"N	104°12'29.962"W	0.00	
7617.00†	90.000	1.405	6120.00	1189.84	933.49	1156.48	40°23'51.387"N	104°12'29.931"W	0.00	
7717.00†	90.000	1.405	6120.00	1287.33	1033.46	1158.93	40°23'52.374"N	104°12'29.899"W	0.00	
7817.00†	90.000	1.405	6120.00	1384.82	1133.43	1161.38	40°23'53.362"N	104°12'29.867"W	0.00	
7917.00†	90.000	1.405	6120.00	1482.30	1233.40	1163.83	40°23'54.350"N	104°12'29.835"W	0.00	
8017.00†	90.000	1.405	6120.00	1579.79	1333.37	1166.29	40°23'55.338"N	104°12'29.804"W	0.00	
8117.00†	90.000	1.405	6120.00	1677.28	1433.34	1168.74	40°23'56.326"N	104°12'29.772"W	0.00	
8217.00†	90.000	1.405	6120.00	1774.77	1533.31	1171.19	40°23'57.314"N	104°12'29.740"W	0.00	
8317.00†	90.000	1.405	6120.00	1872.26	1633.28	1173.64	40°23'58.302"N	104°12'29.708"W	0.00	
8417.00†	90.000	1.405	6120.00	1969.74	1733.25	1176.10	40°23'59.289"N	104°12'29.677"W	0.00	



Planned Wellpath Report

STATE PRONGHORN T44-P41-16HNB PWP (REV-A.0)

Page 4 of 6



REFERENCE WELLPATH IDENTIFICATION			
Operator	BONANZA CREEK OIL COMPANY	Slot	SLOT#05 STATE PRONGHORN T44-P41-16HNB (491'FSL & 2243'FEL,SEC.16)
Area	COLORADO	Well	STATE PRONGHORN T44-P41-16HNB
Field	WELD COUNTY	Wellbore	STATE PRONGHORN T44-P41-16HNB PWB
Facility	SEC.16-T05N-R61W		

WELLPATH DATA (122 stations) † = interpolated/extrapolated station										
MD [ft]	Inclination [°]	Azimuth [°]	TVD [ft]	Vert Sect [ft]	North [ft]	East [ft]	Latitude	Longitude	DLS [°/100ft]	Comments
8517.00†	90.000	1.405	6120.00	2067.23	1833.22	1178.55	40°24'00.277"N	104°12'29.645"W	0.00	
8617.00†	90.000	1.405	6120.00	2164.72	1933.19	1181.00	40°24'01.265"N	104°12'29.613"W	0.00	
8717.00†	90.000	1.405	6120.00	2262.21	2033.16	1183.45	40°24'02.253"N	104°12'29.581"W	0.00	
8817.00†	90.000	1.405	6120.00	2359.69	2133.13	1185.91	40°24'03.241"N	104°12'29.550"W	0.00	
8917.00†	90.000	1.405	6120.00	2457.18	2233.10	1188.36	40°24'04.229"N	104°12'29.518"W	0.00	
9017.00†	90.000	1.405	6120.00	2554.67	2333.07	1190.81	40°24'05.217"N	104°12'29.486"W	0.00	
9117.00†	90.000	1.405	6120.00	2652.16	2433.04	1193.26	40°24'06.205"N	104°12'29.454"W	0.00	
9217.00†	90.000	1.405	6120.00	2749.64	2533.01	1195.72	40°24'07.192"N	104°12'29.422"W	0.00	
9317.00†	90.000	1.405	6120.00	2847.13	2632.98	1198.17	40°24'08.180"N	104°12'29.391"W	0.00	
9417.00†	90.000	1.405	6120.00	2944.62	2732.95	1200.62	40°24'09.168"N	104°12'29.359"W	0.00	
9517.00†	90.000	1.405	6120.00	3042.11	2832.92	1203.07	40°24'10.156"N	104°12'29.327"W	0.00	
9617.00†	90.000	1.405	6120.00	3139.59	2932.89	1205.53	40°24'11.144"N	104°12'29.295"W	0.00	
9717.00†	90.000	1.405	6120.00	3237.08	3032.86	1207.98	40°24'12.132"N	104°12'29.264"W	0.00	
9817.00†	90.000	1.405	6120.00	3334.57	3132.83	1210.43	40°24'13.120"N	104°12'29.232"W	0.00	
9917.00†	90.000	1.405	6120.00	3432.06	3232.80	1212.88	40°24'14.107"N	104°12'29.200"W	0.00	
10017.00†	90.000	1.405	6120.00	3529.54	3332.77	1215.34	40°24'15.095"N	104°12'29.168"W	0.00	
10117.00†	90.000	1.405	6120.00	3627.03	3432.74	1217.79	40°24'16.083"N	104°12'29.137"W	0.00	
10217.00†	90.000	1.405	6120.00	3724.52	3532.71	1220.24	40°24'17.071"N	104°12'29.105"W	0.00	
10317.00†	90.000	1.405	6120.00	3822.01	3632.68	1222.69	40°24'18.059"N	104°12'29.073"W	0.00	
10417.00†	90.000	1.405	6120.00	3919.49	3732.65	1225.15	40°24'19.047"N	104°12'29.041"W	0.00	
10517.00†	90.000	1.405	6120.00	4016.98	3832.62	1227.60	40°24'20.035"N	104°12'29.010"W	0.00	
10617.00†	90.000	1.405	6120.00	4114.47	3932.59	1230.05	40°24'21.023"N	104°12'28.978"W	0.00	
10717.00†	90.000	1.405	6120.00	4211.96	4032.56	1232.50	40°24'22.010"N	104°12'28.946"W	0.00	
10817.00†	90.000	1.405	6120.00	4309.44	4132.53	1234.96	40°24'22.998"N	104°12'28.914"W	0.00	
10917.00†	90.000	1.405	6120.00	4406.93	4232.50	1237.41	40°24'23.986"N	104°12'28.882"W	0.00	
11017.00†	90.000	1.405	6120.00	4504.42	4332.47	1239.86	40°24'24.974"N	104°12'28.851"W	0.00	
11117.00†	90.000	1.405	6120.00	4601.91	4432.44	1242.31	40°24'25.962"N	104°12'28.819"W	0.00	
11217.00†	90.000	1.405	6120.00	4699.39	4532.41	1244.77	40°24'26.950"N	104°12'28.787"W	0.00	
11317.00†	90.000	1.405	6120.00	4796.88	4632.38	1247.22	40°24'27.938"N	104°12'28.755"W	0.00	
11417.00†	90.000	1.405	6120.00	4894.37	4732.35	1249.67	40°24'28.925"N	104°12'28.724"W	0.00	
11517.00†	90.000	1.405	6120.00	4991.86	4832.32	1252.12	40°24'29.913"N	104°12'28.692"W	0.00	
11615.09	90.000	1.405	6120.00 <sup>2</sup>	5087.48	4930.38	1254.53	40°24'30.882"N	104°12'28.661"W	0.00	End of Tangent (XS)



HOLE & CASING SECTIONS - Ref Wellbore: STATE PRONGHORN T44-P41-16HNB PWB      Ref Wellpath: STATE PRONGHORN T44-P41-16HNB PWP (REV-A.0)									
String/Diameter	Start MD [ft]	End MD [ft]	Interval [ft]	Start TVD [ft]	End TVD [ft]	Start N/S [ft]	Start E/W [ft]	End N/S [ft]	End E/W [ft]
13.5in Open Hole	17.00	1550.00	1533.00	17.00	1550.00	0.00	0.00	0.00	0.00
9.625in Casing Surface	17.00	1550.00	1533.00	17.00	1550.00	0.00	0.00	0.00	0.00
8.5in Open Hole	1550.00	11615.09	10065.09	1550.00	N/A	0.00	0.00	N/A	N/A



# Planned Wellpath Report

STATE PRONGHORN T44-P41-16HNB PWP (REV-A.0)

Page 5 of 6



REFERENCE WELLPATH IDENTIFICATION			
Operator	BONANZA CREEK OIL COMPANY	Slot	SLOT#05 STATE PRONGHORN T44-P41-16HNB (491'FSL & 2243'FEL,SEC.16)
Area	COLORADO	Well	STATE PRONGHORN T44-P41-16HNB
Field	WELD COUNTY	Wellbore	STATE PRONGHORN T44-P41-16HNB PWB
Facility	SEC.16-T05N-R61W		

TARGETS									
Name	MD [ft]	TVD [ft]	North [ft]	East [ft]	Grid East [US ft]	Grid North [US ft]	Latitude	Longitude	Shape
SEC.16-T05N-R61W		-12.00	-934.29	2854.19	3361472.47	1388466.09	40°23'32.928"N	104°12'07.991"W	polygon
2) STATE PRONGHORN T44-P41-16HNB BHL ON PLAT (100'FSL & 1035'FEL,SEC.09)	11615.09	6120.00	4930.38	1254.53	3359787.89	1394306.67	40°24'30.882"N	104°12'28.661"W	point
1) STATE PRONGHORN T44-P41-16HNB LP ON PLAT (470'FSL & 1110'FEL,SEC.16)	6641.78	6120.00	-41.44	1132.56	3359738.12	1389333.82	40°23'41.753"N	104°12'30.240"W	point

SURVEY PROGRAM - Ref Wellbore: STATE PRONGHORN T44-P41-16HNB PWB    Ref Wellpath: STATE PRONGHORN T44-P41-16HNB PWP (REV-A.0)				
Start MD [ft]	End MD [ft]	Positional Uncertainty Model	Log Name/Comment	Wellbore
17.00	1550.00	BHI NaviTrak (Rotating+Axial Corr)		STATE PRONGHORN T44-P41-16HNB PWB
1550.00	11615.09	BHI AutoTrak Curve (Axial Corr, Short spacing)		STATE PRONGHORN T44-P41-16HNB PWB



Planned Wellpath Report

STATE PRONGHORN T44-P41-16HNB PWP (REV-A.0)

Page 6 of 6



REFERENCE WELLPATH IDENTIFICATION			
Operator	BONANZA CREEK OIL COMPANY	Slot	SLOT#05 STATE PRONGHORN T44-P41-16HNB (491'FSL & 2243'FEL,SEC.16)
Area	COLORADO	Well	STATE PRONGHORN T44-P41-16HNB
Field	WELD COUNTY	Wellbore	STATE PRONGHORN T44-P41-16HNB PWB
Facility	SEC.16-T05N-R61W		

DESIGN COMMENTS				
MD [ft]	Inclination [°]	Azimuth [°]	TVD [ft]	Comment
17.00	0.000	122.650	17.00	Tie On
1600.00	0.000	122.650	1600.00	End of Tangent
2503.04	18.061	122.650	2488.16	End of Build (XS)
5649.24	18.061	122.650	5479.34	End of Tangent (XS)
6641.78	90.000	1.405	6120.00	End of 3D Arc (XS)
11615.09	90.000	1.405	6120.00	End of Tangent (XS)