

Section 12
T. 6 S., R. 94 W.

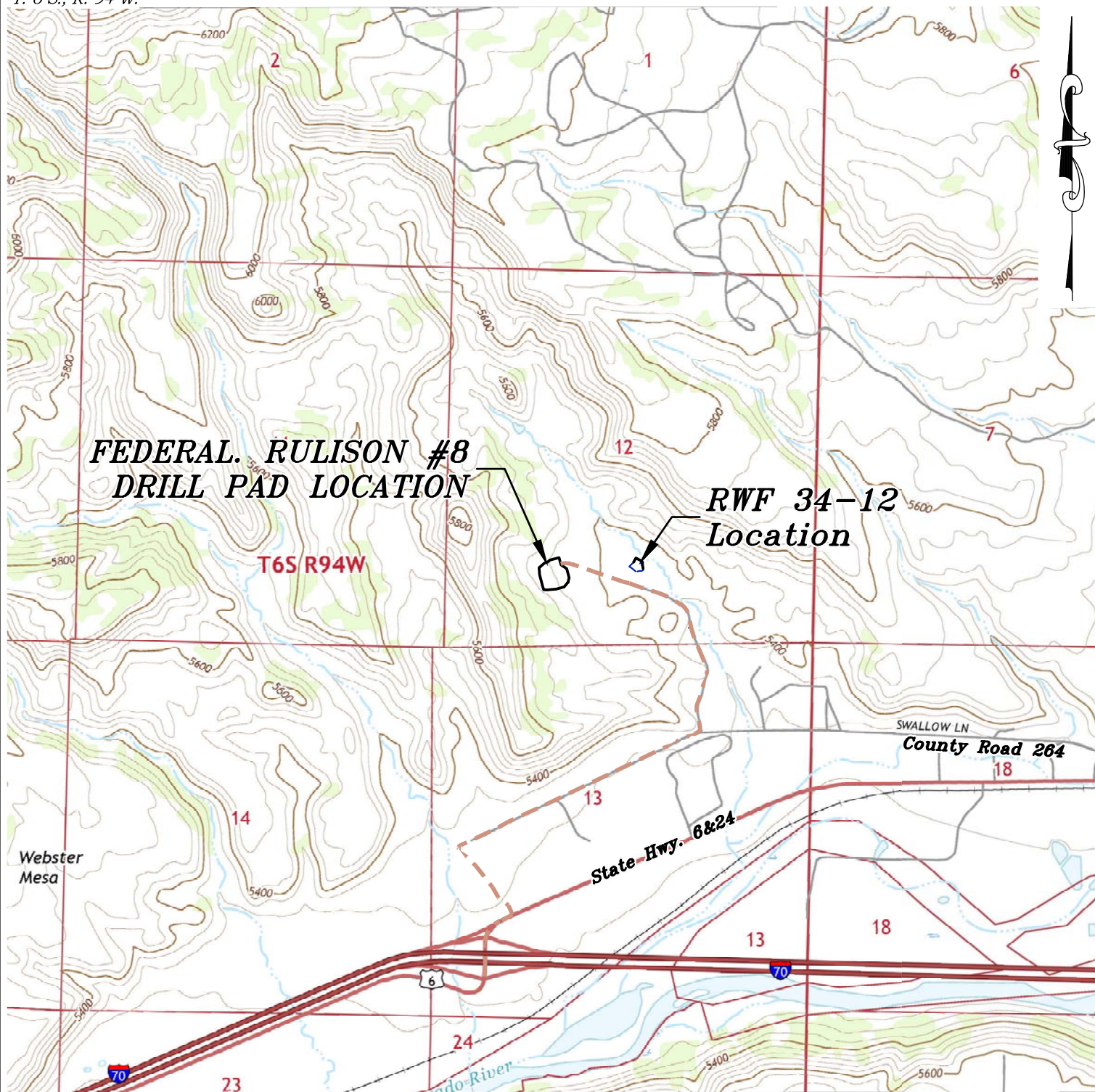

EXISTING ROAD - - - - -

0 1000 2000
GRAPHIC SCALE IN FEET
1 INCH = 2000 FEET

ACCESS DESCRIPTION:

FROM THE I-70 EXIT No. 87 (WEST RIFLE), PROCEED NORTH ALONG STATE HIGHWAY 6 ± 0.2 MILES TO AN INTERSECTION WITH A DIRT/GRAVEL ROAD, PROCEED LEFT IN A NORTHWESTERLY DIRECTION ± 0.2 MILES TO A THREE-WAY INTERSECTION WITH A DIRT/GRAVEL ROAD, PROCEED RIGHT IN A NORTHEASTERLY DIRECTION ± 0.7 MILES TO AN INTERSECTION WITH A DIRTY/GRAVEL ROAD, PROCEED LEFT IN A NORTHERLY DIRECTION ± 0.5 MILES TO A THREE-WAY INTERSECTION, STAY LEFT IN AN EASTERLY DIRECTION ± 0.2 MILES TO THE EXISTING FEDERAL RULISON #8 DRILL PAD LOCATION, AS SHOWN HEREON.

REVISED: 6/13/19

136 East Third Street
Rifle, Colorado 81650
Ph. (970) 625-2720
Fax (970) 625-2773



BOOKCLIFF
Survey Services, Inc.

SCALE: 1" = 2000'
DATE: 5/23/19
PLAT: 5 of 8
PROJECT: TEP Valley
DFT: cs

Construction Plan Prepared for:



TEP Rocky Mountain LLC

*Federal Rulison #8 Drill Pad - Plat 5
ACCESS ROAD & TOPO MAP*