

Gulf Exploration L.L.C.
PRODUCTION FACILITY LAYOUT
Eagle Hill #1-32
NW1/4NE1/4 of Section 32, T10N,
R78W, 6th P.M., Jackson County, Colorado

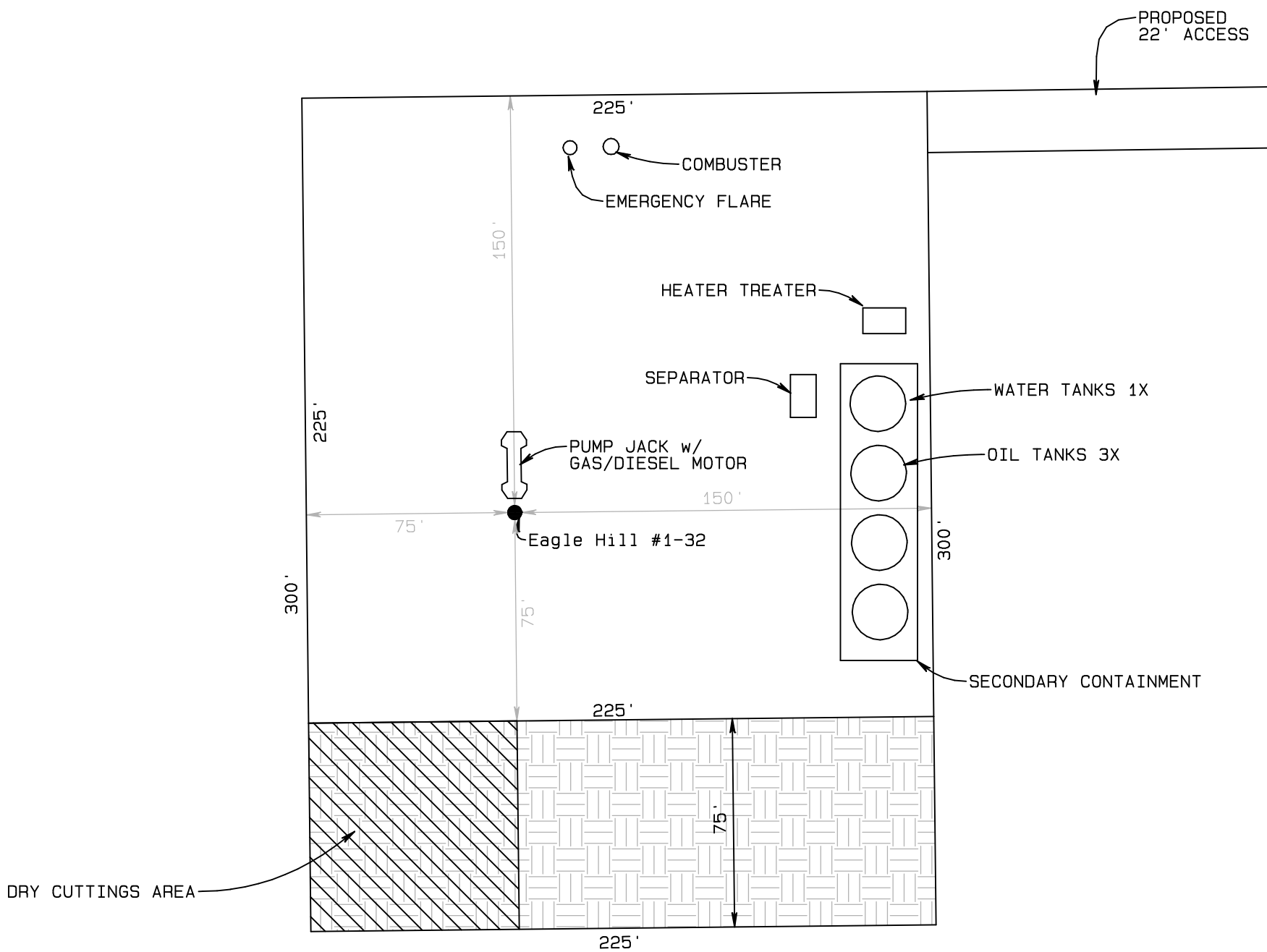

DRILLING PAD AREA = $(225' \times 300') / 43560 = 1.55$ Acres
RECLAIMED AREA = $(75' \times 225') / 43560 = 0.39$ Acres

NET PRODUCTION PAD = 1.16 Acres

