

# Hydrology Map A, with Topo

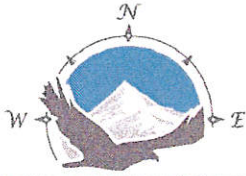

## FRANE SURVEYING INC.

Physical Address: 34834 Annie Cir.  
Mail to: Box 2372, Elizabeth, CO 80107  
Ph. 303-243-0037  
www.franesurveying.com

Job # 19-025-ALC-1545 #1-27

Frane Surveying, in accordance with a request from **McCoy Petroleum Corporation** has determined the location of **ALC 1545 #1-27** to be **660 Feet FSL**, and **660 Feet FEL**, (90° off Section lines) of Section **27**, Township **15s**, Range **45w** of the 6th Principal Meridian, **Cheyenne County**, Colorado.

Date: Staked on 02/20/19 drawn on 02/25/19.

Re: Staked by Elijah Frane  
Drawn: Drawn by Elijah Frane

## 1000' HYDROLOGY MAP

THERE ARE NO APPARENT SURFACE WATER OR RIPARIAN AREAS WITHIN 1000' OF THE PROPOSED WELL PAD.

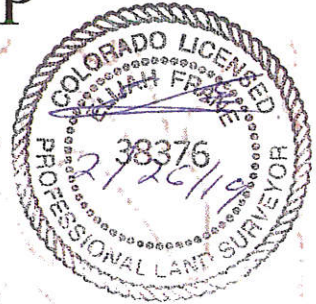

27

McCoy Petroleum Corp.  
ALC 1545 #1-27  
SE 1/4 Sec. 27-15S-45W  
Cheyenne, CO, Colorado

