

Location Drawing

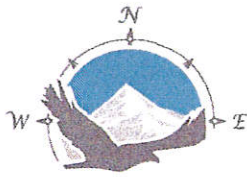

FRANE SURVEYING INC.

Physical Address: 34834 Annie Cir.
Mail to: Box 2372, Elizabeth, CO 80107
Ph. 303-243-0037
www.franesurveying.com

Job # 19-025-ALC-1545 #1-27

Frane Surveying, in accordance with a request from **McCoy Petroleum Corporation** has determined the location of **ALC 1545 #1-27** to be **660 Feet FSL**, and **660 Feet FEL**, (90° off Section lines) of Section **27**, Township **15s**, Range **45w** of the 6th Principal Meridian, **Cheyenne County**, Colorado.

Date: Staked on 02/20/19 drawn on 02/25/19.

Re: Staked by Elijah Frane
Drawn: Drawn by Elijah Frane

LOCATION DRAWING

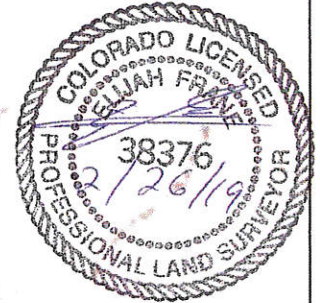

The North ROW of C.R. H falls approx. 380' South, a Powerline falls approx. 440' South, The West ROW of C.R. 40 falls approx. 380' East and a Powerline falls approx. 440' East of proposed well pad.



SCALE: 1" = 400'

McCoy Petroleum Corp.
ALC 1545 #1-27
SE 1/4 Sec. 27-15S-45W
Cheyenne, CO, Colorado

