



PROJECT DETAILS: Weld County, CO NAD 83

Geodetic System: US State Plane 1983
Datum: North American Datum 1983
Ellipsoid: GRS 1980
Zone: Colorado Northern Zone
System Datum: Mean Sea Level
Local North: True

Project: Weld County, CO NAD 83
Site: Fox Creek 25 SW Pad
Well: Fox Creek 36-0362B
Wellbore: OH
Design: Plan 1



Azimuths to True North
Magnetic North: 8.28°

Magnetic Field
Strength: 52808.0snT
Dip Angle: 67.28°
Date: 10/17/2018
Model: HDGM



Plan: Plan 1 (Fox Creek 36-0362B/OH)

Created By: Seth Burstad

SECTION DETAILS

MD	Inc	Azi	TVD	+N/-S	+E/-W	Dleg	TFace	VSect
0.00	0.00	0.000	0.00	0.00	0.00	0.00	0.00	0.00
500.00	0.00	0.000	500.00	0.00	0.00	0.00	0.00	0.00
750.00	5.00	66.500	749.68	4.35	10.00	2.00	66.50	-4.32
1703.95	5.00	66.500	1700.00	37.50	86.24	0.00	0.00	-37.29
2093.61	2.79	245.999	2089.29	40.41	93.15	2.00	179.82	-40.19
2393.63	2.79	245.999	2388.96	34.47	79.80	0.00	0.00	-34.27
2579.85	0.00	0.000	2575.10	32.62	75.65	1.50	180.00	-32.44
6881.79	0.00	0.000	6877.04	32.62	75.65	0.00	0.00	-32.44
7781.79	90.00	179.860	7450.00	-540.34	77.05	10.00	179.86	540.52
18199.58	90.00	179.860	7450.00	-10958.10	102.50	0.00	0.00	10958.31

WELL DETAILS: Fox Creek 36-0362B

GL 5412' & KB 20' @ 5432.00ft 5412.00
+N/-S +E/-W Northing Easting Latitude Longitude
0.00 0.00 1599788.22 3307633.06 40° 58' 28.103 N 104° 23' 9.470 W

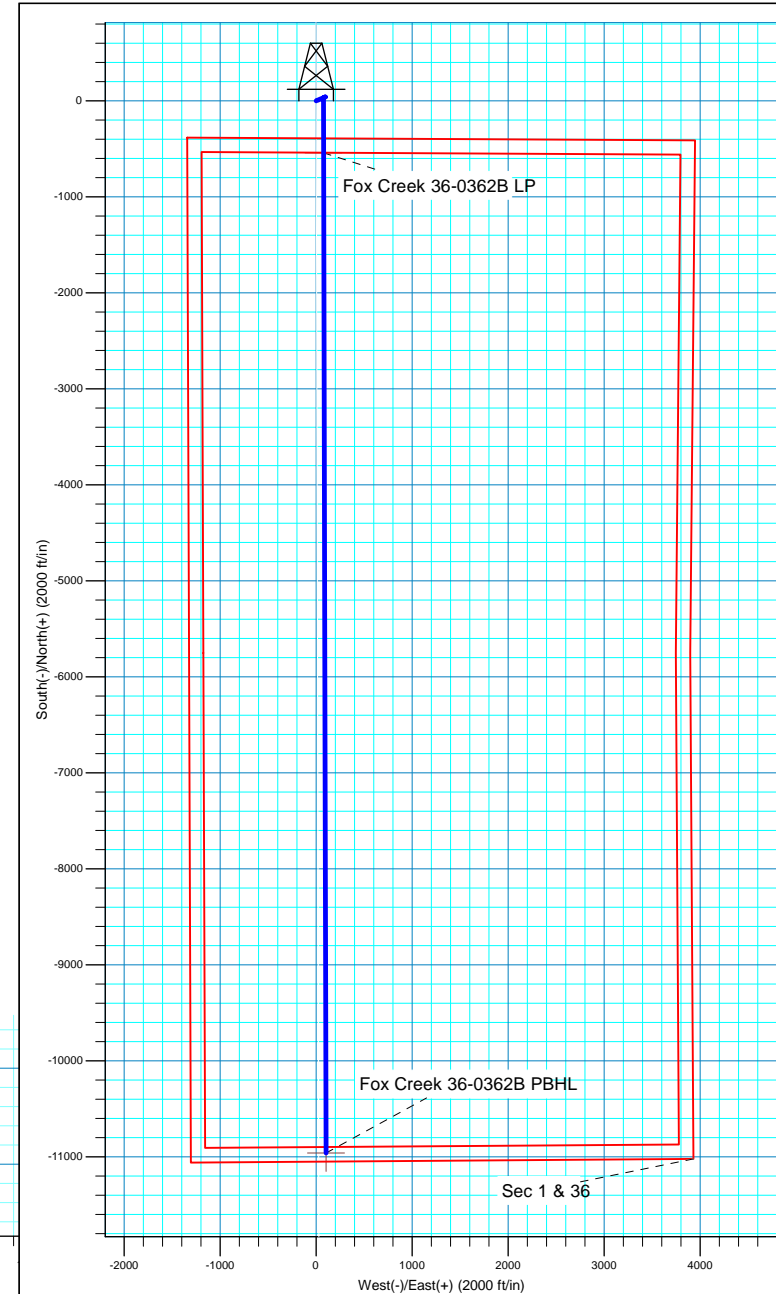
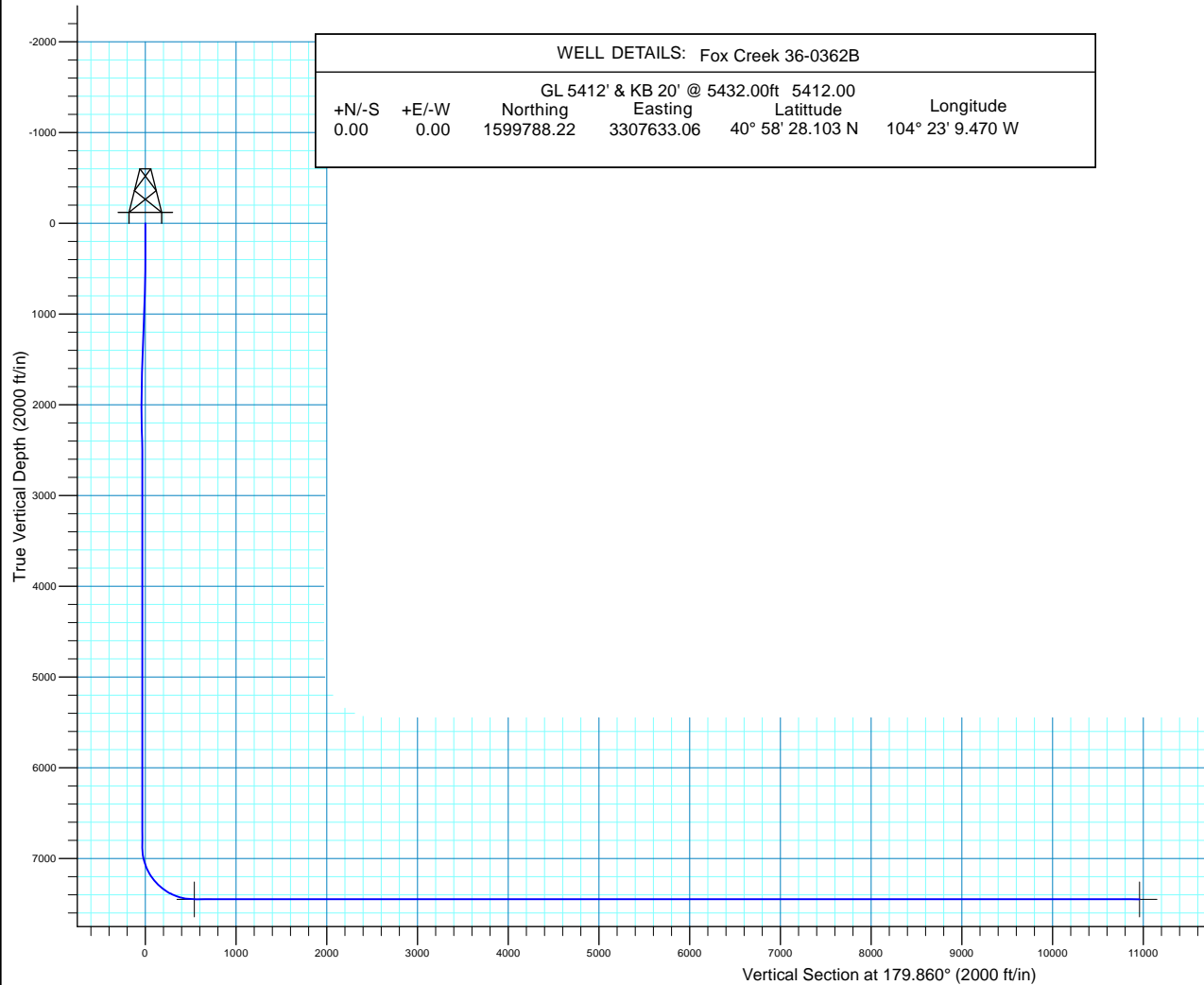



HighPoint Resources

Weld County, CO NAD 83

Fox Creek 25 SW Pad

Fox Creek 36-0362B

OH

Plan: Plan 1

Standard Planning Report

17 October, 2018



Database:	Casper District	Local Co-ordinate Reference:	Well Fox Creek 36-0362B
Company:	HighPoint Resources	TVD Reference:	GL 5412' & KB 20' @ 5432.00ft
Project:	Weld County, CO NAD 83	MD Reference:	GL 5412' & KB 20' @ 5432.00ft
Site:	Fox Creek 25 SW Pad	North Reference:	True
Well:	Fox Creek 36-0362B	Survey Calculation Method:	Minimum Curvature
Wellbore:	OH		
Design:	Plan 1		

Project	Weld County, CO NAD 83		
Map System:	US State Plane 1983	System Datum:	Mean Sea Level
Geo Datum:	North American Datum 1983		
Map Zone:	Colorado Northern Zone		

Site	Fox Creek 25 SW Pad, Site Center : Fox Creek 25-6104B				
Site Position:		Northing:	1,599,789.47 usft	Latitude:	40° 58' 28.092 N
From:	Lat/Long	Easting:	3,307,818.08 usft	Longitude:	104° 23' 7.058 W
Position Uncertainty:	0.00 ft	Slot Radius:	13.200 in	Grid Convergence:	0.72 °

Well	Fox Creek 36-0362B, 390' FSL 1341' FWL Sec 25 T12N R63W					
Well Position	+N/-S	1.08 ft	Northing:	1,599,788.22 usft	Latitude:	40° 58' 28.103 N
	+E/-W	-185.02 ft	Easting:	3,307,633.06 usft	Longitude:	104° 23' 9.470 W
Position Uncertainty		0.00 ft	Wellhead Elevation:	0.00 ft	Ground Level:	5,412.00 ft

Wellbore	OH				
Magnetics	Model Name	Sample Date	Declination (°)	Dip Angle (°)	Field Strength (nT)
	HDGM	10/17/2018	8.28	67.28	52,808

Design	Plan 1			
Audit Notes:				
Version:	Phase:	PLAN	Tie On Depth:	0.00
Vertical Section:	Depth From (TVD) (ft)	+N/-S (ft)	+E/-W (ft)	Direction (°)
	0.00	0.00	0.00	179.860

Plan Sections										
Measured Depth (ft)	Inclination (°)	Azimuth (°)	Vertical Depth (ft)	+N/-S (ft)	+E/-W (ft)	Dogleg Rate (°/100ft)	Build Rate (°/100ft)	Turn Rate (°/100ft)	TFO (°)	Target
0.00	0.00	0.000	0.00	0.00	0.00	0.00	0.00	0.00	0.00	
500.00	0.00	0.000	500.00	0.00	0.00	0.00	0.00	0.00	0.00	
750.00	5.00	66.500	749.68	4.35	10.00	2.00	2.00	0.00	66.50	
1,703.95	5.00	66.500	1,700.00	37.50	86.24	0.00	0.00	0.00	0.00	
2,093.61	2.79	245.999	2,089.29	40.41	93.15	2.00	-0.57	46.07	179.82	
2,393.63	2.79	245.999	2,388.96	34.47	79.80	0.00	0.00	0.00	0.00	
2,579.85	0.00	0.000	2,575.10	32.62	75.65	1.50	-1.50	0.00	180.00	
6,881.79	0.00	0.000	6,877.04	32.62	75.65	0.00	0.00	0.00	0.00	
7,781.79	90.00	179.860	7,450.00	-540.34	77.05	10.00	10.00	19.98	179.86	
18,199.59	90.00	179.860	7,450.00	-10,958.10	102.50	0.00	0.00	0.00	0.00	Fox Creek 36-0362B

Database:	Casper District	Local Co-ordinate Reference:	Well Fox Creek 36-0362B
Company:	HighPoint Resources	TVD Reference:	GL 5412' & KB 20' @ 5432.00ft
Project:	Weld County, CO NAD 83	MD Reference:	GL 5412' & KB 20' @ 5432.00ft
Site:	Fox Creek 25 SW Pad	North Reference:	True
Well:	Fox Creek 36-0362B	Survey Calculation Method:	Minimum Curvature
Wellbore:	OH		
Design:	Plan 1		

Planned Survey									
Measured Depth (ft)	Inclination (°)	Azimuth (°)	Vertical Depth (ft)	+N/-S (ft)	+E/-W (ft)	Vertical Section (ft)	Dogleg Rate (°/100ft)	Build Rate (°/100ft)	Turn Rate (°/100ft)
0.00	0.00	0.000	0.00	0.00	0.00	0.00	0.00	0.00	0.00
100.00	0.00	0.000	100.00	0.00	0.00	0.00	0.00	0.00	0.00
200.00	0.00	0.000	200.00	0.00	0.00	0.00	0.00	0.00	0.00
300.00	0.00	0.000	300.00	0.00	0.00	0.00	0.00	0.00	0.00
400.00	0.00	0.000	400.00	0.00	0.00	0.00	0.00	0.00	0.00
500.00	0.00	0.000	500.00	0.00	0.00	0.00	0.00	0.00	0.00
Start Build 2.00									
600.00	2.00	66.500	599.98	0.70	1.60	-0.69	2.00	2.00	0.00
700.00	4.00	66.500	699.84	2.78	6.40	-2.77	2.00	2.00	0.00
750.00	5.00	66.500	749.68	4.35	10.00	-4.32	2.00	2.00	0.00
Start 953.95 hold at 750.00 MD									
800.00	5.00	66.500	799.49	6.08	13.99	-6.05	0.00	0.00	0.00
900.00	5.00	66.500	899.11	9.56	21.99	-9.51	0.00	0.00	0.00
1,000.00	5.00	66.500	998.73	13.04	29.98	-12.96	0.00	0.00	0.00
1,100.00	5.00	66.500	1,098.35	16.51	37.97	-16.42	0.00	0.00	0.00
1,200.00	5.00	66.500	1,197.97	19.99	45.96	-19.87	0.00	0.00	0.00
1,300.00	5.00	66.500	1,297.59	23.46	53.96	-23.33	0.00	0.00	0.00
1,400.00	5.00	66.500	1,397.21	26.94	61.95	-26.79	0.00	0.00	0.00
1,500.00	5.00	66.500	1,496.83	30.41	69.94	-30.24	0.00	0.00	0.00
1,600.00	5.00	66.500	1,596.45	33.89	77.94	-33.70	0.00	0.00	0.00
1,700.00	5.00	66.500	1,696.07	37.36	85.93	-37.15	0.00	0.00	0.00
1,703.95	5.00	66.500	1,700.00	37.50	86.24	-37.29	0.00	0.00	0.00
Start DLS 2.00 TFO 179.82									
1,800.00	3.08	66.612	1,795.81	40.19	92.45	-39.97	2.00	-2.00	0.12
1,900.00	1.08	67.154	1,895.74	41.62	95.78	-41.39	2.00	-2.00	0.54
2,000.00	0.92	245.344	1,995.73	41.65	95.92	-41.42	2.00	-0.16	178.19
2,093.61	2.79	245.999	2,089.29	40.41	93.15	-40.19	2.00	2.00	0.70
Start 300.03 hold at 2093.61 MD									
2,100.00	2.79	245.999	2,095.67	40.29	92.87	-40.06	0.00	0.00	0.00
2,200.00	2.79	245.999	2,195.55	38.30	88.42	-38.09	0.00	0.00	0.00
2,300.00	2.79	245.999	2,295.44	36.32	83.96	-36.12	0.00	0.00	0.00
2,393.63	2.79	245.999	2,388.96	34.47	79.80	-34.27	0.00	0.00	0.00
Start Drop -1.50									
2,400.00	2.70	245.999	2,395.32	34.34	79.52	-34.15	1.50	-1.50	0.00
2,500.00	1.20	245.999	2,495.26	32.96	76.41	-32.77	1.50	-1.50	0.00
2,579.85	0.00	0.000	2,575.10	32.62	75.65	-32.44	1.50	-1.50	0.00
Start 4301.94 hold at 2579.85 MD									
2,600.00	0.00	0.000	2,595.25	32.62	75.65	-32.44	0.00	0.00	0.00
2,700.00	0.00	0.000	2,695.25	32.62	75.65	-32.44	0.00	0.00	0.00
2,800.00	0.00	0.000	2,795.25	32.62	75.65	-32.44	0.00	0.00	0.00
2,900.00	0.00	0.000	2,895.25	32.62	75.65	-32.44	0.00	0.00	0.00
3,000.00	0.00	0.000	2,995.25	32.62	75.65	-32.44	0.00	0.00	0.00
3,100.00	0.00	0.000	3,095.25	32.62	75.65	-32.44	0.00	0.00	0.00
3,200.00	0.00	0.000	3,195.25	32.62	75.65	-32.44	0.00	0.00	0.00
3,300.00	0.00	0.000	3,295.25	32.62	75.65	-32.44	0.00	0.00	0.00
3,400.00	0.00	0.000	3,395.25	32.62	75.65	-32.44	0.00	0.00	0.00
3,500.00	0.00	0.000	3,495.25	32.62	75.65	-32.44	0.00	0.00	0.00
3,600.00	0.00	0.000	3,595.25	32.62	75.65	-32.44	0.00	0.00	0.00
3,700.00	0.00	0.000	3,695.25	32.62	75.65	-32.44	0.00	0.00	0.00
3,800.00	0.00	0.000	3,795.25	32.62	75.65	-32.44	0.00	0.00	0.00
3,900.00	0.00	0.000	3,895.25	32.62	75.65	-32.44	0.00	0.00	0.00
4,000.00	0.00	0.000	3,995.25	32.62	75.65	-32.44	0.00	0.00	0.00
4,100.00	0.00	0.000	4,095.25	32.62	75.65	-32.44	0.00	0.00	0.00

Database:	Casper District	Local Co-ordinate Reference:	Well Fox Creek 36-0362B
Company:	HighPoint Resources	TVD Reference:	GL 5412' & KB 20' @ 5432.00ft
Project:	Weld County, CO NAD 83	MD Reference:	GL 5412' & KB 20' @ 5432.00ft
Site:	Fox Creek 25 SW Pad	North Reference:	True
Well:	Fox Creek 36-0362B	Survey Calculation Method:	Minimum Curvature
Wellbore:	OH		
Design:	Plan 1		

Planned Survey									
Measured Depth (ft)	Inclination (°)	Azimuth (°)	Vertical Depth (ft)	+N/-S (ft)	+E/-W (ft)	Vertical Section (ft)	Dogleg Rate (°/100ft)	Build Rate (°/100ft)	Turn Rate (°/100ft)
4,200.00	0.00	0.000	4,195.25	32.62	75.65	-32.44	0.00	0.00	0.00
4,300.00	0.00	0.000	4,295.25	32.62	75.65	-32.44	0.00	0.00	0.00
4,400.00	0.00	0.000	4,395.25	32.62	75.65	-32.44	0.00	0.00	0.00
4,500.00	0.00	0.000	4,495.25	32.62	75.65	-32.44	0.00	0.00	0.00
4,600.00	0.00	0.000	4,595.25	32.62	75.65	-32.44	0.00	0.00	0.00
4,700.00	0.00	0.000	4,695.25	32.62	75.65	-32.44	0.00	0.00	0.00
4,800.00	0.00	0.000	4,795.25	32.62	75.65	-32.44	0.00	0.00	0.00
4,900.00	0.00	0.000	4,895.25	32.62	75.65	-32.44	0.00	0.00	0.00
5,000.00	0.00	0.000	4,995.25	32.62	75.65	-32.44	0.00	0.00	0.00
5,100.00	0.00	0.000	5,095.25	32.62	75.65	-32.44	0.00	0.00	0.00
5,200.00	0.00	0.000	5,195.25	32.62	75.65	-32.44	0.00	0.00	0.00
5,300.00	0.00	0.000	5,295.25	32.62	75.65	-32.44	0.00	0.00	0.00
5,400.00	0.00	0.000	5,395.25	32.62	75.65	-32.44	0.00	0.00	0.00
5,500.00	0.00	0.000	5,495.25	32.62	75.65	-32.44	0.00	0.00	0.00
5,600.00	0.00	0.000	5,595.25	32.62	75.65	-32.44	0.00	0.00	0.00
5,700.00	0.00	0.000	5,695.25	32.62	75.65	-32.44	0.00	0.00	0.00
5,800.00	0.00	0.000	5,795.25	32.62	75.65	-32.44	0.00	0.00	0.00
5,900.00	0.00	0.000	5,895.25	32.62	75.65	-32.44	0.00	0.00	0.00
6,000.00	0.00	0.000	5,995.25	32.62	75.65	-32.44	0.00	0.00	0.00
6,100.00	0.00	0.000	6,095.25	32.62	75.65	-32.44	0.00	0.00	0.00
6,200.00	0.00	0.000	6,195.25	32.62	75.65	-32.44	0.00	0.00	0.00
6,300.00	0.00	0.000	6,295.25	32.62	75.65	-32.44	0.00	0.00	0.00
6,400.00	0.00	0.000	6,395.25	32.62	75.65	-32.44	0.00	0.00	0.00
6,500.00	0.00	0.000	6,495.25	32.62	75.65	-32.44	0.00	0.00	0.00
6,600.00	0.00	0.000	6,595.25	32.62	75.65	-32.44	0.00	0.00	0.00
6,700.00	0.00	0.000	6,695.25	32.62	75.65	-32.44	0.00	0.00	0.00
6,800.00	0.00	0.000	6,795.25	32.62	75.65	-32.44	0.00	0.00	0.00
6,881.79	0.00	0.000	6,877.04	32.62	75.65	-32.44	0.00	0.00	0.00
Start DLS 10.00 TFO 179.86									
6,900.00	1.82	179.860	6,895.25	32.33	75.65	-32.15	10.00	10.00	0.00
7,000.00	11.82	179.860	6,994.41	20.47	75.68	-20.28	10.00	10.00	0.00
7,100.00	21.82	179.860	7,090.01	-8.43	75.75	8.62	10.00	10.00	0.00
7,200.00	31.82	179.860	7,179.14	-53.50	75.86	53.68	10.00	10.00	0.00
7,300.00	41.82	179.860	7,259.09	-113.35	76.01	113.54	10.00	10.00	0.00
7,400.00	51.82	179.860	7,327.43	-186.18	76.18	186.37	10.00	10.00	0.00
7,500.00	61.82	179.860	7,382.09	-269.77	76.39	269.96	10.00	10.00	0.00
7,600.00	71.82	179.860	7,421.40	-361.58	76.61	361.77	10.00	10.00	0.00
7,700.00	81.82	179.860	7,444.17	-458.82	76.85	459.01	10.00	10.00	0.00
7,781.79	90.00	179.860	7,450.00	-540.34	77.05	540.52	10.00	10.00	0.00
Start 10417.80 hold at 7781.79 MD									
7,800.00	90.00	179.860	7,450.00	-558.55	77.09	558.73	0.00	0.00	0.00
7,900.00	90.00	179.860	7,450.00	-658.55	77.34	658.73	0.00	0.00	0.00
8,000.00	90.00	179.860	7,450.00	-758.55	77.58	758.73	0.00	0.00	0.00
8,100.00	90.00	179.860	7,450.00	-858.55	77.83	858.73	0.00	0.00	0.00
8,200.00	90.00	179.860	7,450.00	-958.54	78.07	958.73	0.00	0.00	0.00
8,300.00	90.00	179.860	7,450.00	-1,058.54	78.32	1,058.73	0.00	0.00	0.00
8,400.00	90.00	179.860	7,450.00	-1,158.54	78.56	1,158.73	0.00	0.00	0.00
8,500.00	90.00	179.860	7,450.00	-1,258.54	78.80	1,258.73	0.00	0.00	0.00
8,600.00	90.00	179.860	7,450.00	-1,358.54	79.05	1,358.73	0.00	0.00	0.00
8,700.00	90.00	179.860	7,450.00	-1,458.54	79.29	1,458.73	0.00	0.00	0.00
8,800.00	90.00	179.860	7,450.00	-1,558.54	79.54	1,558.73	0.00	0.00	0.00
8,900.00	90.00	179.860	7,450.00	-1,658.54	79.78	1,658.73	0.00	0.00	0.00
9,000.00	90.00	179.860	7,450.00	-1,758.54	80.03	1,758.73	0.00	0.00	0.00
9,100.00	90.00	179.860	7,450.00	-1,858.54	80.27	1,858.73	0.00	0.00	0.00

Database:	Casper District	Local Co-ordinate Reference:	Well Fox Creek 36-0362B
Company:	HighPoint Resources	TVD Reference:	GL 5412' & KB 20' @ 5432.00ft
Project:	Weld County, CO NAD 83	MD Reference:	GL 5412' & KB 20' @ 5432.00ft
Site:	Fox Creek 25 SW Pad	North Reference:	True
Well:	Fox Creek 36-0362B	Survey Calculation Method:	Minimum Curvature
Wellbore:	OH		
Design:	Plan 1		

Planned Survey									
Measured Depth (ft)	Inclination (°)	Azimuth (°)	Vertical Depth (ft)	+N/-S (ft)	+E/-W (ft)	Vertical Section (ft)	Dogleg Rate (°/100ft)	Build Rate (°/100ft)	Turn Rate (°/100ft)
9,200.00	90.00	179.860	7,450.00	-1,958.54	80.51	1,958.73	0.00	0.00	0.00
9,300.00	90.00	179.860	7,450.00	-2,058.54	80.76	2,058.73	0.00	0.00	0.00
9,400.00	90.00	179.860	7,450.00	-2,158.54	81.00	2,158.73	0.00	0.00	0.00
9,500.00	90.00	179.860	7,450.00	-2,258.54	81.25	2,258.73	0.00	0.00	0.00
9,600.00	90.00	179.860	7,450.00	-2,358.54	81.49	2,358.73	0.00	0.00	0.00
9,700.00	90.00	179.860	7,450.00	-2,458.54	81.74	2,458.73	0.00	0.00	0.00
9,800.00	90.00	179.860	7,450.00	-2,558.54	81.98	2,558.73	0.00	0.00	0.00
9,900.00	90.00	179.860	7,450.00	-2,658.54	82.22	2,658.73	0.00	0.00	0.00
10,000.00	90.00	179.860	7,450.00	-2,758.54	82.47	2,758.73	0.00	0.00	0.00
10,100.00	90.00	179.860	7,450.00	-2,858.54	82.71	2,858.73	0.00	0.00	0.00
10,200.00	90.00	179.860	7,450.00	-2,958.54	82.96	2,958.73	0.00	0.00	0.00
10,300.00	90.00	179.860	7,450.00	-3,058.54	83.20	3,058.73	0.00	0.00	0.00
10,400.00	90.00	179.860	7,450.00	-3,158.54	83.45	3,158.73	0.00	0.00	0.00
10,500.00	90.00	179.860	7,450.00	-3,258.54	83.69	3,258.73	0.00	0.00	0.00
10,600.00	90.00	179.860	7,450.00	-3,358.54	83.93	3,358.73	0.00	0.00	0.00
10,700.00	90.00	179.860	7,450.00	-3,458.54	84.18	3,458.73	0.00	0.00	0.00
10,800.00	90.00	179.860	7,450.00	-3,558.54	84.42	3,558.73	0.00	0.00	0.00
10,900.00	90.00	179.860	7,450.00	-3,658.54	84.67	3,658.73	0.00	0.00	0.00
11,000.00	90.00	179.860	7,450.00	-3,758.54	84.91	3,758.73	0.00	0.00	0.00
11,100.00	90.00	179.860	7,450.00	-3,858.54	85.16	3,858.73	0.00	0.00	0.00
11,200.00	90.00	179.860	7,450.00	-3,958.54	85.40	3,958.73	0.00	0.00	0.00
11,300.00	90.00	179.860	7,450.00	-4,058.54	85.64	4,058.73	0.00	0.00	0.00
11,400.00	90.00	179.860	7,450.00	-4,158.54	85.89	4,158.73	0.00	0.00	0.00
11,500.00	90.00	179.860	7,450.00	-4,258.54	86.13	4,258.73	0.00	0.00	0.00
11,600.00	90.00	179.860	7,450.00	-4,358.53	86.38	4,358.73	0.00	0.00	0.00
11,700.00	90.00	179.860	7,450.00	-4,458.53	86.62	4,458.73	0.00	0.00	0.00
11,800.00	90.00	179.860	7,450.00	-4,558.53	86.87	4,558.73	0.00	0.00	0.00
11,900.00	90.00	179.860	7,450.00	-4,658.53	87.11	4,658.73	0.00	0.00	0.00
12,000.00	90.00	179.860	7,450.00	-4,758.53	87.35	4,758.73	0.00	0.00	0.00
12,100.00	90.00	179.860	7,450.00	-4,858.53	87.60	4,858.73	0.00	0.00	0.00
12,200.00	90.00	179.860	7,450.00	-4,958.53	87.84	4,958.73	0.00	0.00	0.00
12,300.00	90.00	179.860	7,450.00	-5,058.53	88.09	5,058.73	0.00	0.00	0.00
12,400.00	90.00	179.860	7,450.00	-5,158.53	88.33	5,158.73	0.00	0.00	0.00
12,500.00	90.00	179.860	7,450.00	-5,258.53	88.58	5,258.73	0.00	0.00	0.00
12,600.00	90.00	179.860	7,450.00	-5,358.53	88.82	5,358.73	0.00	0.00	0.00
12,700.00	90.00	179.860	7,450.00	-5,458.53	89.06	5,458.73	0.00	0.00	0.00
12,800.00	90.00	179.860	7,450.00	-5,558.53	89.31	5,558.73	0.00	0.00	0.00
12,900.00	90.00	179.860	7,450.00	-5,658.53	89.55	5,658.73	0.00	0.00	0.00
13,000.00	90.00	179.860	7,450.00	-5,758.53	89.80	5,758.73	0.00	0.00	0.00
13,100.00	90.00	179.860	7,450.00	-5,858.53	90.04	5,858.73	0.00	0.00	0.00
13,200.00	90.00	179.860	7,450.00	-5,958.53	90.28	5,958.73	0.00	0.00	0.00
13,300.00	90.00	179.860	7,450.00	-6,058.53	90.53	6,058.73	0.00	0.00	0.00
13,400.00	90.00	179.860	7,450.00	-6,158.53	90.77	6,158.73	0.00	0.00	0.00
13,500.00	90.00	179.860	7,450.00	-6,258.53	91.02	6,258.73	0.00	0.00	0.00
13,600.00	90.00	179.860	7,450.00	-6,358.53	91.26	6,358.73	0.00	0.00	0.00
13,700.00	90.00	179.860	7,450.00	-6,458.53	91.51	6,458.73	0.00	0.00	0.00
13,800.00	90.00	179.860	7,450.00	-6,558.53	91.75	6,558.73	0.00	0.00	0.00
13,900.00	90.00	179.860	7,450.00	-6,658.53	91.99	6,658.73	0.00	0.00	0.00
14,000.00	90.00	179.860	7,450.00	-6,758.53	92.24	6,758.73	0.00	0.00	0.00
14,100.00	90.00	179.860	7,450.00	-6,858.53	92.48	6,858.73	0.00	0.00	0.00
14,200.00	90.00	179.860	7,450.00	-6,958.53	92.73	6,958.73	0.00	0.00	0.00
14,300.00	90.00	179.860	7,450.00	-7,058.53	92.97	7,058.73	0.00	0.00	0.00
14,400.00	90.00	179.860	7,450.00	-7,158.53	93.22	7,158.73	0.00	0.00	0.00
14,500.00	90.00	179.860	7,450.00	-7,258.53	93.46	7,258.73	0.00	0.00	0.00

Database:	Casper District	Local Co-ordinate Reference:	Well Fox Creek 36-0362B
Company:	HighPoint Resources	TVD Reference:	GL 5412' & KB 20' @ 5432.00ft
Project:	Weld County, CO NAD 83	MD Reference:	GL 5412' & KB 20' @ 5432.00ft
Site:	Fox Creek 25 SW Pad	North Reference:	True
Well:	Fox Creek 36-0362B	Survey Calculation Method:	Minimum Curvature
Wellbore:	OH		
Design:	Plan 1		

Planned Survey										
Measured Depth (ft)	Inclination (°)	Azimuth (°)	Vertical Depth (ft)	+N/-S (ft)	+E/-W (ft)	Vertical Section (ft)	Dogleg Rate (°/100ft)	Build Rate (°/100ft)	Turn Rate (°/100ft)	
14,600.00	90.00	179.860	7,450.00	-7,358.53	93.70	7,358.73	0.00	0.00	0.00	
14,700.00	90.00	179.860	7,450.00	-7,458.53	93.95	7,458.73	0.00	0.00	0.00	
14,800.00	90.00	179.860	7,450.00	-7,558.53	94.19	7,558.73	0.00	0.00	0.00	
14,900.00	90.00	179.860	7,450.00	-7,658.52	94.44	7,658.73	0.00	0.00	0.00	
15,000.00	90.00	179.860	7,450.00	-7,758.52	94.68	7,758.73	0.00	0.00	0.00	
15,100.00	90.00	179.860	7,450.00	-7,858.52	94.93	7,858.73	0.00	0.00	0.00	
15,200.00	90.00	179.860	7,450.00	-7,958.52	95.17	7,958.73	0.00	0.00	0.00	
15,300.00	90.00	179.860	7,450.00	-8,058.52	95.41	8,058.73	0.00	0.00	0.00	
15,400.00	90.00	179.860	7,450.00	-8,158.52	95.66	8,158.73	0.00	0.00	0.00	
15,500.00	90.00	179.860	7,450.00	-8,258.52	95.90	8,258.73	0.00	0.00	0.00	
15,600.00	90.00	179.860	7,450.00	-8,358.52	96.15	8,358.73	0.00	0.00	0.00	
15,700.00	90.00	179.860	7,450.00	-8,458.52	96.39	8,458.73	0.00	0.00	0.00	
15,800.00	90.00	179.860	7,450.00	-8,558.52	96.64	8,558.73	0.00	0.00	0.00	
15,900.00	90.00	179.860	7,450.00	-8,658.52	96.88	8,658.73	0.00	0.00	0.00	
16,000.00	90.00	179.860	7,450.00	-8,758.52	97.12	8,758.73	0.00	0.00	0.00	
16,100.00	90.00	179.860	7,450.00	-8,858.52	97.37	8,858.73	0.00	0.00	0.00	
16,200.00	90.00	179.860	7,450.00	-8,958.52	97.61	8,958.73	0.00	0.00	0.00	
16,300.00	90.00	179.860	7,450.00	-9,058.52	97.86	9,058.73	0.00	0.00	0.00	
16,400.00	90.00	179.860	7,450.00	-9,158.52	98.10	9,158.73	0.00	0.00	0.00	
16,500.00	90.00	179.860	7,450.00	-9,258.52	98.35	9,258.73	0.00	0.00	0.00	
16,600.00	90.00	179.860	7,450.00	-9,358.52	98.59	9,358.73	0.00	0.00	0.00	
16,700.00	90.00	179.860	7,450.00	-9,458.52	98.83	9,458.73	0.00	0.00	0.00	
16,800.00	90.00	179.860	7,450.00	-9,558.52	99.08	9,558.73	0.00	0.00	0.00	
16,900.00	90.00	179.860	7,450.00	-9,658.52	99.32	9,658.73	0.00	0.00	0.00	
17,000.00	90.00	179.860	7,450.00	-9,758.52	99.57	9,758.73	0.00	0.00	0.00	
17,100.00	90.00	179.860	7,450.00	-9,858.52	99.81	9,858.73	0.00	0.00	0.00	
17,200.00	90.00	179.860	7,450.00	-9,958.52	100.06	9,958.73	0.00	0.00	0.00	
17,300.00	90.00	179.860	7,450.00	-10,058.52	100.30	10,058.73	0.00	0.00	0.00	
17,400.00	90.00	179.860	7,450.00	-10,158.52	100.54	10,158.73	0.00	0.00	0.00	
17,500.00	90.00	179.860	7,450.00	-10,258.52	100.79	10,258.73	0.00	0.00	0.00	
17,600.00	90.00	179.860	7,450.00	-10,358.52	101.03	10,358.73	0.00	0.00	0.00	
17,700.00	90.00	179.860	7,450.00	-10,458.52	101.28	10,458.73	0.00	0.00	0.00	
17,800.00	90.00	179.860	7,450.00	-10,558.52	101.52	10,558.73	0.00	0.00	0.00	
17,900.00	90.00	179.860	7,450.00	-10,658.52	101.77	10,658.73	0.00	0.00	0.00	
18,000.00	90.00	179.860	7,450.00	-10,758.52	102.01	10,758.73	0.00	0.00	0.00	
18,100.00	90.00	179.860	7,450.00	-10,858.52	102.25	10,858.73	0.00	0.00	0.00	
18,199.59	90.00	179.860	7,450.00	-10,958.10	102.50	10,958.32	0.00	0.00	0.00	
TD at 18199.59										

Design Targets										
Target Name	Dip Angle (°)	Dip Dir. (°)	TVD (ft)	+N/-S (ft)	+E/-W (ft)	Northing (usft)	Easting (usft)	Latitude	Longitude	
- hit/miss target										
- Shape										
Fox Creek 36-0362B PB	0.00	0.000	7,450.00	-10,958.10	102.50	1,588,832.29	3,307,873.22	40° 56' 39.833 N	104° 23' 8.135 W	
- plan hits target center										
- Point										
Fox Creek 36-0362B LP	0.00	0.000	7,450.00	-540.33	77.05	1,599,248.90	3,307,716.89	40° 58' 22.764 N	104° 23' 8.466 W	
- plan hits target center										
- Point										

Database:	Casper District	Local Co-ordinate Reference:	Well Fox Creek 36-0362B
Company:	HighPoint Resources	TVD Reference:	GL 5412' & KB 20' @ 5432.00ft
Project:	Weld County, CO NAD 83	MD Reference:	GL 5412' & KB 20' @ 5432.00ft
Site:	Fox Creek 25 SW Pad	North Reference:	True
Well:	Fox Creek 36-0362B	Survey Calculation Method:	Minimum Curvature
Wellbore:	OH		
Design:	Plan 1		

Plan Annotations				
Measured Depth (ft)	Vertical Depth (ft)	Local Coordinates		Comment
		+N/-S (ft)	+E/-W (ft)	
500.00	500.00	0.00	0.00	Start Build 2.00
750.00	749.68	4.35	10.00	Start 953.95 hold at 750.00 MD
1,703.95	1,700.00	37.50	86.24	Start DLS 2.00 TFO 179.82
2,093.61	2,089.29	40.41	93.15	Start 300.03 hold at 2093.61 MD
2,393.63	2,388.96	34.47	79.80	Start Drop -1.50
2,579.85	2,575.10	32.62	75.65	Start 4301.94 hold at 2579.85 MD
6,881.79	6,877.04	32.62	75.65	Start DLS 10.00 TFO 179.86
7,781.79	7,450.00	-540.34	77.05	Start 10417.80 hold at 7781.79 MD
18,199.59	7,450.00	-10,958.10	102.50	TD at 18199.59