

Location:	COLORADO	Slot:	SLOT#30 ANTELOPE FEDERAL T44-P41-20HNB (689'FSL & 2351'FEL, SEC.20)
Field:	WELD COUNTY (NAD83/TRUE)	Well:	ANTELOPE FEDERAL T44-P41-20HNB
Facility:	SEC.20-T05N-R62W	Wellbore:	ANTELOPE FEDERAL T44-P41-20HNB PWB

Post reference wellpath is ANTELOPE FEDERAL T44-P41-20Hb (REV-C-3) PWP	Grid System: NAD83 / Lambert Colorado SP, Northern Zone (501), US feet
True vertical depths are referenced to AKITA 519 (4655'GL+17'KB@467Z) (RKB)	North Reference: True north
Measured depths are referenced to AKITA 519 (4655'GL+17'KB@467Z) (RKB)	Scale: True distance
AKITA 519 (4655'GL+17'KB@467Z) (RKB) to Mean Sea Level: 4672 feet	Depths are in feet
Mean Sea Level to Ground level (At Slot: SLOT#30 ANTELOPE FEDERAL T44-P41-20HNB (899'SL & 2351'FEL, SEC.2): 0 feet	Created by: doddanna on 2019-07-01
Coordinates are in feet referenced to Slot	Database: WellArchitect

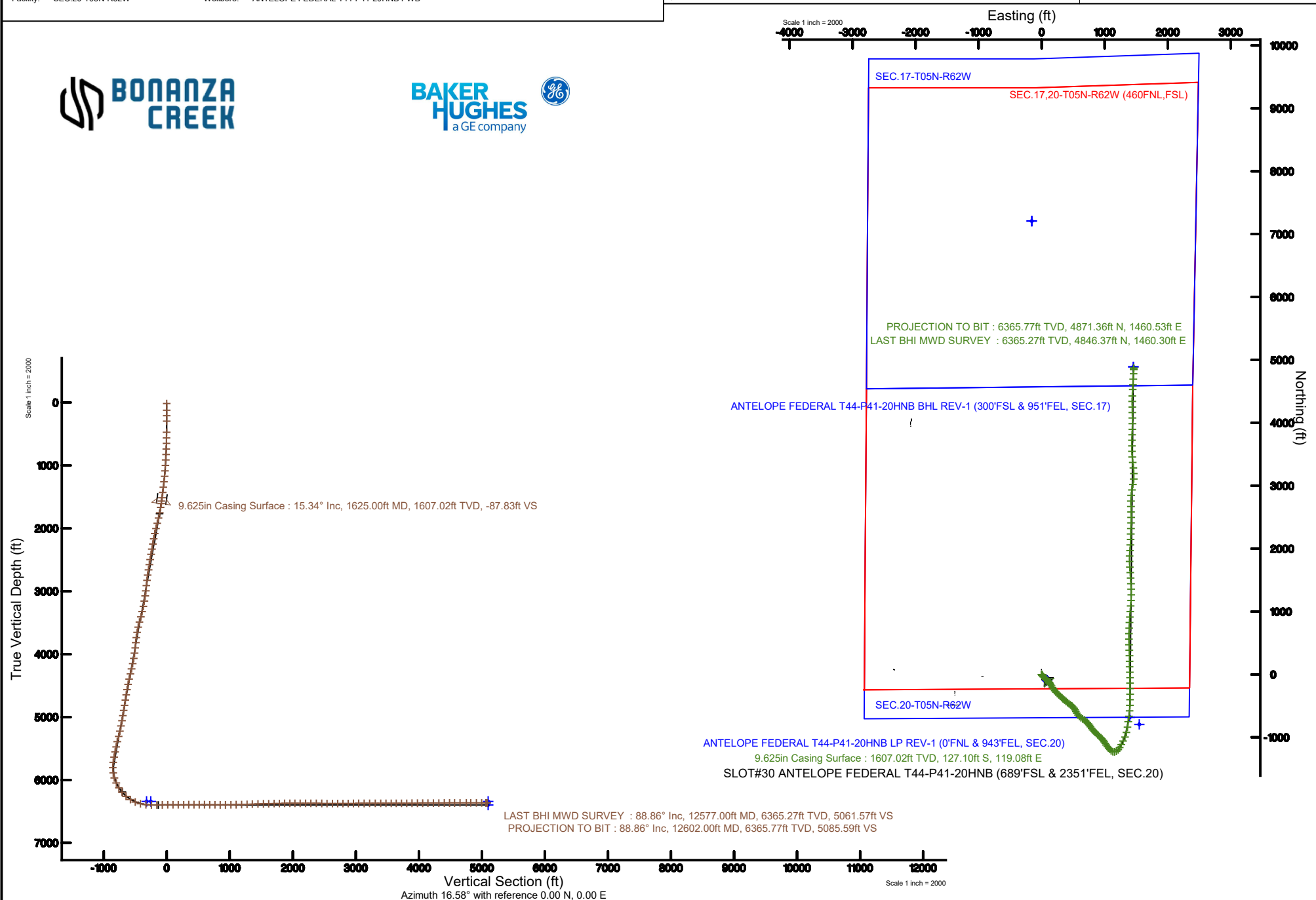

# Actual Wellpath Report

ANTELOPE FEDERAL T44-P41-20HNB AWP

Page 1 of 8



## REFERENCE WELLPATH IDENTIFICATION

Operator	BONANZA CREEK ENERGY	Slot	SLOT#30 ANTELOPE FEDERAL T44-P41-20HNB (689'FSL & 2351'FEL, SEC.20)
Area	COLORADO	Well	ANTELOPE FEDERAL T44-P41-20HNB
Field	WELD COUNTY (NAD83/TRUE)	Wellbore	ANTELOPE FEDERAL T44-P41-20HNB AWP
Facility	SEC.20-T05N-R62W		

## REPORT SETUP INFORMATION

Projection System	NAD83 / Lambert Colorado SP, Northern Zone (501), US feet	Software System	WellArchitect® 5.1
North Reference	True	User	Doddanna
Scale	0.999959	Report Generated	7/1/2019 at 9:14:52 AM
Convergence at slot	0.75° East	Database/Source file	WellArchitectDB/ANTELOPE_FEDERAL_T44-P41-20HNB_AWP.xml

## WELLPATH LOCATION

	Local coordinates		Grid coordinates		Geographic coordinates	
	North[ft]	East[ft]	Easting[US ft]	Northing[US ft]	Latitude	Longitude
Slot Location	-72.04	2336.65	3321319.83	1383277.49	40°22'47.143"N	104°20'47.771"W
Facility Reference Pt			3318982.55	1383319.35	40°22'47.856"N	104°21'17.964"W
Field Reference Pt			3224525.77	1254425.87	40°01'44.400"N	104°41'53.556"W

## WELLPATH DATUM

Calculation method	Minimum curvature	AKITA 519 (4655'GL+17'KB@4672') (RKB) to Facility Vertical Datum	4672.00ft
Horizontal Reference Pt	Slot	AKITA 519 (4655'GL+17'KB@4672') (RKB) to Mean Sea Level	4672.00ft
Vertical Reference Pt	AKITA 519 (4655'GL+17'KB@4672') (RKB)	AKITA 519 (4655'GL+17'KB@4672') (RKB) to Ground Level at Slot (SLOT#30 ANTELOPE FEDERAL T44-P41-20HNB (689'FSL & 2351'FEL, SEC.20))	4672.00ft
MD Reference Pt	AKITA 519 (4655'GL+17'KB@4672') (RKB)	Section Origin	N 0.00, E 0.00 ft
Field Vertical Reference	Mean Sea Level	Section Azimuth	16.58°

# Actual Wellpath Report

## ANTELOPE FEDERAL T44-P41-20HNB AWP

Page 2 of 8



REFERENCE WELLPATH IDENTIFICATION			
Operator	BONANZA CREEK ENERGY	Slot	SLOT#30 ANTELOPE FEDERAL T44-P41-20HNB (689'FSL & 2351'FEL, SEC.20)
Area	COLORADO	Well	ANTELOPE FEDERAL T44-P41-20HNB
Field	WELD COUNTY (NAD83/TRUE)	Wellbore	ANTELOPE FEDERAL T44-P41-20HNB AWB
Facility	SEC.20-T05N-R62W		

WELLPATH DATA (145 stations) † = interpolated/extrapolated station										
MD [ft]	Inclination [°]	Azimuth [°]	TVD [ft]	Vert Sect [ft]	North [ft]	East [ft]	Latitude	Longitude	DLS [°/100ft]	Comments
0.00†	0.000	113.740	0.00	0.00	0.00	0.00	40°22'47.143"N	104°20'47.771"W	0.00	
17.00	0.000	113.740	17.00	0.00	0.00	0.00	40°22'47.143"N	104°20'47.771"W	0.00	
123.00	0.410	113.740	123.00	-0.05	-0.15	0.35	40°22'47.141"N	104°20'47.767"W	0.39	
209.00	0.460	144.070	209.00	-0.30	-0.56	0.83	40°22'47.138"N	104°20'47.760"W	0.27	
297.00	0.230	147.870	297.00	-0.63	-0.99	1.13	40°22'47.133"N	104°20'47.756"W	0.26	
474.00	0.490	156.050	473.99	-1.44	-1.98	1.63	40°22'47.123"N	104°20'47.750"W	0.15	
562.00	1.140	132.340	561.98	-2.10	-2.92	2.43	40°22'47.114"N	104°20'47.740"W	0.82	
650.00	2.040	153.740	649.95	-3.63	-4.91	3.77	40°22'47.094"N	104°20'47.722"W	1.21	
738.00	3.240	145.870	737.85	-6.36	-8.38	5.86	40°22'47.060"N	104°20'47.695"W	1.42	
826.00	4.540	146.630	825.65	-10.17	-13.34	9.17	40°22'47.011"N	104°20'47.653"W	1.48	
913.00	5.820	142.540	912.29	-14.98	-19.72	13.75	40°22'46.948"N	104°20'47.593"W	1.53	
1000.00	7.600	138.740	998.69	-20.63	-27.55	20.22	40°22'46.871"N	104°20'47.510"W	2.11	
1088.00	9.430	133.620	1085.72	-27.01	-36.90	29.28	40°22'46.778"N	104°20'47.393"W	2.25	
1177.00	11.110	134.510	1173.29	-34.34	-47.94	40.67	40°22'46.669"N	104°20'47.245"W	1.90	
1265.00	12.630	134.370	1259.41	-42.79	-60.61	53.60	40°22'46.544"N	104°20'47.078"W	1.73	
1353.00	13.920	135.910	1345.05	-52.46	-74.94	67.84	40°22'46.402"N	104°20'46.894"W	1.52	
1440.00	15.400	135.820	1429.22	-63.23	-90.74	83.17	40°22'46.246"N	104°20'46.696"W	1.70	
1528.00	16.460	133.820	1513.84	-74.65	-107.75	100.31	40°22'46.078"N	104°20'46.475"W	1.36	
1582.00	16.310	136.280	1565.65	-81.91	-118.53	111.07	40°22'45.972"N	104°20'46.336"W	1.31	
1688.00	13.930	140.000	1667.97	-96.31	-139.07	129.56	40°22'45.769"N	104°20'46.097"W	2.42	
1777.00	17.050	147.200	1753.74	-110.71	-158.25	143.52	40°22'45.579"N	104°20'45.916"W	4.11	
1865.00	19.480	150.120	1837.30	-129.22	-181.82	157.82	40°22'45.346"N	104°20'45.732"W	2.95	
1952.00	19.980	149.830	1919.19	-149.40	-207.25	172.52	40°22'45.095"N	104°20'45.542"W	0.59	
2040.00	20.760	146.670	2001.69	-169.74	-233.28	188.65	40°22'44.838"N	104°20'45.333"W	1.53	
2129.00	21.090	141.540	2084.83	-189.08	-259.00	207.28	40°22'44.584"N	104°20'45.093"W	2.09	
2216.00	21.100	136.000	2166.01	-205.74	-282.52	227.89	40°22'44.351"N	104°20'44.826"W	2.29	
2305.00	20.800	132.570	2249.13	-220.53	-304.73	250.66	40°22'44.132"N	104°20'44.532"W	1.42	
2393.00	20.710	132.840	2331.41	-234.26	-325.88	273.57	40°22'43.923"N	104°20'44.236"W	0.15	
2481.00	20.740	132.490	2413.72	-247.96	-346.99	296.47	40°22'43.714"N	104°20'43.940"W	0.14	
2569.00	20.680	132.430	2496.03	-261.54	-368.00	319.43	40°22'43.507"N	104°20'43.644"W	0.07	

# Actual Wellpath Report

## ANTELOPE FEDERAL T44-P41-20HNB AWP

Page 3 of 8



REFERENCE WELLPATH IDENTIFICATION			
Operator	BONANZA CREEK ENERGY	Slot	SLOT#30 ANTELOPE FEDERAL T44-P41-20HNB (689'FSL & 2351'FEL, SEC.20)
Area	COLORADO	Well	ANTELOPE FEDERAL T44-P41-20HNB
Field	WELD COUNTY (NAD83/TRUE)	Wellbore	ANTELOPE FEDERAL T44-P41-20HNB AWB
Facility	SEC.20-T05N-R62W		

WELLPATH DATA (145 stations)										
MD [ft]	Inclination [°]	Azimuth [°]	TVD [ft]	Vert Sect [ft]	North [ft]	East [ft]	Latitude	Longitude	DLS [°/100ft]	Comments
2656.00	19.980	131.610	2577.61	-274.53	-388.23	341.88	40°22'43.307"N	104°20'43.353"W	0.87	
2743.00	20.140	135.690	2659.34	-288.10	-408.82	363.46	40°22'43.103"N	104°20'43.075"W	1.62	
2832.00	20.170	132.170	2742.89	-302.18	-430.09	385.54	40°22'42.893"N	104°20'42.789"W	1.36	
2920.00	19.610	124.460	2825.66	-313.27	-448.63	408.96	40°22'42.710"N	104°20'42.487"W	3.05	
3009.00	18.880	122.550	2909.68	-321.82	-464.83	433.41	40°22'42.550"N	104°20'42.171"W	1.08	
3097.00	18.770	126.790	2992.98	-330.63	-480.97	456.76	40°22'42.390"N	104°20'41.869"W	1.56	
3184.00	19.090	131.310	3075.28	-341.41	-498.75	478.65	40°22'42.215"N	104°20'41.586"W	1.72	
3271.00	18.200	138.410	3157.72	-354.53	-518.30	498.36	40°22'42.021"N	104°20'41.332"W	2.80	
3359.00	18.050	145.280	3241.37	-370.31	-539.79	515.25	40°22'41.809"N	104°20'41.113"W	2.43	
3446.00	18.590	150.710	3323.96	-388.39	-562.96	529.71	40°22'41.580"N	104°20'40.926"W	2.06	
3534.00	20.270	154.490	3406.95	-409.47	-588.96	543.14	40°22'41.323"N	104°20'40.753"W	2.38	
3623.00	20.940	149.290	3490.27	-431.70	-616.55	557.90	40°22'41.050"N	104°20'40.562"W	2.19	
3711.00	22.610	141.960	3572.00	-452.17	-643.40	576.36	40°22'40.785"N	104°20'40.324"W	3.62	
3799.00	21.830	132.100	3653.49	-469.01	-667.70	598.94	40°22'40.545"N	104°20'40.032"W	4.32	
3888.00	21.560	125.890	3736.20	-481.55	-688.38	624.46	40°22'40.341"N	104°20'39.702"W	2.60	
3976.00	20.160	123.160	3818.43	-491.23	-706.16	650.26	40°22'40.165"N	104°20'39.369"W	1.94	
4065.00	20.020	124.760	3902.02	-500.36	-723.23	675.62	40°22'39.996"N	104°20'39.041"W	0.64	
4153.00	20.110	127.350	3984.68	-510.42	-741.00	700.02	40°22'39.821"N	104°20'38.726"W	1.01	
4241.00	19.430	136.400	4067.51	-523.07	-760.78	722.14	40°22'39.625"N	104°20'38.440"W	3.56	
4330.00	19.530	143.730	4151.43	-539.41	-783.50	741.15	40°22'39.401"N	104°20'38.194"W	2.75	
4417.00	19.640	145.140	4233.39	-557.31	-807.22	758.11	40°22'39.166"N	104°20'37.975"W	0.56	
4503.00	20.580	146.150	4314.15	-575.95	-831.63	774.80	40°22'38.925"N	104°20'37.760"W	1.17	
4592.00	20.060	142.950	4397.61	-594.96	-856.81	792.71	40°22'38.676"N	104°20'37.528"W	1.38	
4680.00	20.200	142.680	4480.24	-612.86	-880.93	811.01	40°22'38.438"N	104°20'37.292"W	0.19	
4768.00	17.550	135.870	4563.51	-628.31	-902.54	829.46	40°22'38.224"N	104°20'37.053"W	3.91	
4857.00	18.740	133.620	4648.08	-641.37	-922.04	849.16	40°22'38.032"N	104°20'36.799"W	1.55	
4945.00	20.010	133.530	4731.10	-654.63	-942.16	870.31	40°22'37.833"N	104°20'36.526"W	1.44	
5033.00	20.870	131.670	4813.56	-668.10	-962.95	892.93	40°22'37.627"N	104°20'36.233"W	1.22	
5121.00	21.340	131.270	4895.65	-681.43	-983.94	916.68	40°22'37.420"N	104°20'35.927"W	0.56	
5208.00	19.900	133.100	4977.08	-694.65	-1004.50	939.39	40°22'37.217"N	104°20'35.633"W	1.81	

# Actual Wellpath Report

ANTELOPE FEDERAL T44-P41-20HNB AWP

Page 4 of 8



REFERENCE WELLPATH IDENTIFICATION			
Operator	BONANZA CREEK ENERGY	Slot	SLOT#30 ANTELOPE FEDERAL T44-P41-20HNB (689'FSL & 2351'FEL, SEC.20)
Area	COLORADO	Well	ANTELOPE FEDERAL T44-P41-20HNB
Field	WELD COUNTY (NAD83/TRUE)	Wellbore	ANTELOPE FEDERAL T44-P41-20HNB AWB
Facility	SEC.20-T05N-R62W		

WELLPATH DATA (145 stations)										
MD [ft]	Inclination [°]	Azimuth [°]	TVD [ft]	Vert Sect [ft]	North [ft]	East [ft]	Latitude	Longitude	DLS [°/100ft]	Comments
5295.00	19.450	139.490	5059.01	-709.14	-1025.63	959.61	40°22'37.008"N	104°20'35.372"W	2.53	
5383.00	18.940	142.900	5142.12	-725.56	-1048.16	977.74	40°22'36.785"N	104°20'35.138"W	1.40	
5470.00	19.040	147.310	5224.39	-743.18	-1071.37	993.93	40°22'36.556"N	104°20'34.929"W	1.65	
5559.00	19.770	150.730	5308.33	-763.14	-1096.71	1009.13	40°22'36.305"N	104°20'34.732"W	1.52	
5647.00	20.290	149.370	5391.01	-783.87	-1122.83	1024.18	40°22'36.047"N	104°20'34.538"W	0.79	
5736.00	20.220	141.130	5474.53	-803.08	-1148.08	1041.69	40°22'35.798"N	104°20'34.311"W	3.20	
5823.00	20.160	135.330	5556.19	-818.81	-1170.45	1061.67	40°22'35.577"N	104°20'34.053"W	2.30	
5911.00	20.560	138.020	5638.69	-834.17	-1192.73	1082.67	40°22'35.357"N	104°20'33.782"W	1.16	
5999.00	19.860	133.390	5721.28	-848.97	-1214.48	1103.87	40°22'35.142"N	104°20'33.508"W	1.98	
6086.00	18.770	105.080	5803.56	-855.28	-1228.31	1128.18	40°22'35.005"N	104°20'33.194"W	10.73	
6175.00	19.930	82.820	5887.65	-848.79	-1230.14	1157.09	40°22'34.987"N	104°20'32.820"W	8.34	
6262.00	23.430	62.310	5968.60	-830.71	-1220.23	1187.17	40°22'35.085"N	104°20'32.432"W	9.53	
6351.00	26.130	39.310	6049.58	-800.20	-1196.79	1215.33	40°22'35.316"N	104°20'32.068"W	11.18	
6439.00	32.650	29.260	6126.26	-759.10	-1161.02	1239.25	40°22'35.670"N	104°20'31.759"W	9.27	
6527.00	40.540	27.240	6196.86	-707.75	-1114.81	1263.98	40°22'36.126"N	104°20'31.439"W	9.07	
6616.00	48.690	26.420	6260.16	-646.29	-1059.07	1292.14	40°22'36.677"N	104°20'31.075"W	9.18	
6704.00	58.200	22.490	6312.53	-576.35	-994.75	1321.22	40°22'37.313"N	104°20'30.699"W	11.38	
6792.00	67.890	14.070	6352.43	-498.13	-920.38	1345.53	40°22'38.048"N	104°20'30.385"W	13.92	
6879.00	76.870	8.460	6378.75	-415.70	-839.16	1361.60	40°22'38.850"N	104°20'30.178"W	12.01	
6968.00	84.270	7.610	6393.33	-328.94	-752.28	1373.86	40°22'39.709"N	104°20'30.019"W	8.37	
7057.00	89.380	7.170	6398.25	-241.25	-664.19	1385.29	40°22'40.579"N	104°20'29.871"W	5.76	
7145.00	91.020	5.110	6397.95	-154.71	-576.70	1394.70	40°22'41.444"N	104°20'29.750"W	2.99	
7232.00	90.890	2.720	6396.50	-69.85	-489.92	1400.64	40°22'42.301"N	104°20'29.673"W	2.75	
7320.00	90.520	0.610	6395.41	15.18	-401.97	1403.19	40°22'43.170"N	104°20'29.640"W	2.43	
7407.00	90.000	0.040	6395.02	98.70	-314.97	1403.69	40°22'44.030"N	104°20'29.633"W	0.89	
7496.00	90.000	359.780	6395.02	183.95	-225.97	1403.55	40°22'44.910"N	104°20'29.635"W	0.29	
7584.00	90.890	359.740	6394.33	268.19	-137.98	1403.18	40°22'45.779"N	104°20'29.640"W	1.01	
7671.00	90.150	358.200	6393.55	351.10	-51.00	1401.61	40°22'46.639"N	104°20'29.660"W	1.96	
7758.00	89.660	357.740	6393.69	433.55	35.95	1398.53	40°22'47.498"N	104°20'29.700"W	0.77	
7845.00	90.710	359.670	6393.41	516.35	122.92	1396.57	40°22'48.357"N	104°20'29.725"W	2.53	

# Actual Wellpath Report

ANTELOPE FEDERAL T44-P41-20HNB AWP

Page 5 of 8



REFERENCE WELLPATH IDENTIFICATION			
Operator	BONANZA CREEK ENERGY	Slot	SLOT#30 ANTELOPE FEDERAL T44-P41-20HNB (689'FSL & 2351'FEL, SEC.20)
Area	COLORADO	Well	ANTELOPE FEDERAL T44-P41-20HNB
Field	WELD COUNTY (NAD83/TRUE)	Wellbore	ANTELOPE FEDERAL T44-P41-20HNB AWP
Facility	SEC.20-T05N-R62W		

WELLPATH DATA (145 stations)										
MD [ft]	Inclination [°]	Azimuth [°]	TVD [ft]	Vert Sect [ft]	North [ft]	East [ft]	Latitude	Longitude	DLS [°/100ft]	Comments
7932.00	89.420	359.210	6393.31	599.48	209.91	1395.72	40°22'49.217"N	104°20'29.736"W	1.57	
8020.00	89.380	358.460	6394.23	683.29	297.89	1393.93	40°22'50.086"N	104°20'29.759"W	0.85	
8107.00	89.290	357.490	6395.24	765.73	384.83	1390.85	40°22'50.945"N	104°20'29.799"W	1.12	
8196.00	89.320	357.910	6396.32	849.94	473.75	1387.28	40°22'51.824"N	104°20'29.845"W	0.47	
8283.00	90.430	359.360	6396.51	932.70	560.72	1385.21	40°22'52.683"N	104°20'29.872"W	2.10	
8371.00	91.110	1.630	6395.33	1017.24	648.70	1385.97	40°22'53.553"N	104°20'29.862"W	2.69	
8458.00	91.880	3.320	6393.06	1101.59	735.59	1389.72	40°22'54.411"N	104°20'29.813"W	2.13	
8547.00	90.980	2.660	6390.84	1188.07	824.44	1394.37	40°22'55.289"N	104°20'29.753"W	1.25	
8635.00	92.220	3.820	6388.38	1273.66	912.26	1399.34	40°22'56.157"N	104°20'29.689"W	1.93	
8723.00	92.250	4.610	6384.95	1359.55	999.96	1405.80	40°22'57.024"N	104°20'29.605"W	0.90	
8812.00	91.660	4.440	6381.91	1446.53	1088.63	1412.82	40°22'57.900"N	104°20'29.514"W	0.69	
8901.00	91.200	3.070	6379.69	1533.28	1177.41	1418.64	40°22'58.777"N	104°20'29.439"W	1.62	
8990.00	91.320	0.770	6377.73	1619.36	1266.33	1421.62	40°22'59.656"N	104°20'29.401"W	2.59	
9079.00	90.890	358.210	6376.02	1704.41	1355.30	1420.83	40°23'00.535"N	104°20'29.411"W	2.92	
9167.00	91.480	356.500	6374.20	1787.48	1443.18	1416.77	40°23'01.404"N	104°20'29.463"W	2.06	
9255.00	91.050	356.660	6372.25	1870.15	1531.01	1411.52	40°23'02.271"N	104°20'29.531"W	0.52	
9343.00	90.650	355.740	6370.95	1952.63	1618.80	1405.69	40°23'03.139"N	104°20'29.606"W	1.14	
9431.00	89.850	356.070	6370.56	2034.96	1706.57	1399.41	40°23'04.006"N	104°20'29.687"W	0.98	
9519.00	89.940	358.690	6370.73	2118.06	1794.48	1395.39	40°23'04.875"N	104°20'29.739"W	2.98	
9607.00	89.850	2.070	6370.89	2202.55	1882.46	1395.97	40°23'05.744"N	104°20'29.732"W	3.84	
9695.00	89.260	4.600	6371.57	2288.20	1970.30	1401.09	40°23'06.612"N	104°20'29.665"W	2.95	
9784.00	89.480	3.370	6372.55	2375.05	2059.08	1407.27	40°23'07.490"N	104°20'29.585"W	1.40	
9872.00	89.480	1.980	6373.35	2460.47	2146.98	1411.38	40°23'08.358"N	104°20'29.532"W	1.58	
9959.00	89.600	1.740	6374.05	2544.61	2233.93	1414.20	40°23'09.218"N	104°20'29.496"W	0.31	
10046.00	89.540	1.850	6374.70	2628.72	2320.88	1416.93	40°23'10.077"N	104°20'29.460"W	0.14	
10134.00	89.940	1.490	6375.10	2713.76	2408.84	1419.49	40°23'10.946"N	104°20'29.427"W	0.61	
10220.00	89.780	0.090	6375.31	2796.51	2494.83	1420.68	40°23'11.796"N	104°20'29.412"W	1.64	
10308.00	90.770	358.640	6374.89	2880.56	2582.82	1419.70	40°23'12.665"N	104°20'29.424"W	2.00	
10395.00	90.770	358.640	6373.72	2963.33	2669.79	1417.64	40°23'13.525"N	104°20'29.451"W	0.00	
10483.00	89.850	0.550	6373.24	3047.48	2757.78	1417.02	40°23'14.394"N	104°20'29.459"W	2.41	

# Actual Wellpath Report

## ANTELOPE FEDERAL T44-P41-20HNB AWP

Page 6 of 8



REFERENCE WELLPATH IDENTIFICATION			
Operator	BONANZA CREEK ENERGY	Slot	SLOT#30 ANTELOPE FEDERAL T44-P41-20HNB (689'FSL & 2351'FEL, SEC.20)
Area	COLORADO	Well	ANTELOPE FEDERAL T44-P41-20HNB
Field	WELD COUNTY (NAD83/TRUE)	Wellbore	ANTELOPE FEDERAL T44-P41-20HNB AWB
Facility	SEC.20-T05N-R62W		

WELLPATH DATA (145 stations)										
MD [ft]	Inclination [°]	Azimuth [°]	TVD [ft]	Vert Sect [ft]	North [ft]	East [ft]	Latitude	Longitude	DLS [°/100ft]	Comments
10572.00	90.550	4.500	6372.93	3133.80	2846.68	1420.94	40°23'15.273"N	104°20'29.408"W	4.51	
10660.00	90.830	10.140	6371.87	3220.61	2933.92	1432.14	40°23'16.135"N	104°20'29.263"W	6.42	
10749.00	90.520	11.470	6370.82	3309.15	3021.33	1448.83	40°23'16.998"N	104°20'29.048"W	1.53	
10836.00	89.850	4.050	6370.54	3395.06	3107.48	1460.57	40°23'17.850"N	104°20'28.896"W	8.56	
10922.00	90.000	356.940	6370.65	3477.64	3193.42	1461.31	40°23'18.699"N	104°20'28.886"W	8.27	
11012.00	89.880	354.710	6370.75	3561.79	3283.17	1454.76	40°23'19.586"N	104°20'28.971"W	2.48	
11099.00	90.030	353.750	6370.82	3642.26	3369.73	1446.01	40°23'20.441"N	104°20'29.084"W	1.12	
11188.00	90.090	355.020	6370.72	3724.66	3458.30	1437.30	40°23'21.316"N	104°20'29.196"W	1.43	
11276.00	90.180	359.100	6370.51	3807.58	3546.17	1432.79	40°23'22.185"N	104°20'29.255"W	4.64	
11365.00	90.150	0.120	6370.26	3892.71	3635.16	1432.18	40°23'23.064"N	104°20'29.262"W	1.15	
11453.00	90.120	1.450	6370.05	3977.38	3723.15	1433.39	40°23'23.934"N	104°20'29.247"W	1.51	
11539.00	90.490	2.070	6369.59	4060.52	3809.11	1436.03	40°23'24.783"N	104°20'29.212"W	0.84	
11627.00	90.520	1.640	6368.82	4145.62	3897.06	1438.88	40°23'25.652"N	104°20'29.176"W	0.49	
11717.00	90.250	0.990	6368.21	4232.45	3987.03	1440.94	40°23'26.541"N	104°20'29.149"W	0.78	
11806.00	90.180	358.810	6367.88	4317.69	4076.03	1440.79	40°23'27.421"N	104°20'29.151"W	2.45	
11895.00	90.890	359.840	6367.05	4402.68	4165.02	1439.74	40°23'28.300"N	104°20'29.164"W	1.41	
11982.00	89.780	358.530	6366.54	4485.70	4252.00	1438.50	40°23'29.159"N	104°20'29.180"W	1.97	
12069.00	90.090	359.680	6366.64	4568.68	4338.99	1437.14	40°23'30.019"N	104°20'29.198"W	1.37	
12157.00	90.740	2.550	6366.00	4653.48	4426.96	1438.86	40°23'30.888"N	104°20'29.175"W	3.34	
12261.00	90.280	3.660	6365.07	4754.61	4530.80	1444.49	40°23'31.914"N	104°20'29.103"W	1.16	
12333.00	89.540	2.690	6365.19	4824.65	4602.69	1448.48	40°23'32.625"N	104°20'29.051"W	1.69	
12423.00	90.830	3.690	6364.90	4912.20	4692.55	1453.49	40°23'33.513"N	104°20'28.986"W	1.81	
12510.00	89.750	2.770	6364.46	4996.85	4779.41	1458.39	40°23'34.371"N	104°20'28.923"W	1.63	
12577.00	88.860	0.510	6365.27	5061.57	4846.37	1460.30	40°23'35.033"N	104°20'28.898"W	3.63	LAST BHI MWD SURVEY
12602.00	88.860	0.510	6365.77	5085.59	4871.36	1460.53	40°23'35.280"N	104°20'28.895"W	0.00	PROJECTION TO BIT

# Actual Wellpath Report

ANTELOPE FEDERAL T44-P41-20HNB AWP

Page 7 of 8



REFERENCE WELLPATH IDENTIFICATION			
Operator	BONANZA CREEK ENERGY	Slot	SLOT#30 ANTELOPE FEDERAL T44-P41-20HNB (689'FSL & 2351'FEL, SEC.20)
Area	COLORADO	Well	ANTELOPE FEDERAL T44-P41-20HNB
Field	WELD COUNTY (NAD83/TRUE)	Wellbore	ANTELOPE FEDERAL T44-P41-20HNB AWB
Facility	SEC.20-T05N-R62W		

HOLE & CASING SECTIONS									
- Ref Wellbore: ANTELOPE FEDERAL T44-P41-20HNB AWB					Ref Wellpath: ANTELOPE FEDERAL T44-P41-20HNB AWP				
String/Diameter	Start MD [ft]	End MD [ft]	Interval [ft]	Start TVD [ft]	End TVD [ft]	Start N/S [ft]	Start E/W [ft]	End N/S [ft]	End E/W [ft]
9.625in Casing Surface	17.00	1625.00	1608.00	17.00	1607.02	0.00	0.00	-127.10	119.08

TARGETS								
Name	TVD [ft]	North [ft]	East [ft]	Grid East [US ft]	Grid North [US ft]	Latitude	Longitude	Shape
ANTELOPE FEDERAL T44-P41-20HNB BHL (300'FSL & 951'FEL, SEC.17)	6342.00	4889.10	1455.73	3322711.79	1388184.90	40°23'35.455"N	104°20'28.957"W	point
ANTELOPE FEDERAL T44-P41-20HNB LP (0'FNL & 943'FEL, SEC.20)	6342.00	-680.51	1400.34	3322728.84	1382615.27	40°22'40.418"N	104°20'29.677"W	point
ANTELOPE FEDERAL T44-P41-20HNB LP REV-1 (0'FNL & 943'FEL, SEC.20)	6342.00	-793.51	1550.34	3322880.29	1382504.24	40°22'39.301"N	104°20'27.739"W	point
ANTELOPE FEDERAL T44-P41-20HNB BHL REV-1 (300'FSL & 951'FEL, SEC.17)	6398.00	4889.10	1455.73	3322711.79	1388184.90	40°23'35.455"N	104°20'28.957"W	point
SEC.17,20-T05N-R62W (460FNL,FSL)	10670.00	7207.89	-156.79	3321069.31	1390482.42	40°23'58.369"N	104°20'49.798"W	polygon
SEC.17-T05N-R62W	10671.00	7207.89	-156.79	3321069.31	1390482.42	40°23'58.369"N	104°20'49.798"W	polygon
SEC.20-T05N-R62W	10671.00	7207.89	-156.79	3321069.31	1390482.42	40°23'58.369"N	104°20'49.798"W	polygon

WELLPATH COMPOSITION - Ref Wellbore: ANTELOPE FEDERAL T44-P41-20HNB AWB					Ref Wellpath: ANTELOPE FEDERAL T44-P41-20HNB AWP	
Start MD [ft]	End MD [ft]	Positional Uncertainty Model	Log Name/Comment		Wellbore	
17.00	1582.00	BHI NaviTrak (Rotating+Axial Corr)	BHI NAVITRAK (ROTATING+AXIAL CORR) <123-1582>		ANTELOPE FEDERAL T44-P41-20HNB AWB	
1582.00	12577.00	BHI AutoTrak Curve (Short)	BHI AUTOTRAK CURVE (SHORT) <1688-12577>		ANTELOPE FEDERAL T44-P41-20HNB AWB	
12577.00	12602.00	Blind Drilling (std)	Projection to bit		ANTELOPE FEDERAL T44-P41-20HNB AWB	



**Actual Wellpath Report**  
ANTELOPE FEDERAL T44-P41-20HNB AWP  
Page 8 of 8



REFERENCE WELLPATH IDENTIFICATION			
Operator	BONANZA CREEK ENERGY	Slot	SLOT#30 ANTELOPE FEDERAL T44-P41-20HNB (689'FSL & 2351'FEL, SEC.20)
Area	COLORADO	Well	ANTELOPE FEDERAL T44-P41-20HNB
Field	WELD COUNTY (NAD83/TRUE)	Wellbore	ANTELOPE FEDERAL T44-P41-20HNB AWB
Facility	SEC.20-T05N-R62W		

WELLPATH COMMENTS				
MD [ft]	Inclination [°]	Azimuth [°]	TVD [ft]	Comment
12577.00	88.860	0.510	6365.27	LAST BHI MWD SURVEY
12602.00	88.860	0.510	6365.77	PROJECTION TO BIT