



FIGURES

Figure 1: Topographic Site Location Map

Figure 2: Aerial Site Location Map

Figure 3: Proposed Assessment Map

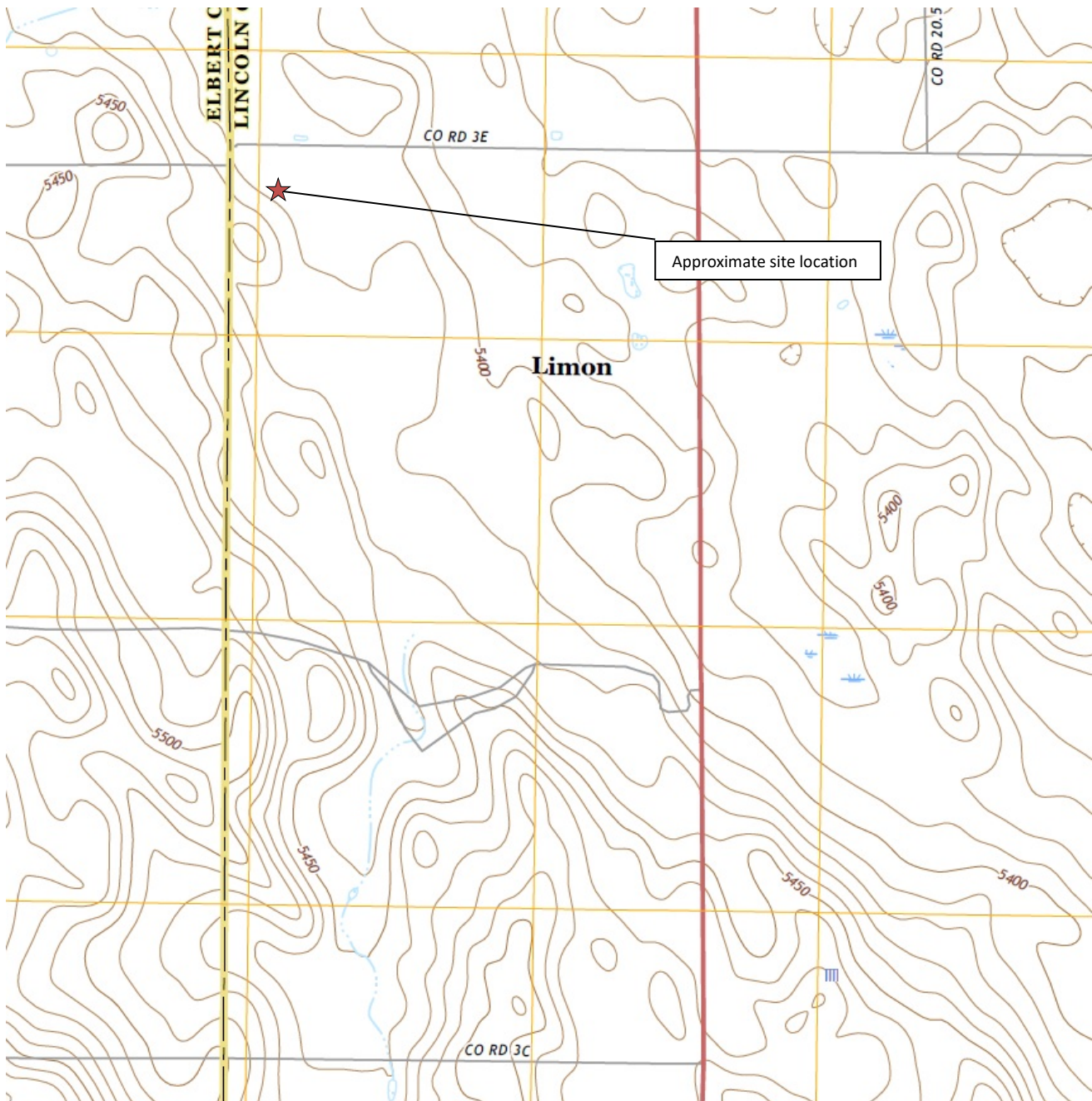

Topographic Site Location Map
 Safranek-State #2-30
 Site Assessment
 39.242416 / -103.713164
 NW¼ NW¼ SEC.30 T9S R56W 6PM
 Lincoln County, Colorado
 Location ID 309601



EAGLE
 ENVIRONMENTAL
 CONSULTING, INC.

Source: USGS 7.5 Minute Topographic
 Map: Lake, CO Quadrangle 2016

Figure 1



LEGEND

- APPROXIMATE SAFRANEK-STATE #2-30 TANK BATTERY
- APPROXIMATE SAFRANEK-STATE #2-30 WELL HEAD
- APPROXIMATE PRODUCED WATER VAULT LOCATION (FACILITY ID 119193)
- APPROXIMATE PRODUCED "PIT" LOCATION (FACILITY ID 116147)

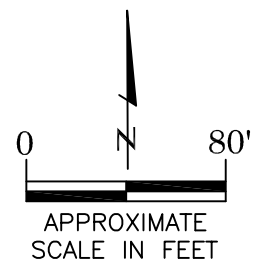

AERIAL SITE LOCATION MAP
 SAFRANEK-STATE #2-30
 SITE ASSESSMENT
 39.242416 / -103.713164
 NW1/4 NW1/4 SEC.30 T9S R56W 6PM
 LINCOLN COUNTY, COLORADO
 LOCATION ID 309601

DATE:
 04/24/19

FIG. NO.
 2

DRAWN BY:
 amn



EAGLE
 ENVIRONMENTAL
 CONSULTING, INC.
 4101 INCA STREET, DENVER, CO 80211
 Ph: 303-433-0479 • F: 303-325-5449



LEGEND

- APPROXIMATE PRODUCED WATER PIT LOCATION
- PROPOSED PRODUCED WATER VAULT SOIL SAMPLE LOCATIONS (1)
- APPROXIMATE PRODUCTION "PIT" LOCATION
- PROPOSED PRODUCTION "PIT" SOIL SAMPLE LOCATIONS (5)
- HISTORICAL PRODUCTION "PIT" LOCATION
- HISTORICAL PRODUCTION "PIT" SOIL SAMPLE LOCATION (1)

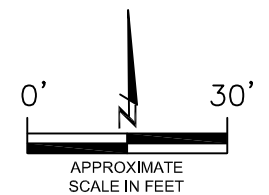

PROPOSED ASSESSMENT MAP
 SAFRANEK-STATE #2-30
 SITE ASSESSMENT
 39.242416 / -103.713164
 NW1/4 NW1/4 SEC.30 T9S R56W 6PM
 LINCOLN COUNTY, COLORADO
 LOCATION ID 309601

DATE:
04/24/19
 DRAWN BY:
amn
 FIG.
NO. 3

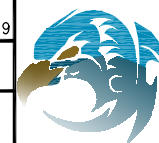

EAGLE
 ENVIRONMENTAL
 CONSULTING, INC.
 4101 INCA STREET, DENVER, CO 80211
 Ph: 303-433-0479 • F: 303-325-5449