

DATE: 6/19/2019

Gulf Exploration L.L.C.

ACCESS ROAD DRAWING
Eagle Hill #1-32
NW1/4NE1/4 of Section 32, T10N, R78W, 6th P.M.
Jackson County, Colorado.

JCR 8

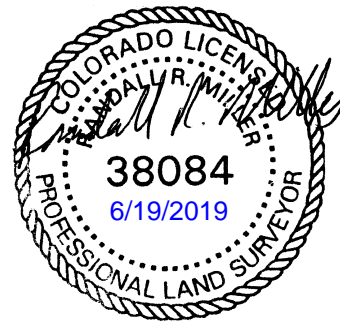

EXISTING TWO-TRACK TO BE UPGRADED
7704' x 22'

NEW ACCESS ROAD
299' x 22'

Eagle Hill #1-32

EXISTING TWO-TRACK
UNIMPROVED

EXISTING TWO-TRACK
UNIMPROVED



GRAPHIC SCALE 1"=1000'

