

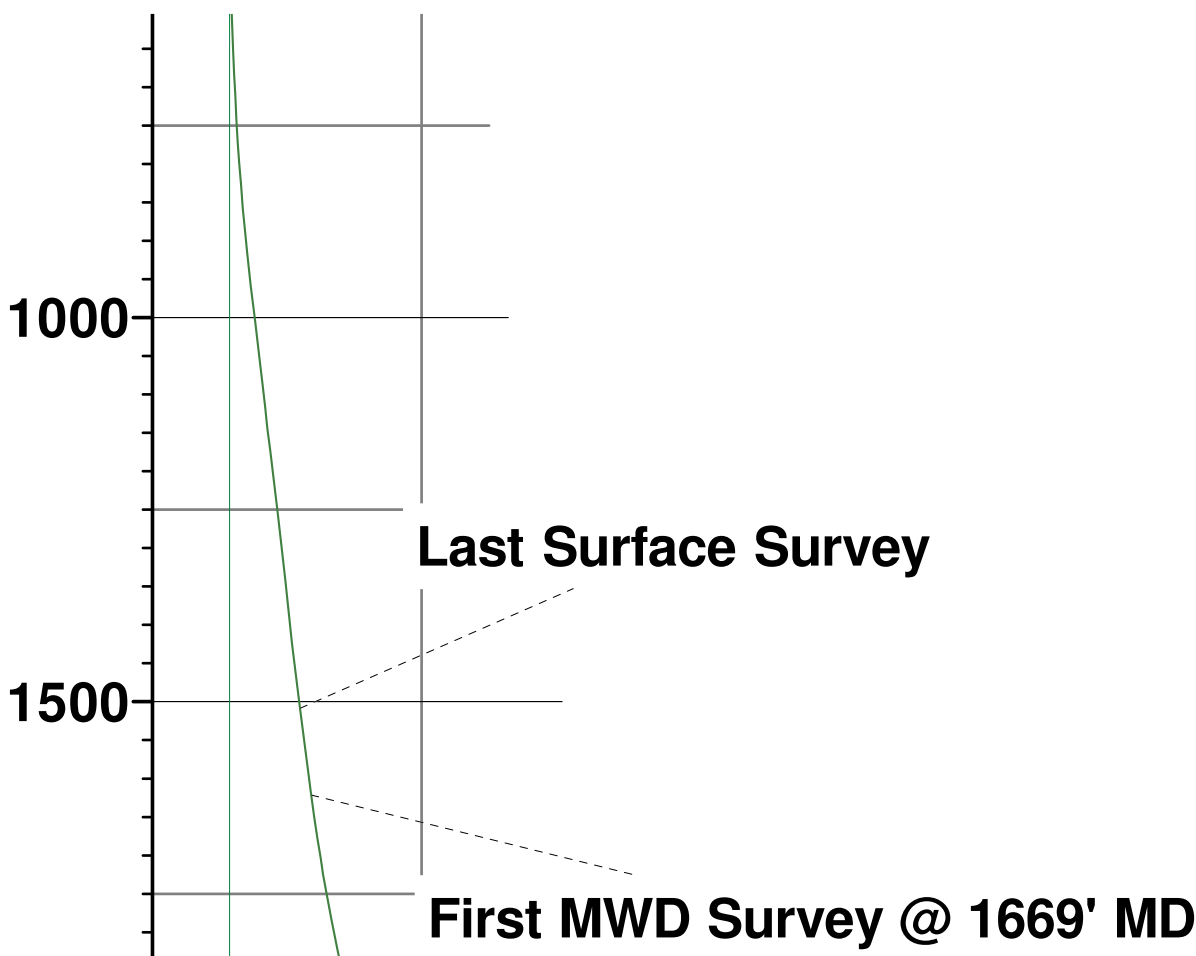

Extraction Oil & Gas
Project: Weld County, CO (NAD83)
Site: Sec 28-T1N-R68W Coyote Trails
Well: Coyote Trails 33W-15-8N
Wellbore: Wellbore #1
Design: Wellbore #1 (Coyote Trails 33W-15-8N/Wellbore #1)
Ensign 147

WELL DETAILS: Coyote Trails 33W-15-8N			
Ground Elevation::		5273.00	
RKB Elevation:		KB @ 5301.00usft (Ensign 147)	
Rig Name: Ensign 147			
Northing	Easting	Latitude	Longitude
1249858.57	3137937.00	40.018197	-105.007504



PROJECT DETAILS: Weld County, CO (NAD83)
Geodetic System: US State Plane 1983
Datum: North American Datum 1983
Ellipsoid: GRS 1980
Zone: Colorado Northern Zone
System Datum: Ground Level
Local North: True

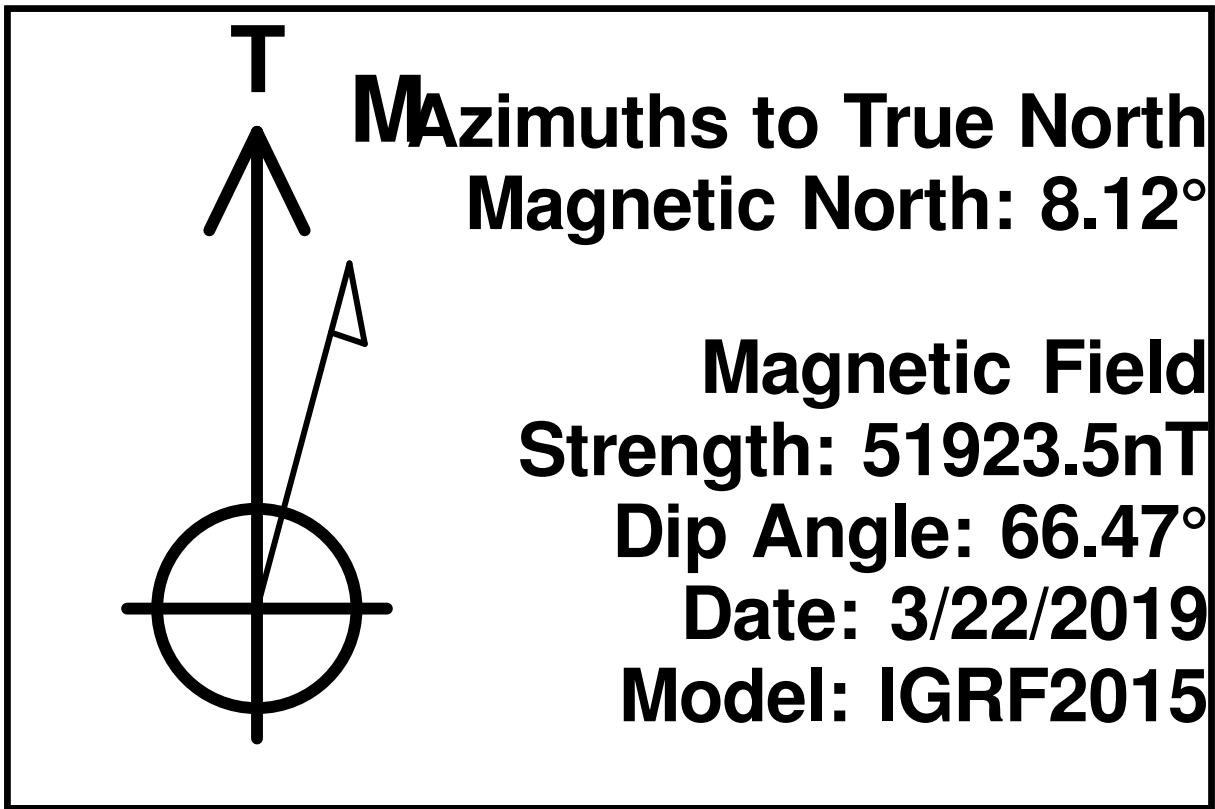

ANNOTATIONS								
MD	Inc	Azi	TVD	+N/-S	+E/-W	VSect	Departure	Annotation
114.00	0.27	73.05	114.00	0.08	0.26	-0.27	0.27	First Surface Survey
1548.00	21.59	175.12	1508.67	-273.11	20.58	92.01	275.82	Last Surface Survey
1669.00	21.30	175.58	1621.30	-317.21	24.17	106.62	320.06	First MWD Survey @ 1669' MD
8408.00	30.00	236.37	7678.32	-3236.42	28.20	1287.50	3271.25	30° Inclination @ 8408.0' MD
8866.50	70.00	262.78	7981.82	-3349.38	-281.91	1616.77	3604.85	70° Inclination @ 8866.5' MD
11540.60	91.91	271.84	8023.11	-3409.02	-2949.00	4078.61	6274.43	Cross @ 11540.6' MD
16247.00	87.94	270.14	8022.83	-3423.28	-7652.76	8383.49	10979.98	Last MWD Survey @ 16247.0' MD
16305.00	87.94	270.14	8024.92	-3423.13	-7710.72	8436.41	11037.94	Projection to TD @ 16305' MD 2174' FNL/ 500' FWL

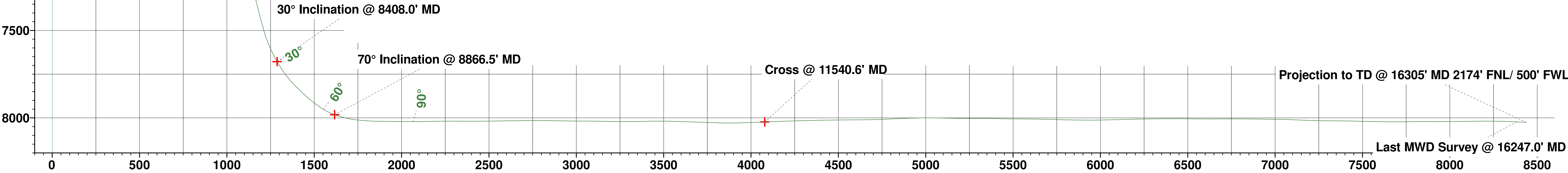
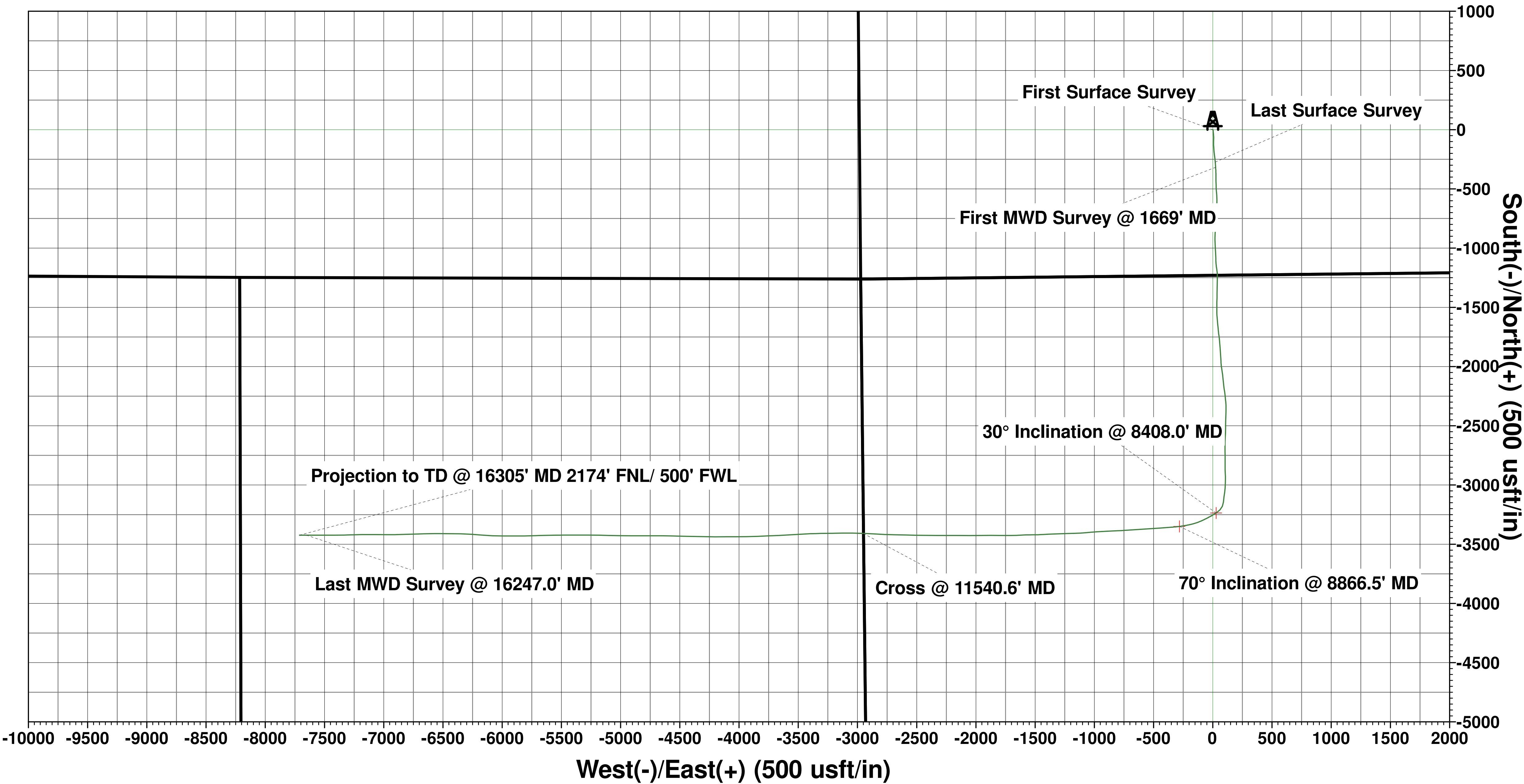

Vertical Section at 246.06° (250 usft/in)