



FRANE SURVEYING INC.

Physical Address: 34834 Annie Cir.
Mail to: Box 2372, Elizabeth, CO 80107
Ph. 303-243-0037
www.franesurveying.com

Job # 19-092-UPRR Baughman Farms #1

Frane Surveying, in accordance with a request from **Kuenzler & Flora Reserve Corp.** has determined the location of **UPRR Baughman Farms #1 (capped well)** to be **681 Feet FSL**, and **675 Feet FEL**, (90° off Section lines) of Section 1, Township 15s, Range 45w of the 6th Principal Meridian, **Cheyenne County**, Colorado.

Date: Staked on 04/26/19 drawn on 04/29/19.

Re: Staked by Elijah Frane

Drawn: Drawn by Elijah Frane

Basis of Elevation Spot: Processed OPUS Solution.

Notes: See location drawing for improvements within 500' of proposed well pad / head.

The ground elevation at staked location = 4275.87' gr.

This drawing does not represent a monumented survey or Land Survey Plat.

Basis of Bearing: Bearings were determined based on the North line of Section 25 to bear N87°53'42"E with all other bearings contained herein relative thereto.

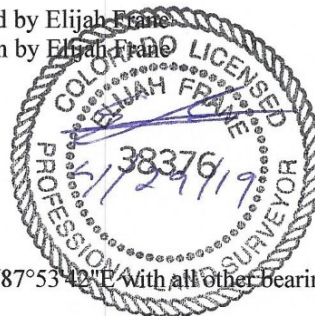

WELL LOCATION MAP

