

PETROLEUM DEVELOPMENT CORP Weld County CO

Well Name: **LaSalle 25E-202**

Surface Location: LaSalle 25F-HZ Pad Sec.25-T5N-R65W
North American Datum 1983 , US State Plane 1983 , Colorado Northern Zone

Ground Elevation: 4655.0

+N/-S	+E/-W	Northing	Easting	Latitude	Longitude	Slot
0.0	0.0	1380261.08	3245132.16	40.373880	-104.620170	
RKB - 15' WELL @ 4670.0ft (RKB - 15')						

FINAL SURVEY

Projected Bottom Hole Location
11775' MD 6765' TVD 1133' N & 5022' E of SHL
91.1 degree Incl @ 90.5 degree AZM

South(-)/North(+) (1500 ft/in)

LaSalle 25E-202

SHL 1300'FNL & 245'FWL

Casing Pt. 147'FNL & 829'FWL

BHL 143'FNL & 51'FEL

460' Setbacks

SEC.25-T5N-R65W

West(-)/East(+) (1500 ft/in)

LaSalle 25F-HZ Pad Sec.25-T5N-R65W
LaSalle 25E-202
Wellbore #1
10:00, November 25 2013

ANNOTATIONS

No annotation data is available.

LEGEND

- LaSalle 25E-202, Wellbore #1, Plan #3 (11-12-13) V0
- Wellbore #1
- Survey #1

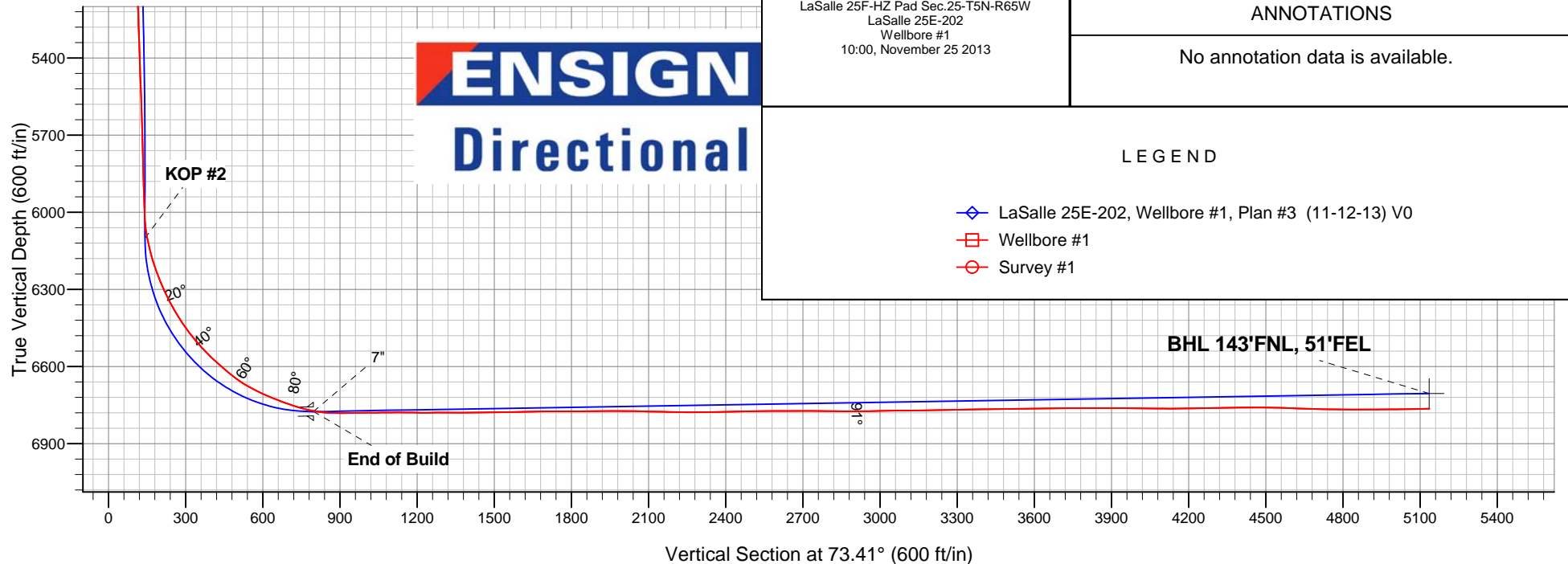



PETROLEUM DEVELOPMENT CORP Weld County CO

SEC.25-T5N-R65W

LaSalle 25F-HZ Pad Sec.25-T5N-R65W

LaSalle 25E-202

Wellbore #1

Survey: Survey #1

Standard Survey Report

25 November, 2013

Survey										
	Measured Depth (ft)	Inclination (°)	Azimuth (°)	Vertical Depth (ft)	+N/-S (ft)	+E/-W (ft)	Vertical Section (ft)	Dogleg Rate (°/100ft)	Build Rate (°/100ft)	Turn Rate (°/100ft)
	0.0	0.00	0.00	0.0	0.0	0.0	0.0	0.00	0.00	0.00
	123.0	0.30	64.90	123.0	0.1	0.3	0.3	0.24	0.24	0.00
	186.0	1.30	20.10	186.0	0.9	0.7	0.9	1.76	1.59	-71.11
	280.0	3.10	6.00	279.9	4.4	1.3	2.5	1.99	1.91	-15.00
	408.0	4.00	10.00	407.7	12.2	2.5	5.8	0.73	0.70	3.13
	534.0	5.90	6.70	533.2	23.0	4.0	10.4	1.52	1.51	-2.62
	659.0	7.50	0.40	657.3	37.5	4.8	15.3	1.41	1.28	-5.04
	786.0	8.80	2.00	783.1	55.5	5.2	20.8	1.04	1.02	1.26
	890.0	10.00	356.70	885.7	72.5	4.9	25.4	1.42	1.15	-5.10
	942.0	10.50	357.60	936.8	81.8	4.5	27.6	1.01	0.96	1.73
	1,005.0	12.10	353.90	998.6	94.1	3.5	30.2	2.79	2.54	-5.87
	1,099.0	13.60	344.90	1,090.3	114.5	-0.4	32.3	2.66	1.60	-9.57

Company:	PETROLEUM DEVELOPMENT CORP Weld County CO	Local Co-ordinate Reference:	Well LaSalle 25E-202
Project:	SEC.25-T5N-R65W	TVD Reference:	WELL @ 4655.0ft (RKB - 15')
Site:	LaSalle 25F-HZ Pad Sec.25-T5N-R65W	MD Reference:	WELL @ 4655.0ft (RKB - 15')
Well:	LaSalle 25E-202	North Reference:	True
Wellbore:	Wellbore #1	Survey Calculation Method:	Minimum Curvature
Design:	Wellbore #1	Database:	Landmark

Survey									
Measured Depth (ft)	Inclination (°)	Azimuth (°)	Vertical Depth (ft)	+N/-S (ft)	+E/-W (ft)	Vertical Section (ft)	Dogleg Rate (°/100ft)	Build Rate (°/100ft)	Turn Rate (°/100ft)
1,194.0	14.00	348.80	1,182.5	136.6	-5.5	33.7	1.07	0.42	4.11
1,321.0	15.60	352.60	1,305.3	168.6	-10.7	37.9	1.47	1.26	2.99
1,442.0	13.00	350.00	1,422.5	198.1	-15.2	42.0	2.21	-2.15	-2.15
1,565.0	12.40	331.20	1,542.6	223.3	-23.9	40.8	3.38	-0.49	-15.28
1,686.0	14.20	324.20	1,660.3	246.8	-38.9	33.2	1.99	1.49	-5.79
1,839.0	12.90	316.10	1,809.1	274.3	-61.7	19.2	1.50	-0.85	-5.29
1,961.0	12.80	313.80	1,928.0	293.5	-80.9	6.2	0.43	-0.08	-1.89
2,113.0	13.80	346.80	2,076.2	322.8	-97.2	-1.0	4.97	0.66	21.71
2,235.0	14.40	351.60	2,194.5	352.0	-102.8	2.0	1.08	0.49	3.93
2,357.0	14.60	349.10	2,312.6	382.1	-107.9	5.7	0.54	0.16	-2.05
2,479.0	13.70	351.40	2,430.9	411.5	-113.0	9.2	0.87	-0.74	1.89
2,605.0	14.60	347.00	2,553.1	441.7	-118.8	12.3	1.11	0.71	-3.49
2,732.0	13.20	354.00	2,676.4	471.7	-123.9	15.9	1.72	-1.10	5.51
2,860.0	13.60	1.80	2,800.9	501.3	-124.9	23.4	1.45	0.31	6.09
2,988.0	12.50	0.40	2,925.6	530.2	-124.4	32.2	0.89	-0.86	-1.09
3,116.0	13.50	359.10	3,050.3	559.0	-124.5	40.2	0.81	0.78	-1.02
3,244.0	13.60	357.20	3,174.8	589.0	-125.5	47.9	0.36	0.08	-1.48
3,371.0	13.50	355.10	3,298.2	618.6	-127.5	54.4	0.40	-0.08	-1.65
3,498.0	12.70	352.30	3,421.9	647.2	-130.6	59.6	0.80	-0.63	-2.20
3,625.0	11.90	349.30	3,546.0	673.9	-134.9	63.1	0.81	-0.63	-2.36
3,753.0	13.20	353.90	3,670.9	701.4	-138.9	67.1	1.28	1.02	3.59
3,881.0	14.00	0.20	3,795.4	731.5	-140.4	74.2	1.31	0.63	4.92
4,008.0	14.00	359.70	3,918.6	762.2	-140.4	83.0	0.10	0.00	-0.39
4,136.0	12.50	356.00	4,043.2	791.5	-141.5	90.3	1.35	-1.17	-2.89
4,263.0	13.30	353.20	4,167.0	819.7	-144.2	95.8	0.80	0.63	-2.20
4,390.0	12.90	349.10	4,290.7	848.1	-148.6	99.7	0.80	-0.31	-3.23
4,518.0	14.20	347.50	4,415.1	877.5	-154.7	102.2	1.06	1.02	-1.25
4,645.0	12.00	341.90	4,538.8	905.3	-162.2	103.0	2.00	-1.73	-4.41
4,772.0	12.00	344.70	4,663.0	930.5	-169.7	103.0	0.46	0.00	2.20
4,899.0	12.40	344.00	4,787.2	956.4	-177.0	103.4	0.34	0.31	-0.55
5,025.0	12.00	347.70	4,910.3	982.2	-183.5	104.5	0.70	-0.32	2.94
5,152.0	13.00	353.70	5,034.3	1,009.3	-187.9	108.0	1.29	0.79	4.72
5,279.0	12.30	353.00	5,158.2	1,036.9	-191.1	112.8	0.56	-0.55	-0.55
5,406.0	10.50	353.50	5,282.7	1,061.8	-194.1	117.1	1.42	-1.42	0.39
5,533.0	9.10	355.50	5,407.9	1,083.3	-196.2	121.3	1.13	-1.10	1.57
5,660.0	7.90	359.30	5,533.5	1,102.1	-197.0	125.7	1.04	-0.94	2.99
5,787.0	6.80	356.20	5,659.4	1,118.3	-197.7	129.8	0.92	-0.87	-2.44
5,914.0	5.50	5.50	5,785.7	1,131.9	-197.6	133.8	1.29	-1.02	7.32
6,041.0	2.70	358.80	5,912.3	1,140.9	-197.0	136.8	2.23	-2.20	-5.28
6,104.0	2.70	31.00	5,975.3	1,143.7	-196.3	138.3	2.38	0.00	51.11
6,136.0	3.10	48.70	6,007.2	1,144.9	-195.3	139.7	3.05	1.25	55.31
6,167.0	4.80	67.90	6,038.2	1,145.9	-193.4	141.7	6.88	5.48	61.94
6,199.0	8.10	81.40	6,070.0	1,146.8	-190.0	145.3	11.28	10.31	42.19
6,231.0	11.50	88.10	6,101.5	1,147.2	-184.6	150.6	11.19	10.63	20.94
6,263.0	13.90	91.80	6,132.7	1,147.2	-177.5	157.3	7.92	7.50	11.56
6,295.0	16.20	93.40	6,163.6	1,146.8	-169.2	165.2	7.30	7.19	5.00
6,327.0	18.20	93.00	6,194.2	1,146.3	-159.8	174.1	6.26	6.25	-1.25
6,359.0	20.40	92.70	6,224.4	1,145.8	-149.2	184.1	6.88	6.88	-0.94
6,390.0	22.20	92.70	6,253.3	1,145.2	-138.0	194.7	5.81	5.81	0.00
6,422.0	24.40	91.60	6,282.6	1,144.8	-125.3	206.7	7.01	6.88	-3.44
6,453.0	26.30	90.00	6,310.7	1,144.6	-112.0	219.3	6.51	6.13	-5.16
6,485.0	28.00	90.20	6,339.1	1,144.6	-97.4	233.3	5.32	5.31	0.63
6,517.0	29.60	89.70	6,367.2	1,144.6	-82.0	248.1	5.06	5.00	-1.56

Company:	PETROLEUM DEVELOPMENT CORP Weld County CO	Local Co-ordinate Reference:	Well LaSalle 25E-202
Project:	SEC.25-T5N-R65W	TVD Reference:	WELL @ 4655.0ft (RKB - 15')
Site:	LaSalle 25F-HZ Pad Sec.25-T5N-R65W	MD Reference:	WELL @ 4655.0ft (RKB - 15')
Well:	LaSalle 25E-202	North Reference:	True
Wellbore:	Wellbore #1	Survey Calculation Method:	Minimum Curvature
Design:	Wellbore #1	Database:	Landmark

Survey									
Measured Depth (ft)	Inclination (°)	Azimuth (°)	Vertical Depth (ft)	+N/-S (ft)	+E/-W (ft)	Vertical Section (ft)	Dogleg Rate (°/100ft)	Build Rate (°/100ft)	Turn Rate (°/100ft)
6,549.0	31.50	89.00	6,394.7	1,144.8	-65.8	263.7	6.04	5.94	-2.19
6,580.0	34.20	88.80	6,420.8	1,145.1	-49.0	280.0	8.72	8.71	-0.65
6,612.0	36.10	89.30	6,446.9	1,145.4	-30.5	297.7	6.01	5.94	1.56
6,644.0	39.00	88.60	6,472.3	1,145.8	-11.0	316.5	9.16	9.06	-2.19
6,675.0	40.90	89.80	6,496.1	1,146.0	8.9	335.6	6.61	6.13	3.87
6,707.0	43.40	90.00	6,519.8	1,146.1	30.3	356.2	7.82	7.81	0.63
6,738.0	45.50	90.90	6,541.9	1,145.9	52.0	377.0	7.07	6.77	2.90
6,770.0	47.40	91.60	6,564.0	1,145.4	75.2	399.1	6.15	5.94	2.19
6,802.0	49.40	92.00	6,585.2	1,144.6	99.1	421.8	6.32	6.25	1.25
6,834.0	50.50	91.80	6,605.8	1,143.8	123.6	445.0	3.47	3.44	-0.63
6,866.0	52.10	91.80	6,625.8	1,143.0	148.6	468.7	5.00	5.00	0.00
6,898.0	54.30	90.20	6,645.0	1,142.6	174.2	493.1	7.96	6.88	-5.00
6,929.0	57.90	88.10	6,662.3	1,143.0	199.9	517.9	12.90	11.61	-6.77
6,961.0	61.10	86.30	6,678.5	1,144.3	227.5	544.7	11.11	10.00	-5.63
6,993.0	63.40	86.20	6,693.4	1,146.2	255.7	572.3	7.19	7.19	-0.31
7,024.0	66.30	86.70	6,706.6	1,147.9	283.7	599.6	9.47	9.35	1.61
7,056.0	68.10	87.21	6,719.0	1,149.5	313.2	628.3	5.81	5.63	1.59
7,088.0	69.30	87.40	6,730.6	1,150.9	343.0	657.2	3.79	3.75	0.59
7,120.0	70.70	88.60	6,741.5	1,151.9	373.0	686.3	5.62	4.38	3.75
7,151.0	72.10	89.80	6,751.4	1,152.4	402.4	714.6	5.82	4.52	3.87
7,183.0	74.50	90.50	6,760.6	1,152.3	433.0	743.9	7.79	7.50	2.19
7,215.0	77.60	90.50	6,768.3	1,152.0	464.1	773.6	9.69	9.69	0.00
7,247.0	80.60	90.00	6,774.4	1,151.9	495.5	803.7	9.50	9.38	-1.56
7,279.0	84.10	89.00	6,778.7	1,152.1	527.2	834.2	11.37	10.94	-3.13
7,301.0	86.20	89.00	6,780.5	1,152.5	549.1	855.3	9.55	9.55	0.00
7,336.0	90.50	88.70	6,781.5	1,153.2	584.1	889.0	12.32	12.29	-0.86
7,366.0	90.80	88.40	6,781.2	1,154.0	614.1	917.9	1.41	1.00	-1.00
7,397.0	91.00	88.60	6,780.7	1,154.8	645.1	947.9	0.91	0.65	0.65
7,427.0	90.30	89.10	6,780.4	1,155.4	675.1	976.8	2.87	-2.33	1.67
7,458.0	90.10	89.70	6,780.2	1,155.7	706.1	1,006.6	2.04	-0.65	1.94
7,488.0	90.50	90.40	6,780.1	1,155.7	736.1	1,035.3	2.69	1.33	2.33
7,518.0	90.70	90.40	6,779.8	1,155.5	766.1	1,064.0	0.67	0.67	0.00
7,550.0	90.70	90.20	6,779.4	1,155.3	798.1	1,094.6	0.62	0.00	-0.63
7,582.0	90.00	90.90	6,779.2	1,155.0	830.1	1,125.2	3.09	-2.19	2.19
7,613.0	89.60	90.90	6,779.3	1,154.5	861.0	1,154.8	1.29	-1.29	0.00
7,645.0	89.30	91.10	6,779.6	1,154.0	893.0	1,185.3	1.13	-0.94	0.63
7,676.0	89.70	91.10	6,779.9	1,153.4	924.0	1,214.8	1.29	1.29	0.00
7,708.0	90.00	91.10	6,780.0	1,152.8	956.0	1,245.3	0.94	0.94	0.00
7,739.0	90.60	90.70	6,779.8	1,152.3	987.0	1,274.9	2.33	1.94	-1.29
7,771.0	90.00	90.40	6,779.6	1,152.0	1,019.0	1,305.5	2.10	-1.88	-0.94
7,803.0	89.70	89.70	6,779.7	1,151.9	1,051.0	1,336.1	2.38	-0.94	-2.19
7,835.0	89.90	89.50	6,779.8	1,152.2	1,083.0	1,366.8	0.88	0.63	-0.63
7,867.0	90.40	89.50	6,779.7	1,152.4	1,115.0	1,397.6	1.56	1.56	0.00
7,899.0	90.30	89.50	6,779.5	1,152.7	1,147.0	1,428.3	0.31	-0.31	0.00
7,931.0	90.30	89.70	6,779.4	1,152.9	1,179.0	1,459.1	0.62	0.00	0.63
7,962.0	90.70	90.70	6,779.1	1,152.8	1,210.0	1,488.7	3.47	1.29	3.23
7,994.0	91.10	91.40	6,778.6	1,152.2	1,242.0	1,519.2	2.52	1.25	2.19
8,026.0	91.70	91.60	6,777.8	1,151.4	1,274.0	1,549.7	1.98	1.88	0.63
8,057.0	91.60	91.30	6,776.9	1,150.6	1,305.0	1,579.1	1.02	-0.32	-0.97
8,089.0	90.90	91.10	6,776.2	1,150.0	1,336.9	1,609.6	2.27	-2.19	-0.63
8,121.0	90.70	90.50	6,775.8	1,149.5	1,368.9	1,640.1	1.98	-0.63	-1.88
8,153.0	91.20	90.00	6,775.2	1,149.4	1,400.9	1,670.7	2.21	1.56	-1.56
8,184.0	90.70	89.10	6,774.7	1,149.6	1,431.9	1,700.5	3.32	-1.61	-2.90
8,216.0	90.10	89.70	6,774.5	1,149.9	1,463.9	1,731.3	2.65	-1.88	1.88

Company:	PETROLEUM DEVELOPMENT CORP Weld County CO	Local Co-ordinate Reference:	Well LaSalle 25E-202
Project:	SEC.25-T5N-R65W	TVD Reference:	WELL @ 4655.0ft (RKB - 15')
Site:	LaSalle 25F-HZ Pad Sec.25-T5N-R65W	MD Reference:	WELL @ 4655.0ft (RKB - 15')
Well:	LaSalle 25E-202	North Reference:	True
Wellbore:	Wellbore #1	Survey Calculation Method:	Minimum Curvature
Design:	Wellbore #1	Database:	Landmark

Survey									
Measured Depth (ft)	Inclination (°)	Azimuth (°)	Vertical Depth (ft)	+N/-S (ft)	+E/-W (ft)	Vertical Section (ft)	Dogleg Rate (°/100ft)	Build Rate (°/100ft)	Turn Rate (°/100ft)
8,247.0	89.90	89.80	6,774.5	1,150.1	1,494.9	1,761.0	0.72	-0.65	0.32
8,279.0	90.10	91.10	6,774.5	1,149.8	1,526.9	1,791.6	4.11	0.63	4.06
8,311.0	90.10	91.10	6,774.5	1,149.2	1,558.9	1,822.1	0.00	0.00	0.00
8,343.0	90.40	90.70	6,774.3	1,148.7	1,590.9	1,852.6	1.56	0.94	-1.25
8,374.0	90.70	90.20	6,774.0	1,148.5	1,621.9	1,882.3	1.88	0.97	-1.61
8,406.0	90.50	89.80	6,773.7	1,148.5	1,653.9	1,912.9	1.40	-0.63	-1.25
8,438.0	90.70	89.80	6,773.3	1,148.6	1,685.9	1,943.6	0.63	0.63	0.00
8,469.0	90.00	90.00	6,773.2	1,148.6	1,716.9	1,973.4	2.35	-2.26	0.65
8,501.0	88.80	91.10	6,773.5	1,148.3	1,748.9	2,003.9	5.09	-3.75	3.44
8,533.0	88.70	91.10	6,774.2	1,147.7	1,780.9	2,034.4	0.31	-0.31	0.00
8,565.0	88.70	90.70	6,774.9	1,147.2	1,812.9	2,064.9	1.25	0.00	-1.25
8,596.0	89.00	90.50	6,775.5	1,146.9	1,843.9	2,094.5	1.16	0.97	-0.65
8,628.0	89.00	89.80	6,776.1	1,146.8	1,875.9	2,125.2	2.19	0.00	-2.19
8,660.0	88.90	89.80	6,776.7	1,146.9	1,907.9	2,155.9	0.31	-0.31	0.00
8,692.0	89.20	89.10	6,777.2	1,147.2	1,939.9	2,186.6	2.38	0.94	-2.19
8,723.0	88.80	89.80	6,777.8	1,147.5	1,970.8	2,216.4	2.60	-1.29	2.26
8,755.0	89.10	90.70	6,778.3	1,147.4	2,002.8	2,247.0	2.96	0.94	2.81
8,787.0	90.00	91.80	6,778.6	1,146.7	2,034.8	2,277.5	4.44	2.81	3.44
8,818.0	91.60	92.30	6,778.2	1,145.6	2,065.8	2,306.9	5.41	5.16	1.61
8,850.0	90.70	92.10	6,777.5	1,144.3	2,097.8	2,337.2	2.88	-2.81	-0.63
8,882.0	91.30	92.00	6,777.0	1,143.2	2,129.7	2,367.5	1.90	1.88	-0.31
8,914.0	91.40	91.40	6,776.2	1,142.3	2,161.7	2,397.8	1.90	0.31	-1.88
8,945.0	91.00	90.00	6,775.6	1,141.9	2,192.7	2,427.4	4.70	-1.29	-4.52
8,977.0	90.70	90.50	6,775.1	1,141.7	2,224.7	2,458.1	1.82	-0.94	1.56
9,009.0	90.90	91.60	6,774.6	1,141.1	2,256.7	2,488.6	3.49	0.63	3.44
9,041.0	91.00	91.40	6,774.1	1,140.3	2,288.7	2,519.0	0.70	0.31	-0.63
9,072.0	90.10	89.70	6,773.8	1,140.0	2,319.7	2,548.6	6.20	-2.90	-5.48
9,104.0	90.20	88.80	6,773.7	1,140.4	2,351.7	2,579.4	2.83	0.31	-2.81
9,136.0	90.40	88.10	6,773.6	1,141.3	2,383.7	2,610.3	2.28	0.63	-2.19
9,167.0	90.00	88.40	6,773.4	1,142.2	2,414.7	2,640.2	1.61	-1.29	0.97
9,199.0	90.20	89.00	6,773.4	1,143.0	2,446.6	2,671.1	1.98	0.63	1.88
9,231.0	90.30	89.50	6,773.3	1,143.4	2,478.6	2,701.9	1.59	0.31	1.56
9,263.0	89.60	90.50	6,773.3	1,143.4	2,510.6	2,732.6	3.81	-2.19	3.13
9,294.0	89.60	91.10	6,773.5	1,143.0	2,541.6	2,762.1	1.94	0.00	1.94
9,326.0	89.80	90.50	6,773.7	1,142.5	2,573.6	2,792.7	1.98	0.63	-1.88
9,358.0	89.50	90.70	6,773.9	1,142.2	2,605.6	2,823.3	1.13	-0.94	0.63
9,389.0	89.50	91.30	6,774.1	1,141.6	2,636.6	2,852.8	1.94	0.00	1.94
9,421.0	89.50	92.00	6,774.4	1,140.7	2,668.6	2,883.2	2.19	0.00	2.19
9,453.0	90.10	93.20	6,774.5	1,139.3	2,700.6	2,913.4	4.19	1.88	3.75
9,484.0	91.50	94.10	6,774.1	1,137.3	2,731.5	2,942.5	5.37	4.52	2.90
9,516.0	91.50	93.70	6,773.3	1,135.1	2,763.4	2,972.5	1.25	0.00	-1.25
9,548.0	90.70	93.50	6,772.6	1,133.1	2,795.4	3,002.5	2.58	-2.50	-0.63
9,579.0	90.70	93.00	6,772.3	1,131.3	2,826.3	3,031.7	1.61	0.00	-1.61
9,611.0	90.50	93.40	6,771.9	1,129.6	2,858.3	3,061.8	1.40	-0.63	1.25
9,643.0	90.30	92.70	6,771.7	1,127.9	2,890.2	3,091.9	2.27	-0.63	-2.19
9,674.0	90.80	92.10	6,771.4	1,126.6	2,921.2	3,121.2	2.52	1.61	-1.94
9,706.0	91.00	91.10	6,770.9	1,125.7	2,953.2	3,151.6	3.19	0.63	-3.13
9,738.0	90.70	90.50	6,770.4	1,125.2	2,985.2	3,182.1	2.10	-0.94	-1.88
9,770.0	90.70	89.50	6,770.0	1,125.2	3,017.1	3,212.8	3.12	0.00	-3.13
9,801.0	90.60	89.00	6,769.7	1,125.6	3,048.1	3,242.6	1.64	-0.32	-1.61
9,833.0	90.40	89.00	6,769.4	1,126.2	3,080.1	3,273.5	0.63	-0.63	0.00
9,865.0	91.00	89.80	6,769.0	1,126.5	3,112.1	3,304.2	3.12	1.88	2.50
9,897.0	91.80	90.20	6,768.2	1,126.5	3,144.1	3,334.9	2.79	2.50	1.25

Company:	PETROLEUM DEVELOPMENT CORP Weld County CO	Local Co-ordinate Reference:	Well LaSalle 25E-202
Project:	SEC.25-T5N-R65W	TVD Reference:	WELL @ 4655.0ft (RKB - 15')
Site:	LaSalle 25F-HZ Pad Sec.25-T5N-R65W	MD Reference:	WELL @ 4655.0ft (RKB - 15')
Well:	LaSalle 25E-202	North Reference:	True
Wellbore:	Wellbore #1	Survey Calculation Method:	Minimum Curvature
Design:	Wellbore #1	Database:	Landmark

Survey									
Measured Depth (ft)	Inclination (°)	Azimuth (°)	Vertical Depth (ft)	+N/-S (ft)	+E/-W (ft)	Vertical Section (ft)	Dogleg Rate (°/100ft)	Build Rate (°/100ft)	Turn Rate (°/100ft)
9,928.0	91.50	89.30	6,767.3	1,126.7	3,175.1	3,364.6	3.06	-0.97	-2.90
9,960.0	90.70	88.30	6,766.7	1,127.3	3,207.1	3,395.5	4.00	-2.50	-3.13
9,992.0	90.80	88.30	6,766.3	1,128.3	3,239.1	3,426.4	0.31	0.31	0.00
10,023.0	91.00	89.00	6,765.8	1,129.0	3,270.1	3,456.3	2.35	0.65	2.26
10,055.0	91.10	89.70	6,765.2	1,129.4	3,302.1	3,487.1	2.21	0.31	2.19
10,086.0	90.70	89.30	6,764.7	1,129.6	3,333.1	3,516.8	1.82	-1.29	-1.29
10,118.0	91.10	89.70	6,764.2	1,129.9	3,365.0	3,547.6	1.77	1.25	1.25
10,150.0	91.40	90.40	6,763.5	1,129.9	3,397.0	3,578.2	2.38	0.94	2.19
10,181.0	90.60	90.90	6,763.0	1,129.5	3,428.0	3,607.8	3.04	-2.58	1.61
10,213.0	90.20	90.70	6,762.8	1,129.1	3,460.0	3,638.4	1.40	-1.25	-0.63
10,245.0	90.20	90.00	6,762.7	1,128.9	3,492.0	3,669.0	2.19	0.00	-2.19
10,277.0	90.30	88.80	6,762.5	1,129.2	3,524.0	3,699.7	3.76	0.31	-3.75
10,309.0	90.20	88.40	6,762.4	1,130.0	3,556.0	3,730.6	1.29	-0.31	-1.25
10,340.0	90.10	88.30	6,762.3	1,130.9	3,587.0	3,760.6	0.46	-0.32	-0.32
10,372.0	90.10	88.30	6,762.3	1,131.9	3,619.0	3,791.5	0.00	0.00	0.00
10,403.0	90.10	87.40	6,762.2	1,133.0	3,650.0	3,821.5	2.90	0.00	-2.90
10,436.0	90.00	88.60	6,762.2	1,134.2	3,682.9	3,853.5	3.65	-0.30	3.64
10,467.0	89.60	90.00	6,762.3	1,134.5	3,713.9	3,883.3	4.70	-1.29	4.52
10,499.0	89.40	90.40	6,762.6	1,134.4	3,745.9	3,913.9	1.40	-0.63	1.25
10,530.0	89.60	89.70	6,762.8	1,134.4	3,776.9	3,943.6	2.35	0.65	-2.26
10,562.0	89.90	90.00	6,763.0	1,134.5	3,808.9	3,974.3	1.33	0.94	0.94
10,597.0	89.60	90.70	6,763.1	1,134.3	3,843.9	4,007.8	2.18	-0.86	2.00
10,629.0	89.30	90.90	6,763.4	1,133.8	3,875.9	4,038.3	1.13	-0.94	0.63
10,661.0	89.30	90.70	6,763.8	1,133.4	3,907.9	4,068.9	0.62	0.00	-0.63
10,692.0	89.30	90.50	6,764.2	1,133.1	3,938.9	4,098.5	0.65	0.00	-0.65
10,724.0	90.10	90.00	6,764.4	1,132.9	3,970.9	4,129.1	2.95	2.50	-1.56
10,756.0	90.60	89.30	6,764.2	1,133.1	4,002.9	4,159.8	2.69	1.56	-2.19
10,787.0	90.90	89.10	6,763.8	1,133.5	4,033.9	4,189.6	1.16	0.97	-0.65
10,819.0	91.00	89.50	6,763.2	1,133.9	4,065.9	4,220.4	1.29	0.31	1.25
10,851.0	91.60	89.00	6,762.5	1,134.4	4,097.9	4,251.2	2.44	1.88	-1.56
10,883.0	91.00	89.10	6,761.8	1,134.9	4,129.9	4,282.0	1.90	-1.88	0.31
10,914.0	90.70	89.00	6,761.3	1,135.4	4,160.9	4,311.9	1.02	-0.97	-0.32
10,947.0	90.90	88.30	6,760.9	1,136.2	4,193.9	4,343.7	2.21	0.61	-2.12
10,978.0	90.60	88.10	6,760.5	1,137.2	4,224.8	4,373.7	1.16	-0.97	-0.65
11,010.0	90.50	88.60	6,760.1	1,138.1	4,256.8	4,404.6	1.59	-0.31	1.56
11,042.0	90.70	89.00	6,759.8	1,138.7	4,288.8	4,435.4	1.40	0.63	1.25
11,073.0	90.40	89.00	6,759.5	1,139.3	4,319.8	4,465.3	0.97	-0.97	0.00
11,105.0	89.30	89.30	6,759.6	1,139.8	4,351.8	4,496.1	3.56	-3.44	0.94
11,137.0	88.70	90.00	6,760.2	1,140.0	4,383.8	4,526.8	2.88	-1.88	2.19
11,168.0	88.80	90.00	6,760.8	1,140.0	4,414.8	4,556.5	0.32	0.32	0.00
11,200.0	87.80	90.90	6,761.8	1,139.7	4,446.8	4,587.1	4.20	-3.13	2.81
11,231.0	87.60	91.40	6,763.0	1,139.1	4,477.8	4,616.6	1.74	-0.65	1.61
11,263.0	87.80	90.90	6,764.3	1,138.4	4,509.7	4,647.1	1.68	0.63	-1.56
11,295.0	88.40	91.10	6,765.4	1,137.9	4,541.7	4,677.5	1.98	1.88	0.63
11,326.0	88.90	91.60	6,766.1	1,137.2	4,572.7	4,707.0	2.28	1.61	1.61
11,358.0	89.10	91.80	6,766.7	1,136.2	4,604.7	4,737.4	0.88	0.63	0.63
11,390.0	89.30	91.10	6,767.1	1,135.4	4,636.6	4,767.8	2.27	0.63	-2.19
11,422.0	89.30	90.70	6,767.5	1,134.9	4,668.6	4,798.3	1.25	0.00	-1.25
11,453.0	89.70	90.40	6,767.8	1,134.6	4,699.6	4,828.0	1.61	1.29	-0.97
11,485.0	90.10	90.00	6,767.8	1,134.5	4,731.6	4,858.6	1.77	1.25	-1.25
11,517.0	90.10	89.80	6,767.8	1,134.5	4,763.6	4,889.3	0.63	0.00	-0.63
11,549.0	90.30	90.00	6,767.7	1,134.6	4,795.6	4,920.0	0.88	0.63	0.63
11,580.0	90.70	89.50	6,767.4	1,134.7	4,826.6	4,949.7	2.07	1.29	-1.61

Company:	PETROLEUM DEVELOPMENT CORP Weld County CO	Local Co-ordinate Reference:	Well LaSalle 25E-202
Project:	SEC.25-T5N-R65W	TVD Reference:	WELL @ 4655.0ft (RKB - 15')
Site:	LaSalle 25F-HZ Pad Sec.25-T5N-R65W	MD Reference:	WELL @ 4655.0ft (RKB - 15')
Well:	LaSalle 25E-202	North Reference:	True
Wellbore:	Wellbore #1	Survey Calculation Method:	Minimum Curvature
Design:	Wellbore #1	Database:	Landmark

Survey									
Measured Depth (ft)	Inclination (°)	Azimuth (°)	Vertical Depth (ft)	+N/-S (ft)	+E/-W (ft)	Vertical Section (ft)	Dogleg Rate (°/100ft)	Build Rate (°/100ft)	Turn Rate (°/100ft)
11,612.0	90.50	90.40	6,767.1	1,134.8	4,858.6	4,980.4	2.88	-0.63	2.81
11,644.0	90.70	90.50	6,766.7	1,134.5	4,890.6	5,011.0	0.70	0.63	0.31
11,676.0	90.80	91.10	6,766.3	1,134.1	4,922.6	5,041.5	1.90	0.31	1.88
11,707.0	91.00	90.70	6,765.8	1,133.6	4,953.6	5,071.1	1.44	0.65	-1.29
11,720.0	91.10	90.50	6,765.6	1,133.4	4,966.6	5,083.5	1.72	0.77	-1.54
11,775.0	91.10	90.50	6,764.5	1,133.0	5,021.6	5,136.1	0.00	0.00	0.00
BHL 150'FNL, 50'FEL									

Checked By: _____	Approved By: _____	Date: _____
-------------------	--------------------	-------------