

NEW ELK 25-10-2
2200' FSL & 2369' FEL
Sec. 25, T33S, R68W, 6th P.M.

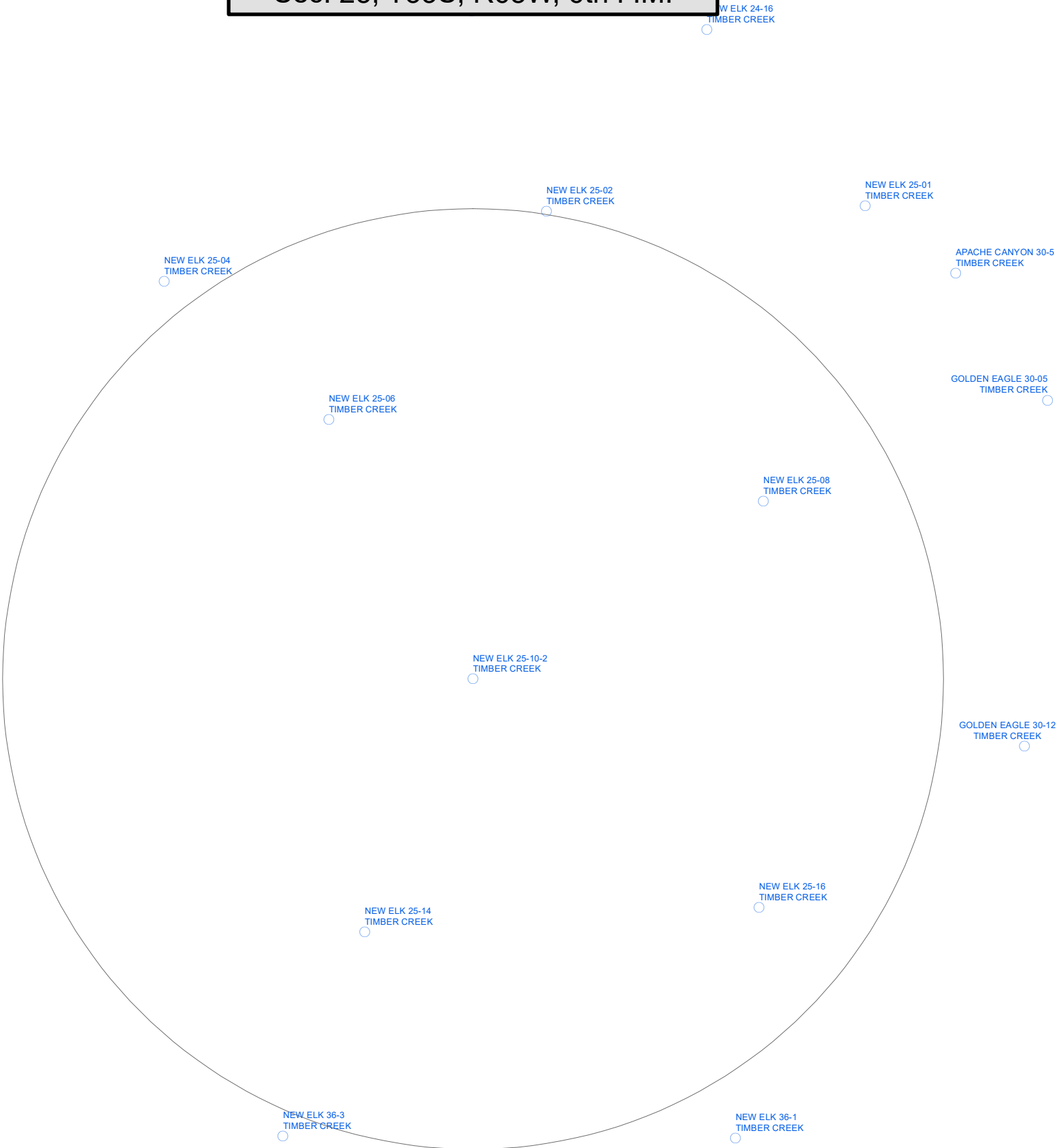

1/2 Mile Radius

Non Op Well that falls within a 1/2 mile radius

-Well name

-Operator

Non Op Well

-Well name

-Operator

Timber Creek Well

-Well name

-Operator



1 inch = 733 feet