

NEW ELK 25-06
1615' FNL & 2119' FWL
Sec. 25, T33S, R68W, 6th P.M.

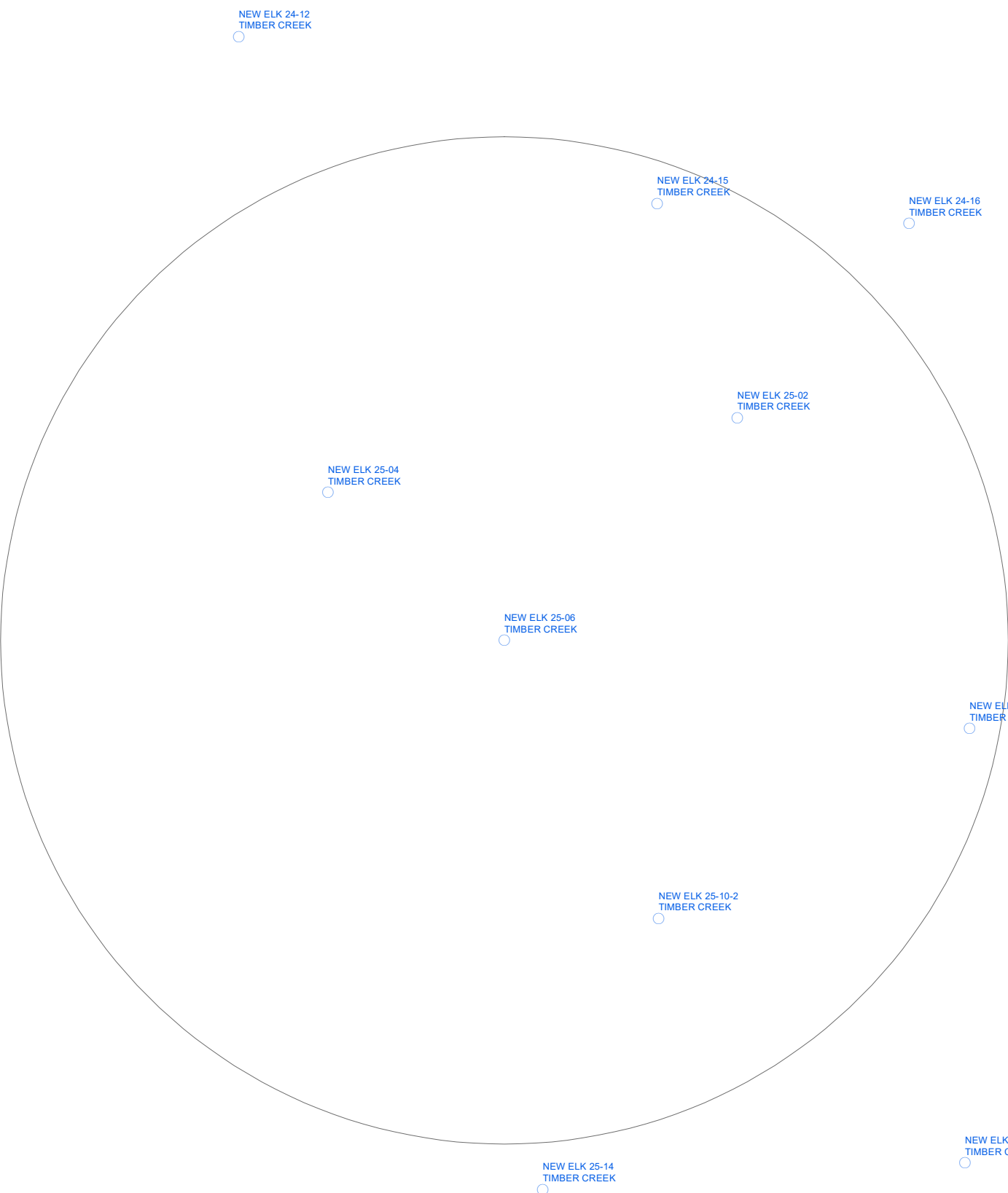

1/2 Mile Radius

- Non Op Well that falls within a 1/2 mile radius
 -Well name
 -Operator
- Non Op Well
 -Well name
 -Operator
- Timber Creek Well
 -Well name
 -Operator



1 inch = 733 feet