

HILL RANCH 22-8
2577' FNL & 722' FEL
Sec. 22, T34S, R67W, 6th P.M.

HILL RANCH EAST 14-14
TIMBER CREEK

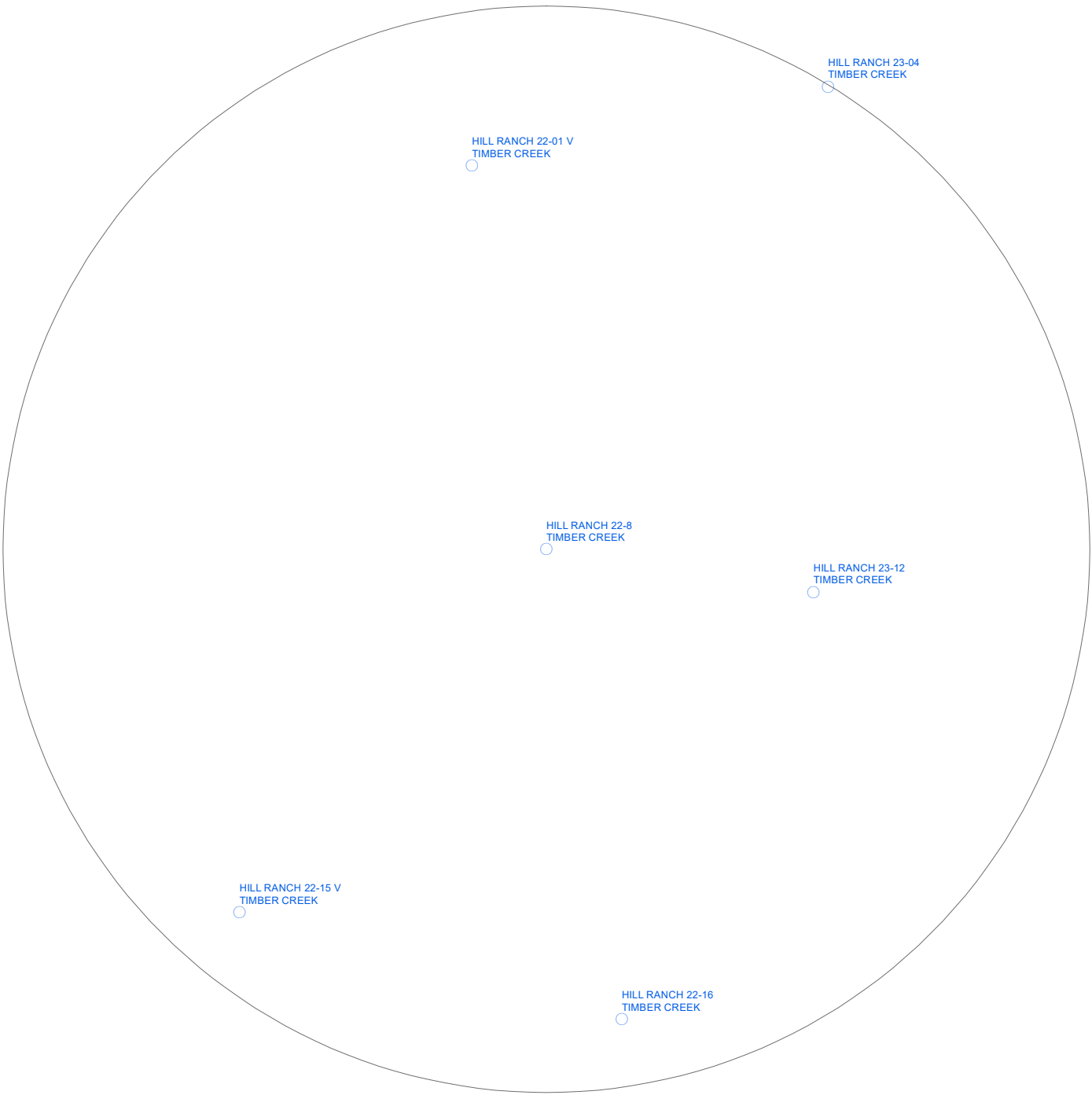

1/2 Mile Radius

- Non Op Well that falls within a 1/2 mile radius
-Well name
-Operator
- Non Op Well
-Well name
-Operator
- Timber Creek Well
-Well name
-Operator



1 inch = 733 feet