

GOLDEN EAGLE 31-04
819' FNL & 915' FWL
Sec. 31, T33S, R67W, 6th P.M.

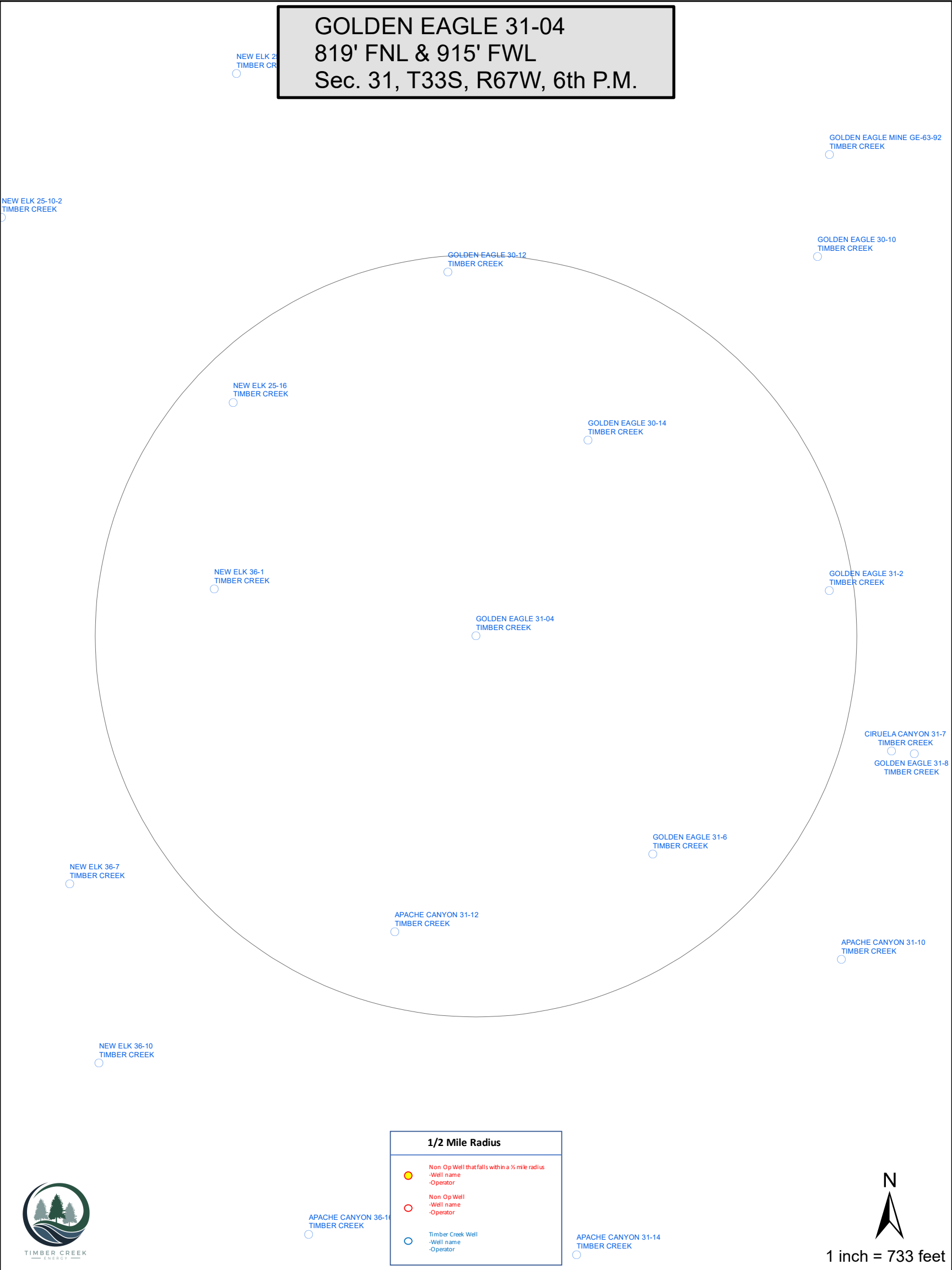

1/2 Mile Radius

- Non Op Well that falls within a 1/2 mile radius
-Well name
-Operator
- Non Op Well
-Well name
-Operator
- Timber Creek Well
-Well name
-Operator



1 inch = 733 feet