



RECEIVED  
FEB 24 1959

Company COX AND HONOLULU EXPLORATION  
AND DRILLING CORPORATION

Lease A. L. KROEGER

Well No. 1-B

Sec. 33 T. 33 N R. 12 W NMPM

Location 660'/south line, and 660'/east line

Elevation: 6489' G. L.

LA PLATA COUNTY

COLORADO

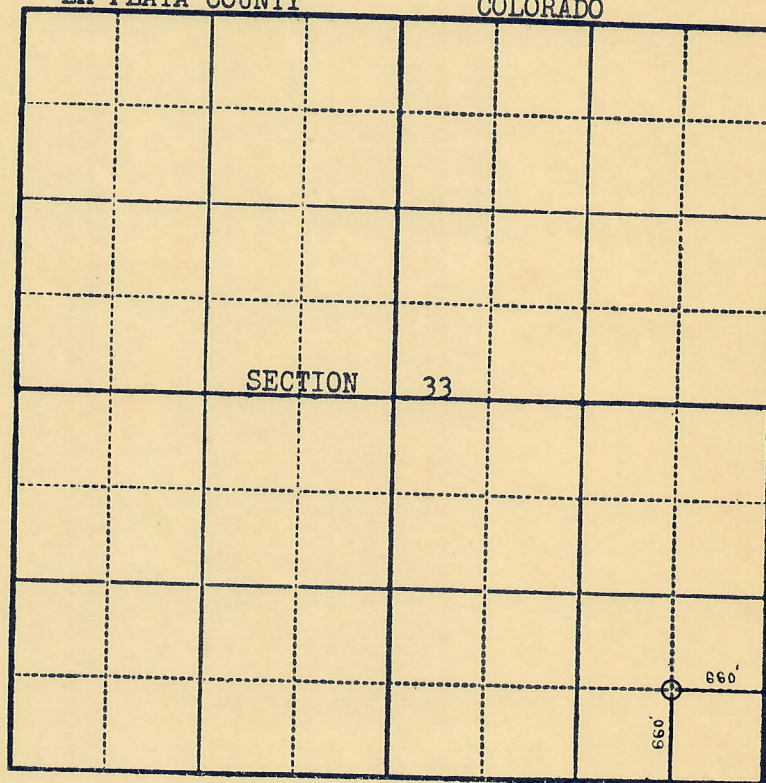

Scale—4 inches equal 1 mile.

This is to certify that the above plat was prepared from field notes of actual surveys made by me or under my supervision and that the same are true and correct to the best of my knowledge and belief.

Stephen H. Kinney  
STEPHEN H. KINNEY  
Registered Professional  
Engineer and Land Surveyor

Surveyed February 18, 19 59

