

FRANE SURVEYING INC.

Physical Address: 34834 Annie Cir.
Mail to: Box 2372, Elizabeth, CO 80107
Ph. 303-243-0037
www.franesurveying.com
Job # 18-132-Millican #1-7

Frane Surveying of Elizabeth, Colorado, has in accordance with a request from **Waulco Resources LLC** has determined the location of **Millican #1-7** to be **1077 feet FNL**, and **211 feet FEL**, of SECTION **7**, Township **32s**, Range **47w** of the 6th Principal Meridian, **Baca**, Colorado.

Date: Staked on 06/06/18 drawn on 06/12/18.

Re:
Drawn:

Staked by Elijah Frane
Drawn by Elijah Frane

Location Drawing

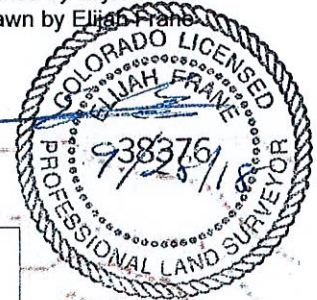

A barbed wire fence falls 20' East and 81' East of the proposed well pad. An overhead powerline falls 81' East of proposed well pad and 243' East of proposed well head.

