



March 19, 2019

Mr. Jeff Robbins, Director
Colorado Oil and Gas Conservation Commission
1120 Lincoln Street, Suite 801
Denver, CO 80203

RE: COGCC Rule 318A.e.: Proposed Wellbore Spacing Unit

Volt 11C-3-L

5N-66W Sec 3: SW/4, W/2SE/4; Sec. 4: S/2; Sec. 5: E/2SW/4, SE/4

Dear Director Robbins,

SRC Energy Inc. ("SRC Energy") is planning to drill the above referenced well in accordance with the provisions set out in COGCC Rule 318A.e. SRC Energy's proposed wellbore spacing unit consists of:

Volt 11C-3-L

5N-66W Sec 3: SW/4, W/2SE/4; Sec. 4: S/2; Sec. 5: E/2SW/4, SE/4

876.02 Acres

SRC Energy is not the only owner within the proposed wellbore spacing unit and hereby certifies to the Director that a thirty day (30-day) notice has been given by certified mail to all owners in the proposed wellbore spacing unit, as required by COGCC Rule 318A.e. (5). Copies of the required notification letters are on file at SRC Energy's office. The required thirty (30) day notice period has elapsed absent the receipt by SRC Energy of any objection to their proposal by the owner(s) within the proposed spacing unit for the subject well. We have not received any objections to such well location or proposed spacing unit, therefore, SRC Energy hereby requests the Director approve the well.

Enclosed is the Proposed Spacing Unit Plat to assist in your review and approval of SRC Energy's proposed Application for Permit to Drill (APD) for Volt 11C-3-L well. SRC Energy respectfully requests the COGCC to review the enclosed information and approve the exception location waiver request per Surface Use Agreement and APD for Volt 11C-3-L.

Thank you,
Erin Ekblad
Erin Ekblad
Manager of Regulatory Affairs
SRC Energy Inc.

Attachment: Proposed Spacing Unit Plat



VOLT 11C-3-L WELLBORE SPACING UNIT

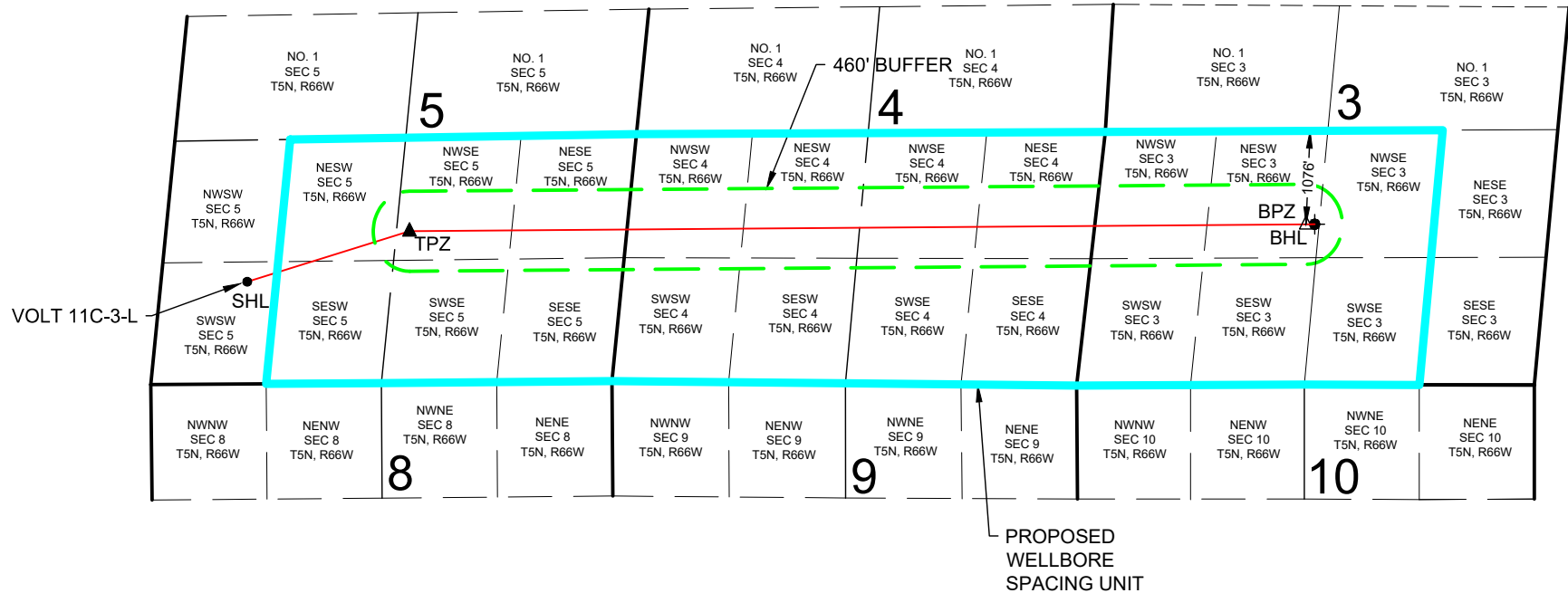

VOLT 11C-3-L WELL TO BE LOCATED 1177' FSL AND 987' FWL, SEC 5, T5N, R66W

DISTANCE FROM COMPLETED
PORTION OF WELLBORE TO
NEAREST UNIT BOUNDARY = 1076'

LEGEND

- = PROPOSED WELL
- = BOTTOM HOLE
- △ = BOTTOM OF PRODUCTION ZONE
- ▲ = TOP OF PRODUCTION ZONE
- SHL = SURFACE HOLE LOCATION
- BHL = BOTTOM HOLE LOCATION
- BPZ = BOTTOM OF PRODUCTION ZONE
- TPZ = TOP OF PRODUCTION ZONE

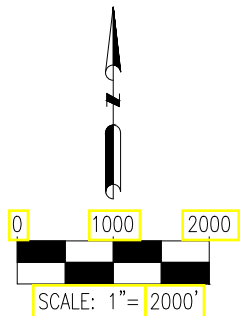

DISCLAIMER:
THIS PLOT DOES NOT REPRESENT A MONUMENTED LAND SURVEY AND
SHOULD NOT BE RELIED UPON TO DETERMINE BOUNDARY LINES, PROPERTY
OWNERSHIP OR OTHER PROPERTY INTERESTS. PARCEL LINES, IF DEPICTED
HAVE NOT BEEN FIELD VERIFIED AND MAY BE BASED UPON PUBLICLY
AVAILABLE DATA THAT ALSO HAS NOT BEEN INDEPENDENTLY VERIFIED.



FIELD DATE:
05-04-18

DRAWING DATE:
10-16-18

BY:
JW

CHECKED BY:
CSG

WELL NAME:
VOLT 11C-3-L

SURFACE LOCATION:
SW 1/4 SW 1/4 SEC 5, T5N, R66W, 6TH P.M.
WELD COUNTY, COLORADO

