

COT 30-J PAD HYDROLOGY MAP

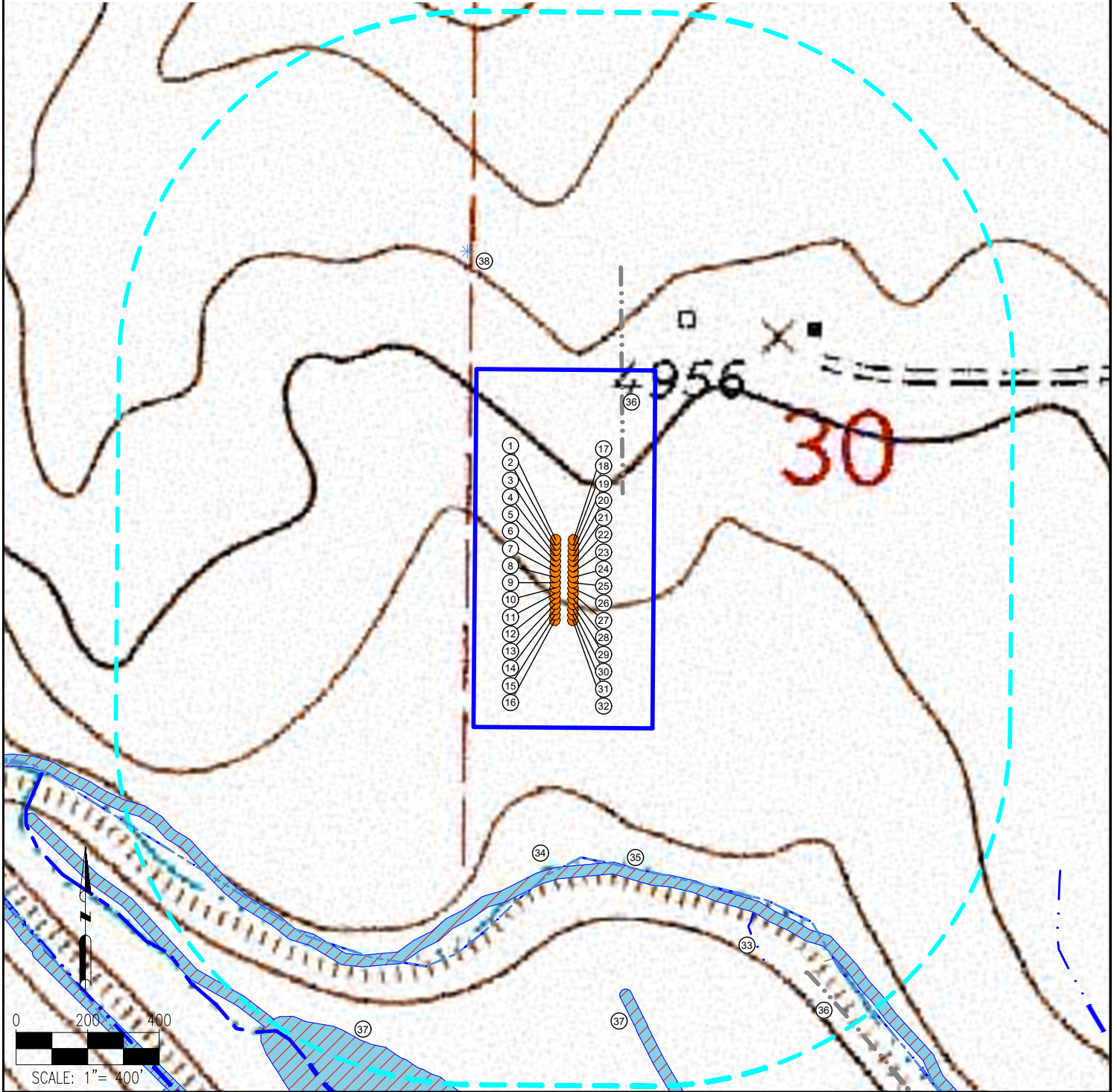

MEASUREMENTS ARE MADE FROM THE NEAREST EDGE OF THE DISTURBANCE AREA.

- | | | | | |
|------------------------|-------------------------|-------------------------|-------------------------|------------------------------------------------|
| 1. COT WEST M-30-25HN | 9. COT WEST S-30-25HN | 17. COT EAST M-30-29HN | 25. COT EAST S-30-29HN | 33. DITCH IS $\pm 575'$ SE |
| 2. COT WEST NA-30-25HC | 10. COT WEST TA-30-25HN | 18. COT EAST NA-30-29HN | 26. COT EAST TA-30-29HN | 34. EATON DITCH CANAL IS $\pm 374'$ S |
| 3. COT WEST N-30-25HC | 11. COT WEST T-30-25HC | 19. COT EAST N-30-29HC | 27. COT EAST T-30-29HC | 35. WETLAND IS $\pm 375'$ S (MAPPED) |
| 4. COT WEST O-30-25HN | 12. COT WEST U-30-25HN | 20. COT EAST O-30-29HN | 28. COT EAST U-30-29HN | 36. CONCRETE DITCH IS $\pm 0'$, $\pm 807'$ SE |
| 5. COT WEST P-30-25HN | 13. COT WEST V-30-25HN | 21. COT EAST P-30-29HN | 29. COT EAST V-30-29HN | 37. WETLANDS ARE $\pm 729'$ S, $\pm 923'$ SW |
| 6. COT WEST QA-30-25HN | 14. COT WEST WA-30-25HN | 22. COT EAST QA-30-29HN | 30. COT EAST WA-30-29HN | 38. PIVOT POINT IS $\pm 330'$ N |
| 7. COT WEST Q-30-25HC | 15. COT WEST W-30-25HC | 23. COT EAST Q-30-29HC | 31. COT EAST W-30-29HC | |
| 8. COT WEST R-30-25HN | 16. COT WEST X-30-25HN | 24. COT EAST R-30-29HN | 32. COT EAST X-30-29HN | |

LEGEND:

- | | |
|--|-----------------------------|
| | = PROPOSED WELL |
| | = PIVOT POINT |
| | = CONCRETE DITCH |
| | = 1000' RADIUS |
| | = PROPOSED DISTURBANCE AREA |
| | = WETLANDS |
| | = DITCH |
| | = CANAL |

DISCLAIMER:
THIS PLOT DOES NOT REPRESENT A MONUMENTED LAND SURVEY AND SHOULD NOT BE RELIED UPON TO DETERMINE BOUNDARY LINES, PROPERTY OWNERSHIP OR OTHER PROPERTY INTERESTS. PARCEL LINES, IF DEPICTED HAVE NOT BEEN FIELD VERIFIED AND MAY BE BASED UPON PUBLICLY AVAILABLE DATA THAT ALSO HAS NOT BEEN INDEPENDENTLY VERIFIED.

DATA SOURCE:
TOPO MAP: USGS
NHD: USGS

PUBLICLY AVAILABLE DATA SOURCES HAVE NOT BEEN INDEPENDENTLY VERIFIED BY ASCENT.



8620 Wolff Court
Westminster, CO 80031
(303) 928-7128
www.ascentgeomatics.com

FIELD DATE:

09-12-18

DRAWING DATE:

03-08-19

BY:

JAG

CHECKED:

IJM

SITE NAME:

COT 30-J PAD

SURFACE LOCATION:

NE 1/4 SW 1/4 SEC. 30, T7N, R66W, 6TH P.M.
WELD COUNTY, COLORADO

PREPARED FOR:



BAYSWATER
EXPLORATION AND PRODUCTION, LLC