

Reference Area Map

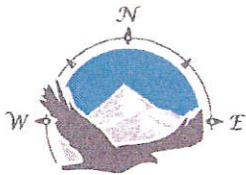

FRANE SURVEYING INC.

Physical Address: 34834 Annie Cir.
Mail to: Box 2372, Elizabeth, CO 80107
Ph. 303-243-0037
www.franesurveying.com
Job # 19-025-ALC-1545 #1-27

Frane Surveying, in accordance with a request from McCoy Petroleum Corporation has determined the location of ALC 1545 #1-27 to be 660 Feet FSL, and 660 Feet FEL, (90° off Section lines) of Section 27, Township 15s, Range 45w of the 6th Principal Meridian, Cheyenne County, Colorado.

Date: Staked on 02/20/19 drawn on 02/25/19.

Re: Staked by Elijah Frane
Drawn: Drawn by Elijah Frane

REFERENCE AREA MAP

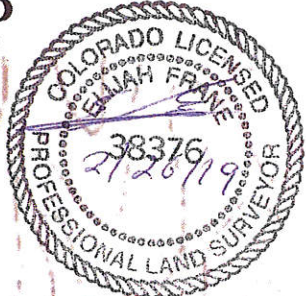

27

McCoy Petroleum Corp.
ALC 1545 #1-27
SE 1/4 Sec. 27-15S-45W
Cheyenne, CO, Colorado

REFERENCE AREA:
LAT=38.71118
LONG=102.42663



4380