

T5N

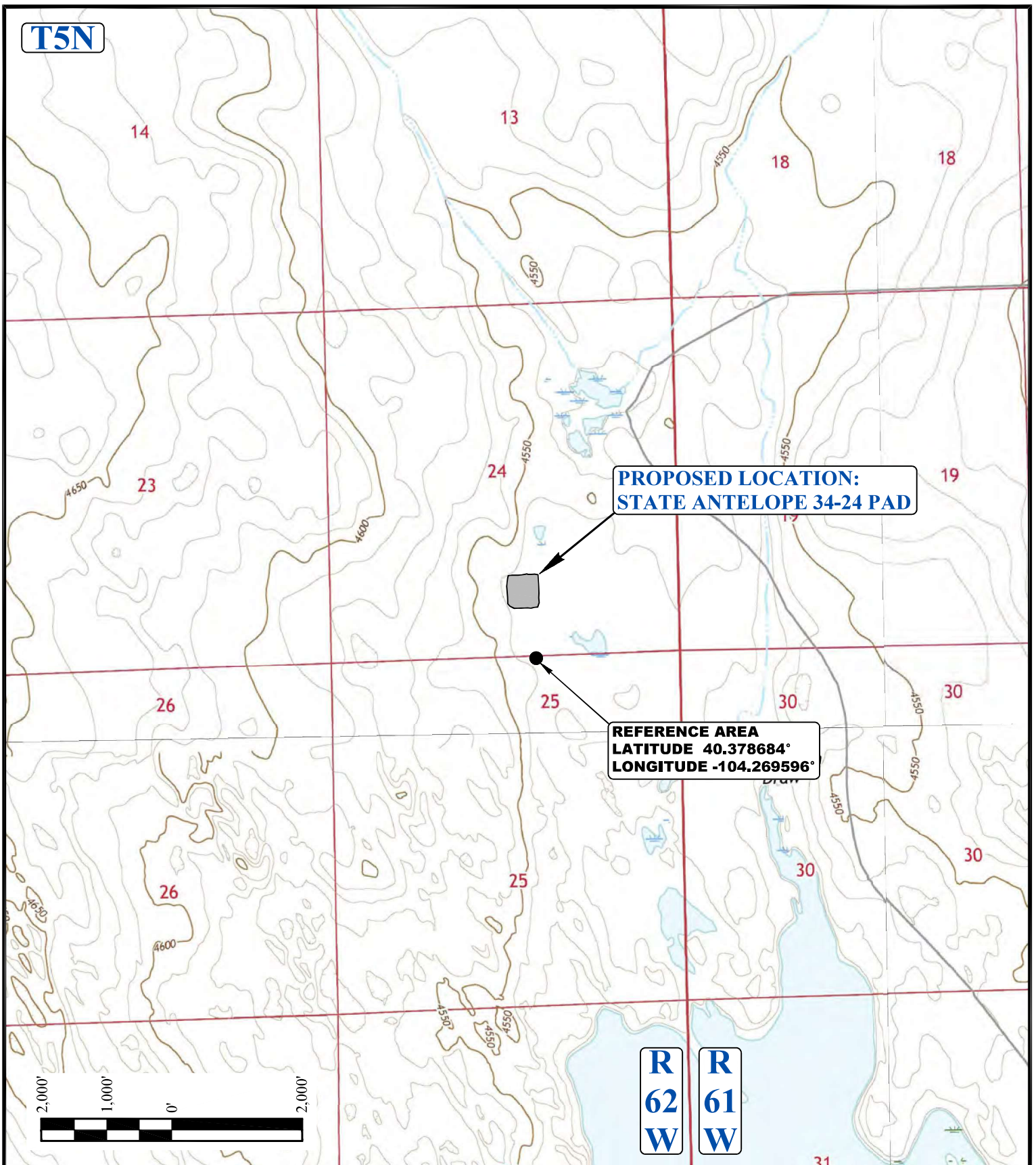

**PROPOSED LOCATION:
STATE ANTELOPE 34-24 PAD**

**REFERENCE AREA
LATITUDE 40.378684°
LONGITUDE -104.269596°**

**R
62
W**

**R
61
W**

LEGEND:



**BONANZA CREEK ENERGY
OPERATING COMPANY, LLC**

**STATE ANTELOPE 34-24 PAD
SW 1/4 SE 1/4, SECTION 24, T5N, R62W, 6th P.M.
WELD COUNTY, COLORADO**

SURVEYED BY	J.F., N.W.	09-06-18	SCALE
DRAWN BY	C.J.K.	10-05-18	1 : 24,000
REFERENCE AREA MAP			REF TOPO



UELS, LLC
Corporate Office * 85 South 200 East
Vernal, UT 84078 * (435) 789-1017