

T2N, R67W

N. 1/4 COR.
SEC. 35, T2N, R67W
FOUND 2" ALUM. CAP
L.S. NO. 25937

NW. COR.
SEC. 35, T2N, R67W
FOUND 3 1/4" ALUM. CAP
P.L.S. NO. 13258

NE. COR.
SEC. 35, T2N, R67W
FOUND 3 1/4" ALUM. CAP
L.S. NO. 22098

SURFACE LOCATION: NAD 83
GROUND ELEVATION= 4932.5'
LATITUDE= 40.090618°
LONGITUDE= -104.858919°
LATITUDE= 40°05'26.224"
LONGITUDE= -104°51'32.108"
HEEL LOCATION: NAD 83
LATITUDE= 40.089433°
LONGITUDE= -104.857364°
LATITUDE= 40°05'21.959"
LONGITUDE= -104°51'26.512"
BOTTOM HOLE LOCATION: NAD 83
LATITUDE= 40.089145°
LONGITUDE= -104.834247°
LATITUDE= 40°05'20.922"
LONGITUDE= -104°50'03.289"

CENTER 1/4 COR.
SEC. 35, T2N, R67W
FOUND 2" ALUM. CAP
ILLEGIBLE

35

W. 1/4 COR.
SEC. 35, T2N, R67W
FOUND 2" ALUM. CAP
L.S. NO. 25937

S 89°39'54" W
1317.75' (M)

S 89°38'28" W
1317.28' (M)

S 89°39'06" W
2634.36' (M)

CW. 1/16 COR.
SEC. 35, T2N, R67W
SET 2 1/2" ALUM. CAP
P.L.S. NO. 38512

N. 1/16 COR.
SEC. 35 & SEC. 36
T2N, R67W
FOUND 3 1/4" ALUM. CAP
P.L.S. NO. 23027

E. 1/4 COR.
SEC. 35, T2N, R67W
FOUND 2 1/2" ALUM. CAP
L.S. NO. 34980

S. 1/16 COR.
SEC. 35 & SEC. 36
T2N, R67W
SET 2 1/2" ALUM. CAP
P.L.S. NO. 38512

WELLBORE
CONTINUES INTO
SECTION 36

SE. COR.
SEC. 35, T2N, R67W
FOUND 2" ALUM. CAP
L.S. NO. 25937

S. 1/4 COR.
SEC. 35, T2N, R67W
FOUND 2 1/2" ALUM. CAP
P.L.S. NO. 24307

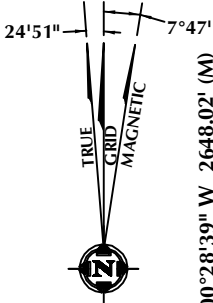

BAJA BERG 35-7HZ
SURFACE LOCATION

2450'

2385'

1132'

699'

HEEL LOCATION

CERTIFICATE OF SURVEYOR:

THIS IS TO CERTIFY THAT THE ABOVE PLAT WAS PREPARED FROM FIELD NOTES OF ACTUAL SURVEYS MADE BY ME OR UNDER MY SUPERVISION AND THAT THE SAME ARE TRUE AND CORRECT TO THE BEST OF MY KNOWLEDGE AND BELIEF. THIS CERTIFICATE DOES NOT REPRESENT A LAND SURVEY PLAT OR IMPROVEMENT SURVEY PLAT AS DEFINED BY C.R.S. 38-5-102 AND CANNOT BE RELIED UPON TO DETERMINE OWNERSHIP.

Randall K. French
3/14/19

RANDALL K. FRENCH
PROFESSIONAL LAND SURVEYOR
COLORADO REGISTRATION NUMBER 38512

NOTICE:
ACCORDING TO COLORADO STATE LAW YOU MUST COMMENCE A LEGAL ACTION BASED UPON ANY DEFECT IN THIS SURVEY WITHIN THREE YEARS AFTER YOU FIRST DISCOVER SUCH DEFECT. IN NO EVENT MAY ANY ACTION BASED UPON ANY DEFECT IN THIS SURVEY BE COMMENCED MORE THAN TEN YEARS FROM THE DATE ON THE CERTIFICATION SHOWN HEREON.

NOTE:
MAGNETIC NORTH IS CURRENT AS OF 9/25/2017.
MAGNETIC NORTH CHANGES WEST 0°06' PER YEAR.

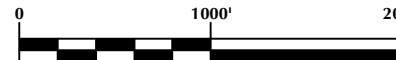

SCALE: 1" = 1000'

NOTES:

- ▲ INDICATES SECTION CORNER.
- INDICATES CALCULATED CORNER.
- ELEVATION BASED ON NAVD88 (GEOID12B).
- BASIS OF BEARING DERIVED FROM COLORADO COORDINATE SYSTEM OF 1983 NORTH ZONE.
- ALL MEASURED DISTANCES ARE GRID.
- COMBINED SCALE FACTOR: .99972874 CALCULATED FROM THE E. 1/4 CORNER OF SECTION 35, T2N, R67W.
- OPERATOR: ROB WILSON / PDOP = 1.6.
- SEE ADDENDUM TO WELL LOCATION CERTIFICATE FOR EXISTING IMPROVEMENTS WITHIN 500' OF THE WELL PAD.
- WELL FOOTAGES ARE MEASURED AT RIGHT ANGLES TO THE SECTION LINES.
- THE BOTTOM OF HOLE BEARS N89°29'36"W, 6469' FROM THE HEEL LOCATION.

WELL PAD - BAJA BERG 14-35HZ

BAJA BERG 35-7HZ
WELL LOCATION CERTIFICATE
1132' FSL & 2450' FWL SESW (SURFACE)
699' FSL & 2385' FEL SWSE (HEEL)
LOCATED IN SECTION 35
635' FSL & 1182' FEL SESE (BOTTOM)
LOCATED IN SECTION 36
T2N, R67W, 6TH P.M.
WELD COUNTY, COLORADO

**Kerr-McGee Oil &
Gas Onshore L.P.**
1099 18th Street
Denver, Colorado 80202



CONSULTING, LLC



SHERIDAN OFFICE
1095 Saberton Avenue
Sheridan, Wyoming 82801
Phone 307-674-0609

LOVELAND OFFICE
6706 North Franklin Avenue
Loveland, Colorado 80538
Phone 970-776-4331

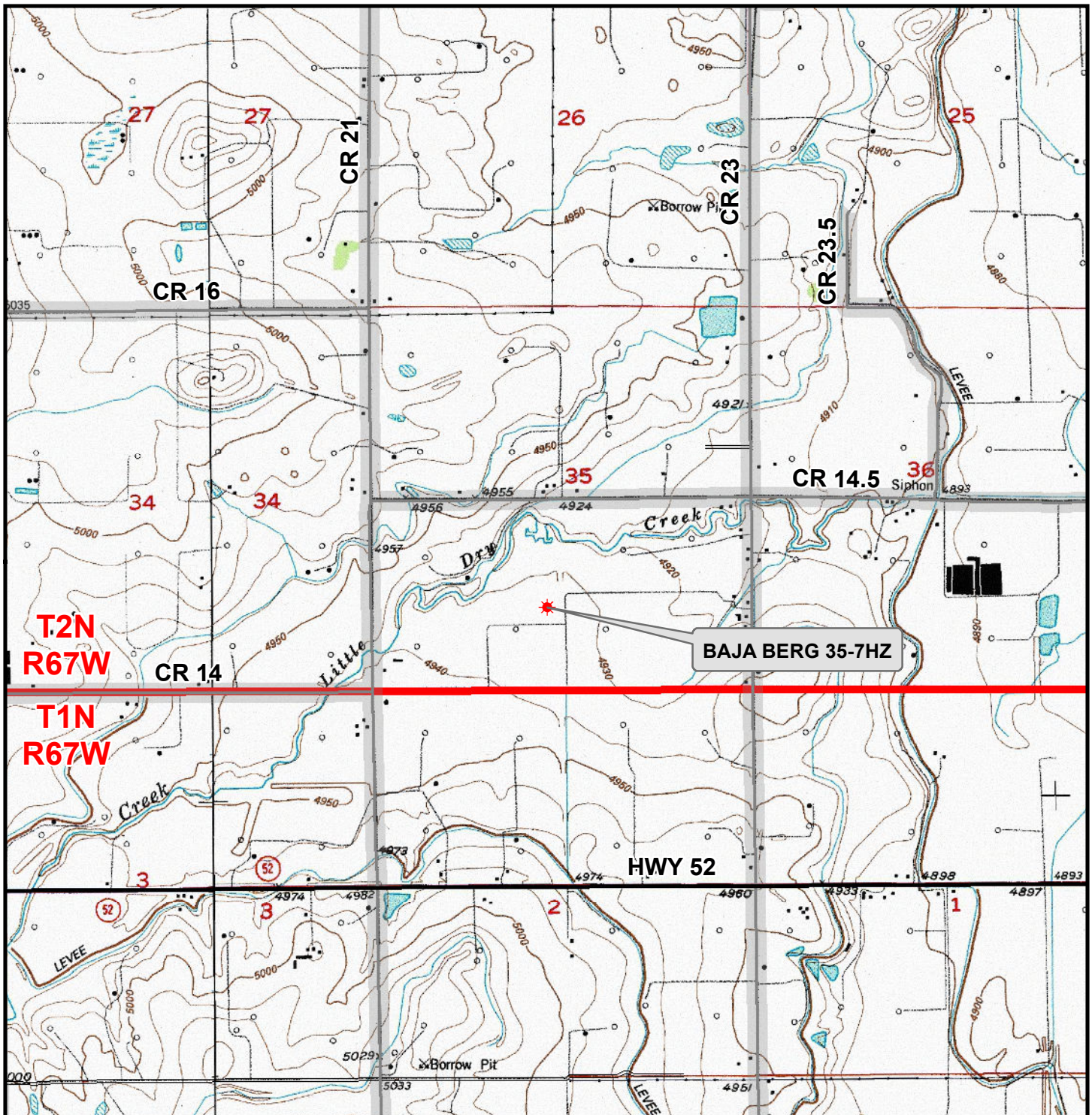
DRAFTED BY:	LMO	CHECKED BY:	RKF	SHEET NO:
DATE DRAFTED:	2/26/18	DATE SURVEYED:	2/12/18	1
REVISED:	3/14/19	FILE NAME:	16-136	1 OF 2



Legend

-  Well - Fee - Proposed == Road - Primitive - Existing  Road - County - Existing
 == Road - Improved - Existing  Road - Highway - Existing

WELL PAD - BAJA BERG 14-35HZ

GENERAL LOCATION MAP

BAJA BERG 35-7HZ

LOCATED IN SECTION 35

T2N, R67W, 6th P.M.

WELD COUNTY, COLORADO

**Kerr-McGee Oil &
Gas Onshore L.P.**

**1099 18th Street
Denver, Colorado 80202**



CONSULTING, LLC

SHERIDAN OFFICE
1095 Saberton Avenue
Sheridan, Wyoming 82801
Phone 307-674-0609

LOVELAND OFFICE
635 Foxtail Drive, Suite 204
Loveland, Colorado 80538
Phone 970-776-4331

SCALE: 1" = 2,000ft

NAD83 CO-Nft

DRAWN: DP

DATE: 26 Feb 2018

REVISED:

DATE: