

PIT STATUS EVALUATION FORM

Facility ID: 115170

Pit Name: EVERITT 1A 42-19

☐ Duplicate Record(s) Pit #

115169

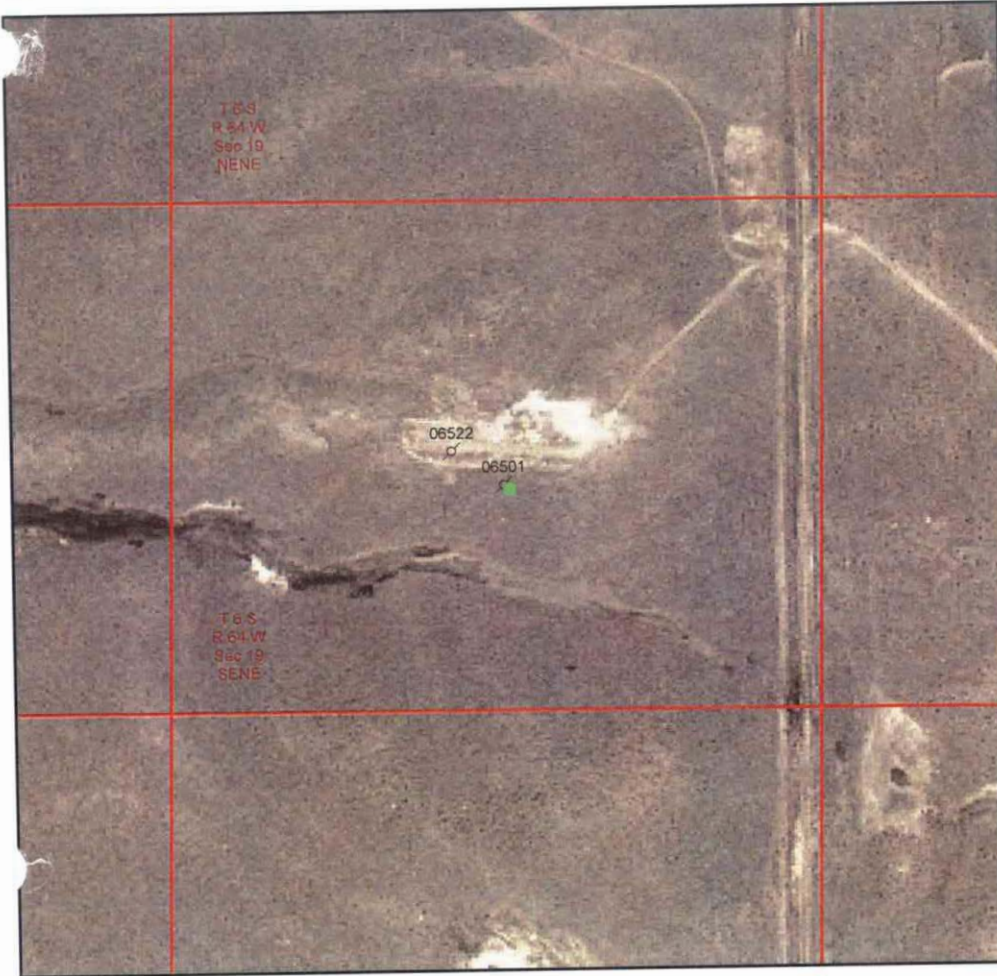

Legend

- ☒ Database Pit Location
- ☐ Producing Well
- ☐ Shut In Well
- ☐ Temp Aban Well
- ☐ Abandoned Well
- ☐ Dry & Aban Well
- ☐ Injection Well
- ☐ Other Well Status



1:6,000
0 250 500 750 Feet

Image Source:
USDA National Agricultural Imagery
Program (NAIP), 2006

S.S. PAPADOPULOS & ASSOCIATES, INC.

COGCC Database Information

Status: NR Owner: CHAMPLIN PETROLEUM COMPANY
T: 6S R: 64W Sec: 19 QQ: SENE 6th Meridian
Latitude: 39.515406 Longitude: -104.590609 NAD83

County: Elbert, CO
County Code: 039

Pit Status Evaluation

☐ Active

☐ Form 15: Pit Permit _____ Assoc. Well Seq No(s) _____

☐ Other documentation _____

☐ Aerial photo verification _____

☒ Closed

☐ Form 27: Remediation Workplan _____

☒ Form 4: Sundry Notice (11-14-1997) Final reclamation completion

☐ Rule 903a.(2)B

☒ Evidence pit(s) existed, no closure docs & well not PR, AC or SI

Well API Seq #(s) 06522 PA(9-2-1997) & 06501 PA(date not avail)

☐ Other documentation LIF#436835 (7-31-86) for #06501

☐ Abandoned

☐ Possible un-reclaimed pit(s) or adverse conditions, no closure docs

☐ Site Visit

☐ No Site Visit

☐ Add'l Review

☐ Unknown

Notes:

Common to Pit ID# 115169 Everitt 41-19 2

LIF (1987) 2-200 BBL skim tank + 20' x 20' pit