

BONANZA CREEK OIL COMPANY

Location: COLORADO Slot: SLOT#06 STATE ANTELOPE V41-B11-13HNB (2587'FNL & 510'FEL,SEC.13)
Field: WELD COUNTY Well: STATE ANTELOPE V41-B11-13HNB
Facility: SEC.13-T5N-R62W Wellbore: STATE ANTELOPE V41-B11-13HNB PWB

Plot reference wellpath is STATE ANTELOPE V41-B11-13HNB PWP (REV-A.0)

| | |
|---|--|
| True vertical depths are referenced to RIG (17) (RKB) | Grid System: NAD83 / Lambert Colorado SP, Northern Zone (501), US feet |
| Measured depths are referenced to RIG (17) (RKB) | North Reference: True north |
| RIG (17) (RKB) to Mean Sea Level: 4590 feet | Scale: True distance |
| Mean Sea Level to Ground level (At Slot: SLOT#06 STATE ANTELOPE V41-B11-13HNB (2587'FNL & 510'FEL,SEC.13): 0 feet | Depths are in feet |
| Coordinates are in feet referenced to Slot | Created by: robale01 on 2018-11-15 |
| | Database: WA DENVER |

Location Information

| Facility Name | | | Grid East (US ft) | Grid North (US ft) | Latitude | Longitude |
|--|--------------|--------------|-------------------|--------------------|----------------|-----------------|
| SEC.13-T5N-R62W | | | 333859.889 | 1389969.906 | 40°23'50.820"N | 104°16'47.028"W |
| Slot | Local N (ft) | Local E (ft) | Grid East (US ft) | Grid North (US ft) | Latitude | Longitude |
| SLOT#06 STATE ANTELOPE V41-B11-13HNB (2587'FNL & 510'FEL,SEC.13) | 1416.12 | 4472.42 | 3344312.210 | 1391447.376 | 40°24'04.810"N | 104°15'49.219"W |
| RIG (17) (RKB) to Ground level (At Slot: SLOT#06 STATE ANTELOPE V41-B11-13HNB (2587'FNL & 510'FEL,SEC.13)) | | | | | | 4590R |
| Mean Sea Level to Ground level (At Slot: SLOT#06 STATE ANTELOPE V41-B11-13HNB (2587'FNL & 510'FEL,SEC.13)) | | | | | | 0ft |
| RIG (17) (RKB) to Mean Sea Level | | | | | | 4590R |

Survey Program

| Start MD (ft) | End MD (ft) | Tool | Model | Log Name/Comment | Wellbore |
|---------------|-------------|--------------------|----------------------------|------------------|----------------------------------|
| 17.00 | 1550.00 | BHI NaviTrak | BHI NaviTrak (Rotating) | | STATE ANTELOPE V41-B11-13HNB PWB |
| 1550.00 | 11366.41 | BHI AutoTrak Curve | BHI AutoTrak Curve (Short) | | STATE ANTELOPE V41-B11-13HNB PWB |

Hole and Casing Sections

| Name | Start MD (ft) | End MD (ft) | Interval (ft) | Start TVD (ft) | End TVD (ft) | Start Local N (ft) | Start Local E (ft) | End Local N (ft) | End Local E (ft) | Wellbore |
|------------------------|---------------|-------------|---------------|----------------|--------------|--------------------|--------------------|------------------|------------------|----------------------------------|
| 13.5in Open Hole | 17.00 | 1550.00 | 1533.00 | 17.00 | 1518.29 | 0.00 | 0.00 | 236.82 | 113.79 | STATE ANTELOPE V41-B11-13HNB PWB |
| 9.625in Casing Surface | 17.00 | 1550.00 | 1533.00 | 17.00 | 1518.29 | 0.00 | 0.00 | 236.82 | 113.79 | STATE ANTELOPE V41-B11-13HNB PWB |
| 8.5in Open Hole | 1550.00 | 11366.41 | 9816.41 | 1518.29 | N/A | 236.82 | 113.79 | N/A | N/A | STATE ANTELOPE V41-B11-13HNB PWB |

Well Profile Data

| Design Comment | MD (ft) | Inc (°) | Az (°) | TVD (ft) | Local N (ft) | Local E (ft) | DLS (°/100ft) | VS (ft) |
|----------------|----------|---------|---------|----------|--------------|--------------|---------------|---------|
| Tie On | 17.00 | 0.000 | 25.664 | 17.00 | 0.00 | 0.00 | 0.00 | 0.00 |
| End of Tangent | 200.00 | 0.000 | 25.664 | 200.00 | 0.00 | 0.00 | 0.00 | 0.00 |
| End of Build | 1000.90 | 16.018 | 25.664 | 990.50 | 100.25 | 48.17 | 2.00 | -17.64 |
| End of Tangent | 5618.71 | 16.018 | 25.664 | 5429.04 | 1248.78 | 600.03 | 0.00 | -219.70 |
| End of 3D Arc | 6587.34 | 90.000 | 270.005 | 6050.00 | 1409.52 | 31.19 | 10.00 | 371.37 |
| End of Tangent | 11366.41 | 90.000 | 270.005 | 6050.00 | 1409.98 | -4747.88 | 0.00 | 4952.82 |

Bottom Hole Location

| MD (ft) | Inc (°) | Az (°) | TVD (ft) | Local N (ft) | Local E (ft) | Grid East (US ft) | Grid North (US ft) | Latitude | Longitude |
|----------|---------|---------|----------|--------------|--------------|-------------------|--------------------|----------------|-----------------|
| 11366.41 | 90.000 | 270.005 | 6050.00 | 1409.98 | -4747.88 | 3339545.33 | 1392790.97 | 40°24'18.738"N | 104°16'50.592"W |

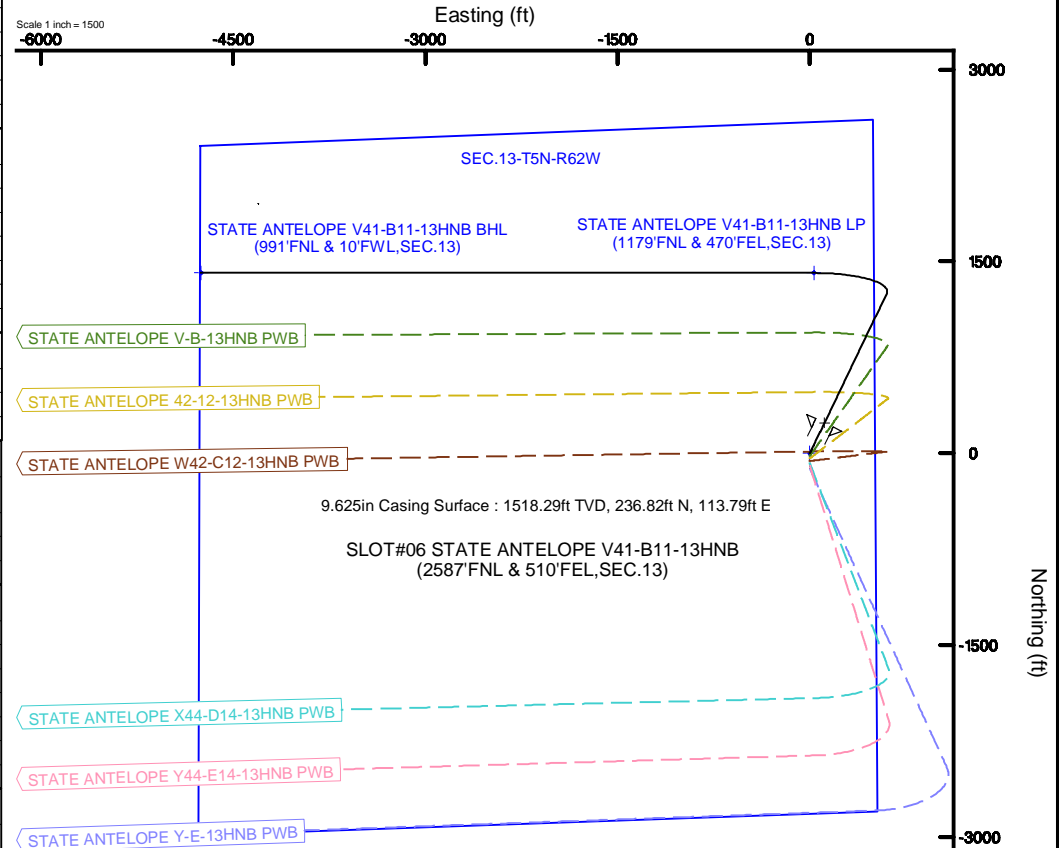
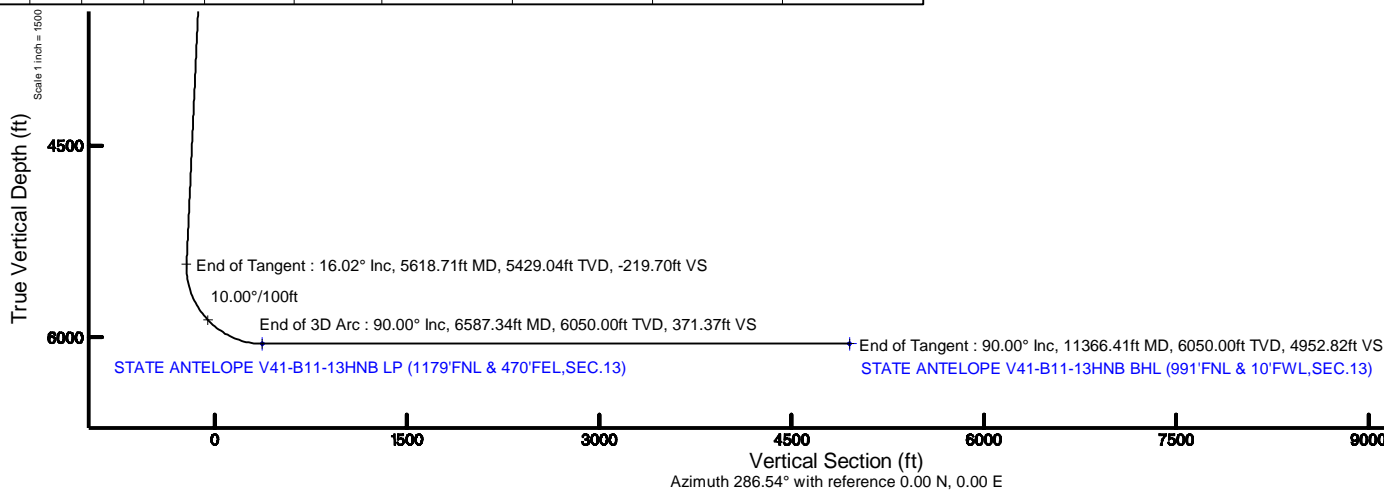

BGGM (1945.0 to 2015.0) Dip: 67.01° Field: 52833.7 nT
Magnetic North is 8.26 degrees East of True North (at 4/24/2014)

To correct azimuth from Magnetic to True add 8.26 degrees



Planned Wellpath Report

STATE ANTELOPE V41-B11-13HNB PWP (REV-A.0)

Page 1 of 6



| REFERENCE WELLPATH IDENTIFICATION | | | |
|-----------------------------------|---------------------------|----------|--|
| Operator | BONANZA CREEK OIL COMPANY | Slot | SLOT#06 STATE ANTELOPE V41-B11-13HNB (2587'FNL & 510'FEL,SEC.13) |
| Area | COLORADO | Well | STATE ANTELOPE V41-B11-13HNB |
| Field | WELD COUNTY | Wellbore | STATE ANTELOPE V41-B11-13HNB PWB |
| Facility | SEC.13-T5N-R62W | | |

| REPORT SETUP INFORMATION | | | |
|--------------------------|---|----------------------|--|
| Projection System | NAD83 / Lambert Colorado SP, Northern Zone (501), US feet | Software System | WellArchitect® 5.1 |
| North Reference | True | User | Robiale01 |
| Scale | 0.999960 | Report Generated | 11/15/2018 at 9:33:40 AM |
| Convergence at slot | 0.80° East | Database/Source file | WA DENVER/STATE_ANTELOPE_V41-B11-13HNB_PWP__REV-A.0_.xml |

| WELLPATH LOCATION | | | | | | |
|-----------------------|-------------------|----------|------------------|-----------------|------------------------|-----------------|
| | Local coordinates | | Grid coordinates | | Geographic coordinates | |
| | North[ft] | East[ft] | Easting[US ft] | Northing[US ft] | Latitude | Longitude |
| Slot Location | 1416.12 | 4472.42 | 3344312.21 | 1391447.38 | 40°24'04.810"N | 104°15'49.219"W |
| Facility Reference Pt | | | 3339859.89 | 1389969.91 | 40°23'50.820"N | 104°16'47.028"W |
| Field Reference Pt | | | 3224525.77 | 1254425.87 | 40°01'44.400"N | 104°41'53.556"W |

| WELLPATH DATUM | | | |
|--------------------------|-------------------|--|-------------------|
| Calculation method | Minimum curvature | RIG (17') (RKB) to Facility Vertical Datum | 4590.00ft |
| Horizontal Reference Pt | Slot | RIG (17') (RKB) to Mean Sea Level | 4590.00ft |
| Vertical Reference Pt | RIG (17') (RKB) | RIG (17') (RKB) to Ground Level at Slot (SLOT#06 STATE ANTELOPE V41-B11-13HNB (2587'FNL & 510'FEL,SEC.13)) | 4590.00ft |
| MD Reference Pt | RIG (17') (RKB) | Section Origin | N 0.00, E 0.00 ft |
| Field Vertical Reference | Mean Sea Level | Section Azimuth | 286.54° |



Planned Wellpath Report
STATE ANTELOPE V41-B11-13HNB PWP (REV-A.0)
Page 2 of 6



| REFERENCE WELLPATH IDENTIFICATION | | | |
|-----------------------------------|---------------------------|----------|--|
| Operator | BONANZA CREEK OIL COMPANY | Slot | SLOT#06 STATE ANTELOPE V41-B11-13HNB (2587'FNL & 510'FEL,SEC.13) |
| Area | COLORADO | Well | STATE ANTELOPE V41-B11-13HNB |
| Field | WELD COUNTY | Wellbore | STATE ANTELOPE V41-B11-13HNB PWB |
| Facility | SEC.13-T5N-R62W | | |

| WELLPATH DATA (120 stations) † = interpolated/extrapolated station | | | | | | | | | | |
|--|--------------------|----------------|-------------|-------------------|---------------|--------------|----------------|-----------------|------------------|----------------|
| MD [ft] | Inclination [°] | Azimuth [°] | TVD [ft] | Vert Sect [ft] | North [ft] | East [ft] | Latitude | Longitude | DLS [°/100ft] | Comments |
| 0.00† | 0.000 | 25.664 | 0.00 | 0.00 | 0.00 | 0.00 | 40°24'04.810"N | 104°15'49.219"W | 0.00 | |
| 17.00 | 0.000 | 25.664 | 17.00 | 0.00 | 0.00 | 0.00 | 40°24'04.810"N | 104°15'49.219"W | 0.00 | Tie On |
| 117.00† | 0.000 | 25.664 | 117.00 | 0.00 | 0.00 | 0.00 | 40°24'04.810"N | 104°15'49.219"W | 0.00 | |
| 200.00 | 0.000 | 25.664 | 200.00 | 0.00 | 0.00 | 0.00 | 40°24'04.810"N | 104°15'49.219"W | 0.00 | End of Tangent |
| 217.00† | 0.340 | 25.664 | 217.00 | -0.01 | 0.05 | 0.02 | 40°24'04.810"N | 104°15'49.219"W | 2.00 | |
| 317.00† | 2.340 | 25.664 | 316.97 | -0.38 | 2.15 | 1.03 | 40°24'04.831"N | 104°15'49.206"W | 2.00 | |
| 417.00† | 4.340 | 25.664 | 416.79 | -1.30 | 7.40 | 3.56 | 40°24'04.883"N | 104°15'49.173"W | 2.00 | |
| 517.00† | 6.340 | 25.664 | 516.35 | -2.78 | 15.79 | 7.59 | 40°24'04.966"N | 104°15'49.121"W | 2.00 | |
| 617.00† | 8.340 | 25.664 | 615.53 | -4.80 | 27.31 | 13.12 | 40°24'05.079"N | 104°15'49.050"W | 2.00 | |
| 717.00† | 10.340 | 25.664 | 714.20 | -7.38 | 41.93 | 20.15 | 40°24'05.224"N | 104°15'48.959"W | 2.00 | |
| 817.00† | 12.340 | 25.664 | 812.24 | -10.50 | 59.66 | 28.66 | 40°24'05.399"N | 104°15'48.849"W | 2.00 | |
| 917.00† | 14.340 | 25.664 | 909.54 | -14.15 | 80.45 | 38.66 | 40°24'05.605"N | 104°15'48.720"W | 2.00 | |
| 1000.90 | 16.018 | 25.664 | 990.50 | -17.64 | 100.25 | 48.17 | 40°24'05.800"N | 104°15'48.597"W | 2.00 | End of Build |
| 1017.00† | 16.018 | 25.664 | 1005.98 | -18.34 | 104.26 | 50.09 | 40°24'05.840"N | 104°15'48.572"W | 0.00 | |
| 1117.00† | 16.018 | 25.664 | 1102.10 | -22.72 | 129.13 | 62.05 | 40°24'06.086"N | 104°15'48.417"W | 0.00 | |
| 1217.00† | 16.018 | 25.664 | 1198.22 | -27.09 | 154.00 | 74.00 | 40°24'06.331"N | 104°15'48.263"W | 0.00 | |
| 1317.00† | 16.018 | 25.664 | 1294.34 | -31.47 | 178.87 | 85.95 | 40°24'06.577"N | 104°15'48.108"W | 0.00 | |
| 1417.00† | 16.018 | 25.664 | 1390.45 | -35.84 | 203.74 | 97.90 | 40°24'06.823"N | 104°15'47.954"W | 0.00 | |
| 1517.00† | 16.018 | 25.664 | 1486.57 | -40.22 | 228.62 | 109.85 | 40°24'07.069"N | 104°15'47.799"W | 0.00 | |
| 1617.00† | 16.018 | 25.664 | 1582.69 | -44.60 | 253.49 | 121.80 | 40°24'07.314"N | 104°15'47.645"W | 0.00 | |
| 1717.00† | 16.018 | 25.664 | 1678.81 | -48.97 | 278.36 | 133.75 | 40°24'07.560"N | 104°15'47.490"W | 0.00 | |
| 1817.00† | 16.018 | 25.664 | 1774.92 | -53.35 | 303.23 | 145.70 | 40°24'07.806"N | 104°15'47.336"W | 0.00 | |
| 1917.00† | 16.018 | 25.664 | 1871.04 | -57.72 | 328.10 | 157.65 | 40°24'08.052"N | 104°15'47.181"W | 0.00 | |
| 2017.00† | 16.018 | 25.664 | 1967.16 | -62.10 | 352.97 | 169.60 | 40°24'08.298"N | 104°15'47.027"W | 0.00 | |
| 2117.00† | 16.018 | 25.664 | 2063.28 | -66.47 | 377.85 | 181.55 | 40°24'08.543"N | 104°15'46.872"W | 0.00 | |
| 2217.00† | 16.018 | 25.664 | 2159.39 | -70.85 | 402.72 | 193.50 | 40°24'08.789"N | 104°15'46.718"W | 0.00 | |
| 2317.00† | 16.018 | 25.664 | 2255.51 | -75.22 | 427.59 | 205.45 | 40°24'09.035"N | 104°15'46.564"W | 0.00 | |
| 2417.00† | 16.018 | 25.664 | 2351.63 | -79.60 | 452.46 | 217.40 | 40°24'09.281"N | 104°15'46.409"W | 0.00 | |
| 2517.00† | 16.018 | 25.664 | 2447.75 | -83.98 | 477.33 | 229.35 | 40°24'09.526"N | 104°15'46.255"W | 0.00 | |
| 2617.00† | 16.018 | 25.664 | 2543.86 | -88.35 | 502.20 | 241.31 | 40°24'09.772"N | 104°15'46.100"W | 0.00 | |
| 2717.00† | 16.018 | 25.664 | 2639.98 | -92.73 | 527.08 | 253.26 | 40°24'10.018"N | 104°15'45.946"W | 0.00 | |
| 2817.00† | 16.018 | 25.664 | 2736.10 | -97.10 | 551.95 | 265.21 | 40°24'10.264"N | 104°15'45.791"W | 0.00 | |
| 2917.00† | 16.018 | 25.664 | 2832.22 | -101.48 | 576.82 | 277.16 | 40°24'10.509"N | 104°15'45.637"W | 0.00 | |
| 3017.00† | 16.018 | 25.664 | 2928.33 | -105.85 | 601.69 | 289.11 | 40°24'10.755"N | 104°15'45.482"W | 0.00 | |
| 3117.00† | 16.018 | 25.664 | 3024.45 | -110.23 | 626.56 | 301.06 | 40°24'11.001"N | 104°15'45.328"W | 0.00 | |
| 3217.00† | 16.018 | 25.664 | 3120.57 | -114.61 | 651.43 | 313.01 | 40°24'11.247"N | 104°15'45.173"W | 0.00 | |

| WELLPATH DATA (120 stations) † = interpolated/extrapolated station | | | | | | | | | | |
|--|--------------------|----------------|-------------|-------------------|---------------|--------------|----------------|-----------------|------------------|----------|
| MD [ft] | Inclination [°] | Azimuth [°] | TVD [ft] | Vert Sect [ft] | North [ft] | East [ft] | Latitude | Longitude | DLS [°/100ft] | Comments |
| 3317.00† | 16.018 | 25.664 | 3216.69 | -118.98 | 676.31 | 324.96 | 40°24'11.493"N | 104°15'45.019"W | 0.00 | |
| 3417.00† | 16.018 | 25.664 | 3312.80 | -123.36 | 701.18 | 336.91 | 40°24'11.738"N | 104°15'44.864"W | 0.00 | |
| 3517.00† | 16.018 | 25.664 | 3408.92 | -127.73 | 726.05 | 348.86 | 40°24'11.984"N | 104°15'44.710"W | 0.00 | |
| 3617.00† | 16.018 | 25.664 | 3505.04 | -132.11 | 750.92 | 360.81 | 40°24'12.230"N | 104°15'44.555"W | 0.00 | |
| 3717.00† | 16.018 | 25.664 | 3601.16 | -136.48 | 775.79 | 372.76 | 40°24'12.476"N | 104°15'44.401"W | 0.00 | |
| 3817.00† | 16.018 | 25.664 | 3697.27 | -140.86 | 800.66 | 384.71 | 40°24'12.721"N | 104°15'44.246"W | 0.00 | |
| 3917.00† | 16.018 | 25.664 | 3793.39 | -145.23 | 825.54 | 396.66 | 40°24'12.967"N | 104°15'44.092"W | 0.00 | |
| 4017.00† | 16.018 | 25.664 | 3889.51 | -149.61 | 850.41 | 408.61 | 40°24'13.213"N | 104°15'43.937"W | 0.00 | |
| 4117.00† | 16.018 | 25.664 | 3985.63 | -153.99 | 875.28 | 420.57 | 40°24'13.459"N | 104°15'43.783"W | 0.00 | |

REFERENCE WELLPATH IDENTIFICATION

| | | | |
|----------|---------------------------|----------|--|
| Operator | BONANZA CREEK OIL COMPANY | Slot | SLOT#06 STATE ANTELOPE V41-B11-13HNB (2587'FNL & 510'FEL,SEC.13) |
| Area | COLORADO | Well | STATE ANTELOPE V41-B11-13HNB |
| Field | WELD COUNTY | Wellbore | STATE ANTELOPE V41-B11-13HNB PWB |
| Facility | SEC.13-T5N-R62W | | |

WELLPATH DATA (120 stations) † = interpolated/extrapolated station

| MD [ft] | Inclination [°] | Azimuth [°] | TVD [ft] | Vert Sect [ft] | North [ft] | East [ft] | Latitude | Longitude | DLS [°/100ft] | Comments |
|------------|--------------------|----------------|----------------------|-------------------|---------------|--------------|----------------|-----------------|------------------|----------------|
| 4217.00† | 16.018 | 25.664 | 4081.74 | -158.36 | 900.15 | 432.52 | 40°24'13.705"N | 104°15'43.628"W | 0.00 | |
| 4317.00† | 16.018 | 25.664 | 4177.86 | -162.74 | 925.02 | 444.47 | 40°24'13.950"N | 104°15'43.474"W | 0.00 | |
| 4417.00† | 16.018 | 25.664 | 4273.98 | -167.11 | 949.89 | 456.42 | 40°24'14.196"N | 104°15'43.319"W | 0.00 | |
| 4517.00† | 16.018 | 25.664 | 4370.10 | -171.49 | 974.77 | 468.37 | 40°24'14.442"N | 104°15'43.165"W | 0.00 | |
| 4617.00† | 16.018 | 25.664 | 4466.21 | -175.86 | 999.64 | 480.32 | 40°24'14.688"N | 104°15'43.011"W | 0.00 | |
| 4717.00† | 16.018 | 25.664 | 4562.33 | -180.24 | 1024.51 | 492.27 | 40°24'14.933"N | 104°15'42.856"W | 0.00 | |
| 4817.00† | 16.018 | 25.664 | 4658.45 | -184.62 | 1049.38 | 504.22 | 40°24'15.179"N | 104°15'42.702"W | 0.00 | |
| 4917.00† | 16.018 | 25.664 | 4754.57 | -188.99 | 1074.25 | 516.17 | 40°24'15.425"N | 104°15'42.547"W | 0.00 | |
| 5017.00† | 16.018 | 25.664 | 4850.68 | -193.37 | 1099.12 | 528.12 | 40°24'15.671"N | 104°15'42.393"W | 0.00 | |
| 5117.00† | 16.018 | 25.664 | 4946.80 | -197.74 | 1124.00 | 540.07 | 40°24'15.916"N | 104°15'42.238"W | 0.00 | |
| 5217.00† | 16.018 | 25.664 | 5042.92 | -202.12 | 1148.87 | 552.02 | 40°24'16.162"N | 104°15'42.084"W | 0.00 | |
| 5317.00† | 16.018 | 25.664 | 5139.04 | -206.49 | 1173.74 | 563.97 | 40°24'16.408"N | 104°15'41.929"W | 0.00 | |
| 5417.00† | 16.018 | 25.664 | 5235.15 | -210.87 | 1198.61 | 575.92 | 40°24'16.654"N | 104°15'41.775"W | 0.00 | |
| 5517.00† | 16.018 | 25.664 | 5331.27 | -215.25 | 1223.48 | 587.87 | 40°24'16.900"N | 104°15'41.620"W | 0.00 | |
| 5617.00† | 16.018 | 25.664 | 5427.39 | -219.62 | 1248.35 | 599.83 | 40°24'17.145"N | 104°15'41.466"W | 0.00 | |
| 5618.71 | 16.018 | 25.664 | 5429.04 | -219.70 | 1248.78 | 600.03 | 40°24'17.150"N | 104°15'41.463"W | 0.00 | End of Tangent |
| 5717.00† | 14.802 | 348.319 | 5524.02 | -215.90 | 1273.36 | 603.37 | 40°24'17.392"N | 104°15'41.420"W | 10.00 | |
| 5817.00† | 19.365 | 317.420 | 5619.77 | -195.58 | 1298.14 | 589.53 | 40°24'17.637"N | 104°15'41.599"W | 10.00 | |
| 5917.00† | 26.954 | 300.595 | 5711.75 | -159.27 | 1321.94 | 558.73 | 40°24'17.872"N | 104°15'41.997"W | 10.00 | |
| 6017.00† | 35.685 | 291.125 | 5797.14 | -108.08 | 1344.05 | 511.89 | 40°24'18.091"N | 104°15'42.602"W | 10.00 | |
| 6117.00† | 44.894 | 285.060 | 5873.37 | -43.57 | 1363.78 | 450.45 | 40°24'18.286"N | 104°15'43.396"W | 10.00 | |
| 6217.00† | 54.333 | 280.709 | 5938.11 | 32.31 | 1380.54 | 376.27 | 40°24'18.452"N | 104°15'44.355"W | 10.00 | |
| 6317.00† | 63.895 | 277.290 | 5989.39 | 117.25 | 1393.82 | 291.61 | 40°24'18.583"N | 104°15'45.450"W | 10.00 | |
| 6417.00† | 73.525 | 274.395 | 6025.67 | 208.67 | 1403.21 | 199.03 | 40°24'18.676"N | 104°15'46.646"W | 10.00 | |
| 6517.00† | 83.192 | 271.776 | 6045.83 | 303.80 | 1408.44 | 101.35 | 40°24'18.727"N | 104°15'47.909"W | 10.00 | |
| 6587.34 | 90.000 | 270.005 | 6050.00 ¹ | 371.37 | 1409.52 | 31.19 | 40°24'18.738"N | 104°15'48.816"W | 10.00 | End of 3D Arc |
| 6617.00† | 90.000 | 270.005 | 6050.00 | 399.80 | 1409.53 | 1.53 | 40°24'18.738"N | 104°15'49.199"W | 0.00 | |
| 6717.00† | 90.000 | 270.005 | 6050.00 | 495.67 | 1409.54 | -98.47 | 40°24'18.738"N | 104°15'50.492"W | 0.00 | |
| 6817.00† | 90.000 | 270.005 | 6050.00 | 591.53 | 1409.55 | -198.47 | 40°24'18.738"N | 104°15'51.785"W | 0.00 | |
| 6917.00† | 90.000 | 270.005 | 6050.00 | 687.40 | 1409.56 | -298.47 | 40°24'18.738"N | 104°15'53.077"W | 0.00 | |
| 7017.00† | 90.000 | 270.005 | 6050.00 | 783.26 | 1409.57 | -398.47 | 40°24'18.738"N | 104°15'54.370"W | 0.00 | |
| 7117.00† | 90.000 | 270.005 | 6050.00 | 879.13 | 1409.58 | -498.47 | 40°24'18.738"N | 104°15'55.663"W | 0.00 | |
| 7217.00† | 90.000 | 270.005 | 6050.00 | 974.99 | 1409.58 | -598.47 | 40°24'18.739"N | 104°15'56.955"W | 0.00 | |
| 7317.00† | 90.000 | 270.005 | 6050.00 | 1070.86 | 1409.59 | -698.47 | 40°24'18.739"N | 104°15'58.248"W | 0.00 | |
| 7417.00† | 90.000 | 270.005 | 6050.00 | 1166.72 | 1409.60 | -798.47 | 40°24'18.739"N | 104°15'59.541"W | 0.00 | |

| WELLPATH DATA (120 stations) † = interpolated/extrapolated station | | | | | | | | | | |
|--|--------------------|----------------|-------------|-------------------|---------------|--------------|----------------|-----------------|------------------|----------|
| MD [ft] | Inclination [°] | Azimuth [°] | TVD [ft] | Vert Sect [ft] | North [ft] | East [ft] | Latitude | Longitude | DLS [°/100ft] | Comments |
| 7517.00† | 90.000 | 270.005 | 6050.00 | 1262.59 | 1409.61 | -898.47 | 40°24'18.739"N | 104°16'00.833"W | 0.00 | |
| 7617.00† | 90.000 | 270.005 | 6050.00 | 1358.45 | 1409.62 | -998.47 | 40°24'18.739"N | 104°16'02.126"W | 0.00 | |
| 7717.00† | 90.000 | 270.005 | 6050.00 | 1454.32 | 1409.63 | -1098.47 | 40°24'18.739"N | 104°16'03.418"W | 0.00 | |
| 7817.00† | 90.000 | 270.005 | 6050.00 | 1550.18 | 1409.64 | -1198.47 | 40°24'18.739"N | 104°16'04.711"W | 0.00 | |
| 7917.00† | 90.000 | 270.005 | 6050.00 | 1646.05 | 1409.65 | -1298.47 | 40°24'18.739"N | 104°16'06.004"W | 0.00 | |
| 8017.00† | 90.000 | 270.005 | 6050.00 | 1741.91 | 1409.66 | -1398.47 | 40°24'18.739"N | 104°16'07.296"W | 0.00 | |
| 8117.00† | 90.000 | 270.005 | 6050.00 | 1837.78 | 1409.67 | -1498.47 | 40°24'18.739"N | 104°16'08.589"W | 0.00 | |
| 8217.00† | 90.000 | 270.005 | 6050.00 | 1933.64 | 1409.68 | -1598.47 | 40°24'18.739"N | 104°16'09.882"W | 0.00 | |
| 8317.00† | 90.000 | 270.005 | 6050.00 | 2029.51 | 1409.69 | -1698.47 | 40°24'18.739"N | 104°16'11.174"W | 0.00 | |
| 8417.00† | 90.000 | 270.005 | 6050.00 | 2125.37 | 1409.70 | -1798.47 | 40°24'18.739"N | 104°16'12.467"W | 0.00 | |

REFERENCE WELLPATH IDENTIFICATION

| | | | |
|----------|---------------------------|----------|--|
| Operator | BONANZA CREEK OIL COMPANY | Slot | SLOT#06 STATE ANTELOPE V41-B11-13HNB (2587'FNL & 510'FEL,SEC.13) |
| Area | COLORADO | Well | STATE ANTELOPE V41-B11-13HNB |
| Field | WELD COUNTY | Wellbore | STATE ANTELOPE V41-B11-13HNB PWB |
| Facility | SEC.13-T5N-R62W | | |

WELLPATH DATA (120 stations) † = interpolated/extrapolated station

| MD [ft] | Inclination [°] | Azimuth [°] | TVD [ft] | Vert Sect [ft] | North [ft] | East [ft] | Latitude | Longitude | DLS [°/100ft] | Comments |
|------------|--------------------|----------------|----------------------|-------------------|---------------|--------------|----------------|-----------------|------------------|----------------|
| 8517.00† | 90.000 | 270.005 | 6050.00 | 2221.23 | 1409.71 | -1898.47 | 40°24'18.739"N | 104°16'13.760"W | 0.00 | |
| 8617.00† | 90.000 | 270.005 | 6050.00 | 2317.10 | 1409.72 | -1998.47 | 40°24'18.739"N | 104°16'15.052"W | 0.00 | |
| 8717.00† | 90.000 | 270.005 | 6050.00 | 2412.96 | 1409.73 | -2098.47 | 40°24'18.739"N | 104°16'16.345"W | 0.00 | |
| 8817.00† | 90.000 | 270.005 | 6050.00 | 2508.83 | 1409.74 | -2198.47 | 40°24'18.739"N | 104°16'17.637"W | 0.00 | |
| 8917.00† | 90.000 | 270.005 | 6050.00 | 2604.69 | 1409.75 | -2298.47 | 40°24'18.739"N | 104°16'18.930"W | 0.00 | |
| 9017.00† | 90.000 | 270.005 | 6050.00 | 2700.56 | 1409.76 | -2398.47 | 40°24'18.739"N | 104°16'20.223"W | 0.00 | |
| 9117.00† | 90.000 | 270.005 | 6050.00 | 2796.42 | 1409.77 | -2498.47 | 40°24'18.739"N | 104°16'21.515"W | 0.00 | |
| 9217.00† | 90.000 | 270.005 | 6050.00 | 2892.29 | 1409.78 | -2598.47 | 40°24'18.739"N | 104°16'22.808"W | 0.00 | |
| 9317.00† | 90.000 | 270.005 | 6050.00 | 2988.15 | 1409.79 | -2698.47 | 40°24'18.739"N | 104°16'24.101"W | 0.00 | |
| 9417.00† | 90.000 | 270.005 | 6050.00 | 3084.02 | 1409.79 | -2798.47 | 40°24'18.739"N | 104°16'25.393"W | 0.00 | |
| 9517.00† | 90.000 | 270.005 | 6050.00 | 3179.88 | 1409.80 | -2898.47 | 40°24'18.739"N | 104°16'26.686"W | 0.00 | |
| 9617.00† | 90.000 | 270.005 | 6050.00 | 3275.75 | 1409.81 | -2998.47 | 40°24'18.739"N | 104°16'27.979"W | 0.00 | |
| 9717.00† | 90.000 | 270.005 | 6050.00 | 3371.61 | 1409.82 | -3098.47 | 40°24'18.739"N | 104°16'29.271"W | 0.00 | |
| 9817.00† | 90.000 | 270.005 | 6050.00 | 3467.48 | 1409.83 | -3198.47 | 40°24'18.739"N | 104°16'30.564"W | 0.00 | |
| 9917.00† | 90.000 | 270.005 | 6050.00 | 3563.34 | 1409.84 | -3298.47 | 40°24'18.739"N | 104°16'31.856"W | 0.00 | |
| 10017.00† | 90.000 | 270.005 | 6050.00 | 3659.21 | 1409.85 | -3398.47 | 40°24'18.739"N | 104°16'33.149"W | 0.00 | |
| 10117.00† | 90.000 | 270.005 | 6050.00 | 3755.07 | 1409.86 | -3498.47 | 40°24'18.739"N | 104°16'34.442"W | 0.00 | |
| 10217.00† | 90.000 | 270.005 | 6050.00 | 3850.94 | 1409.87 | -3598.47 | 40°24'18.739"N | 104°16'35.734"W | 0.00 | |
| 10317.00† | 90.000 | 270.005 | 6050.00 | 3946.80 | 1409.88 | -3698.47 | 40°24'18.739"N | 104°16'37.027"W | 0.00 | |
| 10417.00† | 90.000 | 270.005 | 6050.00 | 4042.67 | 1409.89 | -3798.47 | 40°24'18.739"N | 104°16'38.320"W | 0.00 | |
| 10517.00† | 90.000 | 270.005 | 6050.00 | 4138.53 | 1409.90 | -3898.47 | 40°24'18.739"N | 104°16'39.612"W | 0.00 | |
| 10617.00† | 90.000 | 270.005 | 6050.00 | 4234.40 | 1409.91 | -3998.47 | 40°24'18.739"N | 104°16'40.905"W | 0.00 | |
| 10717.00† | 90.000 | 270.005 | 6050.00 | 4330.26 | 1409.92 | -4098.47 | 40°24'18.739"N | 104°16'42.198"W | 0.00 | |
| 10817.00† | 90.000 | 270.005 | 6050.00 | 4426.13 | 1409.93 | -4198.47 | 40°24'18.738"N | 104°16'43.490"W | 0.00 | |
| 10917.00† | 90.000 | 270.005 | 6050.00 | 4521.99 | 1409.94 | -4298.47 | 40°24'18.738"N | 104°16'44.783"W | 0.00 | |
| 11017.00† | 90.000 | 270.005 | 6050.00 | 4617.86 | 1409.95 | -4398.47 | 40°24'18.738"N | 104°16'46.075"W | 0.00 | |
| 11117.00† | 90.000 | 270.005 | 6050.00 | 4713.72 | 1409.96 | -4498.47 | 40°24'18.738"N | 104°16'47.368"W | 0.00 | |
| 11217.00† | 90.000 | 270.005 | 6050.00 | 4809.59 | 1409.97 | -4598.47 | 40°24'18.738"N | 104°16'48.661"W | 0.00 | |
| 11317.00† | 90.000 | 270.005 | 6050.00 | 4905.45 | 1409.98 | -4698.47 | 40°24'18.738"N | 104°16'49.953"W | 0.00 | |
| 11366.41 | 90.000 | 270.005 | 6050.00 ² | 4952.82 | 1409.98 | -4747.88 | 40°24'18.738"N | 104°16'50.592"W | 0.00 | End of Tangent |

HOLE & CASING SECTIONS - Ref Wellbore: STATE ANTELOPE V41-B11-13HNB PWB Ref Wellpath: STATE ANTELOPE V41-B11-13HNB PWP (REV-A.0)

[illegible]

| HOLE & CASING SECTIONS - Ref Wellbore: STATE ANTELOPE V41-B11-13HNB PWB Ref Wellpath: STATE ANTELOPE V41-B11-13HNB PWP (REV-A.0) | | | | | | | | | |
|---|------------------|----------------|------------------|-------------------|-----------------|-------------------|-------------------|-----------------|-----------------|
| String/Diameter | Start MD [ft] | End MD [ft] | Interval [ft] | Start TVD [ft] | End TVD [ft] | Start N/S [ft] | Start E/W [ft] | End N/S [ft] | End E/W [ft] |
| 13.5in Open Hole | 17.00 | 1550.00 | 1533.00 | 17.00 | 1518.29 | 0.00 | 0.00 | 236.82 | 113.79 |
| 9.625in Casing Surface | 17.00 | 1550.00 | 1533.00 | 17.00 | 1518.29 | 0.00 | 0.00 | 236.82 | 113.79 |
| 8.5in Open Hole | 1550.00 | 11366.41 | 9816.41 | 1518.29 | N/A | 236.82 | 113.79 | N/A | N/A |



Planned Wellpath Report
STATE ANTELOPE V41-B11-13HNB PWP (REV-A.0)
Page 5 of 6



| REFERENCE WELLPATH IDENTIFICATION | | | |
|-----------------------------------|---------------------------|----------|--|
| Operator | BONANZA CREEK OIL COMPANY | Slot | SLOT#06 STATE ANTELOPE V41-B11-13HNB (2587'FNL & 510'FEL,SEC.13) |
| Area | COLORADO | Well | STATE ANTELOPE V41-B11-13HNB |
| Field | WELD COUNTY | Wellbore | STATE ANTELOPE V41-B11-13HNB PWB |
| Facility | SEC.13-T5N-R62W | | |

| TARGETS | | | | | | | | | |
|--|------------|-------------|---------------|--------------|----------------------|-----------------------|----------------|-----------------|---------|
| Name | MD [ft] | TVD [ft] | North [ft] | East [ft] | Grid East [US ft] | Grid North [US ft] | Latitude | Longitude | Shape |
| SEC.13-T5N-R62W | | 0.00 | 0.00 | 0.00 | 3344312.21 | 1391447.38 | 40°24'04.810"N | 104°15'49.219"W | polygon |
| | | | | | | | | | |
| 2) STATE ANTELOPE V41-B11-13HNB BHL (991'FNL & 10'FWL,SEC.13) | 11366.41 | 6050.00 | 1409.98 | -4747.88 | 3339545.33 | 1392790.97 | 40°24'18.738"N | 104°16'50.592"W | point |
| 1) STATE ANTELOPE V41-B11-13HNB LP (1179'FNL & 470'FEL,SEC.13) | 6587.34 | 6050.00 | 1409.52 | 31.19 | 3344323.75 | 1392857.14 | 40°24'18.738"N | 104°15'48.816"W | point |
| | | | | | | | | | |

| SURVEY PROGRAM - Ref Wellbore: STATE ANTELOPE V41-B11-13HNB PWB Ref Wellpath: STATE ANTELOPE V41-B11-13HNB PWP (REV-A.0) | | | | |
|---|----------------|------------------------------|------------------|----------------------------------|
| Start MD [ft] | End MD [ft] | Positional Uncertainty Model | Log Name/Comment | Wellbore |
| 17.00 | 1550.00 | BHI NaviTrak (Rotating) | | STATE ANTELOPE V41-B11-13HNB PWB |
| 1550.00 | 11366.41 | BHI AutoTrak Curve (Short) | | STATE ANTELOPE V41-B11-13HNB PWB |



Planned Wellpath Report

STATE ANTELOPE V41-B11-13HNB PWP (REV-A.0)

Page 6 of 6



| REFERENCE WELLPATH IDENTIFICATION | | | |
|-----------------------------------|---------------------------|----------|--|
| Operator | BONANZA CREEK OIL COMPANY | Slot | SLOT#06 STATE ANTELOPE V41-B11-13HNB (2587'FNL & 510'FEL,SEC.13) |
| Area | COLORADO | Well | STATE ANTELOPE V41-B11-13HNB |
| Field | WELD COUNTY | Wellbore | STATE ANTELOPE V41-B11-13HNB PWB |
| Facility | SEC.13-T5N-R62W | | |

| DESIGN COMMENTS | | | | |
|-----------------|--------------------|----------------|-------------|----------------|
| MD [ft] | Inclination [°] | Azimuth [°] | TVD [ft] | Comment |
| 17.00 | 0.000 | 25.664 | 17.00 | Tie On |
| 200.00 | 0.000 | 25.664 | 200.00 | End of Tangent |
| 1000.90 | 16.018 | 25.664 | 990.50 | End of Build |
| 5618.71 | 16.018 | 25.664 | 5429.04 | End of Tangent |
| 6587.34 | 90.000 | 270.005 | 6050.00 | End of 3D Arc |
| 11366.41 | 90.000 | 270.005 | 6050.00 | End of Tangent |



Clearance Report

STATE ANTELOPE V41-B11-13HNB PWP (REV-A.0)

Closest Approach

Page 1 of 18



| REFERENCE WELLPATH IDENTIFICATION | | | |
|-----------------------------------|---------------------------|----------|--|
| Operator | BONANZA CREEK OIL COMPANY | Slot | SLOT#06 STATE ANTELOPE V41-B11-13HNB (2587'FNL & 510'FEL,SEC.13) |
| Area | COLORADO | Well | STATE ANTELOPE V41-B11-13HNB |
| Field | WELD COUNTY | Wellbore | STATE ANTELOPE V41-B11-13HNB PWB |
| Facility | SEC.13-T5N-R62W | | |

| REPORT SETUP INFORMATION | | | |
|--------------------------|---|----------------------|---|
| Projection System | NAD83 / Lambert Colorado SP, Northern Zone (501), US feet | Software System | WellArchitect® 5.1 |
| North Reference | True | User | Robiale01 |
| Scale | 0.999960 | Report Generated | 11/15/2018 at 9:35:48 AM |
| Convergence at slot | 0.80° East | Database/Source file | WA DENVER/STATE_ANTELOPE_V41-B11-13HNB_PWP_REV-A.0_CR.xml |

| WELLPATH LOCATION | | | | | | |
|-----------------------|-------------------|----------|------------------|-----------------|------------------------|-----------------|
| | Local coordinates | | Grid coordinates | | Geographic coordinates | |
| | North[ft] | East[ft] | Easting[US ft] | Northing[US ft] | Latitude | Longitude |
| Slot Location | 1416.12 | 4472.42 | 3344312.21 | 1391447.38 | 40°24'04.810"N | 104°15'49.219"W |
| Facility Reference Pt | | | 3339859.89 | 1389969.91 | 40°23'50.820"N | 104°16'47.028"W |
| Field Reference Pt | | | 3224525.77 | 1254425.87 | 40°01'44.400"N | 104°41'53.556"W |

| WELLPATH DATUM | | | |
|--------------------------|-------------------|--|-----------|
| Calculation method | Minimum Curvature | RIG (17') (RKB) to Facility Vertical Datum | 4590.00ft |
| Horizontal Reference Pt | Slot | RIG (17') (RKB) to Mean Sea Level | 4590.00ft |
| Vertical Reference Pt | RIG (17') (RKB) | RIG (17') (RKB) to Ground Level at Slot (SLOT#06 STATE ANTELOPE V41-B11-13HNB (2587'FNL & 510'FEL,SEC.13)) | 4590.00ft |
| MD Reference Pt | RIG (17') (RKB) | | |
| Field Vertical Reference | Mean Sea Level | | |

| POSITIONAL UNCERTAINTY CALCULATION SETTINGS | | | | | |
|---|------------------|------------------|---------|------------------------------|----------|
| Ellipse Confidence Limit | 3.00 Std Dev | Ellipse Start MD | 17.00ft | Surface Position Uncertainty | included |
| Declination | 8.26° East of TN | Dip Angle | 67.01° | Mag Field Strength | 52834 nT |
| Slot Surface Uncertainty @1SD | | Horizontal | 0.100ft | Vertical | 1.000ft |
| Facility Surface Uncertainty @1SD | | Horizontal | 8.200ft | Vertical | 3.000ft |
| Positional Uncertainty values in the WELLPATH DATA table are the projection of the ellipsoid of uncertainty onto the vertical and horizontal planes | | | | | |

| ANTI-COLLISION RULE | | | |
|---------------------|--|--|--|
| | | | |

| ANTI-COLLISION RULE | | | |
|----------------------------|---|----------------------|-------|
| Rule Name | Baker Hughes Stop Drilling (offset is HSE risk) | Rule Based On | Ratio |
| Plane of Rule | Closest Approach | Threshold Value | 1.00 |
| Include Casing & Hole Size | yes | Apply Cone of Safety | no |



Clearance Report

STATE ANTELOPE V41-B11-13HNB PWP (REV-A.0)

Closest Approach

Page 2 of 18



| REFERENCE WELLPATH IDENTIFICATION | | | |
|-----------------------------------|---------------------------|----------|--|
| Operator | BONANZA CREEK OIL COMPANY | Slot | SLOT#06 STATE ANTELOPE V41-B11-13HNB (2587'FNL & 510'FEL,SEC.13) |
| Area | COLORADO | Well | STATE ANTELOPE V41-B11-13HNB |
| Field | WELD COUNTY | Wellbore | STATE ANTELOPE V41-B11-13HNB PWB |
| Facility | SEC.13-T5N-R62W | | |

| HOLE & CASING SECTIONS - Ref Wellbore: STATE ANTELOPE V41-B11-13HNB PWB Ref Wellpath: STATE ANTELOPE V41-B11-13HNB PWP (REV-A.0) | | | | | | | | | |
|---|------------------|----------------|------------------|-------------------|-----------------|-------------------|-------------------|-----------------|-----------------|
| String/Diameter | Start MD [ft] | End MD [ft] | Interval [ft] | Start TVD [ft] | End TVD [ft] | Start N/S [ft] | Start E/W [ft] | End N/S [ft] | End E/W [ft] |
| 13.5in Open Hole | 17.00 | 1550.00 | 1533.00 | 17.00 | 1518.29 | 0.00 | 0.00 | 236.82 | 113.79 |
| 9.625in Casing Surface | 17.00 | 1550.00 | 1533.00 | 17.00 | 1518.29 | 0.00 | 0.00 | 236.82 | 113.79 |
| 8.5in Open Hole | 1550.00 | 11366.41 | 9816.41 | 1518.29 | N/A | 236.82 | 113.79 | N/A | N/A |

| SURVEY PROGRAM - Ref Wellbore: STATE ANTELOPE V41-B11-13HNB PWB Ref Wellpath: STATE ANTELOPE V41-B11-13HNB PWP (REV-A.0) | | | | |
|---|----------------|------------------------------|------------------|----------------------------------|
| Start MD [ft] | End MD [ft] | Positional Uncertainty Model | Log Name/Comment | Wellbore |
| 17.00 | 1550.00 | BHI NaviTrak (Rotating) | | STATE ANTELOPE V41-B11-13HNB PWB |
| 1550.00 | 11366.41 | BHI AutoTrak Curve (Short) | | STATE ANTELOPE V41-B11-13HNB PWB |

| CALCULATION RANGE & CUTOFF | | |
|----------------------------|-------------------|------------------------|
| From: 17.00ft MD | To: 11366.41ft MD | C-C Cutoff: 1000.00 ft |

| OFFSET WELL CLEARANCE SUMMARY (6 Offset Wellpaths selected) Ratios are calculated in Closest Approach plane | | | | | | | | | | | |
|---|--|------------------------------|----------------------------------|--|------------------------|-------------------------------|------------------------------|--------------------------------|--------------|--------------------------------|---------------|
| Offset Facility | Offset Slot | Offset Well | Offset Wellbore | Offset Wellpath | C-C Clearance Distance | | | ACR Separation Ratio | | | |
| | | | | | Ref MD [ft] | Min C-C Clear Dist [ft] | Diverging from MD [ft] | Ref MD of Min Ratio [ft] | Min Ratio | Min Ratio Dvrg from [ft] | ACR Status |
| SEC.13-T5N-R62W | SLOT#07 STATE ANTELOPE V-B-13HNB (2607'FNL & 510'FEL,SEC.13) | STATE ANTELOPE V-B-13HNB | STATE ANTELOPE V-B-13HNB PWB | STATE ANTELOPE V-B-13HNB PWP (REV-A.0) | 17.00 | 20.04 | 200.00 | 11366.41 | 0.87 | 11366.41 | FAIL |
| SEC.13-T5N-R62W | SLOT#08 STATE ANTELOPE 42-12-13HNB (2627'FNL & 510'FEL,SEC.13) | STATE ANTELOPE 42-12-13HNB | STATE ANTELOPE 42-12-13HNB PWB | STATE ANTELOPE 42-12-13HNB PWP (REV-A.0) | 17.00 | 40.07 | 200.00 | 11366.41 | 1.75 | 11366.41 | PASS |
| SEC.13-T5N-R62W | SLOT#09 STATE ANTELOPE W42-C12-13HNB (2647'FNL & 510'FEL,SEC.13) | STATE ANTELOPE W42-C12-13HNB | STATE ANTELOPE W42-C12-13HNB PWB | STATE ANTELOPE W42-C12-13HNB PWP (REV-A.0) | 17.00 | 60.11 | 200.00 | 11366.41 | 2.63 | 11366.41 | PASS |
| SEC.13-T5N-R62W | SLOT#10 STATE ANTELOPE X44-D14-13HNB (2667'FNL & 510'FEL,SEC.13) | STATE ANTELOPE X44-D14-13HNB | STATE ANTELOPE X44-D14-13HNB PWB | STATE ANTELOPE X44-D14-13HNB PWP (REV-A.0) | 17.00 | 80.15 | 200.00 | 11366.41 | 6.18 | 11366.41 | PASS |
| SEC.13-T5N-R62W | SLOT#11 STATE ANTELOPE Y44-E14-13HNB (2687'FNL & 510'FEL,SEC.13) | STATE ANTELOPE Y44-E14-13HNB | STATE ANTELOPE Y44-E14-13HNB PWB | STATE ANTELOPE Y44-E14-13HNB PWP (REV-A.0) | 17.00 | 100.19 | 200.00 | 11366.41 | 7.04 | 11366.41 | PASS |
| SEC.13-T5N-R62W | SLOT#12 STATE ANTELOPE Y-E-13HNB (2699'FSL & 510'FEL,SEC.13) | STATE ANTELOPE Y-E-13HNB | STATE ANTELOPE Y-E-13HNB PWB | STATE ANTELOPE Y-E-13HNB PWP (REV-A.0) | 17.00 | 120.22 | 200.00 | 11366.41 | 7.60 | 11366.41 | PASS |



| REFERENCE WELLPATH IDENTIFICATION | | | |
|-----------------------------------|---------------------------|----------|--|
| Operator | BONANZA CREEK OIL COMPANY | Slot | SLOT#06 STATE ANTELOPE V41-B11-13HNB (2587'FNL & 510'FEL,SEC.13) |
| Area | COLORADO | Well | STATE ANTELOPE V41-B11-13HNB |
| Field | WELD COUNTY | Wellbore | STATE ANTELOPE V41-B11-13HNB PWB |
| Facility | SEC.13-T5N-R62W | | |

| CLEARANCE DATA - Offset Wellbore: STATE ANTELOPE V-B-13HNB PWB Offset Wellpath: STATE ANTELOPE V-B-13HNB PWP (REV-A.0) | | | | | | | | | | | | |
|---|-----------------|--|------------------|-------------------|--------------------|--------------------------------|---------------------|---|---------------------------|---------------------|--------------|---------------|
| Facility: SEC.13-T5N-R62W | | Slot: SLOT#07 STATE ANTELOPE V-B-13HNB (2607°FNL & 510°FEL,SEC.13) | | | | Well: STATE ANTELOPE V-B-13HNB | | Threshold Value=1.00 † = interpolated/extrapolated station | | | | |
| Ref MD [ft] | Ref TVD [ft] | Ref North [ft] | Ref East [ft] | Offset MD [ft] | Offset TVD [ft] | Offset North [ft] | Offset East [ft] | Angle from Highside [°] | C-C Clear Dist [ft] | ACR MASD [ft] | Sep Ratio | ACR Status |
| 17.00 | 17.00 | 0.00 | 0.00 | 17.00 | 17.00 | -20.04 | 0.00 | -180.00 | 20.04 | 1.56 | 31.79 | PASS |
| 117.00† | 117.00 | 0.00 | 0.00 | 117.00 | 117.00 | -20.04 | 0.00 | -180.00 | 20.04 | 2.18 | 15.64 | PASS |
| 200.00 | 200.00 | 0.00 | 0.00 | 200.00 | 200.00 | -20.04 | 0.00 | -180.00 | 20.04 | 2.99 | 9.40 | PASS |
| 217.00† | 217.00 | 0.05 | 0.02 | 217.00 | 217.00 | -20.04 | 0.00 | 154.40 | 20.08 | 3.16 | 8.70 | PASS |
| 317.00† | 316.97 | 2.15 | 1.03 | 317.08 | 317.08 | -20.00 | 0.03 | 156.92 | 22.17 | 4.38 | 6.20 | PASS |
| 417.00† | 416.79 | 7.40 | 3.56 | 417.73 | 417.70 | -18.06 | 1.39 | 159.19 | 25.57 | 6.05 | 4.84 | PASS |
| 517.00† | 516.35 | 15.79 | 7.59 | 518.50 | 518.29 | -13.23 | 4.80 | 159.85 | 29.22 | 7.77 | 4.15 | PASS |
| 617.00† | 615.53 | 27.31 | 13.12 | 619.38 | 618.72 | -5.51 | 10.25 | 159.42 | 33.09 | 9.26 | 3.87 | PASS |
| 717.00† | 714.20 | 41.93 | 20.15 | 720.36 | 718.85 | 5.12 | 17.75 | 158.23 | 37.19 | 10.63 | 3.75 | PASS |
| 817.00† | 812.24 | 59.66 | 28.66 | 821.43 | 818.56 | 18.63 | 27.28 | 156.54 | 41.53 | 11.94 | 3.70 | PASS |
| 917.00† | 909.54 | 80.45 | 38.66 | 922.48 | 917.60 | 35.00 | 38.82 | 154.52 | 46.17 | 13.21 | 3.69 | PASS |
| 1000.90 | 990.50 | 100.25 | 48.17 | 1006.20 | 999.41 | 49.54 | 49.09 | 153.65 | 51.49 | 14.18 | 3.82 | PASS |
| 1017.00† | 1005.98 | 104.26 | 50.09 | 1022.26 | 1015.10 | 52.33 | 51.05 | 153.63 | 52.73 | 14.36 | 3.86 | PASS |
| 1117.00† | 1102.10 | 129.13 | 62.05 | 1121.97 | 1112.52 | 69.66 | 63.27 | 153.50 | 60.39 | 15.44 | 4.11 | PASS |
| 1217.00† | 1198.22 | 154.00 | 74.00 | 1221.67 | 1209.95 | 86.98 | 75.50 | 153.41 | 68.06 | 16.58 | 4.30 | PASS |
| 1317.00† | 1294.34 | 178.87 | 85.95 | 1321.38 | 1307.37 | 104.30 | 87.72 | 153.33 | 75.72 | 17.74 | 4.46 | PASS |
| 1417.00† | 1390.45 | 203.74 | 97.90 | 1421.08 | 1404.80 | 121.63 | 99.94 | 153.26 | 83.39 | 18.94 | 4.59 | PASS |
| 1517.00† | 1486.57 | 228.62 | 109.85 | 1520.79 | 1502.22 | 138.95 | 112.16 | 153.21 | 91.05 | 20.15 | 4.69 | PASS |
| 1617.00† | 1582.69 | 253.49 | 121.80 | 1620.50 | 1599.65 | 156.27 | 124.38 | 153.17 | 98.72 | 20.68 | 4.91 | PASS |
| 1717.00† | 1678.81 | 278.36 | 133.75 | 1720.20 | 1697.08 | 173.60 | 136.60 | 153.13 | 106.38 | 21.07 | 5.19 | PASS |
| 1817.00† | 1774.92 | 303.23 | 145.70 | 1819.91 | 1794.50 | 190.92 | 148.82 | 153.10 | 114.05 | 21.55 | 5.44 | PASS |
| 1917.00† | 1871.04 | 328.10 | 157.65 | 1919.61 | 1891.93 | 208.24 | 161.04 | 153.07 | 121.71 | 22.11 | 5.65 | PASS |
| 2017.00† | 1967.16 | 352.97 | 169.60 | 2019.32 | 1989.35 | 225.57 | 173.26 | 153.04 | 129.38 | 22.74 | 5.84 | PASS |
| 2117.00† | 2063.28 | 377.85 | 181.55 | 2119.02 | 2086.78 | 242.89 | 185.48 | 153.02 | 137.04 | 23.44 | 6.00 | PASS |
| 2217.00† | 2159.39 | 402.72 | 193.50 | 2218.73 | 2184.21 | 260.21 | 197.70 | 153.00 | 144.71 | 24.21 | 6.13 | PASS |
| 2317.00† | 2255.51 | 427.59 | 205.45 | 2318.44 | 2281.63 | 277.54 | 209.93 | 152.98 | 152.37 | 25.03 | 6.24 | PASS |
| 2417.00† | 2351.63 | 452.46 | 217.40 | 2418.14 | 2379.06 | 294.86 | 222.15 | 152.97 | 160.04 | 25.90 | 6.33 | PASS |
| 2517.00† | 2447.75 | 477.33 | 229.35 | 2517.85 | 2476.48 | 312.18 | 234.37 | 152.95 | 167.70 | 26.81 | 6.40 | PASS |
| 2617.00† | 2543.86 | 502.20 | 241.31 | 2617.55 | 2573.91 | 329.51 | 246.59 | 152.94 | 175.37 | 27.77 | 6.46 | PASS |
| 2717.00† | 2639.98 | 527.08 | 253.26 | 2717.26 | 2671.33 | 346.83 | 258.81 | 152.92 | 183.04 | 28.76 | 6.50 | PASS |
| 2817.00† | 2736.10 | 551.95 | 265.21 | 2816.96 | 2768.76 | 364.15 | 271.03 | 152.91 | 190.70 | 29.78 | 6.53 | PASS |
| 2917.00† | 2832.22 | 576.82 | 277.16 | 2916.67 | 2866.19 | 381.48 | 283.25 | 152.90 | 198.37 | 30.84 | 6.56 | PASS |
| 3017.00† | 2928.33 | 601.69 | 289.11 | 3016.38 | 2963.61 | 398.80 | 295.47 | 152.89 | 206.03 | 31.92 | 6.58 | PASS |

| CLEARANCE DATA - Offset Wellbore: STATE ANTELOPE V-B-13HNB PWB Offset Wellpath: STATE ANTELOPE V-B-13HNB PWP (REV-A.0) | | | | | | | | | | | | |
|---|-----------------|--|------------------|-------------------|--------------------|--------------------------------|---------------------|----------------------------|---------------------------|---------------------------------------|--------------|---------------|
| Facility: SEC.13-T5N-R62W | | Slot: SLOT#07 STATE ANTELOPE V-B-13HNB (2607'FNL & 510'FEL,SEC.13) | | | | Well: STATE ANTELOPE V-B-13HNB | | Threshold Value=1.00 | | † = interpolated/extrapolated station | | |
| Ref MD [ft] | Ref TVD [ft] | Ref North [ft] | Ref East [ft] | Offset MD [ft] | Offset TVD [ft] | Offset North [ft] | Offset East [ft] | Angle from Highside [°] | C-C Clear Dist [ft] | ACR MASD [ft] | Sep Ratio | ACR Status |
| 3117.00† | 3024.45 | 626.56 | 301.06 | 3116.08 | 3061.04 | 416.12 | 307.69 | 152.88 | 213.70 | 33.03 | 6.59 | PASS |
| 3217.00† | 3120.57 | 651.43 | 313.01 | 3215.79 | 3158.46 | 433.45 | 319.91 | 152.88 | 221.36 | 34.15 | 6.60 | PASS |
| 3317.00† | 3216.69 | 676.31 | 324.96 | 3315.49 | 3255.89 | 450.77 | 332.13 | 152.87 | 229.03 | 35.30 | 6.60 | PASS |
| 3417.00† | 3312.80 | 701.18 | 336.91 | 3415.20 | 3353.31 | 468.09 | 344.35 | 152.86 | 236.69 | 36.46 | 6.60 | PASS |
| 3517.00† | 3408.92 | 726.05 | 348.86 | 3514.90 | 3450.74 | 485.42 | 356.58 | 152.85 | 244.36 | 37.64 | 6.60 | PASS |
| 3617.00† | 3505.04 | 750.92 | 360.81 | 3614.61 | 3548.17 | 502.74 | 368.80 | 152.85 | 252.03 | 38.84 | 6.59 | PASS |
| 3717.00† | 3601.16 | 775.79 | 372.76 | 3714.32 | 3645.59 | 520.06 | 381.02 | 152.84 | 259.69 | 40.04 | 6.58 | PASS |
| 3817.00† | 3697.27 | 800.66 | 384.71 | 3814.02 | 3743.02 | 537.39 | 393.24 | 152.83 | 267.36 | 41.26 | 6.58 | PASS |
| 3917.00† | 3793.39 | 825.54 | 396.66 | 3913.73 | 3840.44 | 554.71 | 405.46 | 152.83 | 275.02 | 42.49 | 6.57 | PASS |
| 4017.00† | 3889.51 | 850.41 | 408.61 | 4013.43 | 3937.87 | 572.03 | 417.68 | 152.82 | 282.69 | 43.73 | 6.55 | PASS |
| 4117.00† | 3985.63 | 875.28 | 420.57 | 4113.14 | 4035.30 | 589.36 | 429.90 | 152.82 | 290.35 | 44.98 | 6.54 | PASS |
| 4217.00† | 4081.74 | 900.15 | 432.52 | 4212.85 | 4132.72 | 606.68 | 442.12 | 152.81 | 298.02 | 46.24 | 6.53 | PASS |

C-C Clearance Distance Cutoff: 1000.00 ft



Clearance Report
STATE ANTELOPE V41-B11-13HNB PWP (REV-A.0)
Closest Approach
Page 4 of 18



| REFERENCE WELLPATH IDENTIFICATION | | | |
|-----------------------------------|---------------------------|----------|--|
| Operator | BONANZA CREEK OIL COMPANY | Slot | SLOT#06 STATE ANTELOPE V41-B11-13HNB (2587'FNL & 510'FEL,SEC.13) |
| Area | COLORADO | Well | STATE ANTELOPE V41-B11-13HNB |
| Field | WELD COUNTY | Wellbore | STATE ANTELOPE V41-B11-13HNB PWB |
| Facility | SEC.13-T5N-R62W | | |

| CLEARANCE DATA - Offset Wellbore: STATE ANTELOPE V-B-13HNB PWB Offset Wellpath: STATE ANTELOPE V-B-13HNB PWP (REV-A.0) | | | | | | | | | | | | | |
|--|-----------------|--|------------------|-------------------|--------------------|--------------------------------|---------------------|----------------------------|---------------------------|---------------------------------------|--------------|---------------|--|
| Facility: SEC.13-T5N-R62W | | Slot: SLOT#07 STATE ANTELOPE V-B-13HNB (2607'FNL & 510'FEL,SEC.13) | | | | Well: STATE ANTELOPE V-B-13HNB | | Threshold Value=1.00 | | † = interpolated/extrapolated station | | | |
| Ref MD [ft] | Ref TVD [ft] | Ref North [ft] | Ref East [ft] | Offset MD [ft] | Offset TVD [ft] | Offset North [ft] | Offset East [ft] | Angle from Highside [°] | C-C Clear Dist [ft] | ACR MASD [ft] | Sep Ratio | ACR Status | |
| 4317.00† | 4177.86 | 925.02 | 444.47 | 4312.55 | 4230.15 | 624.01 | 454.34 | 152.81 | 305.68 | 47.50 | 6.52 | PASS | |
| 4417.00† | 4273.98 | 949.89 | 456.42 | 4412.26 | 4327.57 | 641.33 | 466.56 | 152.81 | 313.35 | 48.78 | 6.50 | PASS | |
| 4517.00† | 4370.10 | 974.77 | 468.37 | 4511.96 | 4425.00 | 658.65 | 478.78 | 152.80 | 321.02 | 50.05 | 6.49 | PASS | |
| 4617.00† | 4466.21 | 999.64 | 480.32 | 4611.67 | 4522.42 | 675.98 | 491.01 | 152.80 | 328.68 | 51.34 | 6.48 | PASS | |
| 4717.00† | 4562.33 | 1024.51 | 492.27 | 4711.37 | 4619.85 | 693.30 | 503.23 | 152.79 | 336.35 | 52.63 | 6.46 | PASS | |
| 4817.00† | 4658.45 | 1049.38 | 504.22 | 4811.08 | 4717.28 | 710.62 | 515.45 | 152.79 | 344.01 | 53.93 | 6.45 | PASS | |
| 4917.00† | 4754.57 | 1074.25 | 516.17 | 4910.79 | 4814.70 | 727.95 | 527.67 | 152.79 | 351.68 | 55.23 | 6.44 | PASS | |
| 5017.00† | 4850.68 | 1099.12 | 528.12 | 5010.49 | 4912.13 | 745.27 | 539.89 | 152.78 | 359.34 | 56.53 | 6.42 | PASS | |
| 5117.00† | 4946.80 | 1124.00 | 540.07 | 5110.20 | 5009.55 | 762.59 | 552.11 | 152.78 | 367.01 | 57.84 | 6.41 | PASS | |
| 5217.00† | 5042.92 | 1148.87 | 552.02 | 5209.90 | 5106.98 | 779.92 | 564.33 | 152.78 | 374.67 | 59.15 | 6.40 | PASS | |
| 5317.00† | 5139.04 | 1173.74 | 563.97 | 5309.61 | 5204.41 | 797.24 | 576.55 | 152.78 | 382.34 | 60.47 | 6.39 | PASS | |
| 5417.00† | 5235.15 | 1198.61 | 575.92 | 5409.31 | 5301.83 | 814.56 | 588.77 | 152.77 | 390.01 | 61.79 | 6.37 | PASS | |
| 5517.00† | 5331.27 | 1223.48 | 587.87 | 5509.02 | 5399.26 | 831.89 | 600.99 | 152.77 | 397.67 | 63.11 | 6.36 | PASS | |
| 5617.00† | 5427.39 | 1248.35 | 599.83 | 5609.81 | 5498.19 | 849.45 | 607.29 | 153.63 | 405.21 | 63.76 | 6.42 | PASS | |
| 5618.71 | 5429.04 | 1248.78 | 600.03 | 5611.52 | 5499.87 | 849.74 | 607.25 | 153.66 | 405.34 | 63.77 | 6.42 | PASS | |
| 5717.00† | 5524.02 | 1273.36 | 603.37 | 5708.16 | 5594.35 | 866.43 | 596.64 | -167.52 | 413.02 | 63.46 | 6.57 | PASS | |
| 5817.00† | 5619.77 | 1298.14 | 589.53 | 5804.22 | 5685.22 | 882.39 | 570.28 | -135.27 | 421.30 | 62.83 | 6.77 | PASS | |
| 5917.00† | 5711.75 | 1321.94 | 558.73 | 5898.26 | 5768.77 | 896.99 | 529.92 | -117.32 | 429.73 | 62.72 | 6.92 | PASS | |
| 6017.00† | 5797.14 | 1344.05 | 511.89 | 5990.59 | 5843.42 | 909.95 | 477.33 | -107.03 | 437.92 | 62.57 | 7.07 | PASS | |
| 6117.00† | 5873.37 | 1363.78 | 450.45 | 6081.47 | 5907.86 | 921.05 | 414.34 | -100.52 | 445.54 | 63.02 | 7.14 | PASS | |
| 6217.00† | 5938.11 | 1380.54 | 376.27 | 6171.20 | 5961.09 | 930.11 | 342.79 | -96.14 | 452.25 | 64.37 | 7.09 | PASS | |
| 6317.00† | 5989.39 | 1393.82 | 291.61 | 6260.03 | 6002.33 | 937.02 | 264.52 | -93.17 | 457.78 | 66.73 | 6.92 | PASS | |
| 6417.00† | 6025.67 | 1403.21 | 199.03 | 6348.22 | 6031.02 | 941.68 | 181.35 | -91.26 | 461.90 | 70.04 | 6.65 | PASS | |
| 6517.00† | 6045.83 | 1408.44 | 101.35 | 6436.00 | 6046.78 | 944.04 | 95.12 | -90.24 | 464.44 | 74.04 | 6.32 | PASS | |
| 6587.34 | 6050.00 | 1409.52 | 31.19 | 6497.67 | 6050.00 | 944.30 | 33.56 | -90.00 | 465.24 | 77.13 | 6.08 | PASS | |
| 6617.00† | 6050.00 | 1409.53 | 1.53 | 6527.34 | 6050.00 | 944.14 | 3.90 | -90.00 | 465.39 | 78.62 | 5.96 | PASS | |
| 6717.00† | 6050.00 | 1409.54 | -98.47 | 6627.33 | 6050.00 | 943.64 | -96.10 | -90.00 | 465.91 | 84.35 | 5.56 | PASS | |
| 6817.00† | 6050.00 | 1409.55 | -198.47 | 6727.33 | 6050.00 | 943.13 | -196.10 | -90.00 | 466.42 | 90.78 | 5.17 | PASS | |
| 6917.00† | 6050.00 | 1409.56 | -298.47 | 6827.33 | 6050.00 | 942.62 | -296.10 | -90.00 | 466.94 | 98.57 | 4.76 | PASS | |
| 7017.00† | 6050.00 | 1409.57 | -398.47 | 6927.33 | 6050.00 | 942.11 | -396.09 | -90.00 | 467.46 | 106.65 | 4.41 | PASS | |
| 7117.00† | 6050.00 | 1409.58 | -498.47 | 7027.33 | 6050.00 | 941.60 | -496.09 | -90.00 | 467.98 | 115.20 | 4.08 | PASS | |
| 7217.00† | 6050.00 | 1409.58 | -598.47 | 7127.33 | 6050.00 | 941.09 | -596.09 | -90.00 | 468.50 | 124.12 | 3.79 | PASS | |
| 7317.00† | 6050.00 | 1409.59 | -698.47 | 7227.33 | 6050.00 | 940.59 | -696.09 | -90.00 | 469.01 | 133.34 | 3.53 | PASS | |
| | | | | | | | | | | | | | |

| CLEARANCE DATA - Offset Wellbore: STATE ANTELOPE V-B-13HNB PWB Offset Wellpath: STATE ANTELOPE V-B-13HNB PWP (REV-A.0) | | | | | | | | | | | | |
|---|-----------------|--|------------------|-------------------|--------------------|--------------------------------|---------------------|----------------------------|---------------------------|---------------------------------------|--------------|---------------|
| Facility: SEC.13-T5N-R62W | | Slot: SLOT#07 STATE ANTELOPE V-B-13HNB (2607'FNL & 510'FEL,SEC.13) | | | | Well: STATE ANTELOPE V-B-13HNB | | Threshold Value=1.00 | | † = interpolated/extrapolated station | | |
| Ref MD [ft] | Ref TVD [ft] | Ref North [ft] | Ref East [ft] | Offset MD [ft] | Offset TVD [ft] | Offset North [ft] | Offset East [ft] | Angle from Highside [°] | C-C Clear Dist [ft] | ACR MASD [ft] | Sep Ratio | ACR Status |
| 7417.00† | 6050.00 | 1409.60 | -798.47 | 7327.33 | 6050.00 | 940.08 | -796.08 | -90.00 | 469.53 | 142.80 | 3.30 | PASS |
| 7517.00† | 6050.00 | 1409.61 | -898.47 | 7427.32 | 6050.00 | 939.57 | -896.08 | -90.00 | 470.05 | 152.46 | 3.09 | PASS |
| 7617.00† | 6050.00 | 1409.62 | -998.47 | 7527.32 | 6050.00 | 939.06 | -996.08 | -90.00 | 470.57 | 162.27 | 2.91 | PASS |
| 7717.00† | 6050.00 | 1409.63 | -1098.47 | 7627.32 | 6050.00 | 938.55 | -1096.08 | -90.00 | 471.09 | 172.22 | 2.74 | PASS |
| 7817.00† | 6050.00 | 1409.64 | -1198.47 | 7727.32 | 6050.00 | 938.04 | -1196.07 | -90.00 | 471.60 | 182.28 | 2.59 | PASS |
| 7917.00† | 6050.00 | 1409.65 | -1298.47 | 7827.32 | 6050.00 | 937.54 | -1296.07 | -90.00 | 472.12 | 192.43 | 2.46 | PASS |
| 8017.00† | 6050.00 | 1409.66 | -1398.47 | 7927.32 | 6050.00 | 937.03 | -1396.07 | -90.00 | 472.64 | 202.66 | 2.34 | PASS |
| 8117.00† | 6050.00 | 1409.67 | -1498.47 | 8027.32 | 6050.00 | 936.52 | -1496.07 | -90.00 | 473.16 | 212.96 | 2.23 | PASS |
| 8217.00† | 6050.00 | 1409.68 | -1598.47 | 8127.31 | 6050.00 | 936.01 | -1596.06 | -90.00 | 473.68 | 223.32 | 2.12 | PASS |
| 8317.00† | 6050.00 | 1409.69 | -1698.47 | 8227.31 | 6050.00 | 935.50 | -1696.06 | -90.00 | 474.19 | 233.73 | 2.03 | PASS |
| 8417.00† | 6050.00 | 1409.70 | -1798.47 | 8327.31 | 6050.00 | 934.99 | -1796.06 | -90.00 | 474.71 | 244.18 | 1.95 | PASS |
| 8517.00† | 6050.00 | 1409.71 | -1898.47 | 8427.31 | 6050.00 | 934.49 | -1896.05 | -90.00 | 475.23 | 254.68 | 1.87 | PASS |

C-C Clearance Distance Cutoff: 1000.00 ft

| POSITIONAL UNCERTAINTY - Offset Wellbore: STATE ANTELOPE V-B-13HNB PWB Offset Wellpath: STATE ANTELOPE V-B-13HNB PWP (REV-A.0) | | | | |
|---|------------|---------|----------|---------|
| Slot Surface Uncertainty @1SD | Horizontal | 0.100ft | Vertical | 1.000ft |
| Facility Surface Uncertainty @1SD | Horizontal | 8.200ft | Vertical | 3.000ft |

| HOLE & CASING SECTIONS - Offset Wellbore: STATE ANTELOPE V-B-13HNB PWB Offset Wellpath: STATE ANTELOPE V-B-13HNB PWP (REV-A.0) | | | | | | | | | |
|---|------------------|----------------|------------------|-------------------|-----------------|-------------------|-------------------|-----------------|-----------------|
| String/Diameter | Start MD [ft] | End MD [ft] | Interval [ft] | Start TVD [ft] | End TVD [ft] | Start N/S [ft] | Start E/W [ft] | End N/S [ft] | End E/W [ft] |
| 13.5in Open Hole | 17.00 | 1550.00 | 1533.00 | 17.00 | 1530.77 | -12.21 | 0.00 | 37.79 | 35.28 |
| 9.625in Casing Surface | 17.00 | 1550.00 | 1533.00 | 17.00 | 1530.77 | -12.21 | 0.00 | 37.79 | 35.28 |
| 8.5in Open Hole | 1550.00 | 11280.38 | 9730.38 | 1530.77 | N/A | 37.79 | 35.28 | N/A | N/A |



Clearance Report

STATE ANTELOPE V41-B11-13HNB PWP (REV-A.0)

Closest Approach

Page 6 of 18



| REFERENCE WELLPATH IDENTIFICATION | | | |
|-----------------------------------|---------------------------|----------|--|
| Operator | BONANZA CREEK OIL COMPANY | Slot | SLOT#06 STATE ANTELOPE V41-B11-13HNB (2587'FNL & 510'FEL,SEC.13) |
| Area | COLORADO | Well | STATE ANTELOPE V41-B11-13HNB |
| Field | WELD COUNTY | Wellbore | STATE ANTELOPE V41-B11-13HNB PWB |
| Facility | SEC.13-T5N-R62W | | |

| SURVEY PROGRAM - Offset Wellbore: STATE ANTELOPE V-B-13HNB PWB Offset Wellpath: STATE ANTELOPE V-B-13HNB PWP (REV-A.0) | | | | |
|---|----------------|------------------------------|------------------|------------------------------|
| Start MD [ft] | End MD [ft] | Positional Uncertainty Model | Log Name/Comment | Wellbore |
| 17.00 | 1550.00 | BHI NaviTrak (Rotating) | | STATE ANTELOPE V-B-13HNB PWB |
| 1550.00 | 11280.38 | BHI AutoTrak Curve (Short) | | STATE ANTELOPE V-B-13HNB PWB |

| OFFSET WELLPATH REFERENCE - Offset Wellbore: STATE ANTELOPE V-B-13HNB PWB Offset Wellpath: STATE ANTELOPE V-B-13HNB PWP (REV-A.0) | |
|--|---|
| MD Reference: RIG (17') (RKB) | Offset TVD & local coordinates use Reference Wellpath settings (See WELLPATH DATUM on page 1 of this report) |
| Ellipse Start MD | 17.00ft |

| CLEARANCE DATA - Offset Wellbore: STATE ANTELOPE 42-12-13HNB PWB Offset Wellpath: STATE ANTELOPE 42-12-13HNB PWP (REV-A.0) | | | | | | | | | | | | |
|---|-----------------|--|------------------|-------------------|--------------------|----------------------------------|---------------------|----------------------------|---|---------------------|--------------|---------------|
| Facility: SEC.13-T5N-R62W | | Slot: SLOT#08 STATE ANTELOPE 42-12-13HNB (2627'FNL & 510'FEL,SEC.13) | | | | Well: STATE ANTELOPE 42-12-13HNB | | | Threshold Value=1.00 † = interpolated/extrapolated station | | | |
| Ref MD [ft] | Ref TVD [ft] | Ref North [ft] | Ref East [ft] | Offset MD [ft] | Offset TVD [ft] | Offset North [ft] | Offset East [ft] | Angle from Highside [°] | C-C Clear Dist [ft] | ACR MASD [ft] | Sep Ratio | ACR Status |
| 3117.00† | 3024.45 | 626.56 | 301.06 | 3095.06 | 3065.17 | 196.30 | 308.92 | 153.07 | 432.25 | 32.33 | 13.65 | PASS |
| 3217.00† | 3120.57 | 651.43 | 313.01 | 3193.85 | 3162.73 | 205.76 | 321.28 | 153.05 | 447.74 | 33.43 | 13.66 | PASS |
| 3317.00† | 3216.69 | 676.31 | 324.96 | 3292.64 | 3260.29 | 215.22 | 333.65 | 153.03 | 463.22 | 34.56 | 13.66 | PASS |
| 3417.00† | 3312.80 | 701.18 | 336.91 | 3391.44 | 3357.85 | 224.68 | 346.01 | 153.02 | 478.71 | 35.70 | 13.66 | PASS |
| 3517.00† | 3408.92 | 726.05 | 348.86 | 3490.23 | 3455.41 | 234.14 | 358.37 | 153.01 | 494.19 | 36.86 | 13.65 | PASS |
| 3617.00† | 3505.04 | 750.92 | 360.81 | 3589.03 | 3552.97 | 243.60 | 370.73 | 152.99 | 509.68 | 38.04 | 13.63 | PASS |
| 3717.00† | 3601.16 | 775.79 | 372.76 | 3687.82 | 3650.53 | 253.06 | 383.09 | 152.98 | 525.17 | 39.22 | 13.62 | PASS |
| 3817.00† | 3697.27 | 800.66 | 384.71 | 3786.61 | 3748.09 | 262.51 | 395.45 | 152.97 | 540.65 | 40.42 | 13.60 | PASS |
| 3917.00† | 3793.39 | 825.54 | 396.66 | 3885.41 | 3845.65 | 271.97 | 407.82 | 152.96 | 556.14 | 41.63 | 13.57 | PASS |
| 4017.00† | 3889.51 | 850.41 | 408.61 | 3984.20 | 3943.21 | 281.43 | 420.18 | 152.95 | 571.62 | 42.85 | 13.55 | PASS |
| 4117.00† | 3985.63 | 875.28 | 420.57 | 4082.99 | 4040.77 | 290.89 | 432.54 | 152.94 | 587.11 | 44.07 | 13.52 | PASS |
| 4217.00† | 4081.74 | 900.15 | 432.52 | 4181.79 | 4138.33 | 300.35 | 444.90 | 152.93 | 602.59 | 45.31 | 13.50 | PASS |

C-C Clearance Distance Cutoff: 1000.00 ft



| REFERENCE WELLPATH IDENTIFICATION | | | |
|-----------------------------------|---------------------------|----------|--|
| Operator | BONANZA CREEK OIL COMPANY | Slot | SLOT#06 STATE ANTELOPE V41-B11-13HNB (2587'FNL & 510'FEL,SEC.13) |
| Area | COLORADO | Well | STATE ANTELOPE V41-B11-13HNB |
| Field | WELD COUNTY | Wellbore | STATE ANTELOPE V41-B11-13HNB PWB |
| Facility | SEC.13-T5N-R62W | | |

| CLEARANCE DATA - Offset Wellbore: STATE ANTELOPE 42-12-13HNB PWB Offset Wellpath: STATE ANTELOPE 42-12-13HNB PWP (REV-A.0) | | | | | | | | | | | | |
|---|-----------------|--|------------------|-------------------|--------------------|----------------------------------|---------------------|---|---------------------------|---------------------|--------------|---------------|
| Facility: SEC.13-T5N-R62W | | Slot: SLOT#08 STATE ANTELOPE 42-12-13HNB (2627'FNL & 510'FEL,SEC.13) | | | | Well: STATE ANTELOPE 42-12-13HNB | | Threshold Value=1.00 † = interpolated/extrapolated station | | | | |
| Ref MD [ft] | Ref TVD [ft] | Ref North [ft] | Ref East [ft] | Offset MD [ft] | Offset TVD [ft] | Offset North [ft] | Offset East [ft] | Angle from Highside [°] | C-C Clear Dist [ft] | ACR MASD [ft] | Sep Ratio | ACR Status |
| 4317.00† | 4177.86 | 925.02 | 444.47 | 4280.58 | 4235.89 | 309.81 | 457.26 | 152.92 | 618.08 | 46.55 | 13.47 | PASS |
| 4417.00† | 4273.98 | 949.89 | 456.42 | 4379.37 | 4333.45 | 319.27 | 469.62 | 152.91 | 633.56 | 47.80 | 13.44 | PASS |
| 4517.00† | 4370.10 | 974.77 | 468.37 | 4478.17 | 4431.01 | 328.72 | 481.99 | 152.90 | 649.05 | 49.06 | 13.41 | PASS |
| 4617.00† | 4466.21 | 999.64 | 480.32 | 4576.96 | 4528.57 | 338.18 | 494.35 | 152.90 | 664.53 | 50.32 | 13.38 | PASS |
| 4717.00† | 4562.33 | 1024.51 | 492.27 | 4675.76 | 4626.13 | 347.64 | 506.71 | 152.89 | 680.02 | 51.58 | 13.35 | PASS |
| 4817.00† | 4658.45 | 1049.38 | 504.22 | 4774.55 | 4723.69 | 357.10 | 519.07 | 152.88 | 695.51 | 52.86 | 13.32 | PASS |
| 4917.00† | 4754.57 | 1074.25 | 516.17 | 4873.34 | 4821.25 | 366.56 | 531.43 | 152.88 | 710.99 | 54.13 | 13.30 | PASS |
| 5017.00† | 4850.68 | 1099.12 | 528.12 | 4972.14 | 4918.81 | 376.02 | 543.79 | 152.87 | 726.48 | 55.41 | 13.27 | PASS |
| 5117.00† | 4946.80 | 1124.00 | 540.07 | 5070.93 | 5016.37 | 385.48 | 556.16 | 152.86 | 741.96 | 56.70 | 13.24 | PASS |
| 5217.00† | 5042.92 | 1148.87 | 552.02 | 5169.72 | 5113.93 | 394.94 | 568.52 | 152.86 | 757.45 | 57.99 | 13.21 | PASS |
| 5317.00† | 5139.04 | 1173.74 | 563.97 | 5268.52 | 5211.49 | 404.39 | 580.88 | 152.85 | 772.93 | 59.28 | 13.18 | PASS |
| 5417.00† | 5235.15 | 1198.61 | 575.92 | 5367.31 | 5309.04 | 413.85 | 593.24 | 152.85 | 788.42 | 60.58 | 13.16 | PASS |
| 5517.00† | 5331.27 | 1223.48 | 587.87 | 5466.11 | 5406.60 | 423.31 | 605.60 | 152.84 | 803.90 | 61.87 | 13.13 | PASS |
| 5617.00† | 5427.39 | 1248.35 | 599.83 | 5565.64 | 5505.48 | 432.81 | 609.63 | 153.43 | 819.33 | 62.77 | 13.19 | PASS |
| 5618.71 | 5429.04 | 1248.78 | 600.03 | 5567.31 | 5507.14 | 432.97 | 609.55 | 153.45 | 819.60 | 62.78 | 13.19 | PASS |
| 5717.00† | 5524.02 | 1273.36 | 603.37 | 5661.87 | 5600.36 | 441.76 | 597.15 | -167.78 | 835.12 | 63.28 | 13.33 | PASS |
| 5817.00† | 5619.77 | 1298.14 | 589.53 | 5755.68 | 5689.60 | 450.02 | 569.81 | -135.55 | 851.22 | 64.99 | 13.23 | PASS |
| 5917.00† | 5711.75 | 1321.94 | 558.73 | 5847.48 | 5771.52 | 457.44 | 529.26 | -117.59 | 867.06 | 63.37 | 13.83 | PASS |
| 6017.00† | 5797.14 | 1344.05 | 511.89 | 5937.66 | 5844.72 | 463.92 | 477.15 | -107.27 | 882.10 | 63.20 | 14.10 | PASS |
| 6117.00† | 5873.37 | 1363.78 | 450.45 | 6026.59 | 5908.07 | 469.34 | 415.10 | -100.70 | 895.80 | 63.44 | 14.27 | PASS |
| 6217.00† | 5938.11 | 1380.54 | 376.27 | 6114.58 | 5960.62 | 473.66 | 344.77 | -96.27 | 907.71 | 64.47 | 14.22 | PASS |
| 6317.00† | 5989.39 | 1393.82 | 291.61 | 6201.89 | 6001.58 | 476.79 | 267.82 | -93.25 | 917.42 | 66.56 | 13.92 | PASS |
| 6417.00† | 6025.67 | 1403.21 | 199.03 | 6288.76 | 6030.33 | 478.71 | 185.96 | -91.30 | 924.61 | 69.63 | 13.40 | PASS |
| 6517.00† | 6045.83 | 1408.44 | 101.35 | 6375.40 | 6046.41 | 479.38 | 100.91 | -90.24 | 929.06 | 73.32 | 12.78 | PASS |
| 6587.34 | 6050.00 | 1409.52 | 31.19 | 6436.30 | 6049.99 | 479.10 | 40.14 | -90.00 | 930.46 | 76.55 | 12.26 | PASS |
| 6617.00† | 6050.00 | 1409.53 | 1.53 | 6465.44 | 6050.00 | 478.81 | 11.00 | -90.00 | 930.77 | 78.04 | 12.03 | PASS |
| 6717.00† | 6050.00 | 1409.54 | -98.47 | 6565.44 | 6050.00 | 477.79 | -88.99 | -90.00 | 931.79 | 83.82 | 11.20 | PASS |
| 6817.00† | 6050.00 | 1409.55 | -198.47 | 6665.43 | 6050.00 | 476.77 | -188.98 | -90.00 | 932.82 | 85.74 | 10.96 | PASS |
| 6917.00† | 6050.00 | 1409.56 | -298.47 | 6765.43 | 6050.00 | 475.76 | -288.97 | -90.00 | 933.85 | 98.02 | 9.59 | PASS |
| 7017.00† | 6050.00 | 1409.57 | -398.47 | 6865.42 | 6050.00 | 474.74 | -388.96 | -90.00 | 934.88 | 106.09 | 8.86 | PASS |
| 7117.00† | 6050.00 | 1409.58 | -498.47 | 6965.42 | 6050.00 | 473.72 | -488.94 | -90.00 | 935.90 | 114.64 | 8.21 | PASS |
| 7217.00† | 6050.00 | 1409.58 | -598.47 | 7065.41 | 6050.00 | 472.70 | -588.93 | -90.00 | 936.93 | 123.57 | 7.62 | PASS |
| 7317.00† | 6050.00 | 1409.59 | -698.47 | 7165.41 | 6050.00 | 471.68 | -688.92 | -90.00 | 937.96 | 132.79 | 7.10 | PASS |

| CLEARANCE DATA - Offset Wellbore: STATE ANTELOPE 42-12-13HNB PWB Offset Wellpath: STATE ANTELOPE 42-12-13HNB PWP (REV-A.0) | | | | | | | | | | | | |
|---|-----------------|--|------------------|-------------------|--------------------|----------------------------------|---------------------|---|---------------------------|---------------------|--------------|---------------|
| Facility: SEC.13-T5N-R62W | | Slot: SLOT#08 STATE ANTELOPE 42-12-13HNB (2627'FNL & 510'FEL,SEC.13) | | | | Well: STATE ANTELOPE 42-12-13HNB | | Threshold Value=1.00 † = interpolated/extrapolated station | | | | |
| Ref MD [ft] | Ref TVD [ft] | Ref North [ft] | Ref East [ft] | Offset MD [ft] | Offset TVD [ft] | Offset North [ft] | Offset East [ft] | Angle from Highside [°] | C-C Clear Dist [ft] | ACR MASD [ft] | Sep Ratio | ACR Status |
| 7417.00† | 6050.00 | 1409.60 | -798.47 | 7265.40 | 6050.00 | 470.67 | -788.91 | -90.00 | 938.99 | 142.26 | 6.63 | PASS |
| 7517.00† | 6050.00 | 1409.61 | -898.47 | 7365.40 | 6050.00 | 469.65 | -888.90 | -90.00 | 940.01 | 151.92 | 6.21 | PASS |
| 7617.00† | 6050.00 | 1409.62 | -998.47 | 7465.39 | 6050.00 | 468.63 | -988.89 | -90.00 | 941.04 | 161.74 | 5.84 | PASS |
| 7717.00† | 6050.00 | 1409.63 | -1098.47 | 7565.39 | 6050.00 | 467.61 | -1088.88 | -90.00 | 942.07 | 171.69 | 5.51 | PASS |
| 7817.00† | 6050.00 | 1409.64 | -1198.47 | 7665.38 | 6050.00 | 466.60 | -1188.87 | -90.00 | 943.10 | 181.75 | 5.21 | PASS |
| 7917.00† | 6050.00 | 1409.65 | -1298.47 | 7765.37 | 6050.00 | 465.58 | -1288.86 | -90.00 | 944.12 | 191.91 | 4.93 | PASS |
| 8017.00† | 6050.00 | 1409.66 | -1398.47 | 7865.37 | 6050.00 | 464.56 | -1388.85 | -90.00 | 945.15 | 202.14 | 4.69 | PASS |
| 8117.00† | 6050.00 | 1409.67 | -1498.47 | 7965.36 | 6050.00 | 463.54 | -1488.84 | -90.00 | 946.18 | 212.45 | 4.47 | PASS |
| 8217.00† | 6050.00 | 1409.68 | -1598.47 | 8065.36 | 6050.00 | 462.52 | -1588.83 | -90.00 | 947.20 | 222.81 | 4.26 | PASS |
| 8317.00† | 6050.00 | 1409.69 | -1698.47 | 8165.35 | 6050.00 | 461.51 | -1688.82 | -90.00 | 948.23 | 233.22 | 4.08 | PASS |
| 8417.00† | 6050.00 | 1409.70 | -1798.47 | 8265.35 | 6050.00 | 460.49 | -1788.81 | -90.00 | 949.26 | 243.67 | 3.90 | PASS |
| 8517.00† | 6050.00 | 1409.71 | -1898.47 | 8365.34 | 6050.00 | 459.47 | -1888.80 | -90.00 | 950.29 | 254.17 | 3.75 | PASS |

C-C Clearance Distance Cutoff: 1000.00 ft

| POSITIONAL UNCERTAINTY - Offset Wellbore: STATE ANTELOPE 42-12-13HNB PWB Offset Wellpath: STATE ANTELOPE 42-12-13HNB PWP (REV-A.0) | | | | |
|---|------------|---------|----------|---------|
| Slot Surface Uncertainty @1SD | Horizontal | 0.100ft | Vertical | 1.000ft |
| Facility Surface Uncertainty @1SD | Horizontal | 8.200ft | Vertical | 3.000ft |

| HOLE & CASING SECTIONS - Offset Wellbore: STATE ANTELOPE 42-12-13HNB PWB Offset Wellpath: STATE ANTELOPE 42-12-13HNB PWP (REV-A.0) | | | | | | | | | |
|---|------------------|----------------|------------------|-------------------|-----------------|-------------------|-------------------|-----------------|-----------------|
| String/Diameter | Start MD [ft] | End MD [ft] | Interval [ft] | Start TVD [ft] | End TVD [ft] | Start N/S [ft] | Start E/W [ft] | End N/S [ft] | End E/W [ft] |
| 13.5in Open Hole | 17.00 | 1550.00 | 1533.00 | 17.00 | 1539.41 | -24.43 | 0.00 | 2.53 | 35.23 |
| 9.625in Casing Surface | 17.00 | 1550.00 | 1533.00 | 17.00 | 1539.41 | -24.43 | 0.00 | 2.53 | 35.23 |
| 8.5in Open Hole | 1550.00 | 11226.99 | 9676.99 | 1539.41 | N/A | 2.53 | 35.23 | N/A | N/A |



Clearance Report

STATE ANTELOPE V41-B11-13HNB PWP (REV-A.0)

Closest Approach

Page 10 of 18



| REFERENCE WELLPATH IDENTIFICATION | | | |
|-----------------------------------|---------------------------|----------|--|
| Operator | BONANZA CREEK OIL COMPANY | Slot | SLOT#06 STATE ANTELOPE V41-B11-13HNB (2587'FNL & 510'FEL,SEC.13) |
| Area | COLORADO | Well | STATE ANTELOPE V41-B11-13HNB |
| Field | WELD COUNTY | Wellbore | STATE ANTELOPE V41-B11-13HNB PWB |
| Facility | SEC.13-T5N-R62W | | |

| SURVEY PROGRAM - Offset Wellbore: STATE ANTELOPE 42-12-13HNB PWB Offset Wellpath: STATE ANTELOPE 42-12-13HNB PWP (REV-A.0) | | | | |
|---|----------------|------------------------------|------------------|--------------------------------|
| Start MD [ft] | End MD [ft] | Positional Uncertainty Model | Log Name/Comment | Wellbore |
| 17.00 | 1550.00 | BHI NaviTrak (Rotating) | | STATE ANTELOPE 42-12-13HNB PWB |
| 1550.00 | 11226.99 | BHI AutoTrak Curve (Short) | | STATE ANTELOPE 42-12-13HNB PWB |

| OFFSET WELLPATH REFERENCE - Offset Wellbore: STATE ANTELOPE 42-12-13HNB PWB Offset Wellpath: STATE ANTELOPE 42-12-13HNB PWP (REV-A.0) | |
|--|---|
| MD Reference: RIG (17') (RKB) | Offset TVD & local coordinates use Reference Wellpath settings (See WELLPATH DATUM on page 1 of this report) |
| Ellipse Start MD | 17.00ft |



REFERENCE WELLPATH IDENTIFICATION

| | | | |
|----------|---------------------------|----------|--|
| Operator | BONANZA CREEK OIL COMPANY | Slot | SLOT#06 STATE ANTELOPE V41-B11-13HNB (2587'FNL & 510'FEL,SEC.13) |
| Area | COLORADO | Well | STATE ANTELOPE V41-B11-13HNB |
| Field | WELD COUNTY | Wellbore | STATE ANTELOPE V41-B11-13HNB PWB |
| Facility | SEC.13-T5N-R62W | | |

CLEARANCE DATA - Offset Wellbore: **STATE ANTELOPE W42-C12-13HNB PWB** Offset Wellpath: **STATE ANTELOPE W42-C12-13HNB PWP (REV-A.0)**

| | | | | |
|---------------------------|--|------------------------------------|----------------------|---------------------------------------|
| Facility: SEC.13-T5N-R62W | Slot: SLOT#09 STATE ANTELOPE W42-C12-13HNB (2647'FNL & 510'FEL,SEC.13) | Well: STATE ANTELOPE W42-C12-13HNB | Threshold Value=1.00 | † = interpolated/extrapolated station |
|---------------------------|--|------------------------------------|----------------------|---------------------------------------|

| Ref MD [ft] | Ref TVD [ft] | Ref North [ft] | Ref East [ft] | Offset MD [ft] | Offset TVD [ft] | Offset North [ft] | Offset East [ft] | Angle from Highside [°] | C-C Clear Dist [ft] | ACR MASD [ft] | Sep Ratio | ACR Status |
|----------------|-----------------|-------------------|------------------|-------------------|--------------------|----------------------|---------------------|----------------------------|---------------------------|---------------------|--------------|---------------|
| 17.00 | 17.00 | 0.00 | 0.00 | 17.00 | 17.00 | -60.11 | 0.28 | 179.74 | 60.11 | 1.56 | 98.58 | PASS |
| 117.00† | 117.00 | 0.00 | 0.00 | 117.00 | 117.00 | -60.11 | 0.28 | 179.74 | 60.11 | 2.18 | 48.51 | PASS |
| 200.00 | 200.00 | 0.00 | 0.00 | 200.00 | 200.00 | -60.11 | 0.28 | 179.74 | 60.11 | 2.99 | 29.14 | PASS |
| 217.00† | 217.00 | 0.05 | 0.02 | 217.00 | 217.00 | -60.11 | 0.28 | 154.09 | 60.16 | 3.16 | 26.93 | PASS |
| 317.00† | 316.97 | 2.15 | 1.03 | 316.97 | 316.97 | -60.11 | 0.28 | 155.01 | 62.27 | 4.38 | 17.96 | PASS |
| 417.00† | 416.79 | 7.40 | 3.56 | 416.79 | 416.79 | -60.11 | 0.28 | 157.06 | 67.60 | 5.89 | 13.52 | PASS |
| 517.00† | 516.35 | 15.79 | 7.59 | 516.45 | 516.45 | -60.11 | 0.33 | 159.69 | 76.24 | 7.24 | 11.99 | PASS |
| 617.00† | 615.53 | 27.31 | 13.12 | 616.41 | 616.38 | -59.82 | 2.63 | 161.04 | 87.77 | 8.52 | 11.48 | PASS |
| 717.00† | 714.20 | 41.93 | 20.15 | 716.21 | 716.01 | -59.12 | 8.37 | 160.75 | 101.76 | 9.76 | 11.46 | PASS |
| 817.00† | 812.24 | 59.66 | 28.66 | 815.68 | 815.04 | -58.01 | 17.53 | 159.41 | 118.22 | 10.97 | 11.72 | PASS |
| 917.00† | 909.54 | 80.45 | 38.66 | 914.25 | 912.86 | -56.53 | 29.62 | 157.61 | 137.32 | 12.19 | 12.15 | PASS |
| 1000.90 | 990.50 | 100.25 | 48.17 | 996.07 | 993.99 | -55.25 | 40.07 | 156.65 | 155.76 | 13.18 | 12.67 | PASS |
| 1017.00† | 1005.98 | 104.26 | 50.09 | 1011.73 | 1009.52 | -55.01 | 42.07 | 156.54 | 159.51 | 13.37 | 12.78 | PASS |
| 1117.00† | 1102.10 | 129.13 | 62.05 | 1108.96 | 1105.95 | -53.49 | 54.49 | 156.01 | 182.82 | 14.45 | 13.48 | PASS |
| 1217.00† | 1198.22 | 154.00 | 74.00 | 1206.19 | 1202.37 | -51.98 | 66.91 | 155.60 | 206.14 | 15.57 | 14.04 | PASS |
| 1317.00† | 1294.34 | 178.87 | 85.95 | 1303.43 | 1298.79 | -50.46 | 79.33 | 155.27 | 229.47 | 16.73 | 14.49 | PASS |
| 1417.00† | 1390.45 | 203.74 | 97.90 | 1400.66 | 1395.22 | -48.94 | 91.75 | 155.00 | 252.81 | 17.91 | 14.86 | PASS |
| 1517.00† | 1486.57 | 228.62 | 109.85 | 1497.89 | 1491.64 | -47.43 | 104.18 | 154.77 | 276.15 | 19.12 | 15.16 | PASS |
| 1617.00† | 1582.69 | 253.49 | 121.80 | 1595.12 | 1588.07 | -45.91 | 116.60 | 154.59 | 299.49 | 19.68 | 15.75 | PASS |
| 1717.00† | 1678.81 | 278.36 | 133.75 | 1692.36 | 1684.49 | -44.40 | 129.02 | 154.42 | 322.84 | 20.11 | 16.61 | PASS |
| 1817.00† | 1774.92 | 303.23 | 145.70 | 1789.59 | 1780.91 | -42.88 | 141.44 | 154.29 | 346.19 | 20.56 | 17.40 | PASS |
| 1917.00† | 1871.04 | 328.10 | 157.65 | 1886.82 | 1877.34 | -41.36 | 153.86 | 154.16 | 369.54 | 21.09 | 18.09 | PASS |
| 2017.00† | 1967.16 | 352.97 | 169.60 | 1984.06 | 1973.76 | -39.85 | 166.28 | 154.06 | 392.89 | 21.70 | 18.69 | PASS |
| 2117.00† | 2063.28 | 377.85 | 181.55 | 2081.29 | 2070.19 | -38.33 | 178.71 | 153.96 | 416.24 | 22.37 | 19.18 | PASS |
| 2217.00† | 2159.39 | 402.72 | 193.50 | 2178.52 | 2166.61 | -36.81 | 191.13 | 153.88 | 439.60 | 23.10 | 19.60 | PASS |
| 2317.00† | 2255.51 | 427.59 | 205.45 | 2275.75 | 2263.04 | -35.30 | 203.55 | 153.80 | 462.95 | 23.89 | 19.94 | PASS |
| 2417.00† | 2351.63 | 452.46 | 217.40 | 2372.99 | 2359.46 | -33.78 | 215.97 | 153.73 | 486.31 | 24.72 | 20.22 | PASS |
| 2517.00† | 2447.75 | 477.33 | 229.35 | 2470.22 | 2455.88 | -32.27 | 228.39 | 153.67 | 509.66 | 25.61 | 20.44 | PASS |
| 2617.00† | 2543.86 | 502.20 | 241.31 | 2567.45 | 2552.31 | -30.75 | 240.81 | 153.61 | 533.02 | 26.53 | 20.62 | PASS |
| 2717.00† | 2639.98 | 527.08 | 253.26 | 2664.68 | 2648.73 | -29.23 | 253.23 | 153.56 | 556.38 | 27.48 | 20.75 | PASS |
| 2817.00† | 2736.10 | 551.95 | 265.21 | 2761.92 | 2745.16 | -27.72 | 265.66 | 153.51 | 579.74 | 28.47 | 20.86 | PASS |
| 2917.00† | 2832.22 | 576.82 | 277.16 | 2859.15 | 2841.58 | -26.20 | 278.08 | 153.46 | 603.09 | 29.49 | 20.93 | PASS |
| 3017.00† | 2928.33 | 601.69 | 289.11 | 2956.38 | 2938.00 | -24.68 | 290.50 | 153.42 | 626.45 | 30.53 | 20.98 | PASS |

| CLEARANCE DATA - Offset Wellbore: STATE ANTELOPE W42-C12-13HNB PWB Offset Wellpath: STATE ANTELOPE W42-C12-13HNB PWP (REV-A.0) | | | | | | | | | | | | |
|---|-----------------|--|------------------|-------------------|--------------------|------------------------------------|---------------------|----------------------------|---------------------------|---------------------|---------------------------------------|---------------|
| Facility: SEC.13-T5N-R62W | | Slot: SLOT#09 STATE ANTELOPE W42-C12-13HNB (2647'FNL & 510'FEL,SEC.13) | | | | Well: STATE ANTELOPE W42-C12-13HNB | | | Threshold Value=1.00 | | † = interpolated/extrapolated station | |
| Ref MD [ft] | Ref TVD [ft] | Ref North [ft] | Ref East [ft] | Offset MD [ft] | Offset TVD [ft] | Offset North [ft] | Offset East [ft] | Angle from Highside [°] | C-C Clear Dist [ft] | ACR MASD [ft] | Sep Ratio | ACR Status |
| 3117.00† | 3024.45 | 626.56 | 301.06 | 3053.62 | 3034.43 | -23.17 | 302.92 | 153.38 | 649.81 | 31.60 | 21.01 | PASS |
| 3217.00† | 3120.57 | 651.43 | 313.01 | 3150.85 | 3130.85 | -21.65 | 315.34 | 153.35 | 673.17 | 32.69 | 21.03 | PASS |
| 3317.00† | 3216.69 | 676.31 | 324.96 | 3248.08 | 3227.28 | -20.14 | 327.76 | 153.32 | 696.53 | 33.79 | 21.03 | PASS |
| 3417.00† | 3312.80 | 701.18 | 336.91 | 3345.31 | 3323.70 | -18.62 | 340.18 | 153.28 | 719.89 | 34.92 | 21.02 | PASS |
| 3517.00† | 3408.92 | 726.05 | 348.86 | 3442.55 | 3420.13 | -17.10 | 352.61 | 153.25 | 743.25 | 36.06 | 21.01 | PASS |
| 3617.00† | 3505.04 | 750.92 | 360.81 | 3539.78 | 3516.55 | -15.59 | 365.03 | 153.23 | 766.61 | 37.21 | 20.98 | PASS |
| 3717.00† | 3601.16 | 775.79 | 372.76 | 3637.01 | 3612.97 | -14.07 | 377.45 | 153.20 | 789.96 | 38.38 | 20.95 | PASS |
| 3817.00† | 3697.27 | 800.66 | 384.71 | 3734.25 | 3709.40 | -12.55 | 389.87 | 153.18 | 813.32 | 39.55 | 20.92 | PASS |
| 3917.00† | 3793.39 | 825.54 | 396.66 | 3831.48 | 3805.82 | -11.04 | 402.29 | 153.15 | 836.68 | 40.74 | 20.88 | PASS |
| 4017.00† | 3889.51 | 850.41 | 408.61 | 3928.71 | 3902.25 | -9.52 | 414.71 | 153.13 | 860.04 | 41.94 | 20.84 | PASS |
| 4117.00† | 3985.63 | 875.28 | 420.57 | 4025.94 | 3998.67 | -8.01 | 427.14 | 153.11 | 883.40 | 43.14 | 20.80 | PASS |
| 4217.00† | 4081.74 | 900.15 | 432.52 | 4123.18 | 4095.09 | -6.49 | 439.56 | 153.09 | 906.77 | 44.36 | 20.76 | PASS |

C-C Clearance Distance Cutoff: 1000.00 ft



Clearance Report

STATE ANTELOPE V41-B11-13HNB PWP (REV-A.0)

Closest Approach

Page 12 of 18



| REFERENCE WELLPATH IDENTIFICATION | | | |
|-----------------------------------|---------------------------|----------|--|
| Operator | BONANZA CREEK OIL COMPANY | Slot | SLOT#06 STATE ANTELOPE V41-B11-13HNB (2587'FNL & 510'FEL,SEC.13) |
| Area | COLORADO | Well | STATE ANTELOPE V41-B11-13HNB |
| Field | WELD COUNTY | Wellbore | STATE ANTELOPE V41-B11-13HNB PWB |
| Facility | SEC.13-T5N-R62W | | |

| CLEARANCE DATA - Offset Wellbore: STATE ANTELOPE W42-C12-13HNB PWB Offset Wellpath: STATE ANTELOPE W42-C12-13HNB PWP (REV-A.0) | | | | | | | | | | | | |
|---|--------------|--|---------------|----------------|------------------------------------|-------------------|------------------|---|---------------------|---------------|-----------|------------|
| Facility: SEC.13-T5N-R62W | | Slot: SLOT#09 STATE ANTELOPE W42-C12-13HNB (2647'FNL & 510'FEL,SEC.13) | | | Well: STATE ANTELOPE W42-C12-13HNB | | | Threshold Value=1.00 † = interpolated/extrapolated station | | | | |
| Ref MD [ft] | Ref TVD [ft] | Ref North [ft] | Ref East [ft] | Offset MD [ft] | Offset TVD [ft] | Offset North [ft] | Offset East [ft] | Angle from Highside [°] | C-C Clear Dist [ft] | ACR MASD [ft] | Sep Ratio | ACR Status |
| 4317.00† | 4177.86 | 925.02 | 444.47 | 4220.41 | 4191.52 | -4.97 | 451.98 | 153.07 | 930.13 | 45.58 | 20.71 | PASS |
| 4417.00† | 4273.98 | 949.89 | 456.42 | 4317.64 | 4287.94 | -3.46 | 464.40 | 153.06 | 953.49 | 46.81 | 20.67 | PASS |
| 4517.00† | 4370.10 | 974.77 | 468.37 | 4414.87 | 4384.37 | -1.94 | 476.82 | 153.04 | 976.85 | 48.04 | 20.62 | PASS |

C-C Clearance Distance Cutoff: 1000.00 ft

| POSITIONAL UNCERTAINTY - Offset Wellbore: STATE ANTELOPE W42-C12-13HNB PWB Offset Wellpath: STATE ANTELOPE W42-C12-13HNB PWP (REV-A.0) | | | |
|---|--|------------|---------|
| Slot Surface Uncertainty @1SD | | Horizontal | 0.100ft |
| Facility Surface Uncertainty @1SD | | Horizontal | 8.200ft |
| | | Vertical | 1.000ft |
| | | Vertical | 3.000ft |

| HOLE & CASING SECTIONS - Offset Wellbore: STATE ANTELOPE W42-C12-13HNB PWB Offset Wellpath: STATE ANTELOPE W42-C12-13HNB PWP (REV-A.0) | | | | | | | | | |
|---|---------------|-------------|---------------|----------------|--------------|----------------|----------------|--------------|--------------|
| String/Diameter | Start MD [ft] | End MD [ft] | Interval [ft] | Start TVD [ft] | End TVD [ft] | Start N/S [ft] | Start E/W [ft] | End N/S [ft] | End E/W [ft] |
| 13.5in Open Hole | 17.00 | 1550.00 | 1533.00 | 17.00 | 1543.32 | -36.64 | 0.17 | -32.53 | 33.87 |
| 9.625in Casing Surface | 17.00 | 1550.00 | 1533.00 | 17.00 | 1543.32 | -36.64 | 0.17 | -32.53 | 33.87 |
| 8.5in Open Hole | 1550.00 | 11208.26 | 9658.26 | 1543.32 | 6050.00 | -32.53 | 33.87 | -36.50 | -1448.17 |

| SURVEY PROGRAM - Offset Wellbore: STATE ANTELOPE W42-C12-13HNB PWB Offset Wellpath: STATE ANTELOPE W42-C12-13HNB PWP (REV-A.0) | | | | |
|---|-------------|------------------------------|------------------|----------------------------------|
| Start MD [ft] | End MD [ft] | Positional Uncertainty Model | Log Name/Comment | Wellbore |
| 17.00 | 1550.00 | BHI NaviTrak (Rotating) | | STATE ANTELOPE W42-C12-13HNB PWB |
| 1550.00 | 11208.26 | BHI AutoTrak Curve (Short) | | STATE ANTELOPE W42-C12-13HNB PWB |

| OFFSET WELLPATH REFERENCE - Offset Wellbore: STATE ANTELOPE W42-C12-13HNB PWB Offset Wellpath: STATE ANTELOPE W42-C12-13HNB PWP (REV-A.0) | |
|--|---|
| MD Reference: RIG (17") (RKB) | Offset TVD & local coordinates use Reference Wellpath settings (See WELLPATH DATUM on page 1 of this report) |
| Ellipse Start MD | 17.00ft |



Clearance Report
STATE ANTELOPE V41-B11-13HNB PWP (REV-A.0)
Closest Approach
Page 13 of 18



| REFERENCE WELLPATH IDENTIFICATION | | | |
|-----------------------------------|---------------------------|----------|--|
| Operator | BONANZA CREEK OIL COMPANY | Slot | SLOT#06 STATE ANTELOPE V41-B11-13HNB (2587'FNL & 510'FEL,SEC.13) |
| Area | COLORADO | Well | STATE ANTELOPE V41-B11-13HNB |
| Field | WELD COUNTY | Wellbore | STATE ANTELOPE V41-B11-13HNB PWB |
| Facility | SEC.13-T5N-R62W | | |

| CLEARANCE DATA - Offset Wellbore: STATE ANTELOPE X44-D14-13HNB PWB Offset Wellpath: STATE ANTELOPE X44-D14-13HNB PWP (REV-A.0) | | | | | | | | | | | | |
|--|--------------|--|---------------|----------------|------------------------------------|-------------------|------------------|--|---------------------|---------------|-----------|------------|
| Facility: SEC.13-T5N-R62W | | Slot: SLOT#10 STATE ANTELOPE X44-D14-13HNB (2667'FNL & 510'FEL,SEC.13) | | | Well: STATE ANTELOPE X44-D14-13HNB | | | Threshold Value=1.00 † = interpolated/extrapolated station | | | | |
| Ref MD [ft] | Ref TVD [ft] | Ref North [ft] | Ref East [ft] | Offset MD [ft] | Offset TVD [ft] | Offset North [ft] | Offset East [ft] | Angle from Highside [°] | C-C Clear Dist [ft] | ACR MASD [ft] | Sep Ratio | ACR Status |
| 17.00 | 17.00 | 0.00 | 0.00 | 17.00 | 17.00 | -80.15 | 0.28 | 179.80 | 80.15 | 1.56 | 131.98 | PASS |
| 117.00† | 117.00 | 0.00 | 0.00 | 117.00 | 117.00 | -80.15 | 0.28 | 179.80 | 80.15 | 2.18 | 64.95 | PASS |
| 200.00 | 200.00 | 0.00 | 0.00 | 200.00 | 200.00 | -80.15 | 0.28 | 179.80 | 80.15 | 2.99 | 39.01 | PASS |
| 217.00† | 217.00 | 0.05 | 0.02 | 217.00 | 217.00 | -80.15 | 0.28 | 154.15 | 80.19 | 3.16 | 36.04 | PASS |
| 317.00† | 316.97 | 2.15 | 1.03 | 316.53 | 316.53 | -80.19 | 0.30 | 154.83 | 82.35 | 4.37 | 23.86 | PASS |
| 417.00† | 416.79 | 7.40 | 3.56 | 413.54 | 413.51 | -82.25 | 1.08 | 155.79 | 89.75 | 6.02 | 17.55 | PASS |
| 517.00† | 516.35 | 15.79 | 7.59 | 509.60 | 509.42 | -87.31 | 3.02 | 156.58 | 103.43 | 7.72 | 15.16 | PASS |
| 617.00† | 615.53 | 27.31 | 13.12 | 604.17 | 603.60 | -95.22 | 6.05 | 157.11 | 123.30 | 9.20 | 14.85 | PASS |
| 717.00† | 714.20 | 41.93 | 20.15 | 696.74 | 695.47 | -105.76 | 10.08 | 157.40 | 149.22 | 10.61 | 15.37 | PASS |
| 817.00† | 812.24 | 59.66 | 28.66 | 786.84 | 784.50 | -118.69 | 15.03 | 157.51 | 181.00 | 11.82 | 16.58 | PASS |
| 917.00† | 909.54 | 80.45 | 38.66 | 874.05 | 870.22 | -133.68 | 20.77 | 157.48 | 218.45 | 12.98 | 18.10 | PASS |
| 1000.90 | 990.50 | 100.25 | 48.17 | 944.74 | 939.31 | -147.62 | 26.11 | 157.37 | 254.06 | 13.95 | 19.49 | PASS |
| 1017.00† | 1005.98 | 104.26 | 50.09 | 958.05 | 952.28 | -150.42 | 27.18 | 157.40 | 261.29 | 14.12 | 19.79 | PASS |
| 1117.00† | 1102.10 | 129.13 | 62.05 | 1039.46 | 1031.27 | -168.78 | 34.21 | 157.44 | 307.48 | 15.06 | 21.74 | PASS |
| 1217.00† | 1198.22 | 154.00 | 74.00 | 1118.67 | 1107.58 | -188.65 | 41.81 | 157.29 | 355.90 | 16.00 | 23.60 | PASS |
| 1317.00† | 1294.34 | 178.87 | 85.95 | 1195.67 | 1181.15 | -209.85 | 49.93 | 157.03 | 406.46 | 16.94 | 25.38 | PASS |
| 1417.00† | 1390.45 | 203.74 | 97.90 | 1270.43 | 1251.98 | -232.19 | 58.48 | 156.70 | 459.09 | 17.75 | 27.29 | PASS |
| 1517.00† | 1486.57 | 228.62 | 109.85 | 1346.83 | 1323.74 | -256.68 | 67.85 | 156.32 | 513.60 | 18.79 | 28.76 | PASS |
| 1617.00† | 1582.69 | 253.49 | 121.80 | 1430.33 | 1402.00 | -283.84 | 78.25 | 155.96 | 568.56 | 19.43 | 30.40 | PASS |
| 1717.00† | 1678.81 | 278.36 | 133.75 | 1513.82 | 1480.27 | -311.00 | 88.65 | 155.67 | 623.53 | 20.09 | 32.21 | PASS |
| 1817.00† | 1774.92 | 303.23 | 145.70 | 1597.32 | 1558.54 | -338.16 | 99.05 | 155.42 | 678.51 | 20.56 | 34.15 | PASS |
| 1917.00† | 1871.04 | 328.10 | 157.65 | 1680.81 | 1636.80 | -365.32 | 109.44 | 155.21 | 733.50 | 20.98 | 36.15 | PASS |
| 2017.00† | 1967.16 | 352.97 | 169.60 | 1764.31 | 1715.07 | -392.48 | 119.84 | 155.03 | 788.50 | 21.42 | 38.04 | PASS |
| 2117.00† | 2063.28 | 377.85 | 181.55 | 1847.81 | 1793.34 | -419.64 | 130.24 | 154.87 | 843.50 | 21.92 | 39.73 | PASS |
| 2217.00† | 2159.39 | 402.72 | 193.50 | 1931.30 | 1871.60 | -446.80 | 140.64 | 154.73 | 898.50 | 22.48 | 41.24 | PASS |
| 2317.00† | 2255.51 | 427.59 | 205.45 | 2014.80 | 1949.87 | -473.97 | 151.03 | 154.61 | 953.51 | 23.09 | 42.58 | PASS |

C-C Clearance Distance Cutoff: 1000.00 ft

| POSITIONAL UNCERTAINTY - Offset Wellbore: STATE ANTELOPE X44-D14-13HNB PWB Offset Wellpath: STATE ANTELOPE X44-D14-13HNB PWP (REV-A.0) | | | |
|--|--|------------|---------|
| Slot Surface Uncertainty @1SD | | Horizontal | 0.100ft |
| Facility Surface Uncertainty @1SD | | Horizontal | 8.200ft |
| | | Vertical | 1.000ft |
| | | Vertical | 3.000ft |

| HOLE & CASING SECTIONS - Offset Wellbore: STATE ANTELOPE X44-D14-13HNB PWB Offset Wellpath: STATE ANTELOPE X44-D14-13HNB PWP (REV-A.0) | | | | | | | | | |
|---|------------------|----------------|------------------|-------------------|-----------------|-------------------|-------------------|-----------------|-----------------|
| String/Diameter | Start MD [ft] | End MD [ft] | Interval [ft] | Start TVD [ft] | End TVD [ft] | Start N/S [ft] | Start E/W [ft] | End N/S [ft] | End E/W [ft] |
| 13.5in Open Hole | 17.00 | 1550.00 | 1533.00 | 17.00 | 1514.18 | -48.86 | 0.17 | -122.81 | 28.48 |
| 9.625in Casing Surface | 17.00 | 1550.00 | 1533.00 | 17.00 | 1514.18 | -48.86 | 0.17 | -122.81 | 28.48 |
| 8.5in Open Hole | 1550.00 | 11521.25 | 9971.25 | 1514.18 | N/A | -122.81 | 28.48 | N/A | N/A |



Clearance Report

STATE ANTELOPE V41-B11-13HNB PWP (REV-A.0)

Closest Approach

Page 14 of 18



| REFERENCE WELLPATH IDENTIFICATION | | | |
|-----------------------------------|---------------------------|----------|--|
| Operator | BONANZA CREEK OIL COMPANY | Slot | SLOT#06 STATE ANTELOPE V41-B11-13HNB (2587'FNL & 510'FEL,SEC.13) |
| Area | COLORADO | Well | STATE ANTELOPE V41-B11-13HNB |
| Field | WELD COUNTY | Wellbore | STATE ANTELOPE V41-B11-13HNB PWB |
| Facility | SEC.13-T5N-R62W | | |

| SURVEY PROGRAM - Offset Wellbore: STATE ANTELOPE X44-D14-13HNB PWB Offset Wellpath: STATE ANTELOPE X44-D14-13HNB PWP (REV-A.0) | | | | |
|---|----------------|------------------------------|------------------|----------------------------------|
| Start MD [ft] | End MD [ft] | Positional Uncertainty Model | Log Name/Comment | Wellbore |
| 17.00 | 1550.00 | BHI NaviTrak (Rotating) | | STATE ANTELOPE X44-D14-13HNB PWB |
| 1550.00 | 11521.25 | BHI AutoTrak Curve (Short) | | STATE ANTELOPE X44-D14-13HNB PWB |

| OFFSET WELLPATH REFERENCE - Offset Wellbore: STATE ANTELOPE X44-D14-13HNB PWB Offset Wellpath: STATE ANTELOPE X44-D14-13HNB PWP (REV-A.0) | |
|---|---|
| MD Reference: RIG (17') (RKB) | Offset TVD & local coordinates use Reference Wellpath settings (See WELLPATH DATUM on page 1 of this report) |
| Ellipse Start MD | 17.00ft |



Clearance Report
STATE ANTELOPE V41-B11-13HNB PWP (REV-A.0)
Closest Approach
Page 15 of 18



| REFERENCE WELLPATH IDENTIFICATION | | | |
|-----------------------------------|---------------------------|----------|--|
| Operator | BONANZA CREEK OIL COMPANY | Slot | SLOT#06 STATE ANTELOPE V41-B11-13HNB (2587'FNL & 510'FEL,SEC.13) |
| Area | COLORADO | Well | STATE ANTELOPE V41-B11-13HNB |
| Field | WELD COUNTY | Wellbore | STATE ANTELOPE V41-B11-13HNB PWB |
| Facility | SEC.13-T5N-R62W | | |

| CLEARANCE DATA - Offset Wellbore: STATE ANTELOPE Y44-E14-13HNB PWB Offset Wellpath: STATE ANTELOPE Y44-E14-13HNB PWP (REV-A.0) | | | | | | | | | | | | |
|--|--------------|--|---------------|----------------|------------------------------------|-------------------|------------------|--|---------------------|---------------|-----------|------------|
| Facility: SEC.13-T5N-R62W | | Slot: SLOT#11 STATE ANTELOPE Y44-E14-13HNB (2687'FNL & 510'FEL,SEC.13) | | | Well: STATE ANTELOPE Y44-E14-13HNB | | | Threshold Value=1.00 † = interpolated/extrapolated station | | | | |
| Ref MD [ft] | Ref TVD [ft] | Ref North [ft] | Ref East [ft] | Offset MD [ft] | Offset TVD [ft] | Offset North [ft] | Offset East [ft] | Angle from Highside [°] | C-C Clear Dist [ft] | ACR MASD [ft] | Sep Ratio | ACR Status |
| 17.00 | 17.00 | 0.00 | 0.00 | 17.00 | 17.00 | -100.19 | 0.56 | 179.68 | 100.19 | 1.56 | 165.37 | PASS |
| 117.00† | 117.00 | 0.00 | 0.00 | 117.00 | 117.00 | -100.19 | 0.56 | 179.68 | 100.19 | 2.18 | 81.38 | PASS |
| 200.00 | 200.00 | 0.00 | 0.00 | 200.00 | 200.00 | -100.19 | 0.56 | 179.68 | 100.19 | 2.99 | 48.89 | PASS |
| 217.00† | 217.00 | 0.05 | 0.02 | 217.00 | 217.00 | -100.19 | 0.56 | 154.03 | 100.23 | 3.16 | 45.15 | PASS |
| 317.00† | 316.97 | 2.15 | 1.03 | 314.75 | 314.74 | -100.88 | 0.77 | 154.44 | 103.06 | 4.41 | 29.62 | PASS |
| 417.00† | 416.79 | 7.40 | 3.56 | 410.89 | 410.81 | -104.50 | 1.89 | 155.03 | 112.08 | 6.18 | 21.29 | PASS |
| 517.00† | 516.35 | 15.79 | 7.59 | 505.93 | 505.59 | -111.10 | 3.93 | 155.63 | 127.40 | 7.85 | 18.37 | PASS |
| 617.00† | 615.53 | 27.31 | 13.12 | 599.32 | 598.45 | -120.51 | 6.85 | 156.15 | 148.93 | 9.31 | 17.73 | PASS |
| 717.00† | 714.20 | 41.93 | 20.15 | 690.55 | 688.81 | -132.48 | 10.55 | 156.55 | 176.51 | 10.69 | 18.04 | PASS |
| 817.00† | 812.24 | 59.66 | 28.66 | 779.16 | 776.16 | -146.74 | 14.97 | 156.81 | 209.97 | 11.90 | 19.11 | PASS |
| 917.00† | 909.54 | 80.45 | 38.66 | 864.77 | 860.06 | -162.96 | 19.99 | 156.94 | 249.09 | 13.03 | 20.56 | PASS |
| 1000.90 | 990.50 | 100.25 | 48.17 | 934.02 | 927.54 | -177.83 | 24.59 | 156.97 | 286.09 | 14.00 | 21.88 | PASS |
| 1017.00† | 1005.98 | 104.26 | 50.09 | 947.05 | 940.19 | -180.80 | 25.51 | 157.04 | 293.58 | 14.16 | 22.17 | PASS |
| 1117.00† | 1102.10 | 129.13 | 62.05 | 1026.66 | 1017.18 | -200.14 | 31.49 | 157.26 | 341.42 | 15.09 | 24.10 | PASS |
| 1217.00† | 1198.22 | 154.00 | 74.00 | 1104.04 | 1091.45 | -220.90 | 37.92 | 157.30 | 391.47 | 16.01 | 25.96 | PASS |
| 1317.00† | 1294.34 | 178.87 | 85.95 | 1179.18 | 1162.97 | -242.88 | 44.72 | 157.21 | 443.65 | 16.91 | 27.76 | PASS |
| 1417.00† | 1390.45 | 203.74 | 97.90 | 1252.07 | 1231.76 | -265.91 | 51.85 | 157.05 | 497.87 | 17.78 | 29.55 | PASS |
| 1517.00† | 1486.57 | 228.62 | 109.85 | 1322.71 | 1297.82 | -289.81 | 59.25 | 156.83 | 554.03 | 18.69 | 31.19 | PASS |
| 1617.00† | 1582.69 | 253.49 | 121.80 | 1391.14 | 1361.20 | -314.45 | 66.87 | 156.59 | 612.06 | 19.21 | 33.12 | PASS |
| 1717.00† | 1678.81 | 278.36 | 133.75 | 1457.38 | 1421.95 | -339.66 | 74.68 | 156.33 | 671.87 | 19.71 | 35.41 | PASS |
| 1817.00† | 1774.92 | 303.23 | 145.70 | 1534.22 | 1491.95 | -369.92 | 84.04 | 156.03 | 732.81 | 20.31 | 37.43 | PASS |
| 1917.00† | 1871.04 | 328.10 | 157.65 | 1613.43 | 1564.11 | -401.14 | 93.71 | 155.77 | 793.78 | 20.78 | 39.51 | PASS |
| 2017.00† | 1967.16 | 352.97 | 169.60 | 1692.64 | 1636.27 | -432.36 | 103.37 | 155.55 | 854.77 | 21.18 | 41.72 | PASS |
| 2117.00† | 2063.28 | 377.85 | 181.55 | 1771.85 | 1708.43 | -463.58 | 113.03 | 155.35 | 915.75 | 21.63 | 43.74 | PASS |
| 2217.00† | 2159.39 | 402.72 | 193.50 | 1851.07 | 1780.59 | -494.80 | 122.69 | 155.18 | 976.75 | 22.13 | 45.56 | PASS |

C-C Clearance Distance Cutoff: 1000.00 ft

| POSITIONAL UNCERTAINTY - Offset Wellbore: STATE ANTELOPE Y44-E14-13HNB PWB Offset Wellpath: STATE ANTELOPE Y44-E14-13HNB PWP (REV-A.0) | | | |
|--|------------|---------|----------|
| Slot Surface Uncertainty @1SD | Horizontal | 0.100ft | Vertical |
| Facility Surface Uncertainty @1SD | Horizontal | 8.200ft | Vertical |
| | | | 3.000ft |

| HOLE & CASING SECTIONS - Offset Wellbore: STATE ANTELOPE Y44-E14-13HNB PWB Offset Wellpath: STATE ANTELOPE Y44-E14-13HNB PWP (REV-A.0) | | | | | | | | | |
|---|------------------|----------------|------------------|-------------------|-----------------|-------------------|-------------------|-----------------|-----------------|
| String/Diameter | Start MD [ft] | End MD [ft] | Interval [ft] | Start TVD [ft] | End TVD [ft] | Start N/S [ft] | Start E/W [ft] | End N/S [ft] | End E/W [ft] |
| 13.5in Open Hole | 17.00 | 1550.00 | 1533.00 | 17.00 | 1506.33 | -61.07 | 0.34 | -145.19 | 26.37 |
| 9.625in Casing Surface | 17.00 | 1550.00 | 1533.00 | 17.00 | 1506.33 | -61.07 | 0.34 | -145.19 | 26.37 |
| 8.5in Open Hole | 1550.00 | 11675.40 | 10125.40 | 1506.33 | N/A | -145.19 | 26.37 | N/A | N/A |



Clearance Report

STATE ANTELOPE V41-B11-13HNB PWP (REV-A.0)

Closest Approach

Page 16 of 18



| REFERENCE WELLPATH IDENTIFICATION | | | |
|-----------------------------------|---------------------------|----------|--|
| Operator | BONANZA CREEK OIL COMPANY | Slot | SLOT#06 STATE ANTELOPE V41-B11-13HNB (2587'FNL & 510'FEL,SEC.13) |
| Area | COLORADO | Well | STATE ANTELOPE V41-B11-13HNB |
| Field | WELD COUNTY | Wellbore | STATE ANTELOPE V41-B11-13HNB PWB |
| Facility | SEC.13-T5N-R62W | | |

| SURVEY PROGRAM - Offset Wellbore: STATE ANTELOPE Y44-E14-13HNB PWB Offset Wellpath: STATE ANTELOPE Y44-E14-13HNB PWP (REV-A.0) | | | | |
|---|----------------|------------------------------|------------------|----------------------------------|
| Start MD [ft] | End MD [ft] | Positional Uncertainty Model | Log Name/Comment | Wellbore |
| 17.00 | 1550.00 | BHI NaviTrak (Rotating) | | STATE ANTELOPE Y44-E14-13HNB PWB |
| 1550.00 | 11675.40 | BHI AutoTrak Curve (Short) | | STATE ANTELOPE Y44-E14-13HNB PWB |

| OFFSET WELLPATH REFERENCE - Offset Wellbore: STATE ANTELOPE Y44-E14-13HNB PWB Offset Wellpath: STATE ANTELOPE Y44-E14-13HNB PWP (REV-A.0) | |
|--|---|
| MD Reference: RIG (17') (RKB) | Offset TVD & local coordinates use Reference Wellpath settings (See WELLPATH DATUM on page 1 of this report) |
| Ellipse Start MD | 17.00ft |



Clearance Report
STATE ANTELOPE V41-B11-13HNB PWP (REV-A.0)
Closest Approach
Page 17 of 18



| REFERENCE WELLPATH IDENTIFICATION | | | |
|-----------------------------------|---------------------------|----------|--|
| Operator | BONANZA CREEK OIL COMPANY | Slot | SLOT#06 STATE ANTELOPE V41-B11-13HNB (2587'FNL & 510'FEL,SEC.13) |
| Area | COLORADO | Well | STATE ANTELOPE V41-B11-13HNB |
| Field | WELD COUNTY | Wellbore | STATE ANTELOPE V41-B11-13HNB PWB |
| Facility | SEC.13-T5N-R62W | | |

| CLEARANCE DATA - Offset Wellbore: STATE ANTELOPE Y-E-13HNB PWB Offset Wellpath: STATE ANTELOPE Y-E-13HNB PWP (REV-A.0) | | | | | | | | | | | | |
|--|--------------|--|---------------|----------------|--------------------------------|-------------------|----------------------|-------------------------|---------------------------------------|---------------|-----------|------------|
| Facility: SEC.13-T5N-R62W | | Slot: SLOT#12 STATE ANTELOPE Y-E-13HNB (2699'FSL & 510'FEL,SEC.13) | | | Well: STATE ANTELOPE Y-E-13HNB | | Threshold Value=1.00 | | † = interpolated/extrapolated station | | | |
| Ref MD [ft] | Ref TVD [ft] | Ref North [ft] | Ref East [ft] | Offset MD [ft] | Offset TVD [ft] | Offset North [ft] | Offset East [ft] | Angle from Highside [°] | C-C Clear Dist [ft] | ACR MASD [ft] | Sep Ratio | ACR Status |
| 17.00 | 17.00 | 0.00 | 0.00 | 17.00 | 17.00 | -120.22 | 0.56 | 179.74 | 120.22 | 1.56 | 198.77 | PASS |
| 117.00† | 117.00 | 0.00 | 0.00 | 117.00 | 117.00 | -120.22 | 0.56 | 179.74 | 120.22 | 2.18 | 97.81 | PASS |
| 200.00 | 200.00 | 0.00 | 0.00 | 200.00 | 200.00 | -120.22 | 0.56 | 179.74 | 120.22 | 2.99 | 58.84 | PASS |
| 217.00† | 217.00 | 0.05 | 0.02 | 216.37 | 216.37 | -120.27 | 0.58 | 154.07 | 120.31 | 3.16 | 54.37 | PASS |
| 317.00† | 316.97 | 2.15 | 1.03 | 312.54 | 312.51 | -122.23 | 1.48 | 154.08 | 124.47 | 4.55 | 34.45 | PASS |
| 417.00† | 416.79 | 7.40 | 3.56 | 408.07 | 407.89 | -127.09 | 3.70 | 154.09 | 134.79 | 6.46 | 24.35 | PASS |
| 517.00† | 516.35 | 15.79 | 7.59 | 502.43 | 501.87 | -134.73 | 7.19 | 154.08 | 151.21 | 8.03 | 21.26 | PASS |
| 617.00† | 615.53 | 27.31 | 13.12 | 595.11 | 593.86 | -144.96 | 11.88 | 154.05 | 173.63 | 9.43 | 20.40 | PASS |
| 717.00† | 714.20 | 41.93 | 20.15 | 685.65 | 683.33 | -157.57 | 17.64 | 153.99 | 201.89 | 10.75 | 20.54 | PASS |
| 817.00† | 812.24 | 59.66 | 28.66 | 773.63 | 769.80 | -172.27 | 24.37 | 153.88 | 235.82 | 11.95 | 21.39 | PASS |
| 917.00† | 909.54 | 80.45 | 38.66 | 858.68 | 852.89 | -188.78 | 31.92 | 153.73 | 275.21 | 13.07 | 22.66 | PASS |
| 1000.90 | 990.50 | 100.25 | 48.17 | 927.55 | 919.76 | -203.78 | 38.79 | 153.56 | 312.30 | 14.05 | 23.79 | PASS |
| 1017.00† | 1005.98 | 104.26 | 50.09 | 940.51 | 932.30 | -206.77 | 40.16 | 153.60 | 319.79 | 14.22 | 24.05 | PASS |
| 1117.00† | 1102.10 | 129.13 | 62.05 | 1019.78 | 1008.64 | -226.15 | 49.03 | 153.69 | 367.60 | 15.17 | 25.81 | PASS |
| 1217.00† | 1198.22 | 154.00 | 74.00 | 1096.89 | 1082.31 | -246.85 | 58.50 | 153.61 | 417.56 | 16.12 | 27.49 | PASS |
| 1317.00† | 1294.34 | 178.87 | 85.95 | 1171.82 | 1153.29 | -268.68 | 68.49 | 153.43 | 469.58 | 16.95 | 29.31 | PASS |
| 1417.00† | 1390.45 | 203.74 | 97.90 | 1244.57 | 1221.58 | -291.48 | 78.92 | 153.18 | 523.57 | 17.98 | 30.71 | PASS |
| 1517.00† | 1486.57 | 228.62 | 109.85 | 1315.15 | 1287.20 | -315.11 | 89.73 | 152.88 | 579.47 | 18.93 | 32.20 | PASS |
| 1617.00† | 1582.69 | 253.49 | 121.80 | 1383.56 | 1350.17 | -339.40 | 100.84 | 152.56 | 637.19 | 19.50 | 33.95 | PASS |
| 1717.00† | 1678.81 | 278.36 | 133.75 | 1449.83 | 1410.55 | -364.23 | 112.21 | 152.23 | 696.66 | 20.08 | 36.02 | PASS |
| 1817.00† | 1774.92 | 303.23 | 145.70 | 1513.99 | 1468.40 | -389.47 | 123.76 | 151.89 | 757.81 | 20.67 | 38.01 | PASS |
| 1917.00† | 1871.04 | 328.10 | 157.65 | 1576.07 | 1523.77 | -415.02 | 135.44 | 151.56 | 820.56 | 21.10 | 40.20 | PASS |
| 2017.00† | 1967.16 | 352.97 | 169.60 | 1636.14 | 1576.73 | -440.76 | 147.22 | 151.23 | 884.84 | 21.54 | 42.43 | PASS |
| 2117.00† | 2063.28 | 377.85 | 181.55 | 1695.89 | 1628.84 | -467.36 | 159.39 | 150.89 | 950.58 | 21.93 | 44.76 | PASS |

C-C Clearance Distance Cutoff: 1000.00 ft

| POSITIONAL UNCERTAINTY - Offset Wellbore: STATE ANTELOPE Y-E-13HNB PWB Offset Wellpath: STATE ANTELOPE Y-E-13HNB PWP (REV-A.0) | | | | |
|--|--|------------|---------|------------------|
| Slot Surface Uncertainty @1SD | | Horizontal | 0.100ft | Vertical 1.000ft |
| Facility Surface Uncertainty @1SD | | Horizontal | 8.200ft | Vertical 3.000ft |

| HOLE & CASING SECTIONS - Offset Wellbore: STATE ANTELOPE Y-E-13HNB PWB Offset Wellpath: STATE ANTELOPE Y-E-13HNB PWP (REV-A.0) | | | | | | | | | |
|---|------------------|----------------|------------------|-------------------|-----------------|-------------------|-------------------|-----------------|-----------------|
| String/Diameter | Start MD [ft] | End MD [ft] | Interval [ft] | Start TVD [ft] | End TVD [ft] | Start N/S [ft] | Start E/W [ft] | End N/S [ft] | End E/W [ft] |
| 13.5in Open Hole | 17.00 | 1550.00 | 1533.00 | 17.00 | 1500.59 | -73.29 | 0.34 | -159.83 | 39.94 |
| 9.625in Casing Surface | 17.00 | 1550.00 | 1533.00 | 17.00 | 1500.59 | -73.29 | 0.34 | -159.83 | 39.94 |
| 8.5in Open Hole | 1550.00 | 12383.68 | 10833.68 | 1500.59 | N/A | -159.83 | 39.94 | N/A | N/A |



Clearance Report

STATE ANTELOPE V41-B11-13HNB PWP (REV-A.0)

Closest Approach

Page 18 of 18



| REFERENCE WELLPATH IDENTIFICATION | | | |
|-----------------------------------|---------------------------|----------|--|
| Operator | BONANZA CREEK OIL COMPANY | Slot | SLOT#06 STATE ANTELOPE V41-B11-13HNB (2587'FNL & 510'FEL,SEC.13) |
| Area | COLORADO | Well | STATE ANTELOPE V41-B11-13HNB |
| Field | WELD COUNTY | Wellbore | STATE ANTELOPE V41-B11-13HNB PWB |
| Facility | SEC.13-T5N-R62W | | |

| SURVEY PROGRAM - Offset Wellbore: STATE ANTELOPE Y-E-13HNB PWB Offset Wellpath: STATE ANTELOPE Y-E-13HNB PWP (REV-A.0) | | | | |
|---|----------------|------------------------------|------------------|------------------------------|
| Start MD [ft] | End MD [ft] | Positional Uncertainty Model | Log Name/Comment | Wellbore |
| 17.00 | 1550.00 | BHI NaviTrak (Rotating) | | STATE ANTELOPE Y-E-13HNB PWB |
| 1550.00 | 12383.68 | BHI AutoTrak Curve (Short) | | STATE ANTELOPE Y-E-13HNB PWB |

| OFFSET WELLPATH REFERENCE - Offset Wellbore: STATE ANTELOPE Y-E-13HNB PWB Offset Wellpath: STATE ANTELOPE Y-E-13HNB PWP (REV-A.0) | |
|--|---|
| MD Reference: RIG (17') (RKB) | Offset TVD & local coordinates use Reference Wellpath settings (See WELLPATH DATUM on page 1 of this report) |
| Ellipse Start MD | 17.00ft |