

BONANZA CREEK OIL COMPANY

Location: COLORADO Slot: SLOT#10 STATE ANTELOPE X44-D14-13HNB (2667'FNL & 510'FEL, SEC.13)
Field: WELD COUNTY Well: STATE ANTELOPE X44-D14-13HNB
Facility: SEC.13-T5N-R62W Wellbore: STATE ANTELOPE X44-D14-13HNB PWB

Plot reference wellpath is STATE ANTELOPE X44-D14-13HNB PWP (REV-A.0)

| | |
|--|--|
| True vertical depths are referenced to RIG (17) (RKB) | Grid System: NAD83 / Lambert Colorado SP, Northern Zone (501), US feet |
| Measured depths are referenced to RIG (17) (RKB) | North Reference: True north |
| RIG (17) (RKB) to Mean Sea Level: 4590 feet | Scale: True distance |
| Mean Sea Level to Ground level (At Slot: SLOT#10 STATE ANTELOPE X44-D14-13HNB (2667'FNL & 510'FEL, SEC.13)) 0 feet | Depths are in feet |
| Coordinates are in feet referenced to Slot | Created by: robale01 on 2018-11-15 |
| | Databases: WA DENVER |

Location Information

| | | | | | | |
|---|--------------|--------------|-------------------|--------------------|----------------|-----------------|
| Facility Name | | | Grid East (US ft) | Grid North (US ft) | Latitude | Longitude |
| SEC.13-T5N-R62W | | | 333955.889 | 138953.906 | 40°23'50.820"N | 104°15'47.028"W |
| Slot | Local N (ft) | Local E (ft) | Grid East (US ft) | Grid North (US ft) | Latitude | Longitude |
| SLOT#10 STATE ANTELOPE X44-D14-13HNB (2667'FNL & 510'FEL, SEC.13) | 1335.97 | 4472.71 | 3344313.606 | 1391367.242 | 40°24'04.018"N | 104°15'49.216"W |
| RIG (17) (RKB) to Ground level (At Slot: SLOT#10 STATE ANTELOPE X44-D14-13HNB (2667'FNL & 510'FEL, SEC.13)) | | | 4590ft | | | |
| Mean Sea Level to Ground level (At Slot: SLOT#10 STATE ANTELOPE X44-D14-13HNB (2667'FNL & 510'FEL, SEC.13)) | | | 0ft | | | |
| RIG (17) (RKB) to Mean Sea Level | | | 4590ft | | | |

Survey Program

| | | | | | |
|---------------|-------------|--------------------|----------------------------|------------------|----------------------------------|
| Start MD (ft) | End MD (ft) | Tool | Model | Log Name/Comment | Wellbore |
| 17.00 | 1550.00 | BHI NavTrak | BHI NavTrak (Rotating) | | STATE ANTELOPE X44-D14-13HNB PWB |
| 1550.00 | 11521.25 | BHI AutoTrak Curve | BHI AutoTrak Curve (Short) | | STATE ANTELOPE X44-D14-13HNB PWB |

Hole and Casing Sections

| Name | Start MD (ft) | End MD (ft) | Interval (ft) | Start TVD (ft) | End TVD (ft) | Start Local N (ft) | End Local N (ft) | Start Local E (ft) | End Local E (ft) | Wellbore |
|------------------------|---------------|-------------|---------------|----------------|--------------|--------------------|------------------|--------------------|------------------|----------------------------------|
| 13.5in Open Hole | 17.00 | 1550.00 | 1533.00 | 17.00 | 1514.18 | 0.00 | 0.00 | -242.62 | 92.88 | STATE ANTELOPE X44-D14-13HNB PWB |
| 9.625in Casing Surface | 17.00 | 1550.00 | 1533.00 | 17.00 | 1514.18 | 0.00 | 0.00 | -242.62 | 92.88 | STATE ANTELOPE X44-D14-13HNB PWB |
| 8.5in Open Hole | 1550.00 | 11521.25 | 9971.25 | 1514.18 | N/A | -242.62 | 92.88 | N/A | N/A | STATE ANTELOPE X44-D14-13HNB PWB |

Well Profile Data

| Design Comment | MD (ft) | Inc (°) | Az (°) | TVD (ft) | Local N (ft) | Local E (ft) | DLS (°/100ft) | VS (ft) |
|----------------|----------|---------|---------|----------|--------------|--------------|---------------|---------|
| Tie On | 17.00 | 0.000 | 159.053 | 17.00 | 0.00 | 0.00 | 0.00 | 0.00 |
| End of Tangent | 300.00 | 0.000 | 159.053 | 300.00 | 0.00 | 0.00 | 0.00 | 0.00 |
| End of Build | 1319.23 | 20.385 | 159.053 | 1297.86 | -167.55 | 64.14 | 2.00 | 4.22 |
| End of Tangent | 5744.75 | 20.385 | 159.053 | 5446.24 | -1607.17 | 615.23 | 0.00 | 40.51 |
| End of 3D Arc | 6711.65 | 90.000 | 268.595 | 6050.00 | -1832.49 | 51.53 | 10.00 | 647.55 |
| End of Tangent | 11521.25 | 90.000 | 268.595 | 6050.00 | -1950.43 | -4756.62 | 0.00 | 5140.97 |

Bottom Hole Location

| MD (ft) | Inc (°) | Az (°) | TVD (ft) | Local N (ft) | Local E (ft) | Grid East (US ft) | Grid North (US ft) | Latitude | Longitude |
|----------|---------|---------|----------|--------------|--------------|-------------------|--------------------|----------------|-----------------|
| 11521.25 | 90.000 | 268.595 | 6050.00 | -1950.43 | -4756.62 | 3339584.84 | 1389350.77 | 40°23'44.740"N | 104°16'50.693"W |

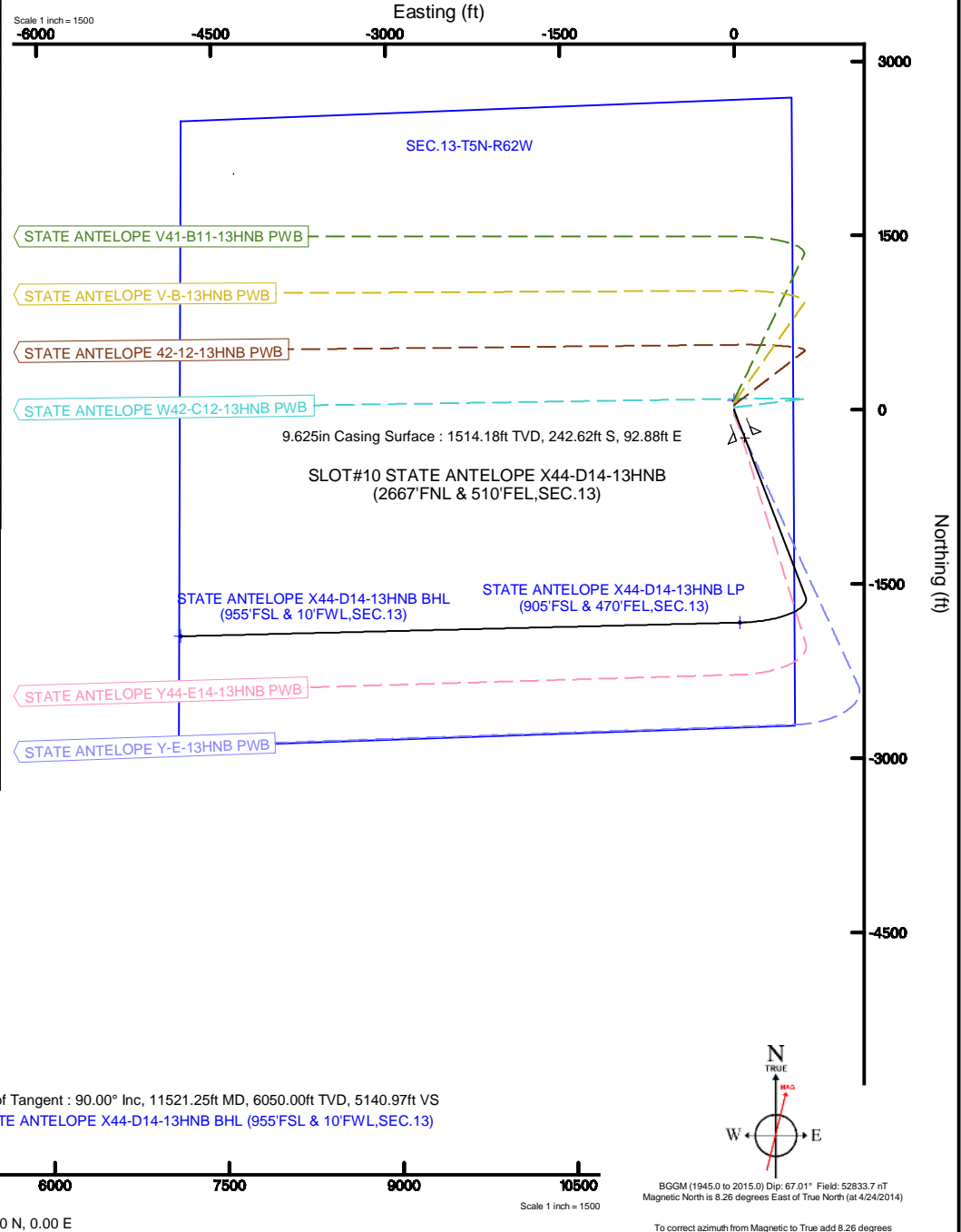
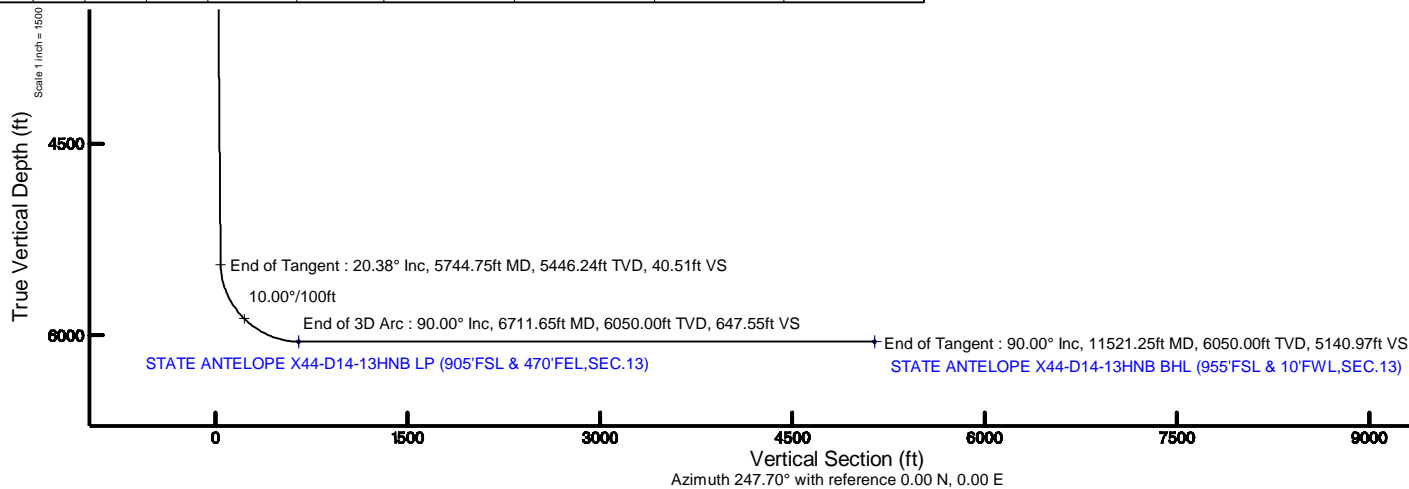



Planned Wellpath Report

STATE ANTELOPE X44-D14-13HNB PWP (REV-A.0)

Page 1 of 6



| REFERENCE WELLPATH IDENTIFICATION | | | |
|-----------------------------------|---------------------------|----------|--|
| Operator | BONANZA CREEK OIL COMPANY | Slot | SLOT#10 STATE ANTELOPE X44-D14-13HNB (2667'FNL & 510'FEL,SEC.13) |
| Area | COLORADO | Well | STATE ANTELOPE X44-D14-13HNB |
| Field | WELD COUNTY | Wellbore | STATE ANTELOPE X44-D14-13HNB PWB |
| Facility | SEC.13-T5N-R62W | | |

| REPORT SETUP INFORMATION | | | |
|--------------------------|---|----------------------|--|
| Projection System | NAD83 / Lambert Colorado SP, Northern Zone (501), US feet | Software System | WellArchitect® 5.1 |
| North Reference | True | User | Robiale01 |
| Scale | 0.999960 | Report Generated | 11/15/2018 at 10:17:04 AM |
| Convergence at slot | 0.80° East | Database/Source file | WA DENVER/STATE_ANTELOPE_X44-D14-13HNB_PWP__REV-A.0_.xml |

| WELLPATH LOCATION | | | | | | |
|-----------------------|-------------------|----------|------------------|-----------------|------------------------|-----------------|
| | Local coordinates | | Grid coordinates | | Geographic coordinates | |
| | North[ft] | East[ft] | Easting[US ft] | Northing[US ft] | Latitude | Longitude |
| Slot Location | 1335.97 | 4472.71 | 3344313.61 | 1391367.24 | 40°24'04.018"N | 104°15'49.216"W |
| Facility Reference Pt | | | 3339859.89 | 1389969.91 | 40°23'50.820"N | 104°16'47.028"W |
| Field Reference Pt | | | 3224525.77 | 1254425.87 | 40°01'44.400"N | 104°41'53.556"W |

| WELLPATH DATUM | | | |
|--------------------------|-------------------|--|-------------------|
| Calculation method | Minimum curvature | RIG (17') (RKB) to Facility Vertical Datum | 4590.00ft |
| Horizontal Reference Pt | Slot | RIG (17') (RKB) to Mean Sea Level | 4590.00ft |
| Vertical Reference Pt | RIG (17') (RKB) | RIG (17') (RKB) to Ground Level at Slot (SLOT#10 STATE ANTELOPE X44-D14-13HNB (2667'FNL & 510'FEL,SEC.13)) | 4590.00ft |
| MD Reference Pt | RIG (17') (RKB) | Section Origin | N 0.00, E 0.00 ft |
| Field Vertical Reference | Mean Sea Level | Section Azimuth | 247.70° |



Planned Wellpath Report
STATE ANTELOPE X44-D14-13HNB PWP (REV-A.0)
Page 2 of 6



| REFERENCE WELLPATH IDENTIFICATION | | | |
|-----------------------------------|---------------------------|----------|--|
| Operator | BONANZA CREEK OIL COMPANY | Slot | SLOT#10 STATE ANTELOPE X44-D14-13HNB (2667'FNL & 510'FEL,SEC.13) |
| Area | COLORADO | Well | STATE ANTELOPE X44-D14-13HNB |
| Field | WELD COUNTY | Wellbore | STATE ANTELOPE X44-D14-13HNB PWB |
| Facility | SEC.13-T5N-R62W | | |

| WELLPATH DATA (122 stations) † = interpolated/extrapolated station | | | | | | | | | | |
|--|--------------------|----------------|-------------|-------------------|---------------|--------------|----------------|-----------------|------------------|----------------|
| MD [ft] | Inclination [°] | Azimuth [°] | TVD [ft] | Vert Sect [ft] | North [ft] | East [ft] | Latitude | Longitude | DLS [°/100ft] | Comments |
| 0.00† | 0.000 | 159.053 | 0.00 | 0.00 | 0.00 | 0.00 | 40°24'04.018"N | 104°15'49.216"W | 0.00 | |
| 17.00 | 0.000 | 159.053 | 17.00 | 0.00 | 0.00 | 0.00 | 40°24'04.018"N | 104°15'49.216"W | 0.00 | Tie On |
| 117.00† | 0.000 | 159.053 | 117.00 | 0.00 | 0.00 | 0.00 | 40°24'04.018"N | 104°15'49.216"W | 0.00 | |
| 217.00† | 0.000 | 159.053 | 217.00 | 0.00 | 0.00 | 0.00 | 40°24'04.018"N | 104°15'49.216"W | 0.00 | |
| 300.00 | 0.000 | 159.053 | 300.00 | 0.00 | 0.00 | 0.00 | 40°24'04.018"N | 104°15'49.216"W | 0.00 | End of Tangent |
| 317.00† | 0.340 | 159.053 | 317.00 | 0.00 | -0.05 | 0.02 | 40°24'04.017"N | 104°15'49.215"W | 2.00 | |
| 417.00† | 2.340 | 159.053 | 416.97 | 0.06 | -2.23 | 0.85 | 40°24'03.996"N | 104°15'49.205"W | 2.00 | |
| 517.00† | 4.340 | 159.053 | 516.79 | 0.19 | -7.67 | 2.94 | 40°24'03.942"N | 104°15'49.178"W | 2.00 | |
| 617.00† | 6.340 | 159.053 | 616.35 | 0.41 | -16.36 | 6.26 | 40°24'03.856"N | 104°15'49.135"W | 2.00 | |
| 717.00† | 8.340 | 159.053 | 715.53 | 0.71 | -28.29 | 10.83 | 40°24'03.738"N | 104°15'49.076"W | 2.00 | |
| 817.00† | 10.340 | 159.053 | 814.20 | 1.10 | -43.45 | 16.63 | 40°24'03.588"N | 104°15'49.001"W | 2.00 | |
| 917.00† | 12.340 | 159.053 | 912.24 | 1.56 | -61.81 | 23.66 | 40°24'03.407"N | 104°15'48.910"W | 2.00 | |
| 1017.00† | 14.340 | 159.053 | 1009.54 | 2.10 | -83.36 | 31.91 | 40°24'03.194"N | 104°15'48.803"W | 2.00 | |
| 1117.00† | 16.340 | 159.053 | 1105.97 | 2.72 | -108.06 | 41.37 | 40°24'02.950"N | 104°15'48.681"W | 2.00 | |
| 1217.00† | 18.340 | 159.053 | 1201.42 | 3.43 | -135.90 | 52.02 | 40°24'02.675"N | 104°15'48.543"W | 2.00 | |
| 1317.00† | 20.340 | 159.053 | 1295.77 | 4.21 | -166.82 | 63.86 | 40°24'02.369"N | 104°15'48.390"W | 2.00 | |
| 1319.23 | 20.385 | 159.053 | 1297.86 | 4.22 | -167.55 | 64.14 | 40°24'02.362"N | 104°15'48.387"W | 2.00 | End of Build |
| 1417.00† | 20.385 | 159.053 | 1389.51 | 5.02 | -199.35 | 76.31 | 40°24'02.048"N | 104°15'48.229"W | 0.00 | |
| 1517.00† | 20.385 | 159.053 | 1483.25 | 5.84 | -231.88 | 88.77 | 40°24'01.726"N | 104°15'48.068"W | 0.00 | |
| 1617.00† | 20.385 | 159.053 | 1576.99 | 6.66 | -264.41 | 101.22 | 40°24'01.405"N | 104°15'47.907"W | 0.00 | |
| 1717.00† | 20.385 | 159.053 | 1670.72 | 7.48 | -296.94 | 113.67 | 40°24'01.083"N | 104°15'47.746"W | 0.00 | |
| 1817.00† | 20.385 | 159.053 | 1764.46 | 8.30 | -329.47 | 126.12 | 40°24'00.762"N | 104°15'47.585"W | 0.00 | |
| 1917.00† | 20.385 | 159.053 | 1858.20 | 9.12 | -362.00 | 138.58 | 40°24'00.440"N | 104°15'47.424"W | 0.00 | |
| 2017.00† | 20.385 | 159.053 | 1951.94 | 9.94 | -394.53 | 151.03 | 40°24'00.119"N | 104°15'47.263"W | 0.00 | |
| 2117.00† | 20.385 | 159.053 | 2045.67 | 10.76 | -427.06 | 163.48 | 40°23'59.798"N | 104°15'47.103"W | 0.00 | |
| 2217.00† | 20.385 | 159.053 | 2139.41 | 11.58 | -459.59 | 175.93 | 40°23'59.476"N | 104°15'46.942"W | 0.00 | |
| 2317.00† | 20.385 | 159.053 | 2233.15 | 12.40 | -492.12 | 188.39 | 40°23'59.155"N | 104°15'46.781"W | 0.00 | |
| 2417.00† | 20.385 | 159.053 | 2326.89 | 13.22 | -524.65 | 200.84 | 40°23'58.833"N | 104°15'46.620"W | 0.00 | |
| 2517.00† | 20.385 | 159.053 | 2420.62 | 14.04 | -557.18 | 213.29 | 40°23'58.512"N | 104°15'46.459"W | 0.00 | |
| 2617.00† | 20.385 | 159.053 | 2514.36 | 14.86 | -589.71 | 225.74 | 40°23'58.190"N | 104°15'46.298"W | 0.00 | |
| 2717.00† | 20.385 | 159.053 | 2608.10 | 15.68 | -622.24 | 238.20 | 40°23'57.869"N | 104°15'46.137"W | 0.00 | |
| 2817.00† | 20.385 | 159.053 | 2701.84 | 16.50 | -654.77 | 250.65 | 40°23'57.547"N | 104°15'45.976"W | 0.00 | |
| 2917.00† | 20.385 | 159.053 | 2795.57 | 17.32 | -687.30 | 263.10 | 40°23'57.226"N | 104°15'45.815"W | 0.00 | |
| 3017.00† | 20.385 | 159.053 | 2889.31 | 18.14 | -719.83 | 275.55 | 40°23'56.904"N | 104°15'45.654"W | 0.00 | |
| 3117.00† | 20.385 | 159.053 | 2983.05 | 18.96 | -752.36 | 288.01 | 40°23'56.583"N | 104°15'45.493"W | 0.00 | |
| 3217.00† | 20.385 | 159.053 | 3076.79 | 19.78 | -784.89 | 300.46 | 40°23'56.262"N | 104°15'45.332"W | 0.00 | |

| WELLPATH DATA (122 stations) † = interpolated/extrapolated station | | | | | | | | | | |
|--|--------------------|----------------|-------------|-------------------|---------------|--------------|----------------|-----------------|------------------|----------|
| MD [ft] | Inclination [°] | Azimuth [°] | TVD [ft] | Vert Sect [ft] | North [ft] | East [ft] | Latitude | Longitude | DLS [°/100ft] | Comments |
| 3317.00† | 20.385 | 159.053 | 3170.52 | 20.60 | -817.42 | 312.91 | 40°23'55.940"N | 104°15'45.171"W | 0.00 | |
| 3417.00† | 20.385 | 159.053 | 3264.26 | 21.42 | -849.95 | 325.36 | 40°23'55.619"N | 104°15'45.010"W | 0.00 | |
| 3517.00† | 20.385 | 159.053 | 3358.00 | 22.24 | -882.48 | 337.82 | 40°23'55.297"N | 104°15'44.849"W | 0.00 | |
| 3617.00† | 20.385 | 159.053 | 3451.74 | 23.06 | -915.01 | 350.27 | 40°23'54.976"N | 104°15'44.688"W | 0.00 | |
| 3717.00† | 20.385 | 159.053 | 3545.48 | 23.88 | -947.54 | 362.72 | 40°23'54.654"N | 104°15'44.527"W | 0.00 | |
| 3817.00† | 20.385 | 159.053 | 3639.21 | 24.70 | -980.07 | 375.18 | 40°23'54.333"N | 104°15'44.366"W | 0.00 | |
| 3917.00† | 20.385 | 159.053 | 3732.95 | 25.52 | -1012.60 | 387.63 | 40°23'54.011"N | 104°15'44.205"W | 0.00 | |
| 4017.00† | 20.385 | 159.053 | 3826.69 | 26.34 | -1045.13 | 400.08 | 40°23'53.690"N | 104°15'44.045"W | 0.00 | |
| 4117.00† | 20.385 | 159.053 | 3920.43 | 27.16 | -1077.66 | 412.53 | 40°23'53.368"N | 104°15'43.884"W | 0.00 | |

REFERENCE WELLPATH IDENTIFICATION

| | | | |
|----------|---------------------------|----------|--|
| Operator | BONANZA CREEK OIL COMPANY | Slot | SLOT#10 STATE ANTELOPE X44-D14-13HNB (2667'FNL & 510'FEL,SEC.13) |
| Area | COLORADO | Well | STATE ANTELOPE X44-D14-13HNB |
| Field | WELD COUNTY | Wellbore | STATE ANTELOPE X44-D14-13HNB PWB |
| Facility | SEC.13-T5N-R62W | | |

WELLPATH DATA (122 stations) † = interpolated/extrapolated station

| MD [ft] | Inclination [°] | Azimuth [°] | TVD [ft] | Vert Sect [ft] | North [ft] | East [ft] | Latitude | Longitude | DLS [°/100ft] | Comments |
|------------|--------------------|----------------|----------------------|-------------------|---------------|--------------|----------------|-----------------|------------------|----------------|
| 4217.00† | 20.385 | 159.053 | 4014.16 | 27.98 | -1110.19 | 424.99 | 40°23'53.047"N | 104°15'43.723"W | 0.00 | |
| 4317.00† | 20.385 | 159.053 | 4107.90 | 28.80 | -1142.72 | 437.44 | 40°23'52.726"N | 104°15'43.562"W | 0.00 | |
| 4417.00† | 20.385 | 159.053 | 4201.64 | 29.62 | -1175.25 | 449.89 | 40°23'52.404"N | 104°15'43.401"W | 0.00 | |
| 4517.00† | 20.385 | 159.053 | 4295.38 | 30.44 | -1207.78 | 462.34 | 40°23'52.083"N | 104°15'43.240"W | 0.00 | |
| 4617.00† | 20.385 | 159.053 | 4389.11 | 31.26 | -1240.31 | 474.80 | 40°23'51.761"N | 104°15'43.079"W | 0.00 | |
| 4717.00† | 20.385 | 159.053 | 4482.85 | 32.08 | -1272.84 | 487.25 | 40°23'51.440"N | 104°15'42.918"W | 0.00 | |
| 4817.00† | 20.385 | 159.053 | 4576.59 | 32.90 | -1305.37 | 499.70 | 40°23'51.118"N | 104°15'42.757"W | 0.00 | |
| 4917.00† | 20.385 | 159.053 | 4670.33 | 33.72 | -1337.90 | 512.15 | 40°23'50.797"N | 104°15'42.596"W | 0.00 | |
| 5017.00† | 20.385 | 159.053 | 4764.06 | 34.54 | -1370.43 | 524.61 | 40°23'50.475"N | 104°15'42.435"W | 0.00 | |
| 5117.00† | 20.385 | 159.053 | 4857.80 | 35.36 | -1402.96 | 537.06 | 40°23'50.154"N | 104°15'42.274"W | 0.00 | |
| 5217.00† | 20.385 | 159.053 | 4951.54 | 36.18 | -1435.49 | 549.51 | 40°23'49.833"N | 104°15'42.113"W | 0.00 | |
| 5317.00† | 20.385 | 159.053 | 5045.28 | 37.00 | -1468.02 | 561.96 | 40°23'49.511"N | 104°15'41.952"W | 0.00 | |
| 5417.00† | 20.385 | 159.053 | 5139.01 | 37.82 | -1500.55 | 574.42 | 40°23'49.190"N | 104°15'41.791"W | 0.00 | |
| 5517.00† | 20.385 | 159.053 | 5232.75 | 38.64 | -1533.08 | 586.87 | 40°23'48.868"N | 104°15'41.630"W | 0.00 | |
| 5617.00† | 20.385 | 159.053 | 5326.49 | 39.46 | -1565.61 | 599.32 | 40°23'48.547"N | 104°15'41.470"W | 0.00 | |
| 5717.00† | 20.385 | 159.053 | 5420.23 | 40.28 | -1598.14 | 611.77 | 40°23'48.225"N | 104°15'41.309"W | 0.00 | |
| 5744.75 | 20.385 | 159.053 | 5446.24 | 40.51 | -1607.17 | 615.23 | 40°23'48.136"N | 104°15'41.264"W | 0.00 | End of Tangent |
| 5817.00† | 19.307 | 180.212 | 5514.29 | 45.39 | -1630.90 | 619.69 | 40°23'47.902"N | 104°15'41.206"W | 10.00 | |
| 5917.00† | 21.891 | 207.960 | 5608.11 | 66.10 | -1663.98 | 610.87 | 40°23'47.575"N | 104°15'41.320"W | 10.00 | |
| 6017.00† | 27.891 | 227.171 | 5698.92 | 102.43 | -1696.43 | 584.91 | 40°23'47.254"N | 104°15'41.656"W | 10.00 | |
| 6117.00† | 35.618 | 239.332 | 5783.98 | 153.27 | -1727.26 | 542.60 | 40°23'46.949"N | 104°15'42.203"W | 10.00 | |
| 6217.00† | 44.168 | 247.463 | 5860.68 | 217.08 | -1755.53 | 485.23 | 40°23'46.670"N | 104°15'42.944"W | 10.00 | |
| 6317.00† | 53.138 | 253.372 | 5926.71 | 291.92 | -1780.40 | 414.54 | 40°23'46.424"N | 104°15'43.858"W | 10.00 | |
| 6417.00† | 62.338 | 258.018 | 5980.05 | 375.51 | -1801.09 | 332.68 | 40°23'46.220"N | 104°15'44.916"W | 10.00 | |
| 6517.00† | 71.669 | 261.932 | 6019.09 | 465.31 | -1816.99 | 242.14 | 40°23'46.063"N | 104°15'46.086"W | 10.00 | |
| 6617.00† | 81.071 | 265.441 | 6042.64 | 558.60 | -1827.60 | 145.66 | 40°23'45.958"N | 104°15'47.333"W | 10.00 | |
| 6711.65 | 90.000 | 268.595 | 6050.00 ¹ | 647.55 | -1832.49 | 51.53 | 40°23'45.910"N | 104°15'48.550"W | 10.00 | End of 3D Arc |
| 6717.00† | 90.000 | 268.595 | 6050.00 | 652.54 | -1832.62 | 46.19 | 40°23'45.908"N | 104°15'48.619"W | 0.00 | |
| 6817.00† | 90.000 | 268.595 | 6050.00 | 745.97 | -1835.07 | -53.78 | 40°23'45.884"N | 104°15'49.911"W | 0.00 | |
| 6917.00† | 90.000 | 268.595 | 6050.00 | 839.40 | -1837.52 | -153.75 | 40°23'45.860"N | 104°15'51.203"W | 0.00 | |
| 7017.00† | 90.000 | 268.595 | 6050.00 | 932.82 | -1839.98 | -253.72 | 40°23'45.836"N | 104°15'52.495"W | 0.00 | |
| 7117.00† | 90.000 | 268.595 | 6050.00 | 1026.25 | -1842.43 | -353.69 | 40°23'45.811"N | 104°15'53.787"W | 0.00 | |
| 7217.00† | 90.000 | 268.595 | 6050.00 | 1119.68 | -1844.88 | -453.66 | 40°23'45.787"N | 104°15'55.079"W | 0.00 | |
| 7317.00† | 90.000 | 268.595 | 6050.00 | 1213.10 | -1847.33 | -553.63 | 40°23'45.763"N | 104°15'56.371"W | 0.00 | |
| 7417.00† | 90.000 | 268.595 | 6050.00 | 1306.53 | -1849.79 | -653.60 | 40°23'45.739"N | 104°15'57.663"W | 0.00 | |

| WELLPATH DATA (122 stations) † = interpolated/extrapolated station | | | | | | | | | | |
|--|--------------------|----------------|-------------|-------------------|---------------|--------------|----------------|-----------------|------------------|----------|
| MD [ft] | Inclination [°] | Azimuth [°] | TVD [ft] | Vert Sect [ft] | North [ft] | East [ft] | Latitude | Longitude | DLS [°/100ft] | Comments |
| 7517.00† | 90.000 | 268.595 | 6050.00 | 1399.95 | -1852.24 | -753.57 | 40°23'45.714"N | 104°15'58.955"W | 0.00 | |
| 7617.00† | 90.000 | 268.595 | 6050.00 | 1493.38 | -1854.69 | -853.54 | 40°23'45.690"N | 104°16'00.247"W | 0.00 | |
| 7717.00† | 90.000 | 268.595 | 6050.00 | 1586.81 | -1857.14 | -953.51 | 40°23'45.666"N | 104°16'01.539"W | 0.00 | |
| 7817.00† | 90.000 | 268.595 | 6050.00 | 1680.23 | -1859.60 | -1053.48 | 40°23'45.642"N | 104°16'02.831"W | 0.00 | |
| 7917.00† | 90.000 | 268.595 | 6050.00 | 1773.66 | -1862.05 | -1153.45 | 40°23'45.617"N | 104°16'04.124"W | 0.00 | |
| 8017.00† | 90.000 | 268.595 | 6050.00 | 1867.09 | -1864.50 | -1253.42 | 40°23'45.593"N | 104°16'05.416"W | 0.00 | |
| 8117.00† | 90.000 | 268.595 | 6050.00 | 1960.51 | -1866.95 | -1353.39 | 40°23'45.569"N | 104°16'06.708"W | 0.00 | |
| 8217.00† | 90.000 | 268.595 | 6050.00 | 2053.94 | -1869.40 | -1453.36 | 40°23'45.544"N | 104°16'08.000"W | 0.00 | |
| 8317.00† | 90.000 | 268.595 | 6050.00 | 2147.36 | -1871.86 | -1553.33 | 40°23'45.520"N | 104°16'09.292"W | 0.00 | |
| 8417.00† | 90.000 | 268.595 | 6050.00 | 2240.79 | -1874.31 | -1653.30 | 40°23'45.496"N | 104°16'10.584"W | 0.00 | |



Planned Wellpath Report
STATE ANTELOPE X44-D14-13HNB PWP (REV-A.0)
Page 4 of 6



| REFERENCE WELLPATH IDENTIFICATION | | | |
|-----------------------------------|---------------------------|----------|--|
| Operator | BONANZA CREEK OIL COMPANY | Slot | SLOT#10 STATE ANTELOPE X44-D14-13HNB (2667'FNL & 510'FEL,SEC.13) |
| Area | COLORADO | Well | STATE ANTELOPE X44-D14-13HNB |
| Field | WELD COUNTY | Wellbore | STATE ANTELOPE X44-D14-13HNB PWB |
| Facility | SEC.13-T5N-R62W | | |

| WELLPATH DATA (122 stations) † = interpolated/extrapolated station | | | | | | | | | | |
|--|--------------------|----------------|----------------------|-------------------|---------------|--------------|----------------|-----------------|------------------|----------------|
| MD [ft] | Inclination [°] | Azimuth [°] | TVD [ft] | Vert Sect [ft] | North [ft] | East [ft] | Latitude | Longitude | DLS [°/100ft] | Comments |
| 8517.00† | 90.000 | 268.595 | 6050.00 | 2334.22 | -1876.76 | -1753.27 | 40°23'45.472"N | 104°16'11.876"W | 0.00 | |
| 8617.00† | 90.000 | 268.595 | 6050.00 | 2427.64 | -1879.21 | -1853.24 | 40°23'45.447"N | 104°16'13.168"W | 0.00 | |
| 8717.00† | 90.000 | 268.595 | 6050.00 | 2521.07 | -1881.67 | -1953.21 | 40°23'45.423"N | 104°16'14.460"W | 0.00 | |
| 8817.00† | 90.000 | 268.595 | 6050.00 | 2614.50 | -1884.12 | -2053.18 | 40°23'45.399"N | 104°16'15.752"W | 0.00 | |
| 8917.00† | 90.000 | 268.595 | 6050.00 | 2707.92 | -1886.57 | -2153.15 | 40°23'45.374"N | 104°16'17.044"W | 0.00 | |
| 9017.00† | 90.000 | 268.595 | 6050.00 | 2801.35 | -1889.02 | -2253.12 | 40°23'45.350"N | 104°16'18.336"W | 0.00 | |
| 9117.00† | 90.000 | 268.595 | 6050.00 | 2894.77 | -1891.47 | -2353.09 | 40°23'45.326"N | 104°16'19.628"W | 0.00 | |
| 9217.00† | 90.000 | 268.595 | 6050.00 | 2988.20 | -1893.93 | -2453.06 | 40°23'45.301"N | 104°16'20.920"W | 0.00 | |
| 9317.00† | 90.000 | 268.595 | 6050.00 | 3081.63 | -1896.38 | -2553.03 | 40°23'45.277"N | 104°16'22.213"W | 0.00 | |
| 9417.00† | 90.000 | 268.595 | 6050.00 | 3175.05 | -1898.83 | -2653.00 | 40°23'45.253"N | 104°16'23.505"W | 0.00 | |
| 9517.00† | 90.000 | 268.595 | 6050.00 | 3268.48 | -1901.28 | -2752.97 | 40°23'45.228"N | 104°16'24.797"W | 0.00 | |
| 9617.00† | 90.000 | 268.595 | 6050.00 | 3361.91 | -1903.74 | -2852.94 | 40°23'45.204"N | 104°16'26.089"W | 0.00 | |
| 9717.00† | 90.000 | 268.595 | 6050.00 | 3455.33 | -1906.19 | -2952.91 | 40°23'45.180"N | 104°16'27.381"W | 0.00 | |
| 9817.00† | 90.000 | 268.595 | 6050.00 | 3548.76 | -1908.64 | -3052.88 | 40°23'45.155"N | 104°16'28.673"W | 0.00 | |
| 9917.00† | 90.000 | 268.595 | 6050.00 | 3642.18 | -1911.09 | -3152.85 | 40°23'45.131"N | 104°16'29.965"W | 0.00 | |
| 10017.00† | 90.000 | 268.595 | 6050.00 | 3735.61 | -1913.54 | -3252.82 | 40°23'45.107"N | 104°16'31.257"W | 0.00 | |
| 10117.00† | 90.000 | 268.595 | 6050.00 | 3829.04 | -1916.00 | -3352.79 | 40°23'45.082"N | 104°16'32.549"W | 0.00 | |
| 10217.00† | 90.000 | 268.595 | 6050.00 | 3922.46 | -1918.45 | -3452.76 | 40°23'45.058"N | 104°16'33.841"W | 0.00 | |
| 10317.00† | 90.000 | 268.595 | 6050.00 | 4015.89 | -1920.90 | -3552.73 | 40°23'45.033"N | 104°16'35.133"W | 0.00 | |
| 10417.00† | 90.000 | 268.595 | 6050.00 | 4109.32 | -1923.35 | -3652.70 | 40°23'45.009"N | 104°16'36.425"W | 0.00 | |
| 10517.00† | 90.000 | 268.595 | 6050.00 | 4202.74 | -1925.81 | -3752.67 | 40°23'44.985"N | 104°16'37.717"W | 0.00 | |
| 10617.00† | 90.000 | 268.595 | 6050.00 | 4296.17 | -1928.26 | -3852.64 | 40°23'44.960"N | 104°16'39.009"W | 0.00 | |
| 10717.00† | 90.000 | 268.595 | 6050.00 | 4389.59 | -1930.71 | -3952.61 | 40°23'44.936"N | 104°16'40.301"W | 0.00 | |
| 10817.00† | 90.000 | 268.595 | 6050.00 | 4483.02 | -1933.16 | -4052.58 | 40°23'44.911"N | 104°16'41.593"W | 0.00 | |
| 10917.00† | 90.000 | 268.595 | 6050.00 | 4576.45 | -1935.61 | -4152.55 | 40°23'44.887"N | 104°16'42.886"W | 0.00 | |
| 11017.00† | 90.000 | 268.595 | 6050.00 | 4669.87 | -1938.07 | -4252.52 | 40°23'44.863"N | 104°16'44.178"W | 0.00 | |
| 11117.00† | 90.000 | 268.595 | 6050.00 | 4763.30 | -1940.52 | -4352.49 | 40°23'44.838"N | 104°16'45.470"W | 0.00 | |
| 11217.00† | 90.000 | 268.595 | 6050.00 | 4856.73 | -1942.97 | -4452.46 | 40°23'44.814"N | 104°16'46.762"W | 0.00 | |
| 11317.00† | 90.000 | 268.595 | 6050.00 | 4950.15 | -1945.42 | -4552.43 | 40°23'44.789"N | 104°16'48.054"W | 0.00 | |
| 11417.00† | 90.000 | 268.595 | 6050.00 | 5043.58 | -1947.88 | -4652.40 | 40°23'44.765"N | 104°16'49.346"W | 0.00 | |
| 11517.00† | 90.000 | 268.595 | 6050.00 | 5137.00 | -1950.33 | -4752.37 | 40°23'44.741"N | 104°16'50.638"W | 0.00 | |
| 11521.25 | 90.000 | 268.595 | 6050.00 ² | 5140.97 | -1950.43 | -4756.62 | 40°23'44.740"N | 104°16'50.693"W | 0.00 | End of Tangent |

| HOLE & CASING SECTIONS - Ref Wellbore: STATE ANTELOPE X44-D14-13HNB PWB Ref Wellpath: STATE ANTELOPE X44-D14-13HNB PWP (REV-A.0) | | | | | | | | | |
|---|------------------|----------------|------------------|-------------------|-----------------|-------------------|-------------------|-----------------|-----------------|
| String/Diameter | Start MD [ft] | End MD [ft] | Interval [ft] | Start TVD [ft] | End TVD [ft] | Start N/S [ft] | Start E/W [ft] | End N/S [ft] | End E/W [ft] |
| 13.5in Open Hole | 17.00 | 1550.00 | 1533.00 | 17.00 | 1514.18 | 0.00 | 0.00 | -242.62 | 92.88 |
| 9.625in Casing Surface | 17.00 | 1550.00 | 1533.00 | 17.00 | 1514.18 | 0.00 | 0.00 | -242.62 | 92.88 |
| 8.5in Open Hole | 1550.00 | 11521.25 | 9971.25 | 1514.18 | N/A | -242.62 | 92.88 | N/A | N/A |



Planned Wellpath Report

STATE ANTELOPE X44-D14-13HNB PWP (REV-A.0)

Page 5 of 6



| REFERENCE WELLPATH IDENTIFICATION | | | |
|-----------------------------------|---------------------------|----------|--|
| Operator | BONANZA CREEK OIL COMPANY | Slot | SLOT#10 STATE ANTELOPE X44-D14-13HNB (2667'FNL & 510'FEL,SEC.13) |
| Area | COLORADO | Well | STATE ANTELOPE X44-D14-13HNB |
| Field | WELD COUNTY | Wellbore | STATE ANTELOPE X44-D14-13HNB PWB |
| Facility | SEC.13-T5N-R62W | | |

| TARGETS | | | | | | | | | |
|---|------------|-------------|---------------|--------------|----------------------|-----------------------|----------------|-----------------|---------|
| Name | MD [ft] | TVD [ft] | North [ft] | East [ft] | Grid East [US ft] | Grid North [US ft] | Latitude | Longitude | Shape |
| SEC.13-T5N-R62W | | 0.00 | 80.15 | -0.28 | 3344312.21 | 1391447.38 | 40°24'04.810"N | 104°15'49.219"W | polygon |
| | | | | | | | | | |
| 2) STATE ANTELOPE X44-D14-13HNB BHL (955'FSL & 10'FWL,SEC.13) | 11521.25 | 6050.00 | -1950.43 | -4756.62 | 3339584.84 | 1389350.77 | 40°23'44.740"N | 104°16'50.693"W | point |
| 1) STATE ANTELOPE X44-D14-13HNB LP (905'FSL & 470'FEL,SEC.13) | 6711.65 | 6050.00 | -1832.49 | 51.53 | 3344390.68 | 1389535.73 | 40°23'45.910"N | 104°15'48.550"W | point |
| | | | | | | | | | |

| SURVEY PROGRAM - Ref Wellbore: STATE ANTELOPE X44-D14-13HNB PWB Ref Wellpath: STATE ANTELOPE X44-D14-13HNB PWP (REV-A.0) | | | | |
|---|----------------|------------------------------|------------------|----------------------------------|
| Start MD [ft] | End MD [ft] | Positional Uncertainty Model | Log Name/Comment | Wellbore |
| 17.00 | 1550.00 | BHI NaviTrak (Rotating) | | STATE ANTELOPE X44-D14-13HNB PWB |
| 1550.00 | 11521.25 | BHI AutoTrak Curve (Short) | | STATE ANTELOPE X44-D14-13HNB PWB |



Planned Wellpath Report

STATE ANTELOPE X44-D14-13HNB PWP (REV-A.0)

Page 6 of 6



| REFERENCE WELLPATH IDENTIFICATION | | | |
|-----------------------------------|---------------------------|----------|--|
| Operator | BONANZA CREEK OIL COMPANY | Slot | SLOT#10 STATE ANTELOPE X44-D14-13HNB (2667'FNL & 510'FEL,SEC.13) |
| Area | COLORADO | Well | STATE ANTELOPE X44-D14-13HNB |
| Field | WELD COUNTY | Wellbore | STATE ANTELOPE X44-D14-13HNB PWB |
| Facility | SEC.13-T5N-R62W | | |

| DESIGN COMMENTS | | | | |
|-----------------|--------------------|----------------|-------------|----------------|
| MD [ft] | Inclination [°] | Azimuth [°] | TVD [ft] | Comment |
| 17.00 | 0.000 | 159.053 | 17.00 | Tie On |
| 300.00 | 0.000 | 159.053 | 300.00 | End of Tangent |
| 1319.23 | 20.385 | 159.053 | 1297.86 | End of Build |
| 5744.75 | 20.385 | 159.053 | 5446.24 | End of Tangent |
| 6711.65 | 90.000 | 268.595 | 6050.00 | End of 3D Arc |
| 11521.25 | 90.000 | 268.595 | 6050.00 | End of Tangent |



Clearance Report

STATE ANTELOPE X44-D14-13HNB PWP (REV-A.0)

Closest Approach

Page 1 of 18



| REFERENCE WELLPATH IDENTIFICATION | | | |
|-----------------------------------|---------------------------|----------|--|
| Operator | BONANZA CREEK OIL COMPANY | Slot | SLOT#10 STATE ANTELOPE X44-D14-13HNB (2667'FNL & 510'FEL,SEC.13) |
| Area | COLORADO | Well | STATE ANTELOPE X44-D14-13HNB |
| Field | WELD COUNTY | Wellbore | STATE ANTELOPE X44-D14-13HNB PWB |
| Facility | SEC.13-T5N-R62W | | |

| REPORT SETUP INFORMATION | | | |
|--------------------------|---|----------------------|---|
| Projection System | NAD83 / Lambert Colorado SP, Northern Zone (501), US feet | Software System | WellArchitect® 5.1 |
| North Reference | True | User | Robiale01 |
| Scale | 0.999960 | Report Generated | 11/15/2018 at 10:18:01 AM |
| Convergence at slot | 0.80° East | Database/Source file | WA DENVER/STATE_ANTELOPE_X44-D14-13HNB_PWP_REV-A.0_CR.xml |

| WELLPATH LOCATION | | | | | | |
|-----------------------|-------------------|----------|------------------|-----------------|------------------------|-----------------|
| | Local coordinates | | Grid coordinates | | Geographic coordinates | |
| | North[ft] | East[ft] | Easting[US ft] | Northing[US ft] | Latitude | Longitude |
| Slot Location | 1335.97 | 4472.71 | 3344313.61 | 1391367.24 | 40°24'04.018"N | 104°15'49.216"W |
| Facility Reference Pt | | | 3339859.89 | 1389969.91 | 40°23'50.820"N | 104°16'47.028"W |
| Field Reference Pt | | | 3224525.77 | 1254425.87 | 40°01'44.400"N | 104°41'53.556"W |

| WELLPATH DATUM | | | |
|--------------------------|-------------------|--|-----------|
| Calculation method | Minimum Curvature | RIG (17') (RKB) to Facility Vertical Datum | 4590.00ft |
| Horizontal Reference Pt | Slot | RIG (17') (RKB) to Mean Sea Level | 4590.00ft |
| Vertical Reference Pt | RIG (17') (RKB) | RIG (17') (RKB) to Ground Level at Slot (SLOT#10 STATE ANTELOPE X44-D14-13HNB (2667'FNL & 510'FEL,SEC.13)) | 4590.00ft |
| MD Reference Pt | RIG (17') (RKB) | | |
| Field Vertical Reference | Mean Sea Level | | |

| POSITIONAL UNCERTAINTY CALCULATION SETTINGS | | | | | |
|---|------------------|------------------|---------|------------------------------|----------|
| Ellipse Confidence Limit | 3.00 Std Dev | Ellipse Start MD | 17.00ft | Surface Position Uncertainty | included |
| Declination | 8.26° East of TN | Dip Angle | 67.01° | Mag Field Strength | 52834 nT |
| Slot Surface Uncertainty @1SD | | Horizontal | 0.100ft | Vertical | 1.000ft |
| Facility Surface Uncertainty @1SD | | Horizontal | 8.200ft | Vertical | 3.000ft |
| Positional Uncertainty values in the WELLPATH DATA table are the projection of the ellipsoid of uncertainty onto the vertical and horizontal planes | | | | | |

| ANTI-COLLISION RULE | | | |
|---------------------|--|--|--|
| | | | |

| ANTI-COLLISION RULE | | | |
|----------------------------|---|----------------------|-------|
| Rule Name | Baker Hughes Stop Drilling (offset is HSE risk) | Rule Based On | Ratio |
| Plane of Rule | Closest Approach | Threshold Value | 1.00 |
| Include Casing & Hole Size | yes | Apply Cone of Safety | no |



Clearance Report

STATE ANTELOPE X44-D14-13HNB PWP (REV-A.0)

Closest Approach

Page 2 of 18



| REFERENCE WELLPATH IDENTIFICATION | | | |
|-----------------------------------|---------------------------|----------|--|
| Operator | BONANZA CREEK OIL COMPANY | Slot | SLOT#10 STATE ANTELOPE X44-D14-13HNB (2667'FNL & 510'FEL,SEC.13) |
| Area | COLORADO | Well | STATE ANTELOPE X44-D14-13HNB |
| Field | WELD COUNTY | Wellbore | STATE ANTELOPE X44-D14-13HNB PWB |
| Facility | SEC.13-T5N-R62W | | |

| HOLE & CASING SECTIONS - Ref Wellbore: STATE ANTELOPE X44-D14-13HNB PWB Ref Wellpath: STATE ANTELOPE X44-D14-13HNB PWP (REV-A.0) | | | | | | | | | |
|---|------------------|----------------|------------------|-------------------|-----------------|-------------------|-------------------|-----------------|-----------------|
| String/Diameter | Start MD [ft] | End MD [ft] | Interval [ft] | Start TVD [ft] | End TVD [ft] | Start N/S [ft] | Start E/W [ft] | End N/S [ft] | End E/W [ft] |
| 13.5in Open Hole | 17.00 | 1550.00 | 1533.00 | 17.00 | 1514.18 | 0.00 | 0.00 | -242.62 | 92.88 |
| 9.625in Casing Surface | 17.00 | 1550.00 | 1533.00 | 17.00 | 1514.18 | 0.00 | 0.00 | -242.62 | 92.88 |
| 8.5in Open Hole | 1550.00 | 11521.25 | 9971.25 | 1514.18 | N/A | -242.62 | 92.88 | N/A | N/A |

| SURVEY PROGRAM - Ref Wellbore: STATE ANTELOPE X44-D14-13HNB PWB Ref Wellpath: STATE ANTELOPE X44-D14-13HNB PWP (REV-A.0) | | | | |
|---|----------------|------------------------------|------------------|----------------------------------|
| Start MD [ft] | End MD [ft] | Positional Uncertainty Model | Log Name/Comment | Wellbore |
| 17.00 | 1550.00 | BHI NaviTrak (Rotating) | | STATE ANTELOPE X44-D14-13HNB PWB |
| 1550.00 | 11521.25 | BHI AutoTrak Curve (Short) | | STATE ANTELOPE X44-D14-13HNB PWB |

| CALCULATION RANGE & CUTOFF | | |
|----------------------------|-------------------|------------------------|
| From: 17.00ft MD | To: 11521.25ft MD | C-C Cutoff: 1000.00 ft |

| OFFSET WELL CLEARANCE SUMMARY (6 Offset Wellpaths selected) Ratios are calculated in Closest Approach plane | | | | | | | | | | | |
|--|--|------------------------------|----------------------------------|--|------------------------|-------------------------------|------------------------------|--------------------------------|--------------|--------------------------------|---------------|
| Offset Facility | Offset Slot | Offset Well | Offset Wellbore | Offset Wellpath | C-C Clearance Distance | | | ACR Separation Ratio | | | |
| | | | | | Ref MD [ft] | Min C-C Clear Dist [ft] | Diverging from MD [ft] | Ref MD of Min Ratio [ft] | Min Ratio | Min Ratio Dvrg from [ft] | ACR Status |
| SEC.13-T5N-R62W | SLOT#11 STATE ANTELOPE Y44-E14-13HNB (2687'FNL & 510'FEL,SEC.13) | STATE ANTELOPE Y44-E14-13HNB | STATE ANTELOPE Y44-E14-13HNB PWB | STATE ANTELOPE Y44-E14-13HNB PWP (REV-A.0) | 17.00 | 20.04 | 217.00 | 11521.25 | 0.84 | 11521.25 | FAIL |
| SEC.13-T5N-R62W | SLOT#12 STATE ANTELOPE Y-E-13HNB (2699'FSL & 510'FEL,SEC.13) | STATE ANTELOPE Y-E-13HNB | STATE ANTELOPE Y-E-13HNB PWB | STATE ANTELOPE Y-E-13HNB PWP (REV-A.0) | 17.00 | 40.08 | 6711.65 | 11521.25 | 1.61 | 11521.25 | PASS |
| SEC.13-T5N-R62W | SLOT#09 STATE ANTELOPE W42-C12-13HNB (2647'FNL & 510'FEL,SEC.13) | STATE ANTELOPE W42-C12-13HNB | STATE ANTELOPE W42-C12-13HNB PWB | STATE ANTELOPE W42-C12-13HNB PWP (REV-A.0) | 17.00 | 20.04 | 300.00 | 11521.25 | 3.51 | 11521.25 | PASS |
| SEC.13-T5N-R62W | SLOT#08 STATE ANTELOPE 42-12-13HNB (2627'FNL & 510'FEL,SEC.13) | STATE ANTELOPE 42-12-13HNB | STATE ANTELOPE 42-12-13HNB PWB | STATE ANTELOPE 42-12-13HNB PWP (REV-A.0) | 17.00 | 40.08 | 300.00 | 11521.25 | 4.38 | 11521.25 | PASS |
| SEC.13-T5N-R62W | SLOT#07 STATE ANTELOPE V-B-13HNB (2607'FNL & 510'FEL,SEC.13) | STATE ANTELOPE V-B-13HNB | STATE ANTELOPE V-B-13HNB PWB | STATE ANTELOPE V-B-13HNB PWP (REV-A.0) | 17.00 | 60.11 | 300.00 | 11521.25 | 5.25 | 11521.25 | PASS |
| SEC.13-T5N-R62W | SLOT#06 STATE ANTELOPE V41-B11-13HNB (2587'FNL & 510'FEL,SEC.13) | STATE ANTELOPE V41-B11-13HNB | STATE ANTELOPE V41-B11-13HNB PWB | STATE ANTELOPE V41-B11-13HNB PWP (REV-A.0) | 17.00 | 80.15 | 117.00 | 11521.25 | 6.13 | 11521.25 | PASS |



| Ref MD [ft] | Ref TVD [ft] | Ref North [ft] | Ref East [ft] | Offset MD [ft] | Offset TVD [ft] | Offset North [ft] | Offset East [ft] | Angle from Highside [°] | C-C Clear Dist [ft] | ACR MASD [ft] | Sep Ratio | ACR Status |
|----------------|-----------------|-------------------|------------------|-------------------|--------------------|----------------------|---------------------|----------------------------|---------------------------|---------------------|--------------|---------------|
| 17.00 | 17.00 | 0.00 | 0.00 | 17.00 | 17.00 | -20.04 | 0.28 | 179.20 | 20.04 | 1.56 | 31.79 | PASS |
| 117.00† | 117.00 | 0.00 | 0.00 | 117.00 | 117.00 | -20.04 | 0.28 | 179.20 | 20.04 | 2.18 | 15.65 | PASS |
| 217.00† | 217.00 | 0.00 | 0.00 | 217.00 | 217.00 | -20.04 | 0.28 | 179.20 | 20.04 | 3.16 | 8.67 | PASS |
| 300.00 | 300.00 | 0.00 | 0.00 | 299.66 | 299.66 | -20.45 | 0.41 | 178.86 | 20.46 | 4.04 | 6.33 | PASS |
| 317.00† | 317.00 | -0.05 | 0.02 | 316.54 | 316.54 | -20.78 | 0.51 | 19.59 | 20.74 | 4.23 | 6.06 | PASS |
| 417.00† | 416.97 | -2.23 | 0.85 | 415.81 | 415.71 | -24.62 | 1.70 | 18.76 | 22.44 | 5.73 | 4.50 | PASS |
| 517.00† | 516.79 | -7.67 | 2.94 | 515.01 | 514.63 | -31.74 | 3.90 | 18.58 | 24.18 | 7.59 | 3.50 | PASS |
| 617.00† | 616.35 | -16.36 | 6.26 | 614.16 | 613.18 | -42.12 | 7.11 | 18.91 | 25.96 | 9.16 | 3.05 | PASS |
| 717.00† | 715.53 | -28.29 | 10.83 | 713.24 | 711.23 | -55.74 | 11.33 | 19.66 | 27.78 | 10.60 | 2.78 | PASS |
| 817.00† | 814.20 | -43.45 | 16.63 | 812.27 | 808.67 | -72.58 | 16.54 | 20.74 | 29.65 | 11.92 | 2.62 | PASS |
| 917.00† | 912.24 | -61.81 | 23.66 | 911.25 | 905.39 | -92.62 | 22.74 | 22.09 | 31.57 | 13.21 | 2.50 | PASS |
| 1017.00† | 1009.54 | -83.36 | 31.91 | 1010.16 | 1001.27 | -115.82 | 29.92 | 23.66 | 33.55 | 14.47 | 2.41 | PASS |
| 1117.00† | 1105.97 | -108.06 | 41.37 | 1109.02 | 1096.20 | -142.15 | 38.07 | 25.38 | 35.61 | 15.75 | 2.34 | PASS |
| 1217.00† | 1201.42 | -135.90 | 52.02 | 1207.82 | 1190.08 | -171.58 | 47.18 | 27.24 | 37.75 | 17.06 | 2.29 | PASS |
| 1317.00† | 1295.77 | -166.82 | 63.86 | 1306.57 | 1282.78 | -204.06 | 57.24 | 29.19 | 39.99 | 18.41 | 2.24 | PASS |
| 1319.23 | 1297.86 | -167.55 | 64.14 | 1308.77 | 1284.83 | -204.82 | 57.47 | 29.23 | 40.04 | 18.44 | 2.24 | PASS |
| 1417.00† | 1389.51 | -199.35 | 76.31 | 1405.21 | 1374.15 | -239.54 | 68.22 | 30.11 | 43.78 | 19.76 | 2.28 | PASS |
| 1517.00† | 1483.25 | -231.88 | 88.77 | 1504.08 | 1464.50 | -277.90 | 80.09 | 29.22 | 50.44 | 21.06 | 2.46 | PASS |
| 1617.00† | 1576.99 | -264.41 | 101.22 | 1603.81 | 1555.35 | -317.20 | 92.25 | 28.23 | 57.75 | 21.67 | 2.72 | PASS |
| 1717.00† | 1670.72 | -296.94 | 113.67 | 1703.54 | 1646.19 | -356.51 | 104.42 | 27.47 | 65.08 | 22.15 | 3.00 | PASS |
| 1817.00† | 1764.46 | -329.47 | 126.12 | 1803.26 | 1737.04 | -395.81 | 116.58 | 26.86 | 72.41 | 22.70 | 3.26 | PASS |
| 1917.00† | 1858.20 | -362.00 | 138.58 | 1902.99 | 1827.89 | -435.11 | 128.75 | 26.36 | 79.75 | 23.33 | 3.49 | PASS |
| 2017.00† | 1951.94 | -394.53 | 151.03 | 2002.72 | 1918.73 | -474.41 | 140.91 | 25.95 | 87.10 | 24.04 | 3.70 | PASS |
| 2117.00† | 2045.67 | -427.06 | 163.48 | 2102.45 | 2009.58 | -513.72 | 153.08 | 25.60 | 94.44 | 24.83 | 3.89 | PASS |
| 2217.00† | 2139.41 | -459.59 | 175.93 | 2202.18 | 2100.43 | -553.02 | 165.24 | 25.30 | 101.80 | 25.68 | 4.05 | PASS |
| 2317.00† | 2233.15 | -492.12 | 188.39 | 2301.90 | 2191.27 | -592.32 | 177.41 | 25.04 | 109.15 | 26.59 | 4.19 | PASS |
| 2417.00† | 2326.89 | -524.65 | 200.84 | 2401.63 | 2282.12 | -631.62 | 189.57 | 24.82 | 116.51 | 27.56 | 4.31 | PASS |
| 2517.00† | 2420.62 | -557.18 | 213.29 | 2501.36 | 2372.96 | -670.93 | 201.73 | 24.62 | 123.86 | 28.58 | 4.42 | PASS |
| 2617.00† | 2514.36 | -589.71 | 225.74 | 2601.09 | 2463.81 | -710.23 | 213.90 | 24.44 | 131.22 | 29.65 | 4.51 | PASS |
| 2717.00† | 2608.10 | -622.24 | 238.20 | 2700.82 | 2554.66 | -749.53 | 226.06 | 24.28 | 138.58 | 30.75 | 4.59 | PASS |
| 2817.00† | 2701.84 | -654.77 | 250.65 | 2800.55 | 2645.50 | -788.83 | 238.23 | 24.14 | 145.95 | 31.90 | 4.66 | PASS |
| 2917.00† | 2795.57 | -687.30 | 263.10 | 2900.27 | 2736.35 | -828.14 | 250.39 | 24.01 | 153.31 | 33.07 | 4.72 | PASS |
| 3017.00† | 2889.31 | -719.83 | 275.55 | 3000.00 | 2827.19 | -867.44 | 262.56 | 23.90 | 160.67 | 34.27 | 4.77 | PASS |

| CLEARANCE DATA - Offset Wellbore: STATE ANTELOPE Y44-E14-13HNB PWB Offset Wellpath: STATE ANTELOPE Y44-E14-13HNB PWP (REV-A.0) | | | | | | | | | | | | |
|---|-----------------|--|------------------|-------------------|--------------------|------------------------------------|---------------------|----------------------------|---|---------------------|--------------|---------------|
| Facility: SEC.13-T5N-R62W | | Slot: SLOT#11 STATE ANTELOPE Y44-E14-13HNB (2687'FNL & 510'FEL,SEC.13) | | | | Well: STATE ANTELOPE Y44-E14-13HNB | | | Threshold Value=1.00 † = interpolated/extrapolated station | | | |
| Ref MD [ft] | Ref TVD [ft] | Ref North [ft] | Ref East [ft] | Offset MD [ft] | Offset TVD [ft] | Offset North [ft] | Offset East [ft] | Angle from Highside [°] | C-C Clear Dist [ft] | ACR MASD [ft] | Sep Ratio | ACR Status |
| 3117.00† | 2983.05 | -752.36 | 288.01 | 3099.73 | 2918.04 | -906.74 | 274.72 | 23.79 | 168.03 | 35.50 | 4.81 | PASS |
| 3217.00† | 3076.79 | -784.89 | 300.46 | 3199.46 | 3008.89 | -946.04 | 286.89 | 23.69 | 175.40 | 36.76 | 4.85 | PASS |
| 3317.00† | 3170.52 | -817.42 | 312.91 | 3299.19 | 3099.73 | -985.35 | 299.05 | 23.60 | 182.76 | 38.03 | 4.88 | PASS |
| 3417.00† | 3264.26 | -849.95 | 325.36 | 3398.91 | 3190.58 | -1024.65 | 311.22 | 23.52 | 190.13 | 39.33 | 4.91 | PASS |
| 3517.00† | 3358.00 | -882.48 | 337.82 | 3498.64 | 3281.42 | -1063.95 | 323.38 | 23.44 | 197.49 | 40.64 | 4.93 | PASS |
| 3617.00† | 3451.74 | -915.01 | 350.27 | 3598.37 | 3372.27 | -1103.25 | 335.54 | 23.37 | 204.86 | 41.96 | 4.95 | PASS |
| 3717.00† | 3545.48 | -947.54 | 362.72 | 3698.10 | 3463.12 | -1142.56 | 347.71 | 23.31 | 212.22 | 43.30 | 4.97 | PASS |
| 3817.00† | 3639.21 | -980.07 | 375.18 | 3797.83 | 3553.96 | -1181.86 | 359.87 | 23.25 | 219.59 | 44.66 | 4.98 | PASS |
| 3917.00† | 3732.95 | -1012.60 | 387.63 | 3897.55 | 3644.81 | -1221.16 | 372.04 | 23.19 | 226.96 | 46.02 | 4.99 | PASS |
| 4017.00† | 3826.69 | -1045.13 | 400.08 | 3997.28 | 3735.66 | -1260.46 | 384.20 | 23.13 | 234.32 | 47.40 | 5.00 | PASS |
| 4117.00† | 3920.43 | -1077.66 | 412.53 | 4097.01 | 3826.50 | -1299.77 | 396.37 | 23.08 | 241.69 | 48.78 | 5.01 | PASS |
| 4217.00† | 4014.16 | -1110.19 | 424.99 | 4196.74 | 3917.35 | -1339.07 | 408.53 | 23.04 | 249.06 | 50.18 | 5.02 | PASS |

C-C Clearance Distance Cutoff: 1000.00 ft



Clearance Report
STATE ANTELOPE X44-D14-13HNB PWP (REV-A.0)
Closest Approach
Page 4 of 18



| REFERENCE WELLPATH IDENTIFICATION | | | |
|-----------------------------------|---------------------------|----------|--|
| Operator | BONANZA CREEK OIL COMPANY | Slot | SLOT#10 STATE ANTELOPE X44-D14-13HNB (2667'FNL & 510'FEL,SEC.13) |
| Area | COLORADO | Well | STATE ANTELOPE X44-D14-13HNB |
| Field | WELD COUNTY | Wellbore | STATE ANTELOPE X44-D14-13HNB PWB |
| Facility | SEC.13-T5N-R62W | | |

| CLEARANCE DATA - Offset Wellbore: STATE ANTELOPE Y44-E14-13HNB PWB Offset Wellpath: STATE ANTELOPE Y44-E14-13HNB PWP (REV-A.0) | | | | | | | | | | | | | |
|--|--------------|--|---------------|----------------|-----------------|------------------------------------|------------------|-------------------------|----------------------|---------------|---------------------------------------|------------|--|
| Facility: SEC.13-T5N-R62W | | Slot: SLOT#11 STATE ANTELOPE Y44-E14-13HNB (2687'FNL & 510'FEL,SEC.13) | | | | Well: STATE ANTELOPE Y44-E14-13HNB | | | Threshold Value=1.00 | | † = interpolated/extrapolated station | | |
| Ref MD [ft] | Ref TVD [ft] | Ref North [ft] | Ref East [ft] | Offset MD [ft] | Offset TVD [ft] | Offset North [ft] | Offset East [ft] | Angle from Highside [°] | C-C Clear Dist [ft] | ACR MASD [ft] | Sep Ratio | ACR Status | |
| 4317.00† | 4107.90 | -1142.72 | 437.44 | 4296.47 | 4008.19 | -1378.37 | 420.70 | 22.99 | 256.42 | 51.58 | 5.03 | PASS | |
| 4417.00† | 4201.64 | -1175.25 | 449.89 | 4396.19 | 4099.04 | -1417.67 | 432.86 | 22.95 | 263.79 | 52.99 | 5.03 | PASS | |
| 4517.00† | 4295.38 | -1207.78 | 462.34 | 4495.92 | 4189.89 | -1456.98 | 445.02 | 22.91 | 271.16 | 54.41 | 5.04 | PASS | |
| 4617.00† | 4389.11 | -1240.31 | 474.80 | 4595.65 | 4280.73 | -1496.28 | 457.19 | 22.87 | 278.52 | 55.83 | 5.04 | PASS | |
| 4717.00† | 4482.85 | -1272.84 | 487.25 | 4695.38 | 4371.58 | -1535.58 | 469.35 | 22.83 | 285.89 | 57.26 | 5.04 | PASS | |
| 4817.00† | 4576.59 | -1305.37 | 499.70 | 4795.11 | 4462.42 | -1574.89 | 481.52 | 22.80 | 293.26 | 58.70 | 5.04 | PASS | |
| 4917.00† | 4670.33 | -1337.90 | 512.15 | 4894.83 | 4553.27 | -1614.19 | 493.68 | 22.77 | 300.63 | 60.14 | 5.05 | PASS | |
| 5017.00† | 4764.06 | -1370.43 | 524.61 | 4994.56 | 4644.12 | -1653.49 | 505.85 | 22.74 | 307.99 | 61.59 | 5.05 | PASS | |
| 5117.00† | 4857.80 | -1402.96 | 537.06 | 5094.29 | 4734.96 | -1692.79 | 518.01 | 22.71 | 315.36 | 63.04 | 5.05 | PASS | |
| 5217.00† | 4951.54 | -1435.49 | 549.51 | 5194.02 | 4825.81 | -1732.10 | 530.18 | 22.68 | 322.73 | 64.49 | 5.05 | PASS | |
| 5317.00† | 5045.28 | -1468.02 | 561.96 | 5293.75 | 4916.66 | -1771.40 | 542.34 | 22.65 | 330.10 | 65.95 | 5.05 | PASS | |
| 5417.00† | 5139.01 | -1500.55 | 574.42 | 5393.47 | 5007.50 | -1810.70 | 554.51 | 22.63 | 337.47 | 67.41 | 5.05 | PASS | |
| 5517.00† | 5232.75 | -1533.08 | 586.87 | 5493.20 | 5098.35 | -1850.00 | 566.67 | 22.60 | 344.84 | 68.87 | 5.05 | PASS | |
| 5617.00† | 5326.49 | -1565.61 | 599.32 | 5592.93 | 5189.19 | -1889.31 | 578.83 | 22.58 | 352.20 | 70.34 | 5.05 | PASS | |
| 5717.00† | 5420.23 | -1598.14 | 611.77 | 5692.66 | 5280.04 | -1928.61 | 591.00 | 22.56 | 359.57 | 71.81 | 5.05 | PASS | |
| 5744.75 | 5446.24 | -1607.17 | 615.23 | 5720.33 | 5305.25 | -1939.51 | 594.37 | 22.55 | 361.62 | 72.22 | 5.05 | PASS | |
| 5817.00† | 5514.29 | -1630.90 | 619.69 | 5792.21 | 5370.73 | -1967.84 | 603.14 | 2.40 | 366.63 | 72.43 | 5.10 | PASS | |
| 5917.00† | 5608.11 | -1663.98 | 610.87 | 5889.64 | 5459.48 | -2006.24 | 615.03 | -26.16 | 373.16 | 70.22 | 5.36 | PASS | |
| 6017.00† | 5698.92 | -1696.43 | 584.91 | 5986.16 | 5547.77 | -2044.64 | 620.02 | -47.36 | 381.22 | 67.21 | 5.72 | PASS | |
| 6117.00† | 5783.98 | -1727.26 | 542.60 | 6088.18 | 5640.33 | -2085.41 | 607.74 | -61.33 | 391.34 | 65.88 | 5.99 | PASS | |
| 6217.00† | 5860.68 | -1755.53 | 485.23 | 6196.81 | 5734.80 | -2127.61 | 575.21 | -70.98 | 402.97 | 66.39 | 6.12 | PASS | |
| 6317.00† | 5926.71 | -1780.40 | 414.54 | 6312.99 | 5827.44 | -2169.70 | 519.54 | -77.97 | 415.25 | 68.13 | 6.15 | PASS | |
| 6417.00† | 5980.05 | -1801.09 | 332.68 | 6437.37 | 5912.78 | -2209.35 | 438.58 | -83.12 | 427.10 | 70.33 | 6.12 | PASS | |
| 6517.00† | 6019.09 | -1816.99 | 242.14 | 6569.92 | 5983.60 | -2243.41 | 332.21 | -86.78 | 437.27 | 73.00 | 6.04 | PASS | |
| 6617.00† | 6042.64 | -1827.60 | 145.66 | 6709.52 | 6031.71 | -2268.20 | 203.90 | -89.07 | 444.56 | 76.78 | 5.83 | PASS | |
| 6711.65 | 6050.00 | -1832.49 | 51.53 | 6845.99 | 6049.82 | -2280.06 | 69.48 | -89.98 | 447.94 | 82.00 | 5.50 | PASS | |
| 6717.00† | 6050.00 | -1832.62 | 46.19 | 6853.76 | 6049.96 | -2280.36 | 61.71 | -89.99 | 448.00 | 82.34 | 5.48 | PASS | |
| 6817.00† | 6050.00 | -1835.07 | -53.78 | 6956.08 | 6050.00 | -2283.39 | -40.56 | -90.00 | 448.51 | 87.83 | 5.14 | PASS | |
| 6917.00† | 6050.00 | -1837.52 | -153.75 | 7056.08 | 6050.00 | -2286.34 | -140.51 | -90.00 | 449.01 | 94.16 | 4.80 | PASS | |
| 7017.00† | 6050.00 | -1839.98 | -253.72 | 7156.07 | 6050.00 | -2289.29 | -240.47 | -90.00 | 449.51 | 101.29 | 4.46 | PASS | |
| 7117.00† | 6050.00 | -1842.43 | -353.69 | 7256.07 | 6050.00 | -2292.24 | -340.42 | -90.00 | 450.01 | 107.95 | 4.19 | PASS | |
| 7217.00† | 6050.00 | -1844.88 | -453.66 | 7356.07 | 6050.00 | -2295.19 | -440.38 | -90.00 | 450.50 | 117.30 | 3.86 | PASS | |
| 7317.00† | 6050.00 | -1847.33 | -553.63 | 7456.07 | 6050.00 | -2298.14 | -540.33 | -90.00 | 451.00 | 125.96 | 3.60 | PASS | |

| CLEARANCE DATA - Offset Wellbore: STATE ANTELOPE Y44-E14-13HNB PWB Offset Wellpath: STATE ANTELOPE Y44-E14-13HNB PWP (REV-A.0) | | | | | | | | | | | | |
|---|-----------------|--|------------------|-------------------|--------------------|------------------------------------|---------------------|----------------------------|---|---------------------|--------------|---------------|
| Facility: SEC.13-T5N-R62W | | Slot: SLOT#11 STATE ANTELOPE Y44-E14-13HNB (2687'FNL & 510'FEL,SEC.13) | | | | Well: STATE ANTELOPE Y44-E14-13HNB | | | Threshold Value=1.00 † = interpolated/extrapolated station | | | |
| Ref MD [ft] | Ref TVD [ft] | Ref North [ft] | Ref East [ft] | Offset MD [ft] | Offset TVD [ft] | Offset North [ft] | Offset East [ft] | Angle from Highside [°] | C-C Clear Dist [ft] | ACR MASD [ft] | Sep Ratio | ACR Status |
| 7417.00† | 6050.00 | -1849.79 | -653.60 | 7556.07 | 6050.00 | -2301.09 | -640.29 | -90.00 | 451.50 | 134.93 | 3.36 | PASS |
| 7517.00† | 6050.00 | -1852.24 | -753.57 | 7656.07 | 6050.00 | -2304.04 | -740.24 | -90.00 | 452.00 | 144.17 | 3.15 | PASS |
| 7617.00† | 6050.00 | -1854.69 | -853.54 | 7756.07 | 6050.00 | -2306.99 | -840.20 | -90.00 | 452.49 | 153.62 | 2.95 | PASS |
| 7717.00† | 6050.00 | -1857.14 | -953.51 | 7856.07 | 6050.00 | -2309.94 | -940.15 | -90.00 | 452.99 | 163.26 | 2.78 | PASS |
| 7817.00† | 6050.00 | -1859.60 | -1053.48 | 7956.06 | 6050.00 | -2312.88 | -1040.11 | -90.00 | 453.49 | 173.06 | 2.63 | PASS |
| 7917.00† | 6050.00 | -1862.05 | -1153.45 | 8056.06 | 6050.00 | -2315.83 | -1140.06 | -90.00 | 453.98 | 182.98 | 2.49 | PASS |
| 8017.00† | 6050.00 | -1864.50 | -1253.42 | 8156.06 | 6050.00 | -2318.78 | -1240.02 | -90.00 | 454.48 | 193.01 | 2.36 | PASS |
| 8117.00† | 6050.00 | -1866.95 | -1353.39 | 8256.06 | 6050.00 | -2321.73 | -1339.97 | -90.00 | 454.98 | 203.13 | 2.24 | PASS |
| 8217.00† | 6050.00 | -1869.40 | -1453.36 | 8356.06 | 6050.00 | -2324.68 | -1439.93 | -90.00 | 455.48 | 213.33 | 2.14 | PASS |
| 8317.00† | 6050.00 | -1871.86 | -1553.33 | 8456.06 | 6050.00 | -2327.63 | -1539.88 | -90.00 | 455.97 | 223.59 | 2.04 | PASS |
| 8417.00† | 6050.00 | -1874.31 | -1653.30 | 8556.06 | 6050.00 | -2330.58 | -1639.84 | -90.00 | 456.47 | 233.90 | 1.95 | PASS |
| 8517.00† | 6050.00 | -1876.76 | -1753.27 | 8656.06 | 6050.00 | -2333.53 | -1739.80 | -90.00 | 456.97 | 244.27 | 1.87 | PASS |

C-C Clearance Distance Cutoff: 1000.00 ft



Clearance Report
STATE ANTELOPE X44-D14-13HNB PWP (REV-A.0)
Closest Approach
Page 5 of 18



| REFERENCE WELLPATH IDENTIFICATION | | | |
|-----------------------------------|---------------------------|----------|--|
| Operator | BONANZA CREEK OIL COMPANY | Slot | SLOT#10 STATE ANTELOPE X44-D14-13HNB (2667'FNL & 510'FEL,SEC.13) |
| Area | COLORADO | Well | STATE ANTELOPE X44-D14-13HNB |
| Field | WELD COUNTY | Wellbore | STATE ANTELOPE X44-D14-13HNB PWB |
| Facility | SEC.13-T5N-R62W | | |

| CLEARANCE DATA - Offset Wellbore: STATE ANTELOPE Y44-E14-13HNB PWB Offset Wellpath: STATE ANTELOPE Y44-E14-13HNB PWP (REV-A.0) | | | | | | | | | | | | | |
|--|-----------------|--|------------------|-------------------|--------------------|------------------------------------|---------------------|----------------------------|---------------------------|---------------------|---------------------------------------|---------------|--|
| Facility: SEC.13-T5N-R62W | | Slot: SLOT#11 STATE ANTELOPE Y44-E14-13HNB (2687'FNL & 510'FEL,SEC.13) | | | | Well: STATE ANTELOPE Y44-E14-13HNB | | | Threshold Value=1.00 | | † = interpolated/extrapolated station | | |
| Ref MD [ft] | Ref TVD [ft] | Ref North [ft] | Ref East [ft] | Offset MD [ft] | Offset TVD [ft] | Offset North [ft] | Offset East [ft] | Angle from Highside [°] | C-C Clear Dist [ft] | ACR MASD [ft] | Sep Ratio | ACR Status | |
| 8617.00† | 6050.00 | -1879.21 | -1853.24 | 8756.05 | 6050.00 | -2336.48 | -1839.75 | -90.00 | 457.47 | 254.68 | 1.80 | PASS | |
| 8717.00† | 6050.00 | -1881.67 | -1953.21 | 8856.05 | 6050.00 | -2339.43 | -1939.71 | -90.00 | 457.96 | 265.13 | 1.73 | PASS | |
| 8817.00† | 6050.00 | -1884.12 | -2053.18 | 8956.05 | 6050.00 | -2342.38 | -2039.66 | -90.00 | 458.46 | 275.61 | 1.67 | PASS | |
| 8917.00† | 6050.00 | -1886.57 | -2153.15 | 9056.05 | 6050.00 | -2345.33 | -2139.62 | -90.00 | 458.96 | 286.13 | 1.61 | PASS | |
| 9017.00† | 6050.00 | -1889.02 | -2253.12 | 9156.05 | 6050.00 | -2348.28 | -2239.57 | -90.00 | 459.45 | 296.67 | 1.55 | PASS | |
| 9117.00† | 6050.00 | -1891.47 | -2353.09 | 9256.05 | 6050.00 | -2351.23 | -2339.53 | -90.00 | 459.95 | 307.23 | 1.50 | PASS | |
| 9217.00† | 6050.00 | -1893.93 | -2453.06 | 9356.05 | 6050.00 | -2354.17 | -2439.48 | -90.00 | 460.45 | 317.82 | 1.45 | PASS | |
| 9317.00† | 6050.00 | -1896.38 | -2553.03 | 9456.05 | 6050.00 | -2357.12 | -2539.44 | -90.00 | 460.95 | 328.43 | 1.40 | PASS | |
| 9417.00† | 6050.00 | -1898.83 | -2653.00 | 9556.04 | 6050.00 | -2360.07 | -2639.39 | -90.00 | 461.44 | 339.05 | 1.36 | PASS | |
| 9517.00† | 6050.00 | -1901.28 | -2752.97 | 9656.04 | 6050.00 | -2363.02 | -2739.35 | -90.00 | 461.94 | 349.70 | 1.32 | PASS | |
| 9617.00† | 6050.00 | -1903.74 | -2852.94 | 9756.04 | 6050.00 | -2365.97 | -2839.30 | -90.00 | 462.44 | 360.35 | 1.28 | PASS | |
| 9717.00† | 6050.00 | -1906.19 | -2952.91 | 9856.04 | 6050.00 | -2368.92 | -2939.26 | -90.00 | 462.94 | 371.02 | 1.25 | PASS | |
| 9817.00† | 6050.00 | -1908.64 | -3052.88 | 9956.04 | 6050.00 | -2371.87 | -3039.21 | -90.00 | 463.43 | 381.71 | 1.21 | PASS | |
| 9917.00† | 6050.00 | -1911.09 | -3152.85 | 10056.04 | 6050.00 | -2374.82 | -3139.17 | -90.00 | 463.93 | 392.40 | 1.18 | PASS | |
| 10017.00† | 6050.00 | -1913.54 | -3252.82 | 10156.04 | 6050.00 | -2377.77 | -3239.12 | -90.00 | 464.43 | 403.11 | 1.15 | PASS | |
| 10117.00† | 6050.00 | -1916.00 | -3352.79 | 10256.04 | 6050.00 | -2380.72 | -3339.08 | -90.00 | 464.92 | 413.82 | 1.12 | PASS | |
| 10217.00† | 6050.00 | -1918.45 | -3452.76 | 10356.03 | 6050.00 | -2383.67 | -3439.03 | -90.00 | 465.42 | 424.55 | 1.10 | PASS | |
| 10317.00† | 6050.00 | -1920.90 | -3552.73 | 10456.03 | 6050.00 | -2386.62 | -3538.99 | -90.00 | 465.92 | 435.28 | 1.07 | PASS | |
| 10417.00† | 6050.00 | -1923.35 | -3652.70 | 10556.03 | 6050.00 | -2389.57 | -3638.95 | -90.00 | 466.42 | 446.02 | 1.05 | PASS | |
| 10517.00† | 6050.00 | -1925.81 | -3752.67 | 10656.03 | 6050.00 | -2392.52 | -3738.90 | -90.00 | 466.91 | 456.77 | 1.02 | PASS | |
| 10617.00† | 6050.00 | -1928.26 | -3852.64 | 10756.03 | 6050.00 | -2395.47 | -3838.86 | -90.00 | 467.41 | 467.52 | 1.00 | FAIL | |
| 10717.00† | 6050.00 | -1930.71 | -3952.61 | 10856.03 | 6050.00 | -2398.41 | -3938.81 | -90.00 | 467.91 | 478.28 | 0.98 | FAIL | |
| 10817.00† | 6050.00 | -1933.16 | -4052.58 | 10956.03 | 6050.00 | -2401.36 | -4038.77 | -90.00 | 468.40 | 489.05 | 0.96 | FAIL | |
| 10917.00† | 6050.00 | -1935.61 | -4152.55 | 11056.03 | 6050.00 | -2404.31 | -4138.72 | -90.00 | 468.90 | 499.82 | 0.94 | FAIL | |
| 11017.00† | 6050.00 | -1938.07 | -4252.52 | 11156.02 | 6050.00 | -2407.26 | -4238.68 | -90.00 | 469.40 | 510.59 | 0.92 | FAIL | |
| 11117.00† | 6050.00 | -1940.52 | -4352.49 | 11256.02 | 6050.00 | -2410.21 | -4338.63 | -90.00 | 469.90 | 521.38 | 0.90 | FAIL | |
| 11217.00† | 6050.00 | -1942.97 | -4452.46 | 11356.02 | 6050.00 | -2413.16 | -4438.59 | -90.00 | 470.39 | 532.16 | 0.88 | FAIL | |
| 11317.00† | 6050.00 | -1945.42 | -4552.43 | 11456.02 | 6050.00 | -2416.11 | -4538.54 | -90.00 | 470.89 | 542.95 | 0.87 | FAIL | |
| 11417.00† | 6050.00 | -1947.88 | -4652.40 | 11556.02 | 6050.00 | -2419.06 | -4638.50 | -90.00 | 471.39 | 553.75 | 0.85 | FAIL | |
| 11517.00† | 6050.00 | -1950.33 | -4752.37 | 11656.02 | 6050.00 | -2422.01 | -4738.45 | -90.00 | 471.89 | 564.55 | 0.84 | FAIL | |
| 11521.25 | 6050.00 | -1950.43 | -4756.62 | 11660.27 | 6050.00 | -2422.13 | -4742.70 | -90.00 | 471.91 | 565.00 | 0.84 | FAIL | |

C-C Clearance Distance Cutoff: 1000.00 ft

| POSITIONAL UNCERTAINTY - Offset Wellbore: STATE ANTELOPE Y44-E14-13HNB PWB Offset Wellpath: STATE ANTELOPE Y44-E14-13HNB PWP (REV-A.0) | | | | |
|---|------------|---------|----------|---------|
| Slot Surface Uncertainty @1SD | Horizontal | 0.100ft | Vertical | 1.000ft |
| Facility Surface Uncertainty @1SD | Horizontal | 8.200ft | Vertical | 3.000ft |

| HOLE & CASING SECTIONS - Offset Wellbore: STATE ANTELOPE Y44-E14-13HNB PWB Offset Wellpath: STATE ANTELOPE Y44-E14-13HNB PWP (REV-A.0) | | | | | | | | | |
|---|------------------|----------------|------------------|-------------------|-----------------|-------------------|-------------------|-----------------|-----------------|
| String/Diameter | Start MD [ft] | End MD [ft] | Interval [ft] | Start TVD [ft] | End TVD [ft] | Start N/S [ft] | Start E/W [ft] | End N/S [ft] | End E/W [ft] |
| 13.5in Open Hole | 17.00 | 1550.00 | 1533.00 | 17.00 | 1506.33 | -12.21 | 0.17 | -96.33 | 26.20 |
| 9.625in Casing Surface | 17.00 | 1550.00 | 1533.00 | 17.00 | 1506.33 | -12.21 | 0.17 | -96.33 | 26.20 |
| 8.5in Open Hole | 1550.00 | 11675.40 | 10125.40 | 1506.33 | N/A | -96.33 | 26.20 | N/A | N/A |



Clearance Report

STATE ANTELOPE X44-D14-13HNB PWP (REV-A.0)

Closest Approach

Page 6 of 18



| REFERENCE WELLPATH IDENTIFICATION | | | |
|-----------------------------------|---------------------------|----------|--|
| Operator | BONANZA CREEK OIL COMPANY | Slot | SLOT#10 STATE ANTELOPE X44-D14-13HNB (2667'FNL & 510'FEL,SEC.13) |
| Area | COLORADO | Well | STATE ANTELOPE X44-D14-13HNB |
| Field | WELD COUNTY | Wellbore | STATE ANTELOPE X44-D14-13HNB PWB |
| Facility | SEC.13-T5N-R62W | | |

| SURVEY PROGRAM - Offset Wellbore: STATE ANTELOPE Y44-E14-13HNB PWB Offset Wellpath: STATE ANTELOPE Y44-E14-13HNB PWP (REV-A.0) | | | | |
|---|----------------|------------------------------|------------------|----------------------------------|
| Start MD [ft] | End MD [ft] | Positional Uncertainty Model | Log Name/Comment | Wellbore |
| 17.00 | 1550.00 | BHI NaviTrak (Rotating) | | STATE ANTELOPE Y44-E14-13HNB PWB |
| 1550.00 | 11675.40 | BHI AutoTrak Curve (Short) | | STATE ANTELOPE Y44-E14-13HNB PWB |

| OFFSET WELLPATH REFERENCE - Offset Wellbore: STATE ANTELOPE Y44-E14-13HNB PWB Offset Wellpath: STATE ANTELOPE Y44-E14-13HNB PWP (REV-A.0) | |
|--|---|
| MD Reference: RIG (17') (RKB) | Offset TVD & local coordinates use Reference Wellpath settings (See WELLPATH DATUM on page 1 of this report) |
| Ellipse Start MD | 17.00ft |



Clearance Report
STATE ANTELOPE X44-D14-13HNB PWP (REV-A.0)
Closest Approach
Page 8 of 18



| REFERENCE WELLPATH IDENTIFICATION | | | |
|-----------------------------------|---------------------------|----------|--|
| Operator | BONANZA CREEK OIL COMPANY | Slot | SLOT#10 STATE ANTELOPE X44-D14-13HNB (2667'FNL & 510'FEL,SEC.13) |
| Area | COLORADO | Well | STATE ANTELOPE X44-D14-13HNB |
| Field | WELD COUNTY | Wellbore | STATE ANTELOPE X44-D14-13HNB PWB |
| Facility | SEC.13-T5N-R62W | | |

| CLEARANCE DATA - Offset Wellbore: STATE ANTELOPE Y-E-13HNB PWB Offset Wellpath: STATE ANTELOPE Y-E-13HNB PWP (REV-A.0) | | | | | | | | | | | | | |
|--|-----------------|--|------------------|-------------------|--------------------|--------------------------------|---------------------|----------------------------|---------------------------|---------------------------------------|--------------|---------------|--|
| Facility: SEC.13-T5N-R62W | | Slot: SLOT#12 STATE ANTELOPE Y-E-13HNB (2699'FSL & 510'FEL,SEC.13) | | | | Well: STATE ANTELOPE Y-E-13HNB | | Threshold Value=1.00 | | † = interpolated/extrapolated station | | | |
| Ref MD [ft] | Ref TVD [ft] | Ref North [ft] | Ref East [ft] | Offset MD [ft] | Offset TVD [ft] | Offset North [ft] | Offset East [ft] | Angle from Highside [°] | C-C Clear Dist [ft] | ACR MASD [ft] | Sep Ratio | ACR Status | |
| 4317.00† | 4107.90 | -1142.72 | 437.44 | 4246.35 | 3842.59 | -1538.91 | 686.09 | -9.83 | 537.76 | 45.05 | 12.11 | PASS | |
| 4417.00† | 4201.64 | -1175.25 | 449.89 | 4344.97 | 3928.20 | -1583.45 | 706.47 | -9.87 | 554.28 | 46.33 | 12.13 | PASS | |
| 4517.00† | 4295.38 | -1207.78 | 462.34 | 4443.60 | 4013.80 | -1627.98 | 726.85 | -9.90 | 570.80 | 47.63 | 12.15 | PASS | |
| 4617.00† | 4389.11 | -1240.31 | 474.80 | 4542.22 | 4099.41 | -1672.52 | 747.23 | -9.93 | 587.33 | 48.93 | 12.17 | PASS | |
| 4717.00† | 4482.85 | -1272.84 | 487.25 | 4640.85 | 4185.01 | -1717.05 | 767.61 | -9.96 | 603.85 | 50.23 | 12.18 | PASS | |
| 4817.00† | 4576.59 | -1305.37 | 499.70 | 4739.47 | 4270.62 | -1761.59 | 787.98 | -9.99 | 620.37 | 51.55 | 12.19 | PASS | |
| 4917.00† | 4670.33 | -1337.90 | 512.15 | 4838.10 | 4356.22 | -1806.13 | 808.36 | -10.02 | 636.89 | 52.87 | 12.20 | PASS | |
| 5017.00† | 4764.06 | -1370.43 | 524.61 | 4936.72 | 4441.83 | -1850.66 | 828.74 | -10.04 | 653.42 | 54.20 | 12.20 | PASS | |
| 5117.00† | 4857.80 | -1402.96 | 537.06 | 5035.35 | 4527.43 | -1895.20 | 849.12 | -10.06 | 669.94 | 55.53 | 12.21 | PASS | |
| 5217.00† | 4951.54 | -1435.49 | 549.51 | 5133.97 | 4613.04 | -1939.73 | 869.50 | -10.09 | 686.46 | 56.87 | 12.21 | PASS | |
| 5317.00† | 5045.28 | -1468.02 | 561.96 | 5232.60 | 4698.64 | -1984.27 | 889.87 | -10.11 | 702.99 | 58.21 | 12.21 | PASS | |
| 5417.00† | 5139.01 | -1500.55 | 574.42 | 5331.22 | 4784.25 | -2028.81 | 910.25 | -10.13 | 719.51 | 59.56 | 12.21 | PASS | |
| 5517.00† | 5232.75 | -1533.08 | 586.87 | 5429.85 | 4869.85 | -2073.34 | 930.63 | -10.15 | 736.04 | 60.91 | 12.21 | PASS | |
| 5617.00† | 5326.49 | -1565.61 | 599.32 | 5528.47 | 4955.46 | -2117.88 | 951.01 | -10.17 | 752.56 | 62.26 | 12.21 | PASS | |
| 5717.00† | 5420.23 | -1598.14 | 611.77 | 5627.10 | 5041.06 | -2162.41 | 971.39 | -10.18 | 769.08 | 63.62 | 12.21 | PASS | |
| 5744.75 | 5446.24 | -1607.17 | 615.23 | 5654.46 | 5064.81 | -2174.77 | 977.04 | -10.19 | 773.67 | 64.00 | 12.21 | PASS | |
| 5817.00† | 5514.29 | -1630.90 | 619.69 | 5725.17 | 5126.18 | -2206.70 | 991.65 | -29.16 | 787.73 | 65.23 | 12.20 | PASS | |
| 5917.00† | 5608.11 | -1663.98 | 610.87 | 5819.72 | 5208.25 | -2249.39 | 1011.19 | -54.10 | 814.16 | 67.93 | 12.10 | PASS | |
| 6017.00† | 5698.92 | -1696.43 | 584.91 | 5907.83 | 5284.73 | -2289.18 | 1029.39 | -70.44 | 848.81 | 71.92 | 11.91 | PASS | |
| 6117.00† | 5783.98 | -1727.26 | 542.60 | 5986.84 | 5353.31 | -2324.86 | 1045.72 | -79.21 | 892.04 | 76.98 | 11.69 | PASS | |
| 6217.00† | 5860.68 | -1755.53 | 485.23 | 6054.33 | 5411.89 | -2355.34 | 1059.66 | -82.86 | 944.01 | 83.03 | 11.46 | PASS | |
| 6317.00† | 5926.71 | -1780.40 | 414.54 | 7174.33 | 6050.00 | -2714.01 | 447.14 | -87.28 | 942.28 | 83.36 | 11.39 | PASS | |
| 6417.00† | 5980.05 | -1801.09 | 332.68 | 7256.86 | 6050.00 | -2716.89 | 364.66 | -89.25 | 919.02 | 87.13 | 10.63 | PASS | |
| 6517.00† | 6019.09 | -1816.99 | 242.14 | 7347.91 | 6050.00 | -2720.06 | 273.68 | -89.96 | 904.16 | 91.61 | 9.94 | PASS | |
| 6617.00† | 6042.64 | -1827.60 | 145.66 | 7444.69 | 6050.00 | -2723.44 | 176.95 | -90.07 | 896.42 | 96.80 | 9.32 | PASS | |
| 6711.65 | 6050.00 | -1832.49 | 51.53 | 7538.94 | 6050.00 | -2726.73 | 82.76 | -90.00 | 894.79 | 102.26 | 8.80 | PASS | |
| 6717.00† | 6050.00 | -1832.62 | 46.19 | 7544.28 | 6050.00 | -2726.92 | 77.42 | -90.00 | 894.84 | 102.58 | 8.78 | PASS | |
| 6817.00† | 6050.00 | -1835.07 | -53.78 | 7644.28 | 6050.00 | -2730.41 | -22.52 | -90.00 | 895.88 | 108.94 | 8.27 | PASS | |
| 6917.00† | 6050.00 | -1837.52 | -153.75 | 7744.27 | 6050.00 | -2733.90 | -122.45 | -90.00 | 896.92 | 116.21 | 7.76 | PASS | |
| 7017.00† | 6050.00 | -1839.98 | -253.72 | 7844.27 | 6050.00 | -2737.39 | -222.38 | -90.00 | 897.96 | 123.69 | 7.30 | PASS | |
| 7117.00† | 6050.00 | -1842.43 | -353.69 | 7944.26 | 6050.00 | -2740.88 | -322.32 | -90.00 | 899.00 | 131.84 | 6.85 | PASS | |
| 7217.00† | 6050.00 | -1844.88 | -453.66 | 8044.26 | 6050.00 | -2744.37 | -422.25 | -90.00 | 900.04 | 140.37 | 6.44 | PASS | |
| 7317.00† | 6050.00 | -1847.33 | -553.63 | 8144.25 | 6050.00 | -2747.86 | -522.19 | -90.00 | 901.07 | 149.23 | 6.06 | PASS | |
| | | | | | | | | | | | | | |

| CLEARANCE DATA - Offset Wellbore: STATE ANTELOPE Y-E-13HNB PWB Offset Wellpath: STATE ANTELOPE Y-E-13HNB PWP (REV-A.0) | | | | | | | | | | | | |
|---|-----------------|--|------------------|-------------------|--------------------|--------------------------------|---------------------|----------------------------|---------------------------|---------------------------------------|--------------|---------------|
| Facility: SEC.13-T5N-R62W | | Slot: SLOT#12 STATE ANTELOPE Y-E-13HNB (2699'FSL & 510'FEL,SEC.13) | | | | Well: STATE ANTELOPE Y-E-13HNB | | Threshold Value=1.00 | | † = interpolated/extrapolated station | | |
| Ref MD [ft] | Ref TVD [ft] | Ref North [ft] | Ref East [ft] | Offset MD [ft] | Offset TVD [ft] | Offset North [ft] | Offset East [ft] | Angle from Highside [°] | C-C Clear Dist [ft] | ACR MASD [ft] | Sep Ratio | ACR Status |
| 7417.00† | 6050.00 | -1849.79 | -653.60 | 8244.25 | 6050.00 | -2751.35 | -622.12 | -90.00 | 902.11 | 158.31 | 5.72 | PASS |
| 7517.00† | 6050.00 | -1852.24 | -753.57 | 8344.24 | 6050.00 | -2754.84 | -722.05 | -90.00 | 903.15 | 167.57 | 5.41 | PASS |
| 7617.00† | 6050.00 | -1854.69 | -853.54 | 8444.24 | 6050.00 | -2758.33 | -821.99 | -90.00 | 904.19 | 177.17 | 5.12 | PASS |
| 7717.00† | 6050.00 | -1857.14 | -953.51 | 8544.23 | 6050.00 | -2761.82 | -921.92 | -90.00 | 905.23 | 186.87 | 4.86 | PASS |
| 7817.00† | 6050.00 | -1859.60 | -1053.48 | 8644.23 | 6050.00 | -2765.31 | -1021.85 | -90.00 | 906.27 | 196.69 | 4.62 | PASS |
| 7917.00† | 6050.00 | -1862.05 | -1153.45 | 8744.22 | 6050.00 | -2768.80 | -1121.79 | -90.00 | 907.30 | 206.60 | 4.40 | PASS |
| 8017.00† | 6050.00 | -1864.50 | -1253.42 | 8844.21 | 6050.00 | -2772.29 | -1221.72 | -90.00 | 908.34 | 216.61 | 4.20 | PASS |
| 8117.00† | 6050.00 | -1866.95 | -1353.39 | 8944.21 | 6050.00 | -2775.78 | -1321.65 | -90.00 | 909.38 | 226.70 | 4.02 | PASS |
| 8217.00† | 6050.00 | -1869.40 | -1453.36 | 9044.20 | 6050.00 | -2779.27 | -1421.59 | -90.00 | 910.42 | 236.86 | 3.85 | PASS |
| 8317.00† | 6050.00 | -1871.86 | -1553.33 | 9144.20 | 6050.00 | -2782.76 | -1521.52 | -90.00 | 911.46 | 247.09 | 3.70 | PASS |
| 8417.00† | 6050.00 | -1874.31 | -1653.30 | 9244.19 | 6050.00 | -2786.25 | -1621.46 | -90.00 | 912.50 | 257.37 | 3.55 | PASS |
| 8517.00† | 6050.00 | -1876.76 | -1753.27 | 9344.19 | 6050.00 | -2789.74 | -1721.39 | -90.00 | 913.53 | 267.69 | 3.42 | PASS |

C-C Clearance Distance Cutoff: 1000.00 ft



Clearance Report
STATE ANTELOPE X44-D14-13HNB PWP (REV-A.0)
Closest Approach
Page 9 of 18



| REFERENCE WELLPATH IDENTIFICATION | | | |
|-----------------------------------|---------------------------|----------|--|
| Operator | BONANZA CREEK OIL COMPANY | Slot | SLOT#10 STATE ANTELOPE X44-D14-13HNB (2667'FNL & 510'FEL,SEC.13) |
| Area | COLORADO | Well | STATE ANTELOPE X44-D14-13HNB |
| Field | WELD COUNTY | Wellbore | STATE ANTELOPE X44-D14-13HNB PWB |
| Facility | SEC.13-T5N-R62W | | |

| CLEARANCE DATA - Offset Wellbore: STATE ANTELOPE Y-E-13HNB PWB Offset Wellpath: STATE ANTELOPE Y-E-13HNB PWP (REV-A.0) | | | | | | | | | | | | |
|--|-----------------|--|------------------|-------------------|--------------------------------|----------------------|---------------------|----------------------------|---------------------------|---------------------------------------|--------------|---------------|
| Facility: SEC.13-T5N-R62W | | Slot: SLOT#12 STATE ANTELOPE Y-E-13HNB (2699'FSL & 510'FEL,SEC.13) | | | Well: STATE ANTELOPE Y-E-13HNB | | | Threshold Value=1.00 | | † = interpolated/extrapolated station | | |
| Ref MD [ft] | Ref TVD [ft] | Ref North [ft] | Ref East [ft] | Offset MD [ft] | Offset TVD [ft] | Offset North [ft] | Offset East [ft] | Angle from Highside [°] | C-C Clear Dist [ft] | ACR MASD [ft] | Sep Ratio | ACR Status |
| 8617.00† | 6050.00 | -1879.21 | -1853.24 | 9444.18 | 6050.00 | -2793.23 | -1821.32 | -90.00 | 914.57 | 278.06 | 3.29 | PASS |
| 8717.00† | 6050.00 | -1881.67 | -1953.21 | 9544.18 | 6050.00 | -2796.72 | -1921.26 | -90.00 | 915.61 | 288.47 | 3.18 | PASS |
| 8817.00† | 6050.00 | -1884.12 | -2053.18 | 9644.17 | 6050.00 | -2800.21 | -2021.19 | -90.00 | 916.65 | 298.91 | 3.07 | PASS |
| 8917.00† | 6050.00 | -1886.57 | -2153.15 | 9744.17 | 6050.00 | -2803.70 | -2121.12 | -90.00 | 917.69 | 309.38 | 2.97 | PASS |
| 9017.00† | 6050.00 | -1889.02 | -2253.12 | 9844.16 | 6050.00 | -2807.19 | -2221.06 | -90.00 | 918.73 | 319.88 | 2.88 | PASS |
| 9117.00† | 6050.00 | -1891.47 | -2353.09 | 9944.16 | 6050.00 | -2810.68 | -2320.99 | -90.00 | 919.76 | 330.40 | 2.79 | PASS |
| 9217.00† | 6050.00 | -1893.93 | -2453.06 | 10044.15 | 6050.00 | -2814.17 | -2420.93 | -90.00 | 920.80 | 340.95 | 2.70 | PASS |
| 9317.00† | 6050.00 | -1896.38 | -2553.03 | 10144.14 | 6050.00 | -2817.66 | -2520.86 | -90.00 | 921.84 | 351.52 | 2.63 | PASS |
| 9417.00† | 6050.00 | -1898.83 | -2653.00 | 10244.14 | 6050.00 | -2821.15 | -2620.79 | -90.00 | 922.88 | 362.11 | 2.55 | PASS |
| 9517.00† | 6050.00 | -1901.28 | -2752.97 | 10344.13 | 6050.00 | -2824.64 | -2720.73 | -90.00 | 923.92 | 372.71 | 2.48 | PASS |
| 9617.00† | 6050.00 | -1903.74 | -2852.94 | 10444.13 | 6050.00 | -2828.13 | -2820.66 | -90.00 | 924.96 | 383.33 | 2.42 | PASS |
| 9717.00† | 6050.00 | -1906.19 | -2952.91 | 10544.12 | 6050.00 | -2831.62 | -2920.59 | -90.00 | 925.99 | 393.97 | 2.35 | PASS |
| 9817.00† | 6050.00 | -1908.64 | -3052.88 | 10644.12 | 6050.00 | -2835.11 | -3020.53 | -90.00 | 927.03 | 404.62 | 2.29 | PASS |
| 9917.00† | 6050.00 | -1911.09 | -3152.85 | 10744.11 | 6050.00 | -2838.60 | -3120.46 | -90.00 | 928.07 | 415.28 | 2.24 | PASS |
| 10017.00† | 6050.00 | -1913.54 | -3252.82 | 10844.11 | 6050.00 | -2842.09 | -3220.39 | -90.00 | 929.11 | 425.95 | 2.18 | PASS |
| 10117.00† | 6050.00 | -1916.00 | -3352.79 | 10944.10 | 6050.00 | -2845.58 | -3320.33 | -90.00 | 930.15 | 436.63 | 2.13 | PASS |
| 10217.00† | 6050.00 | -1918.45 | -3452.76 | 11044.10 | 6050.00 | -2849.07 | -3420.26 | -90.00 | 931.19 | 447.33 | 2.08 | PASS |
| 10317.00† | 6050.00 | -1920.90 | -3552.73 | 11144.09 | 6050.00 | -2852.56 | -3520.20 | -90.00 | 932.22 | 458.03 | 2.04 | PASS |
| 10417.00† | 6050.00 | -1923.35 | -3652.70 | 11244.09 | 6050.00 | -2856.05 | -3620.13 | -90.00 | 933.26 | 468.74 | 1.99 | PASS |
| 10517.00† | 6050.00 | -1925.81 | -3752.67 | 11344.08 | 6050.00 | -2859.54 | -3720.06 | -90.00 | 934.30 | 479.46 | 1.95 | PASS |
| 10617.00† | 6050.00 | -1928.26 | -3852.64 | 11444.07 | 6050.00 | -2863.03 | -3820.00 | -90.00 | 935.34 | 490.18 | 1.91 | PASS |
| 10717.00† | 6050.00 | -1930.71 | -3952.61 | 11544.07 | 6050.00 | -2866.52 | -3919.93 | -90.00 | 936.38 | 500.92 | 1.87 | PASS |
| 10817.00† | 6050.00 | -1933.16 | -4052.58 | 11644.06 | 6050.00 | -2870.01 | -4019.86 | -90.00 | 937.42 | 511.66 | 1.83 | PASS |
| 10917.00† | 6050.00 | -1935.61 | -4152.55 | 11744.06 | 6050.00 | -2873.50 | -4119.80 | -90.00 | 938.45 | 522.40 | 1.80 | PASS |
| 11017.00† | 6050.00 | -1938.07 | -4252.52 | 11844.05 | 6050.00 | -2876.99 | -4219.73 | -90.00 | 939.49 | 533.15 | 1.76 | PASS |
| 11117.00† | 6050.00 | -1940.52 | -4352.49 | 11944.05 | 6050.00 | -2880.48 | -4319.67 | -90.00 | 940.53 | 543.91 | 1.73 | PASS |
| 11217.00† | 6050.00 | -1942.97 | -4452.46 | 12044.04 | 6050.00 | -2883.97 | -4419.60 | -90.00 | 941.57 | 554.67 | 1.70 | PASS |
| 11317.00† | 6050.00 | -1945.42 | -4552.43 | 12144.04 | 6050.00 | -2887.46 | -4519.53 | -90.00 | 942.61 | 565.44 | 1.67 | PASS |
| 11417.00† | 6050.00 | -1947.88 | -4652.40 | 12244.03 | 6050.00 | -2890.95 | -4619.47 | -90.00 | 943.65 | 576.21 | 1.64 | PASS |
| 11517.00† | 6050.00 | -1950.33 | -4752.37 | 12344.03 | 6050.00 | -2894.44 | -4719.40 | -90.00 | 944.68 | 586.99 | 1.61 | PASS |
| 11521.25 | 6050.00 | -1950.43 | -4756.62 | 12348.27 | 6050.00 | -2894.59 | -4723.64 | -90.00 | 944.73 | 587.44 | 1.61 | PASS |

C-C Clearance Distance Cutoff: 1000.00 ft

| POSITIONAL UNCERTAINTY - Offset Wellbore: STATE ANTELOPE Y-E-13HNB PWB Offset Wellpath: STATE ANTELOPE Y-E-13HNB PWP (REV-A.0) | | | | |
|---|------------|---------|----------|---------|
| Slot Surface Uncertainty @1SD | Horizontal | 0.100ft | Vertical | 1.000ft |
| Facility Surface Uncertainty @1SD | Horizontal | 8.200ft | Vertical | 3.000ft |

| HOLE & CASING SECTIONS - Offset Wellbore: STATE ANTELOPE Y-E-13HNB PWB Offset Wellpath: STATE ANTELOPE Y-E-13HNB PWP (REV-A.0) | | | | | | | | | |
|---|------------------|----------------|------------------|-------------------|-----------------|-------------------|-------------------|-----------------|-----------------|
| String/Diameter | Start MD [ft] | End MD [ft] | Interval [ft] | Start TVD [ft] | End TVD [ft] | Start N/S [ft] | Start E/W [ft] | End N/S [ft] | End E/W [ft] |
| 13.5in Open Hole | 17.00 | 1550.00 | 1533.00 | 17.00 | 1500.59 | -24.43 | 0.17 | -110.97 | 39.77 |
| 9.625in Casing Surface | 17.00 | 1550.00 | 1533.00 | 17.00 | 1500.59 | -24.43 | 0.17 | -110.97 | 39.77 |
| 8.5in Open Hole | 1550.00 | 12383.68 | 10833.68 | 1500.59 | N/A | -110.97 | 39.77 | N/A | N/A |



Clearance Report

STATE ANTELOPE X44-D14-13HNB PWP (REV-A.0)

Closest Approach

Page 10 of 18



| REFERENCE WELLPATH IDENTIFICATION | | | |
|-----------------------------------|---------------------------|----------|--|
| Operator | BONANZA CREEK OIL COMPANY | Slot | SLOT#10 STATE ANTELOPE X44-D14-13HNB (2667'FNL & 510'FEL,SEC.13) |
| Area | COLORADO | Well | STATE ANTELOPE X44-D14-13HNB |
| Field | WELD COUNTY | Wellbore | STATE ANTELOPE X44-D14-13HNB PWB |
| Facility | SEC.13-T5N-R62W | | |

| SURVEY PROGRAM - Offset Wellbore: STATE ANTELOPE Y-E-13HNB PWB Offset Wellpath: STATE ANTELOPE Y-E-13HNB PWP (REV-A.0) | | | | |
|---|----------------|------------------------------|------------------|------------------------------|
| Start MD [ft] | End MD [ft] | Positional Uncertainty Model | Log Name/Comment | Wellbore |
| 17.00 | 1550.00 | BHI NaviTrak (Rotating) | | STATE ANTELOPE Y-E-13HNB PWB |
| 1550.00 | 12383.68 | BHI AutoTrak Curve (Short) | | STATE ANTELOPE Y-E-13HNB PWB |

| OFFSET WELLPATH REFERENCE - Offset Wellbore: STATE ANTELOPE Y-E-13HNB PWB Offset Wellpath: STATE ANTELOPE Y-E-13HNB PWP (REV-A.0) | |
|---|---|
| MD Reference: RIG (17') (RKB) | Offset TVD & local coordinates use Reference Wellpath settings (See WELLPATH DATUM on page 1 of this report) |
| Ellipse Start MD | 17.00ft |



REFERENCE WELLPATH IDENTIFICATION

| | | | |
|----------|---------------------------|----------|--|
| Operator | BONANZA CREEK OIL COMPANY | Slot | SLOT#10 STATE ANTELOPE X44-D14-13HNB (2667'FNL & 510'FEL,SEC.13) |
| Area | COLORADO | Well | STATE ANTELOPE X44-D14-13HNB |
| Field | WELD COUNTY | Wellbore | STATE ANTELOPE X44-D14-13HNB PWB |
| Facility | SEC.13-T5N-R62W | | |

CLEARANCE DATA - Offset Wellbore: **STATE ANTELOPE W42-C12-13HNB PWB** Offset Wellpath: **STATE ANTELOPE W42-C12-13HNB PWP (REV-A.0)**

| | | | | |
|---------------------------|--|------------------------------------|----------------------|---------------------------------------|
| Facility: SEC.13-T5N-R62W | Slot: SLOT#09 STATE ANTELOPE W42-C12-13HNB (2647'FNL & 510'FEL,SEC.13) | Well: STATE ANTELOPE W42-C12-13HNB | Threshold Value=1.00 | † = interpolated/extrapolated station |
|---------------------------|--|------------------------------------|----------------------|---------------------------------------|

| Ref MD [ft] | Ref TVD [ft] | Ref North [ft] | Ref East [ft] | Offset MD [ft] | Offset TVD [ft] | Offset North [ft] | Offset East [ft] | Angle from Highside [°] | C-C Clear Dist [ft] | ACR MASD [ft] | Sep Ratio | ACR Status |
|----------------|-----------------|-------------------|------------------|-------------------|--------------------|----------------------|---------------------|----------------------------|---------------------------|---------------------|--------------|---------------|
| 17.00 | 17.00 | 0.00 | 0.00 | 17.00 | 17.00 | 20.04 | 0.00 | 0.00 | 20.04 | 1.56 | 31.79 | PASS |
| 117.00† | 117.00 | 0.00 | 0.00 | 117.00 | 117.00 | 20.04 | 0.00 | 0.00 | 20.04 | 2.18 | 15.64 | PASS |
| 217.00† | 217.00 | 0.00 | 0.00 | 217.00 | 217.00 | 20.04 | 0.00 | 0.00 | 20.04 | 3.16 | 8.67 | PASS |
| 300.00 | 300.00 | 0.00 | 0.00 | 300.00 | 300.00 | 20.04 | 0.00 | 0.00 | 20.04 | 4.01 | 6.26 | PASS |
| 317.00† | 317.00 | -0.05 | 0.02 | 317.00 | 317.00 | 20.04 | 0.00 | -159.10 | 20.08 | 4.18 | 5.94 | PASS |
| 417.00† | 416.97 | -2.23 | 0.85 | 416.97 | 416.97 | 20.04 | 0.00 | -161.24 | 22.28 | 5.38 | 4.83 | PASS |
| 517.00† | 516.79 | -7.67 | 2.94 | 516.79 | 516.79 | 20.04 | 0.05 | -164.96 | 27.86 | 6.87 | 4.55 | PASS |
| 617.00† | 616.35 | -16.36 | 6.26 | 616.36 | 616.33 | 20.32 | 2.35 | -165.06 | 36.89 | 8.20 | 4.96 | PASS |
| 717.00† | 715.53 | -28.29 | 10.83 | 715.49 | 715.29 | 21.02 | 8.04 | -162.10 | 49.39 | 9.44 | 5.71 | PASS |
| 817.00† | 814.20 | -43.45 | 16.63 | 813.91 | 813.28 | 22.12 | 17.05 | -158.31 | 65.58 | 10.64 | 6.68 | PASS |
| 917.00† | 912.24 | -61.81 | 23.66 | 911.58 | 910.21 | 23.58 | 29.00 | -154.84 | 85.58 | 11.87 | 7.76 | PASS |
| 1017.00† | 1009.54 | -83.36 | 31.91 | 1008.79 | 1006.61 | 25.09 | 41.41 | -153.15 | 108.91 | 13.07 | 8.92 | PASS |
| 1117.00† | 1105.97 | -108.06 | 41.37 | 1105.24 | 1102.26 | 26.60 | 53.74 | -152.65 | 135.28 | 14.32 | 10.06 | PASS |
| 1217.00† | 1201.42 | -135.90 | 52.02 | 1200.83 | 1197.05 | 28.09 | 65.95 | -152.78 | 164.63 | 15.58 | 11.20 | PASS |
| 1317.00† | 1295.77 | -166.82 | 63.86 | 1295.42 | 1290.86 | 29.56 | 78.03 | -153.25 | 196.96 | 16.86 | 12.33 | PASS |
| 1319.23 | 1297.86 | -167.55 | 64.14 | 1297.52 | 1292.94 | 29.60 | 78.30 | -153.26 | 197.71 | 16.89 | 12.35 | PASS |
| 1417.00† | 1389.51 | -199.35 | 76.31 | 1389.47 | 1384.12 | 31.03 | 90.05 | -154.00 | 230.85 | 18.02 | 13.48 | PASS |
| 1517.00† | 1483.25 | -231.88 | 88.77 | 1483.51 | 1477.38 | 32.50 | 102.06 | -154.58 | 264.78 | 19.19 | 14.48 | PASS |
| 1617.00† | 1576.99 | -264.41 | 101.22 | 1577.55 | 1570.64 | 33.96 | 114.07 | -155.02 | 298.72 | 19.80 | 15.61 | PASS |
| 1717.00† | 1670.72 | -296.94 | 113.67 | 1671.59 | 1663.90 | 35.43 | 126.09 | -155.37 | 332.67 | 20.26 | 16.98 | PASS |
| 1817.00† | 1764.46 | -329.47 | 126.12 | 1765.63 | 1757.16 | 36.90 | 138.10 | -155.65 | 366.64 | 20.70 | 18.30 | PASS |
| 1917.00† | 1858.20 | -362.00 | 138.58 | 1859.67 | 1850.42 | 38.36 | 150.12 | -155.89 | 400.61 | 21.23 | 19.49 | PASS |
| 2017.00† | 1951.94 | -394.53 | 151.03 | 1953.72 | 1943.68 | 39.83 | 162.13 | -156.09 | 434.58 | 21.82 | 20.55 | PASS |
| 2117.00† | 2045.67 | -427.06 | 163.48 | 2047.76 | 2036.94 | 41.29 | 174.14 | -156.26 | 468.56 | 22.48 | 21.49 | PASS |
| 2217.00† | 2139.41 | -459.59 | 175.93 | 2141.80 | 2130.19 | 42.76 | 186.16 | -156.41 | 502.54 | 23.20 | 22.31 | PASS |
| 2317.00† | 2233.15 | -492.12 | 188.39 | 2235.84 | 2223.45 | 44.23 | 198.17 | -156.54 | 536.53 | 23.98 | 23.03 | PASS |
| 2417.00† | 2326.89 | -524.65 | 200.84 | 2329.88 | 2316.71 | 45.69 | 210.18 | -156.65 | 570.51 | 24.80 | 23.65 | PASS |
| 2517.00† | 2420.62 | -557.18 | 213.29 | 2423.92 | 2409.97 | 47.16 | 222.20 | -156.76 | 604.50 | 25.67 | 24.19 | PASS |
| 2617.00† | 2514.36 | -589.71 | 225.74 | 2517.97 | 2503.23 | 48.63 | 234.21 | -156.85 | 638.49 | 26.58 | 24.65 | PASS |
| 2717.00† | 2608.10 | -622.24 | 238.20 | 2612.01 | 2596.49 | 50.09 | 246.23 | -156.93 | 672.49 | 27.52 | 25.05 | PASS |
| 2817.00† | 2701.84 | -654.77 | 250.65 | 2706.05 | 2689.75 | 51.56 | 258.24 | -157.00 | 706.48 | 28.50 | 25.39 | PASS |
| 2917.00† | 2795.57 | -687.30 | 263.10 | 2800.09 | 2783.01 | 53.03 | 270.25 | -157.07 | 740.47 | 29.51 | 25.68 | PASS |
| 3017.00† | 2889.31 | -719.83 | 275.55 | 2894.13 | 2876.27 | 54.49 | 282.27 | -157.13 | 774.47 | 30.54 | 25.93 | PASS |

| CLEARANCE DATA - Offset Wellbore: STATE ANTELOPE W42-C12-13HNB PWB Offset Wellpath: STATE ANTELOPE W42-C12-13HNB PWP (REV-A.0) | | | | | | | | | | | | |
|---|-----------------|--|------------------|-------------------|--------------------|------------------------------------|---------------------|----------------------------|---------------------------|---------------------|---------------------------------------|---------------|
| Facility: SEC.13-T5N-R62W | | Slot: SLOT#09 STATE ANTELOPE W42-C12-13HNB (2647'FNL & 510'FEL,SEC.13) | | | | Well: STATE ANTELOPE W42-C12-13HNB | | | Threshold Value=1.00 | | † = interpolated/extrapolated station | |
| Ref MD [ft] | Ref TVD [ft] | Ref North [ft] | Ref East [ft] | Offset MD [ft] | Offset TVD [ft] | Offset North [ft] | Offset East [ft] | Angle from Highside [°] | C-C Clear Dist [ft] | ACR MASD [ft] | Sep Ratio | ACR Status |
| 3117.00† | 2983.05 | -752.36 | 288.01 | 2988.17 | 2969.53 | 55.96 | 294.28 | -157.18 | 808.46 | 31.60 | 26.15 | PASS |
| 3217.00† | 3076.79 | -784.89 | 300.46 | 3082.21 | 3062.79 | 57.43 | 306.30 | -157.23 | 842.46 | 32.68 | 26.33 | PASS |
| 3317.00† | 3170.52 | -817.42 | 312.91 | 3176.26 | 3156.05 | 58.89 | 318.31 | -157.28 | 876.45 | 33.77 | 26.48 | PASS |
| 3417.00† | 3264.26 | -849.95 | 325.36 | 3270.30 | 3249.31 | 60.36 | 330.32 | -157.33 | 910.45 | 34.89 | 26.62 | PASS |
| 3517.00† | 3358.00 | -882.48 | 337.82 | 3364.34 | 3342.57 | 61.83 | 342.34 | -157.37 | 944.45 | 36.02 | 26.73 | PASS |
| 3617.00† | 3451.74 | -915.01 | 350.27 | 3458.38 | 3435.83 | 63.29 | 354.35 | -157.40 | 978.44 | 37.16 | 26.82 | PASS |

C-C Clearance Distance Cutoff: 1000.00 ft

| POSITIONAL UNCERTAINTY - Offset Wellbore: STATE ANTELOPE W42-C12-13HNB PWB Offset Wellpath: STATE ANTELOPE W42-C12-13HNB PWP (REV-A.0) | | | | |
|---|--|--|------------|---------|
| Slot Surface Uncertainty @1SD | | | Horizontal | 0.100ft |
| Facility Surface Uncertainty @1SD | | | Horizontal | 8.200ft |
| | | | Vertical | 1.000ft |
| | | | Vertical | 3.000ft |



Clearance Report

STATE ANTELOPE X44-D14-13HNB PWP (REV-A.0)

Closest Approach

Page 12 of 18



| REFERENCE WELLPATH IDENTIFICATION | | | |
|-----------------------------------|---------------------------|----------|--|
| Operator | BONANZA CREEK OIL COMPANY | Slot | SLOT#10 STATE ANTELOPE X44-D14-13HNB (2667'FNL & 510'FEL,SEC.13) |
| Area | COLORADO | Well | STATE ANTELOPE X44-D14-13HNB |
| Field | WELD COUNTY | Wellbore | STATE ANTELOPE X44-D14-13HNB PWB |
| Facility | SEC.13-T5N-R62W | | |

| HOLE & CASING SECTIONS - Offset Wellbore: STATE ANTELOPE W42-C12-13HNB PWB Offset Wellpath: STATE ANTELOPE W42-C12-13HNB PWP (REV-A.0) | | | | | | | | | |
|---|------------------|----------------|------------------|-------------------|-----------------|-------------------|-------------------|-----------------|-----------------|
| String/Diameter | Start MD [ft] | End MD [ft] | Interval [ft] | Start TVD [ft] | End TVD [ft] | Start N/S [ft] | Start E/W [ft] | End N/S [ft] | End E/W [ft] |
| 13.5in Open Hole | 17.00 | 1550.00 | 1533.00 | 17.00 | 1543.32 | 12.21 | 0.00 | 16.33 | 33.70 |
| 9.625in Casing Surface | 17.00 | 1550.00 | 1533.00 | 17.00 | 1543.32 | 12.21 | 0.00 | 16.33 | 33.70 |
| 8.5in Open Hole | 1550.00 | 11208.26 | 9658.26 | 1543.32 | 6050.00 | 16.33 | 33.70 | 12.35 | -1448.34 |

| SURVEY PROGRAM - Offset Wellbore: STATE ANTELOPE W42-C12-13HNB PWB Offset Wellpath: STATE ANTELOPE W42-C12-13HNB PWP (REV-A.0) | | | | |
|---|----------------|------------------------------|------------------|----------------------------------|
| Start MD [ft] | End MD [ft] | Positional Uncertainty Model | Log Name/Comment | Wellbore |
| 17.00 | 1550.00 | BHI NaviTrak (Rotating) | | STATE ANTELOPE W42-C12-13HNB PWB |
| 1550.00 | 11208.26 | BHI AutoTrak Curve (Short) | | STATE ANTELOPE W42-C12-13HNB PWB |

| OFFSET WELLPATH REFERENCE - Offset Wellbore: STATE ANTELOPE W42-C12-13HNB PWB Offset Wellpath: STATE ANTELOPE W42-C12-13HNB PWP (REV-A.0) | |
|--|---|
| MD Reference: RIG (17') (RKB) | Offset TVD & local coordinates use Reference Wellpath settings (See WELLPATH DATUM on page 1 of this report) |
| Ellipse Start MD | 17.00ft |



Clearance Report

STATE ANTELOPE X44-D14-13HNB PWP (REV-A.0)

Closest Approach

Page 13 of 18



| REFERENCE WELLPATH IDENTIFICATION | | | |
|-----------------------------------|---------------------------|----------|--|
| Operator | BONANZA CREEK OIL COMPANY | Slot | SLOT#10 STATE ANTELOPE X44-D14-13HNB (2667'FNL & 510'FEL,SEC.13) |
| Area | COLORADO | Well | STATE ANTELOPE X44-D14-13HNB |
| Field | WELD COUNTY | Wellbore | STATE ANTELOPE X44-D14-13HNB PWB |
| Facility | SEC.13-T5N-R62W | | |

| CLEARANCE DATA - Offset Wellbore: STATE ANTELOPE 42-12-13HNB PWB Offset Wellpath: STATE ANTELOPE 42-12-13HNB PWP (REV-A.0) | | | | | | | | | | | | |
|--|-----------------|--|------------------|-------------------|--------------------|----------------------------------|---------------------|----------------------------|---------------------------|---------------------------------------|--------------|---------------|
| Facility: SEC.13-T5N-R62W | | Slot: SLOT#08 STATE ANTELOPE 42-12-13HNB (2627'FNL & 510'FEL,SEC.13) | | | | Well: STATE ANTELOPE 42-12-13HNB | | Threshold Value=1.00 | | † = interpolated/extrapolated station | | |
| Ref MD [ft] | Ref TVD [ft] | Ref North [ft] | Ref East [ft] | Offset MD [ft] | Offset TVD [ft] | Offset North [ft] | Offset East [ft] | Angle from Highside [°] | C-C Clear Dist [ft] | ACR MASD [ft] | Sep Ratio | ACR Status |
| 17.00 | 17.00 | 0.00 | 0.00 | 17.00 | 17.00 | 40.07 | -0.28 | -0.40 | 40.08 | 1.56 | 65.19 | PASS |
| 117.00† | 117.00 | 0.00 | 0.00 | 117.00 | 117.00 | 40.07 | -0.28 | -0.40 | 40.08 | 2.18 | 32.08 | PASS |
| 217.00† | 217.00 | 0.00 | 0.00 | 217.00 | 217.00 | 40.07 | -0.28 | -0.40 | 40.08 | 3.16 | 17.78 | PASS |
| 300.00 | 300.00 | 0.00 | 0.00 | 300.00 | 300.00 | 40.07 | -0.28 | -0.40 | 40.08 | 4.01 | 12.84 | PASS |
| 317.00† | 317.00 | -0.05 | 0.02 | 317.00 | 317.00 | 40.07 | -0.28 | -159.48 | 40.12 | 4.18 | 12.16 | PASS |
| 417.00† | 416.97 | -2.23 | 0.85 | 416.82 | 416.82 | 40.10 | -0.24 | -160.52 | 42.35 | 5.38 | 9.37 | PASS |
| 517.00† | 516.79 | -7.67 | 2.94 | 515.66 | 515.63 | 41.49 | 1.58 | -160.55 | 49.20 | 6.90 | 8.13 | PASS |
| 617.00† | 616.35 | -16.36 | 6.26 | 613.78 | 613.58 | 44.92 | 6.05 | -159.03 | 61.35 | 8.36 | 8.16 | PASS |
| 717.00† | 715.53 | -28.29 | 10.83 | 710.74 | 710.13 | 50.31 | 13.09 | -156.96 | 78.82 | 9.73 | 8.88 | PASS |
| 817.00† | 814.20 | -43.45 | 16.63 | 806.13 | 804.77 | 57.54 | 22.55 | -154.94 | 101.60 | 11.03 | 10.00 | PASS |
| 917.00† | 912.24 | -61.81 | 23.66 | 900.97 | 898.49 | 66.39 | 34.11 | -153.27 | 129.36 | 12.26 | 11.37 | PASS |
| 1017.00† | 1009.54 | -83.36 | 31.91 | 996.02 | 992.35 | 75.49 | 46.00 | -152.54 | 160.39 | 13.40 | 12.82 | PASS |
| 1117.00† | 1105.97 | -108.06 | 41.37 | 1090.07 | 1085.22 | 84.49 | 57.77 | -152.42 | 194.36 | 14.58 | 14.20 | PASS |
| 1217.00† | 1201.42 | -135.90 | 52.02 | 1183.00 | 1176.99 | 93.39 | 69.40 | -152.63 | 231.24 | 15.78 | 15.55 | PASS |
| 1317.00† | 1295.77 | -166.82 | 63.86 | 1274.69 | 1267.54 | 102.17 | 80.87 | -153.01 | 271.00 | 16.99 | 16.85 | PASS |
| 1319.23 | 1297.86 | -167.55 | 64.14 | 1276.72 | 1269.54 | 102.36 | 81.12 | -153.02 | 271.92 | 17.02 | 16.87 | PASS |
| 1417.00† | 1389.51 | -199.35 | 76.31 | 1365.70 | 1357.41 | 110.88 | 92.26 | -153.75 | 312.30 | 18.12 | 18.14 | PASS |
| 1517.00† | 1483.25 | -231.88 | 88.77 | 1456.71 | 1447.29 | 119.59 | 103.65 | -154.32 | 353.63 | 19.20 | 19.34 | PASS |
| 1617.00† | 1576.99 | -264.41 | 101.22 | 1547.72 | 1537.16 | 128.31 | 115.03 | -154.77 | 394.98 | 19.89 | 20.60 | PASS |
| 1717.00† | 1670.72 | -296.94 | 113.67 | 1638.73 | 1627.03 | 137.02 | 126.42 | -155.13 | 436.34 | 20.35 | 22.18 | PASS |
| 1817.00† | 1764.46 | -329.47 | 126.12 | 1729.74 | 1716.91 | 145.73 | 137.81 | -155.43 | 477.72 | 20.76 | 23.79 | PASS |
| 1917.00† | 1858.20 | -362.00 | 138.58 | 1820.75 | 1806.78 | 154.45 | 149.20 | -155.69 | 519.11 | 21.24 | 25.24 | PASS |
| 2017.00† | 1951.94 | -394.53 | 151.03 | 1911.76 | 1896.66 | 163.16 | 160.58 | -155.90 | 560.51 | 21.80 | 26.54 | PASS |
| 2117.00† | 2045.67 | -427.06 | 163.48 | 2002.77 | 1986.53 | 171.87 | 171.97 | -156.09 | 601.91 | 22.42 | 27.69 | PASS |
| 2217.00† | 2139.41 | -459.59 | 175.93 | 2093.79 | 2076.40 | 180.59 | 183.36 | -156.25 | 643.32 | 23.10 | 28.70 | PASS |
| 2317.00† | 2233.15 | -492.12 | 188.39 | 2184.80 | 2166.28 | 189.30 | 194.75 | -156.40 | 684.73 | 23.83 | 29.59 | PASS |
| 2417.00† | 2326.89 | -524.65 | 200.84 | 2275.81 | 2256.15 | 198.02 | 206.14 | -156.52 | 726.14 | 24.61 | 30.35 | PASS |
| 2517.00† | 2420.62 | -557.18 | 213.29 | 2366.82 | 2346.02 | 206.73 | 217.52 | -156.64 | 767.56 | 25.43 | 31.02 | PASS |
| 2617.00† | 2514.36 | -589.71 | 225.74 | 2457.83 | 2435.90 | 215.44 | 228.91 | -156.74 | 808.98 | 26.29 | 31.59 | PASS |
| 2717.00† | 2608.10 | -622.24 | 238.20 | 2548.84 | 2525.77 | 224.16 | 240.30 | -156.83 | 850.40 | 27.19 | 32.09 | PASS |
| 2817.00† | 2701.84 | -654.77 | 250.65 | 2639.85 | 2615.65 | 232.87 | 251.69 | -156.91 | 891.82 | 28.12 | 32.51 | PASS |
| 2917.00† | 2795.57 | -687.30 | 263.10 | 2730.86 | 2705.52 | 241.58 | 263.07 | -156.99 | 933.24 | 29.08 | 32.87 | PASS |
| 3017.00† | 2889.31 | -719.83 | 275.55 | 2821.87 | 2795.39 | 250.30 | 274.46 | -157.06 | 974.67 | 30.06 | 33.18 | PASS |

C-C Clearance Distance Cutoff: 1000.00 ft

| POSITIONAL UNCERTAINTY - Offset Wellbore: STATE ANTELOPE 42-12-13HNB PWB Offset Wellpath: STATE ANTELOPE 42-12-13HNB PWP (REV-A.0) | | | | |
|---|------------|---------|----------|---------|
| Slot Surface Uncertainty @1SD | Horizontal | 0.100ft | Vertical | 1.000ft |
| Facility Surface Uncertainty @1SD | Horizontal | 8.200ft | Vertical | 3.000ft |



Clearance Report

STATE ANTELOPE X44-D14-13HNB PWP (REV-A.0)

Closest Approach

Page 14 of 18



| REFERENCE WELLPATH IDENTIFICATION | | | |
|-----------------------------------|---------------------------|----------|--|
| Operator | BONANZA CREEK OIL COMPANY | Slot | SLOT#10 STATE ANTELOPE X44-D14-13HNB (2667'FNL & 510'FEL,SEC.13) |
| Area | COLORADO | Well | STATE ANTELOPE X44-D14-13HNB |
| Field | WELD COUNTY | Wellbore | STATE ANTELOPE X44-D14-13HNB PWB |
| Facility | SEC.13-T5N-R62W | | |

| HOLE & CASING SECTIONS - Offset Wellbore: STATE ANTELOPE 42-12-13HNB PWB Offset Wellpath: STATE ANTELOPE 42-12-13HNB PWP (REV-A.0) | | | | | | | | | |
|---|------------------|----------------|------------------|-------------------|-----------------|-------------------|-------------------|-----------------|-----------------|
| String/Diameter | Start MD [ft] | End MD [ft] | Interval [ft] | Start TVD [ft] | End TVD [ft] | Start N/S [ft] | Start E/W [ft] | End N/S [ft] | End E/W [ft] |
| 13.5in Open Hole | 17.00 | 1550.00 | 1533.00 | 17.00 | 1539.41 | 24.43 | -0.17 | 51.39 | 35.06 |
| 9.625in Casing Surface | 17.00 | 1550.00 | 1533.00 | 17.00 | 1539.41 | 24.43 | -0.17 | 51.39 | 35.06 |
| 8.5in Open Hole | 1550.00 | 11226.99 | 9676.99 | 1539.41 | N/A | 51.39 | 35.06 | N/A | N/A |

| SURVEY PROGRAM - Offset Wellbore: STATE ANTELOPE 42-12-13HNB PWB Offset Wellpath: STATE ANTELOPE 42-12-13HNB PWP (REV-A.0) | | | | |
|---|----------------|------------------------------|------------------|--------------------------------|
| Start MD [ft] | End MD [ft] | Positional Uncertainty Model | Log Name/Comment | Wellbore |
| 17.00 | 1550.00 | BHI NaviTrak (Rotating) | | STATE ANTELOPE 42-12-13HNB PWB |
| 1550.00 | 11226.99 | BHI AutoTrak Curve (Short) | | STATE ANTELOPE 42-12-13HNB PWB |

| OFFSET WELLPATH REFERENCE - Offset Wellbore: STATE ANTELOPE 42-12-13HNB PWB Offset Wellpath: STATE ANTELOPE 42-12-13HNB PWP (REV-A.0) | |
|--|---|
| MD Reference: RIG (17') (RKB) | Offset TVD & local coordinates use Reference Wellpath settings (See WELLPATH DATUM on page 1 of this report) |
| Ellipse Start MD | 17.00ft |

| POSITIONAL UNCERTAINTY - Offset Wellbore: STATE ANTELOPE V-B-13HNB PWB Offset Wellpath: STATE ANTELOPE V-B-13HNB PWP (REV-A.0) | | | | |
|---|------------|---------|----------|---------|
| Slot Surface Uncertainty @1SD | Horizontal | 0.100ft | Vertical | 1.000ft |
| Facility Surface Uncertainty @1SD | Horizontal | 8.200ft | Vertical | 3.000ft |

| HOLE & CASING SECTIONS - Offset Wellbore: STATE ANTELOPE V-B-13HNB PWB Offset Wellpath: STATE ANTELOPE V-B-13HNB PWP (REV-A.0) | | | | | | | | | |
|---|------------------|----------------|------------------|-------------------|-----------------|-------------------|-------------------|-----------------|-----------------|
| String/Diameter | Start MD [ft] | End MD [ft] | Interval [ft] | Start TVD [ft] | End TVD [ft] | Start N/S [ft] | Start E/W [ft] | End N/S [ft] | End E/W [ft] |
| 13.5in Open Hole | 17.00 | 1550.00 | 1533.00 | 17.00 | 1530.77 | 36.64 | -0.17 | 86.65 | 35.11 |
| 9.625in Casing Surface | 17.00 | 1550.00 | 1533.00 | 17.00 | 1530.77 | 36.64 | -0.17 | 86.65 | 35.11 |
| 8.5in Open Hole | 1550.00 | 11280.38 | 9730.38 | 1530.77 | N/A | 86.65 | 35.11 | N/A | N/A |



Clearance Report

STATE ANTELOPE X44-D14-13HNB PWP (REV-A.0)

Closest Approach

Page 16 of 18



| REFERENCE WELLPATH IDENTIFICATION | | | |
|-----------------------------------|---------------------------|----------|--|
| Operator | BONANZA CREEK OIL COMPANY | Slot | SLOT#10 STATE ANTELOPE X44-D14-13HNB (2667'FNL & 510'FEL,SEC.13) |
| Area | COLORADO | Well | STATE ANTELOPE X44-D14-13HNB |
| Field | WELD COUNTY | Wellbore | STATE ANTELOPE X44-D14-13HNB PWB |
| Facility | SEC.13-T5N-R62W | | |

| SURVEY PROGRAM - Offset Wellbore: STATE ANTELOPE V-B-13HNB PWB Offset Wellpath: STATE ANTELOPE V-B-13HNB PWP (REV-A.0) | | | | |
|---|----------------|------------------------------|------------------|------------------------------|
| Start MD [ft] | End MD [ft] | Positional Uncertainty Model | Log Name/Comment | Wellbore |
| 17.00 | 1550.00 | BHI NaviTrak (Rotating) | | STATE ANTELOPE V-B-13HNB PWB |
| 1550.00 | 11280.38 | BHI AutoTrak Curve (Short) | | STATE ANTELOPE V-B-13HNB PWB |

| OFFSET WELLPATH REFERENCE - Offset Wellbore: STATE ANTELOPE V-B-13HNB PWB Offset Wellpath: STATE ANTELOPE V-B-13HNB PWP (REV-A.0) | |
|---|---|
| MD Reference: RIG (17') (RKB) | Offset TVD & local coordinates use Reference Wellpath settings (See WELLPATH DATUM on page 1 of this report) |
| Ellipse Start MD | 17.00ft |



Clearance Report

STATE ANTELOPE X44-D14-13HNB PWP (REV-A.0)

Closest Approach

Page 17 of 18



| REFERENCE WELLPATH IDENTIFICATION | | | |
|-----------------------------------|---------------------------|----------|--|
| Operator | BONANZA CREEK OIL COMPANY | Slot | SLOT#10 STATE ANTELOPE X44-D14-13HNB (2667'FNL & 510'FEL,SEC.13) |
| Area | COLORADO | Well | STATE ANTELOPE X44-D14-13HNB |
| Field | WELD COUNTY | Wellbore | STATE ANTELOPE X44-D14-13HNB PWB |
| Facility | SEC.13-T5N-R62W | | |

| CLEARANCE DATA - Offset Wellbore: STATE ANTELOPE V41-B11-13HNB PWB Offset Wellpath: STATE ANTELOPE V41-B11-13HNB PWP (REV-A.0) | | | | | | | | | | | | |
|--|--------------|--|---------------|----------------|------------------------------------|-------------------|------------------|--|---------------------|---------------|-----------|------------|
| Facility: SEC.13-T5N-R62W | | Slot: SLOT#06 STATE ANTELOPE V41-B11-13HNB (2587'FNL & 510'FEL,SEC.13) | | | Well: STATE ANTELOPE V41-B11-13HNB | | | Threshold Value=1.00 † = interpolated/extrapolated station | | | | |
| Ref MD [ft] | Ref TVD [ft] | Ref North [ft] | Ref East [ft] | Offset MD [ft] | Offset TVD [ft] | Offset North [ft] | Offset East [ft] | Angle from Highside [°] | C-C Clear Dist [ft] | ACR MASD [ft] | Sep Ratio | ACR Status |
| 17.00 | 17.00 | 0.00 | 0.00 | 17.00 | 17.00 | 80.15 | -0.28 | -0.20 | 80.15 | 1.56 | 131.98 | PASS |
| 117.00† | 117.00 | 0.00 | 0.00 | 117.00 | 117.00 | 80.15 | -0.28 | -0.20 | 80.15 | 2.18 | 64.95 | PASS |
| 217.00† | 217.00 | 0.00 | 0.00 | 216.58 | 216.58 | 80.19 | -0.26 | -0.18 | 80.19 | 3.16 | 36.07 | PASS |
| 300.00 | 300.00 | 0.00 | 0.00 | 297.51 | 297.49 | 81.64 | 0.44 | 0.31 | 81.68 | 4.16 | 25.27 | PASS |
| 317.00† | 317.00 | -0.05 | 0.02 | 314.07 | 314.03 | 82.20 | 0.70 | -158.57 | 82.30 | 4.37 | 23.91 | PASS |
| 417.00† | 416.97 | -2.23 | 0.85 | 411.14 | 410.95 | 87.16 | 3.09 | -157.54 | 89.62 | 6.00 | 17.60 | PASS |
| 517.00† | 516.79 | -7.67 | 2.94 | 507.24 | 506.65 | 94.98 | 6.85 | -156.64 | 103.23 | 7.73 | 15.12 | PASS |
| 617.00† | 616.35 | -16.36 | 6.26 | 601.82 | 600.50 | 105.51 | 11.91 | -155.94 | 123.03 | 9.21 | 14.81 | PASS |
| 717.00† | 715.53 | -28.29 | 10.83 | 694.36 | 691.91 | 118.50 | 18.15 | -155.41 | 148.86 | 10.59 | 15.36 | PASS |
| 817.00† | 814.20 | -43.45 | 16.63 | 784.42 | 780.38 | 133.69 | 25.45 | -155.02 | 180.56 | 11.81 | 16.55 | PASS |
| 917.00† | 912.24 | -61.81 | 23.66 | 871.58 | 865.45 | 150.78 | 33.66 | -154.69 | 217.91 | 13.01 | 18.01 | PASS |
| 1017.00† | 1009.54 | -83.36 | 31.91 | 955.49 | 946.77 | 169.42 | 42.62 | -154.40 | 260.68 | 14.14 | 19.72 | PASS |
| 1117.00† | 1105.97 | -108.06 | 41.37 | 1039.35 | 1027.47 | 189.97 | 52.49 | -154.14 | 308.40 | 15.21 | 21.59 | PASS |
| 1217.00† | 1201.42 | -135.90 | 52.02 | 1125.45 | 1110.22 | 211.38 | 62.78 | -154.03 | 359.21 | 16.27 | 23.40 | PASS |
| 1317.00† | 1295.77 | -166.82 | 63.86 | 1209.86 | 1191.36 | 232.37 | 72.86 | -154.03 | 412.73 | 17.30 | 25.20 | PASS |
| 1319.23 | 1297.86 | -167.55 | 64.14 | 1211.72 | 1193.14 | 232.84 | 73.09 | -154.03 | 413.95 | 17.33 | 25.23 | PASS |
| 1417.00† | 1389.51 | -199.35 | 76.31 | 1293.36 | 1271.61 | 253.14 | 82.84 | -154.56 | 467.65 | 18.27 | 26.97 | PASS |
| 1517.00† | 1483.25 | -231.88 | 88.77 | 1376.85 | 1351.86 | 273.91 | 92.82 | -154.99 | 522.59 | 19.25 | 28.52 | PASS |
| 1617.00† | 1576.99 | -264.41 | 101.22 | 1460.35 | 1432.12 | 294.67 | 102.80 | -155.33 | 577.55 | 19.93 | 30.08 | PASS |
| 1717.00† | 1670.72 | -296.94 | 113.67 | 1543.84 | 1512.37 | 315.44 | 112.78 | -155.62 | 632.53 | 20.54 | 31.93 | PASS |
| 1817.00† | 1764.46 | -329.47 | 126.12 | 1627.34 | 1592.63 | 336.21 | 122.76 | -155.86 | 687.51 | 21.00 | 33.85 | PASS |
| 1917.00† | 1858.20 | -362.00 | 138.58 | 1710.84 | 1672.88 | 356.97 | 132.73 | -156.07 | 742.50 | 21.39 | 35.87 | PASS |
| 2017.00† | 1951.94 | -394.53 | 151.03 | 1794.33 | 1753.13 | 377.74 | 142.71 | -156.24 | 797.50 | 21.85 | 37.69 | PASS |
| 2117.00† | 2045.67 | -427.06 | 163.48 | 1877.83 | 1833.39 | 398.51 | 152.69 | -156.40 | 852.50 | 22.37 | 39.33 | PASS |
| 2217.00† | 2139.41 | -459.59 | 175.93 | 1961.32 | 1913.64 | 419.27 | 162.67 | -156.53 | 907.50 | 22.94 | 40.79 | PASS |
| 2317.00† | 2233.15 | -492.12 | 188.39 | 2044.82 | 1993.90 | 440.04 | 172.65 | -156.65 | 962.51 | 23.56 | 42.08 | PASS |

C-C Clearance Distance Cutoff: 1000.00 ft

| POSITIONAL UNCERTAINTY - Offset Wellbore: STATE ANTELOPE V41-B11-13HNB PWB Offset Wellpath: STATE ANTELOPE V41-B11-13HNB PWP (REV-A.0) | | | |
|--|--|------------|---------|
| Slot Surface Uncertainty @1SD | | Horizontal | 0.100ft |
| Facility Surface Uncertainty @1SD | | Horizontal | 8.200ft |
| | | Vertical | 1.000ft |
| | | Vertical | 3.000ft |

| HOLE & CASING SECTIONS - Offset Wellbore: STATE ANTELOPE V41-B11-13HNB PWB Offset Wellpath: STATE ANTELOPE V41-B11-13HNB PWP (REV-A.0) | | | | | | | | | |
|---|------------------|----------------|------------------|-------------------|-----------------|-------------------|-------------------|-----------------|-----------------|
| String/Diameter | Start MD [ft] | End MD [ft] | Interval [ft] | Start TVD [ft] | End TVD [ft] | Start N/S [ft] | Start E/W [ft] | End N/S [ft] | End E/W [ft] |
| 13.5in Open Hole | 17.00 | 1550.00 | 1533.00 | 17.00 | 1518.29 | 48.86 | -0.17 | 121.04 | 34.51 |
| 9.625in Casing Surface | 17.00 | 1550.00 | 1533.00 | 17.00 | 1518.29 | 48.86 | -0.17 | 121.04 | 34.51 |
| 8.5in Open Hole | 1550.00 | 11366.41 | 9816.41 | 1518.29 | N/A | 121.04 | 34.51 | N/A | N/A |



Clearance Report

STATE ANTELOPE X44-D14-13HNB PWP (REV-A.0)

Closest Approach

Page 18 of 18



| REFERENCE WELLPATH IDENTIFICATION | | | |
|-----------------------------------|---------------------------|----------|--|
| Operator | BONANZA CREEK OIL COMPANY | Slot | SLOT#10 STATE ANTELOPE X44-D14-13HNB (2667'FNL & 510'FEL,SEC.13) |
| Area | COLORADO | Well | STATE ANTELOPE X44-D14-13HNB |
| Field | WELD COUNTY | Wellbore | STATE ANTELOPE X44-D14-13HNB PWB |
| Facility | SEC.13-T5N-R62W | | |

| SURVEY PROGRAM - Offset Wellbore: STATE ANTELOPE V41-B11-13HNB PWB Offset Wellpath: STATE ANTELOPE V41-B11-13HNB PWP (REV-A.0) | | | | |
|---|----------------|------------------------------|------------------|----------------------------------|
| Start MD [ft] | End MD [ft] | Positional Uncertainty Model | Log Name/Comment | Wellbore |
| 17.00 | 1550.00 | BHI NaviTrak (Rotating) | | STATE ANTELOPE V41-B11-13HNB PWB |
| 1550.00 | 11366.41 | BHI AutoTrak Curve (Short) | | STATE ANTELOPE V41-B11-13HNB PWB |

| OFFSET WELLPATH REFERENCE - Offset Wellbore: STATE ANTELOPE V41-B11-13HNB PWB Offset Wellpath: STATE ANTELOPE V41-B11-13HNB PWP (REV-A.0) | |
|--|---|
| MD Reference: RIG (17') (RKB) | Offset TVD & local coordinates use Reference Wellpath settings (See WELLPATH DATUM on page 1 of this report) |
| Ellipse Start MD | 17.00ft |