

BONANZA CREEK OIL COMPANY

Location: COLORADO Slot: SLOT#09 STATE ANTELOPE W42-C12-13HNB (2647'FNL & 510'FEL,SEC.13)
 Field: WELD COUNTY Well: STATE ANTELOPE W42-C12-13HNB
 Facility: SEC.13-T5N-R62W Wellbore: STATE ANTELOPE W42-C12-13HNB PWB

| | | |
|--|--|--|
| Plot reference wellpath is STATE ANTELOPE W42-C12-13HNB PWB (REV-A.0) | | Grid System: NAD83 / Lambert Colorado SP, Northern Zone (501), US feet |
| True vertical depths are referenced to RIG (17) (RKB) | | North Reference: True north |
| Measured depths are referenced to RIG (17) (RKB) | | Scale: True distance |
| RIG (17) (RKB) to Mean Sea Level: 4590 feet | | Depths are in feet |
| Mean Sea Level to Ground level (At Slot: SLOT#09 STATE ANTELOPE W42-C12-13HNB (2647'FNL & 510'FEL,SEC.13)): 0 feet | | Created by: rbbale01 on 2018-11-15 |
| Coordinates are in feet referenced to Slot | | Database: WA DENVER |

Location Information

| | | | | | | | |
|--|--|--------------|--------------|-------------------|--------------------|----------------|-----------------|
| Facility Name | | | | Grid East (US ft) | Grid North (US ft) | Latitude | Longitude |
| SEC.13-T5N-R62W | | | | 333985.889 | 1389969.906 | 40°23'50.820"N | 104°16'47.028"W |
| Slot | | Local N (ft) | Local E (ft) | Grid East (US ft) | Grid North (US ft) | Latitude | Longitude |
| SLOT#09 STATE ANTELOPE W42-C12-13HNB (2647'FNL & 510'FEL,SEC.13) | | 1356.01 | 4472.71 | 334431.327 | 1391387.276 | 40°24'04.216"N | 104°15'49.216"W |
| RIG (17) (RKB) to Ground level (At Slot: SLOT#09 STATE ANTELOPE W42-C12-13HNB (2647'FNL & 510'FEL,SEC.13)) | | | | | | | 4590ft |
| Mean Sea Level to Ground level (At Slot: SLOT#09 STATE ANTELOPE W42-C12-13HNB (2647'FNL & 510'FEL,SEC.13)) | | | | | | | 0ft |
| RIG (17) (RKB) to Mean Sea Level | | | | | | | 4590ft |

Survey Program

| Start MD (ft) | End MD (ft) | Tool | Model | Log Name/Comment | Wellbore |
|---------------|-------------|--------------------|----------------------------|------------------|----------------------------------|
| 17.00 | 1550.00 | BHI NavitTrak | BHI NavitTrak (Rotating) | | STATE ANTELOPE W42-C12-13HNB PWB |
| 1550.00 | 11208.26 | BHI AutoTrak Curve | BHI AutoTrak Curve (Short) | | STATE ANTELOPE W42-C12-13HNB PWB |

Hole and Casing Sections

| Name | Start MD (ft) | End MD (ft) | Interval (ft) | Start TVD (ft) | End TVD (ft) | Start Local N (ft) | Start Local E (ft) | End Local N (ft) | End Local E (ft) | Wellbore |
|------------------------|---------------|-------------|---------------|----------------|--------------|--------------------|--------------------|------------------|------------------|----------------------------------|
| 13.5in Open Hole | 17.00 | 1550.00 | 1533.00 | 17.00 | 1543.32 | 0.00 | 0.00 | 13.50 | 110.55 | STATE ANTELOPE W42-C12-13HNB PWB |
| 9.625in Casing Surface | 17.00 | 1550.00 | 1533.00 | 17.00 | 1543.32 | 0.00 | 0.00 | 13.50 | 110.55 | STATE ANTELOPE W42-C12-13HNB PWB |
| 8.5in Open Hole | 1550.00 | 11208.26 | 9658.26 | 1543.32 | 6050.00 | 13.50 | 110.55 | 0.46 | -4751.78 | STATE ANTELOPE W42-C12-13HNB PWB |

Well Profile Data

| Design Comment | MD (ft) | Inc (°) | Az (°) | TVD (ft) | Local N (ft) | Local E (ft) | DLS (°/100ft) | VS (ft) |
|----------------|----------|---------|---------|----------|--------------|--------------|---------------|---------|
| Tie On | 17.00 | 0.000 | 83.040 | 17.00 | 0.00 | 0.00 | 0.00 | 0.00 |
| End of Tangent | 500.00 | 0.000 | 83.040 | 500.00 | 0.00 | 0.00 | 0.00 | 0.00 |
| End of Build | 869.72 | 7.394 | 83.040 | 868.69 | 2.89 | 23.65 | 2.00 | -23.65 |
| End of Tangent | 5442.84 | 7.394 | 83.040 | 5403.78 | 74.20 | 607.87 | 0.00 | -607.86 |
| End of 3D Arc | 6416.36 | 90.000 | 269.117 | 6050.00 | 74.32 | 39.55 | 10.00 | -39.54 |
| End of Tangent | 11208.26 | 90.000 | 269.117 | 6050.00 | 0.46 | -4751.78 | 0.00 | 4751.78 |

Bottom Hole Location

| MD (ft) | Inc (°) | Az (°) | TVD (ft) | Local N (ft) | Local E (ft) | Grid East (US ft) | Grid North (US ft) | Latitude | Longitude |
|----------|---------|---------|----------|--------------|--------------|-------------------|--------------------|----------------|-----------------|
| 11208.26 | 90.000 | 269.117 | 6050.00 | 0.46 | -4751.78 | 333986.220 | 1391321.49 | 40°24'04.216"N | 104°16'50.635"W |

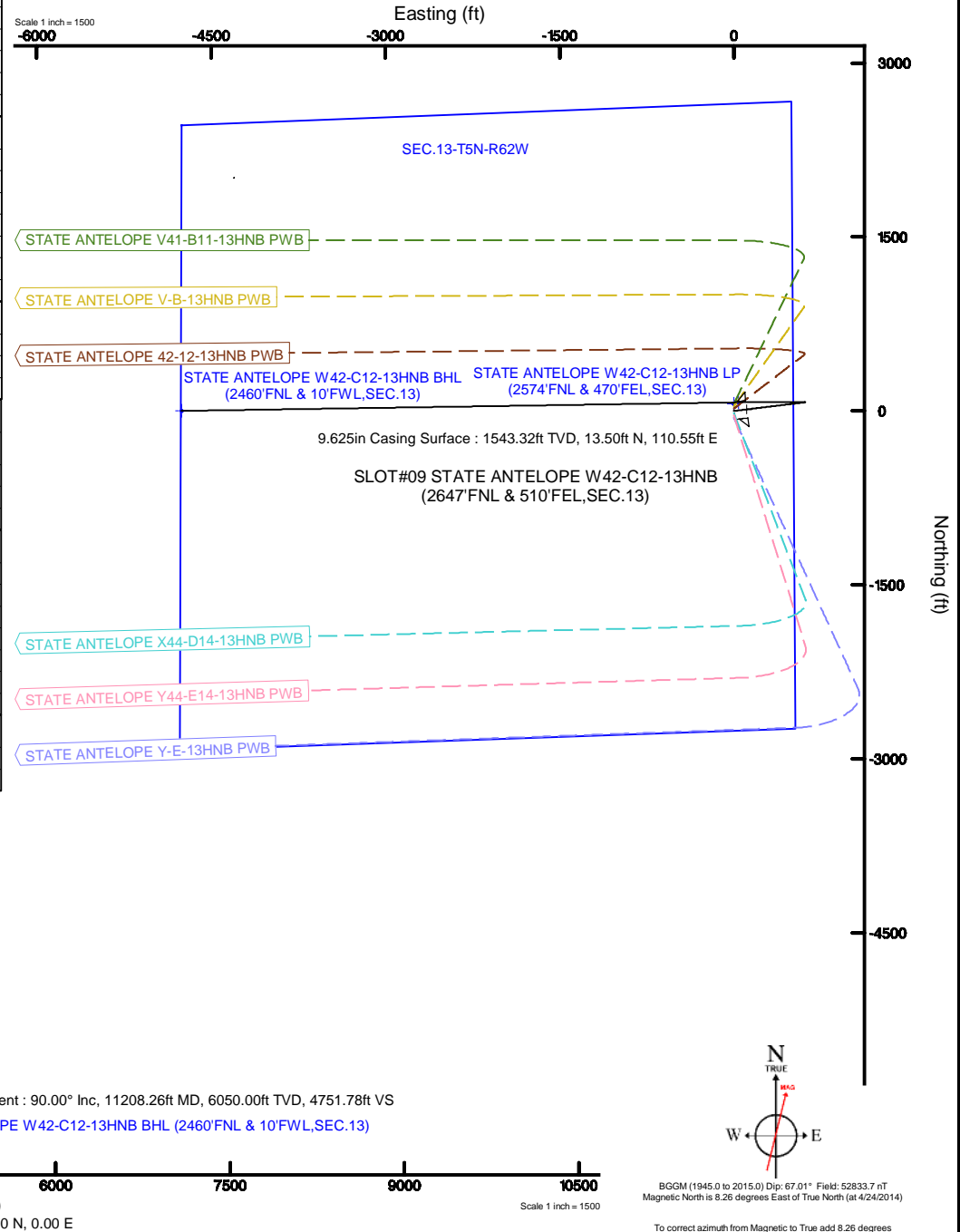
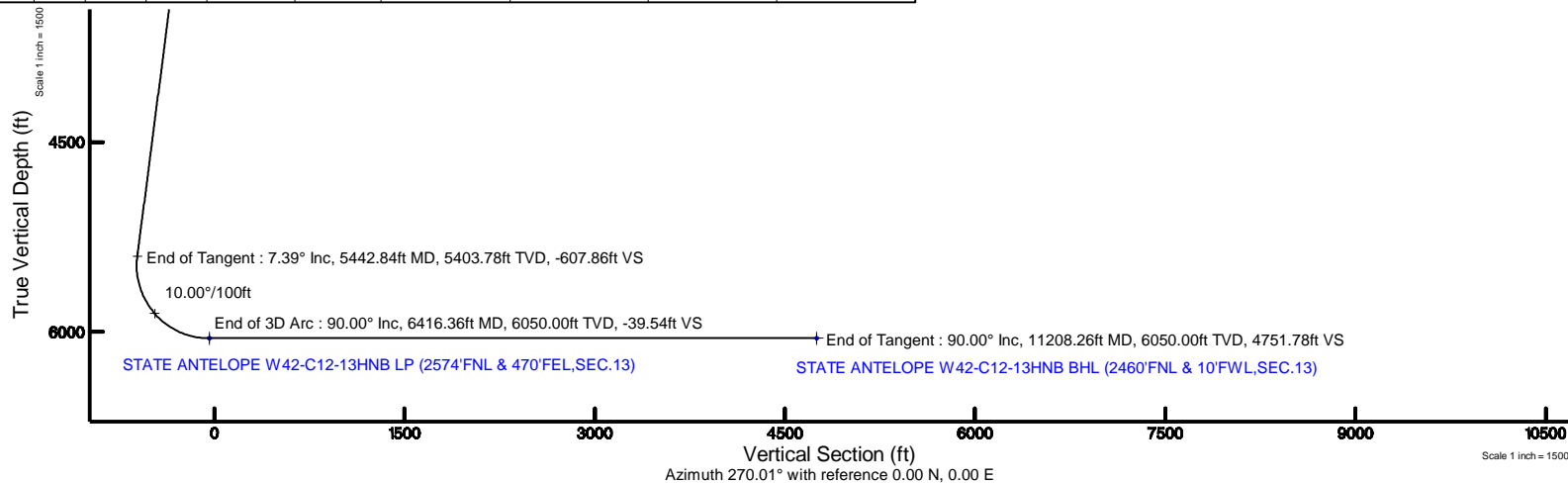



Planned Wellpath Report

STATE ANTELOPE W42-C12-13HNB PWP (REV-A.0)
Page 1 of 6



REFERENCE WELLPATH IDENTIFICATION

| | | | |
|----------|---------------------------|----------|--|
| Operator | BONANZA CREEK OIL COMPANY | Slot | SLOT#09 STATE ANTELOPE W42-C12-13HNB (2647'FNL & 510'FEL,SEC.13) |
| Area | COLORADO | Well | STATE ANTELOPE W42-C12-13HNB |
| Field | WELD COUNTY | Wellbore | STATE ANTELOPE W42-C12-13HNB PWB |
| Facility | SEC.13-T5N-R62W | | |

REPORT SETUP INFORMATION

| | | | |
|---------------------|---|----------------------|--|
| Projection System | NAD83 / Lambert Colorado SP, Northern Zone (501), US feet | Software System | WellArchitect® 5.1 |
| North Reference | True | User | Robiale01 |
| Scale | 0.999960 | Report Generated | 11/15/2018 at 10:08:15 AM |
| Convergence at slot | 0.80° East | Database/Source file | WA DENVER/STATE_ANTELOPE_W42-C12-13HNB_PWP__REV-A.0_.xml |

WELLPATH LOCATION

| | Local coordinates | | Grid coordinates | | Geographic coordinates | |
|-----------------------|-------------------|----------|------------------|-----------------|------------------------|-----------------|
| | North[ft] | East[ft] | Easting[US ft] | Northing[US ft] | Latitude | Longitude |
| Slot Location | 1356.01 | 4472.71 | 3344313.33 | 1391387.28 | 40°24'04.216"N | 104°15'49.216"W |
| Facility Reference Pt | | | 3339859.89 | 1389969.91 | 40°23'50.820"N | 104°16'47.028"W |
| Field Reference Pt | | | 3224525.77 | 1254425.87 | 40°01'44.400"N | 104°41'53.556"W |

WELLPATH DATUM

| | | | |
|--------------------------|-------------------|--|-------------------|
| Calculation method | Minimum curvature | RIG (17') (RKB) to Facility Vertical Datum | 4590.00ft |
| Horizontal Reference Pt | Slot | RIG (17') (RKB) to Mean Sea Level | 4590.00ft |
| Vertical Reference Pt | RIG (17') (RKB) | RIG (17') (RKB) to Ground Level at Slot (SLOT#09 STATE ANTELOPE W42-C12-13HNB (2647'FNL & 510'FEL,SEC.13)) | 4590.00ft |
| MD Reference Pt | RIG (17') (RKB) | Section Origin | N 0.00, E 0.00 ft |
| Field Vertical Reference | Mean Sea Level | Section Azimuth | 270.01° |



Planned Wellpath Report

STATE ANTELOPE W42-C12-13HNB PWP (REV-A.0)

Page 2 of 6



REFERENCE WELLPATH IDENTIFICATION

| | | | |
|----------|---------------------------|----------|---|
| Operator | BONANZA CREEK OIL COMPANY | Slot | SLOT#09 STATE ANTELOPE W42-C12-13HNB (2647'FNL & 510'FEL, SEC.13) |
| Area | COLORADO | Well | STATE ANTELOPE W42-C12-13HNB |
| Field | WELD COUNTY | Wellbore | STATE ANTELOPE W42-C12-13HNB PWB |
| Facility | SEC.13-T5N-R62W | | |

WELLPATH DATA (118 stations) † = interpolated/extrapolated station

| MD [ft] | Inclination [°] | Azimuth [°] | TVD [ft] | Vert Sect [ft] | North [ft] | East [ft] | Latitude | Longitude | DLS [°/100ft] | Comments |
|------------|--------------------|----------------|-------------|-------------------|---------------|--------------|----------------|-----------------|------------------|----------------|
| 0.00† | 0.000 | 83.040 | 0.00 | 0.00 | 0.00 | 0.00 | 40°24'04.216"N | 104°15'49.216"W | 0.00 | |
| 17.00 | 0.000 | 83.040 | 17.00 | 0.00 | 0.00 | 0.00 | 40°24'04.216"N | 104°15'49.216"W | 0.00 | Tie On |
| 117.00† | 0.000 | 83.040 | 117.00 | 0.00 | 0.00 | 0.00 | 40°24'04.216"N | 104°15'49.216"W | 0.00 | |
| 217.00† | 0.000 | 83.040 | 217.00 | 0.00 | 0.00 | 0.00 | 40°24'04.216"N | 104°15'49.216"W | 0.00 | |
| 317.00† | 0.000 | 83.040 | 317.00 | 0.00 | 0.00 | 0.00 | 40°24'04.216"N | 104°15'49.216"W | 0.00 | |
| 417.00† | 0.000 | 83.040 | 417.00 | 0.00 | 0.00 | 0.00 | 40°24'04.216"N | 104°15'49.216"W | 0.00 | |
| 500.00 | 0.000 | 83.040 | 500.00 | 0.00 | 0.00 | 0.00 | 40°24'04.216"N | 104°15'49.216"W | 0.00 | End of Tangent |
| 517.00† | 0.340 | 83.040 | 517.00 | -0.05 | 0.01 | 0.05 | 40°24'04.216"N | 104°15'49.215"W | 2.00 | |
| 617.00† | 2.340 | 83.040 | 616.97 | -2.37 | 0.29 | 2.37 | 40°24'04.218"N | 104°15'49.185"W | 2.00 | |
| 717.00† | 4.340 | 83.040 | 716.79 | -8.15 | 1.00 | 8.15 | 40°24'04.225"N | 104°15'49.110"W | 2.00 | |
| 817.00† | 6.340 | 83.040 | 816.35 | -17.39 | 2.12 | 17.39 | 40°24'04.237"N | 104°15'48.991"W | 2.00 | |
| 869.72 | 7.394 | 83.040 | 868.69 | -23.65 | 2.89 | 23.65 | 40°24'04.244"N | 104°15'48.910"W | 2.00 | End of Build |
| 917.00† | 7.394 | 83.040 | 915.58 | -29.69 | 3.62 | 29.69 | 40°24'04.251"N | 104°15'48.832"W | 0.00 | |
| 1017.00† | 7.394 | 83.040 | 1014.75 | -42.46 | 5.18 | 42.46 | 40°24'04.267"N | 104°15'48.667"W | 0.00 | |
| 1117.00† | 7.394 | 83.040 | 1113.92 | -55.24 | 6.74 | 55.24 | 40°24'04.282"N | 104°15'48.502"W | 0.00 | |
| 1217.00† | 7.394 | 83.040 | 1213.09 | -68.01 | 8.30 | 68.01 | 40°24'04.298"N | 104°15'48.336"W | 0.00 | |
| 1317.00† | 7.394 | 83.040 | 1312.25 | -80.79 | 9.86 | 80.79 | 40°24'04.313"N | 104°15'48.171"W | 0.00 | |
| 1417.00† | 7.394 | 83.040 | 1411.42 | -93.56 | 11.42 | 93.56 | 40°24'04.328"N | 104°15'48.006"W | 0.00 | |
| 1517.00† | 7.394 | 83.040 | 1510.59 | -106.34 | 12.98 | 106.34 | 40°24'04.344"N | 104°15'47.841"W | 0.00 | |
| 1617.00† | 7.394 | 83.040 | 1609.76 | -119.11 | 14.54 | 119.11 | 40°24'04.359"N | 104°15'47.676"W | 0.00 | |
| 1717.00† | 7.394 | 83.040 | 1708.93 | -131.89 | 16.10 | 131.89 | 40°24'04.375"N | 104°15'47.511"W | 0.00 | |
| 1817.00† | 7.394 | 83.040 | 1808.10 | -144.66 | 17.66 | 144.66 | 40°24'04.390"N | 104°15'47.346"W | 0.00 | |
| 1917.00† | 7.394 | 83.040 | 1907.27 | -157.44 | 19.22 | 157.44 | 40°24'04.406"N | 104°15'47.181"W | 0.00 | |
| 2017.00† | 7.394 | 83.040 | 2006.43 | -170.21 | 20.78 | 170.21 | 40°24'04.421"N | 104°15'47.015"W | 0.00 | |
| 2117.00† | 7.394 | 83.040 | 2105.60 | -182.99 | 22.34 | 182.99 | 40°24'04.436"N | 104°15'46.850"W | 0.00 | |
| 2217.00† | 7.394 | 83.040 | 2204.77 | -195.76 | 23.90 | 195.76 | 40°24'04.452"N | 104°15'46.685"W | 0.00 | |
| 2317.00† | 7.394 | 83.040 | 2303.94 | -208.54 | 25.46 | 208.54 | 40°24'04.467"N | 104°15'46.520"W | 0.00 | |
| 2417.00† | 7.394 | 83.040 | 2403.11 | -221.31 | 27.02 | 221.31 | 40°24'04.483"N | 104°15'46.355"W | 0.00 | |
| 2517.00† | 7.394 | 83.040 | 2502.28 | -234.09 | 28.58 | 234.09 | 40°24'04.498"N | 104°15'46.190"W | 0.00 | |
| 2617.00† | 7.394 | 83.040 | 2601.44 | -246.86 | 30.13 | 246.86 | 40°24'04.513"N | 104°15'46.025"W | 0.00 | |
| 2717.00† | 7.394 | 83.040 | 2700.61 | -259.64 | 31.69 | 259.64 | 40°24'04.529"N | 104°15'45.860"W | 0.00 | |
| 2817.00† | 7.394 | 83.040 | 2799.78 | -272.41 | 33.25 | 272.41 | 40°24'04.544"N | 104°15'45.694"W | 0.00 | |
| 2917.00† | 7.394 | 83.040 | 2898.95 | -285.19 | 34.81 | 285.19 | 40°24'04.560"N | 104°15'45.529"W | 0.00 | |
| 3017.00† | 7.394 | 83.040 | 2998.12 | -297.96 | 36.37 | 297.96 | 40°24'04.575"N | 104°15'45.364"W | 0.00 | |
| 3117.00† | 7.394 | 83.040 | 3097.29 | -310.74 | 37.93 | 310.74 | 40°24'04.590"N | 104°15'45.199"W | 0.00 | |
| 3217.00† | 7.394 | 83.040 | 3196.45 | -323.51 | 39.49 | 323.51 | 40°24'04.606"N | 104°15'45.034"W | 0.00 | |

WELLPATH DATA (118 stations) † = interpolated/extrapolated station

| MD [ft] | Inclination [°] | Azimuth [°] | TVD [ft] | Vert Sect [ft] | North [ft] | East [ft] | Latitude | Longitude | DLS [°/100ft] | Comments |
|------------|--------------------|----------------|-------------|-------------------|---------------|--------------|----------------|-----------------|------------------|----------|
| 3317.00† | 7.394 | 83.040 | 3295.62 | -336.29 | 41.05 | 336.29 | 40°24'04.621"N | 104°15'44.869"W | 0.00 | |
| 3417.00† | 7.394 | 83.040 | 3394.79 | -349.06 | 42.61 | 349.06 | 40°24'04.637"N | 104°15'44.704"W | 0.00 | |
| 3517.00† | 7.394 | 83.040 | 3493.96 | -361.84 | 44.17 | 361.84 | 40°24'04.652"N | 104°15'44.539"W | 0.00 | |
| 3617.00† | 7.394 | 83.040 | 3593.13 | -374.61 | 45.73 | 374.61 | 40°24'04.667"N | 104°15'44.373"W | 0.00 | |
| 3717.00† | 7.394 | 83.040 | 3692.30 | -387.38 | 47.29 | 387.39 | 40°24'04.683"N | 104°15'44.208"W | 0.00 | |
| 3817.00† | 7.394 | 83.040 | 3791.46 | -400.16 | 48.85 | 400.16 | 40°24'04.698"N | 104°15'44.043"W | 0.00 | |
| 3917.00† | 7.394 | 83.040 | 3890.63 | -412.93 | 50.41 | 412.94 | 40°24'04.714"N | 104°15'43.878"W | 0.00 | |
| 4017.00† | 7.394 | 83.040 | 3989.80 | -425.71 | 51.97 | 425.71 | 40°24'04.729"N | 104°15'43.713"W | 0.00 | |
| 4117.00† | 7.394 | 83.040 | 4088.97 | -438.48 | 53.53 | 438.49 | 40°24'04.744"N | 104°15'43.548"W | 0.00 | |



Planned Wellpath Report

STATE ANTELOPE W42-C12-13HNB PWP (REV-A.0)
Page 3 of 6



REFERENCE WELLPATH IDENTIFICATION

| | | | |
|----------|---------------------------|----------|---|
| Operator | BONANZA CREEK OIL COMPANY | Slot | SLOT#09 STATE ANTELOPE W42-C12-13HNB (2647'FNL & 510'FEL, SEC.13) |
| Area | COLORADO | Well | STATE ANTELOPE W42-C12-13HNB |
| Field | WELD COUNTY | Wellbore | STATE ANTELOPE W42-C12-13HNB PWB |
| Facility | SEC.13-T5N-R62W | | |

WELLPATH DATA (118 stations) † = interpolated/extrapolated station

| MD [ft] | Inclination [°] | Azimuth [°] | TVD [ft] | Vert Sect [ft] | North [ft] | East [ft] | Latitude | Longitude | DLS [°/100ft] | Comments |
|------------|--------------------|----------------|----------------------|-------------------|---------------|--------------|----------------|-----------------|------------------|----------------|
| 4217.00† | 7.394 | 83.040 | 4188.14 | -451.26 | 55.09 | 451.26 | 40°24'04.760"N | 104°15'43.383"W | 0.00 | |
| 4317.00† | 7.394 | 83.040 | 4287.31 | -464.03 | 56.65 | 464.04 | 40°24'04.775"N | 104°15'43.218"W | 0.00 | |
| 4417.00† | 7.394 | 83.040 | 4386.47 | -476.81 | 58.20 | 476.81 | 40°24'04.791"N | 104°15'43.052"W | 0.00 | |
| 4517.00† | 7.394 | 83.040 | 4485.64 | -489.58 | 59.76 | 489.59 | 40°24'04.806"N | 104°15'42.887"W | 0.00 | |
| 4617.00† | 7.394 | 83.040 | 4584.81 | -502.36 | 61.32 | 502.36 | 40°24'04.822"N | 104°15'42.722"W | 0.00 | |
| 4717.00† | 7.394 | 83.040 | 4683.98 | -515.13 | 62.88 | 515.14 | 40°24'04.837"N | 104°15'42.557"W | 0.00 | |
| 4817.00† | 7.394 | 83.040 | 4783.15 | -527.91 | 64.44 | 527.91 | 40°24'04.852"N | 104°15'42.392"W | 0.00 | |
| 4917.00† | 7.394 | 83.040 | 4882.32 | -540.68 | 66.00 | 540.69 | 40°24'04.868"N | 104°15'42.227"W | 0.00 | |
| 5017.00† | 7.394 | 83.040 | 4981.48 | -553.46 | 67.56 | 553.46 | 40°24'04.883"N | 104°15'42.062"W | 0.00 | |
| 5117.00† | 7.394 | 83.040 | 5080.65 | -566.23 | 69.12 | 566.24 | 40°24'04.899"N | 104°15'41.897"W | 0.00 | |
| 5217.00† | 7.394 | 83.040 | 5179.82 | -579.01 | 70.68 | 579.01 | 40°24'04.914"N | 104°15'41.731"W | 0.00 | |
| 5317.00† | 7.394 | 83.040 | 5278.99 | -591.78 | 72.24 | 591.79 | 40°24'04.929"N | 104°15'41.566"W | 0.00 | |
| 5417.00† | 7.394 | 83.040 | 5378.16 | -604.56 | 73.80 | 604.56 | 40°24'04.945"N | 104°15'41.401"W | 0.00 | |
| 5442.84 | 7.394 | 83.040 | 5403.78 | -607.86 | 74.20 | 607.87 | 40°24'04.949"N | 104°15'41.359"W | 0.00 | End of Tangent |
| 5517.00† | 0.790 | 354.478 | 5477.73 | -612.55 | 75.29 | 612.56 | 40°24'04.960"N | 104°15'41.298"W | 10.00 | |
| 5617.00† | 10.094 | 273.543 | 5577.21 | -603.72 | 76.52 | 603.72 | 40°24'04.972"N | 104°15'41.412"W | 10.00 | |
| 5717.00† | 20.079 | 271.271 | 5673.64 | -577.74 | 77.45 | 577.75 | 40°24'04.981"N | 104°15'41.748"W | 10.00 | |
| 5817.00† | 30.073 | 270.476 | 5764.10 | -535.42 | 78.04 | 535.43 | 40°24'04.987"N | 104°15'42.295"W | 10.00 | |
| 5917.00† | 40.070 | 270.053 | 5845.84 | -478.03 | 78.27 | 478.04 | 40°24'04.989"N | 104°15'43.037"W | 10.00 | |
| 6017.00† | 50.068 | 269.776 | 5916.38 | -407.33 | 78.15 | 407.33 | 40°24'04.988"N | 104°15'43.951"W | 10.00 | |
| 6117.00† | 60.067 | 269.570 | 5973.56 | -325.45 | 77.68 | 325.46 | 40°24'04.983"N | 104°15'45.009"W | 10.00 | |
| 6217.00† | 70.066 | 269.402 | 6015.67 | -234.89 | 76.86 | 234.90 | 40°24'04.975"N | 104°15'46.179"W | 10.00 | |
| 6317.00† | 80.065 | 269.255 | 6041.41 | -138.40 | 75.73 | 138.40 | 40°24'04.964"N | 104°15'47.427"W | 10.00 | |
| 6416.36 | 90.000 | 269.117 | 6050.00 [†] | -39.54 | 74.32 | 39.55 | 40°24'04.950"N | 104°15'48.704"W | 10.00 | End of 3D Arc |
| 6417.00† | 90.000 | 269.117 | 6050.00 | -38.90 | 74.31 | 38.91 | 40°24'04.950"N | 104°15'48.713"W | 0.00 | |
| 6517.00† | 90.000 | 269.117 | 6050.00 | 61.08 | 72.77 | -61.08 | 40°24'04.935"N | 104°15'50.005"W | 0.00 | |
| 6617.00† | 90.000 | 269.117 | 6050.00 | 161.07 | 71.23 | -161.07 | 40°24'04.919"N | 104°15'51.297"W | 0.00 | |
| 6717.00† | 90.000 | 269.117 | 6050.00 | 261.06 | 69.69 | -261.05 | 40°24'04.904"N | 104°15'52.590"W | 0.00 | |
| 6817.00† | 90.000 | 269.117 | 6050.00 | 361.05 | 68.14 | -361.04 | 40°24'04.889"N | 104°15'53.882"W | 0.00 | |
| 6917.00† | 90.000 | 269.117 | 6050.00 | 461.04 | 66.60 | -461.03 | 40°24'04.874"N | 104°15'55.175"W | 0.00 | |
| 7017.00† | 90.000 | 269.117 | 6050.00 | 561.02 | 65.06 | -561.02 | 40°24'04.858"N | 104°15'56.467"W | 0.00 | |
| 7117.00† | 90.000 | 269.117 | 6050.00 | 661.01 | 63.52 | -661.01 | 40°24'04.843"N | 104°15'57.760"W | 0.00 | |
| 7217.00† | 90.000 | 269.117 | 6050.00 | 761.00 | 61.98 | -760.99 | 40°24'04.828"N | 104°15'59.052"W | 0.00 | |
| 7317.00† | 90.000 | 269.117 | 6050.00 | 860.99 | 60.44 | -860.98 | 40°24'04.813"N | 104°16'00.344"W | 0.00 | |
| 7417.00† | 90.000 | 269.117 | 6050.00 | 960.98 | 58.90 | -960.97 | 40°24'04.797"N | 104°16'01.637"W | 0.00 | |

WELLPATH DATA (118 stations) † = interpolated/extrapolated station

| MD [ft] | Inclination [°] | Azimuth [°] | TVD [ft] | Vert Sect [ft] | North [ft] | East [ft] | Latitude | Longitude | DLS [°/100ft] | Comments |
|------------|--------------------|----------------|-------------|-------------------|---------------|--------------|----------------|-----------------|------------------|----------|
| 7517.00† | 90.000 | 269.117 | 6050.00 | 1060.96 | 57.35 | -1060.96 | 40°24'04.782"N | 104°16'02.929"W | 0.00 | |
| 7617.00† | 90.000 | 269.117 | 6050.00 | 1160.95 | 55.81 | -1160.95 | 40°24'04.767"N | 104°16'04.222"W | 0.00 | |
| 7717.00† | 90.000 | 269.117 | 6050.00 | 1260.94 | 54.27 | -1260.93 | 40°24'04.752"N | 104°16'05.514"W | 0.00 | |
| 7817.00† | 90.000 | 269.117 | 6050.00 | 1360.93 | 52.73 | -1360.92 | 40°24'04.736"N | 104°16'06.806"W | 0.00 | |
| 7917.00† | 90.000 | 269.117 | 6050.00 | 1460.92 | 51.19 | -1460.91 | 40°24'04.721"N | 104°16'08.099"W | 0.00 | |
| 8017.00† | 90.000 | 269.117 | 6050.00 | 1560.90 | 49.65 | -1560.90 | 40°24'04.706"N | 104°16'09.391"W | 0.00 | |
| 8117.00† | 90.000 | 269.117 | 6050.00 | 1660.89 | 48.11 | -1660.89 | 40°24'04.690"N | 104°16'10.684"W | 0.00 | |
| 8217.00† | 90.000 | 269.117 | 6050.00 | 1760.88 | 46.56 | -1760.88 | 40°24'04.675"N | 104°16'11.976"W | 0.00 | |
| 8317.00† | 90.000 | 269.117 | 6050.00 | 1860.87 | 45.02 | -1860.86 | 40°24'04.660"N | 104°16'13.268"W | 0.00 | |
| 8417.00† | 90.000 | 269.117 | 6050.00 | 1960.86 | 43.48 | -1960.85 | 40°24'04.645"N | 104°16'14.561"W | 0.00 | |



Planned Wellpath Report

STATE ANTELOPE W42-C12-13HNB PWP (REV-A.0)
Page 4 of 6



REFERENCE WELLPATH IDENTIFICATION

| | | | |
|----------|---------------------------|----------|---|
| Operator | BONANZA CREEK OIL COMPANY | Slot | SLOT#09 STATE ANTELOPE W42-C12-13HNB (2647'FNL & 510'FEL, SEC.13) |
| Area | COLORADO | Well | STATE ANTELOPE W42-C12-13HNB |
| Field | WELD COUNTY | Wellbore | STATE ANTELOPE W42-C12-13HNB PWB |
| Facility | SEC.13-T5N-R62W | | |

WELLPATH DATA (118 stations) † = interpolated/extrapolated station

| MD [ft] | Inclination [°] | Azimuth [°] | TVD [ft] | Vert Sect [ft] | North [ft] | East [ft] | Latitude | Longitude | DLS [°/100ft] | Comments |
|------------|--------------------|----------------|----------------------|-------------------|---------------|--------------|----------------|-----------------|------------------|----------------|
| 8517.00† | 90.000 | 269.117 | 6050.00 | 2060.84 | 41.94 | -2060.84 | 40°24'04.629"N | 104°16'15.853"W | 0.00 | |
| 8617.00† | 90.000 | 269.117 | 6050.00 | 2160.83 | 40.40 | -2160.83 | 40°24'04.614"N | 104°16'17.146"W | 0.00 | |
| 8717.00† | 90.000 | 269.117 | 6050.00 | 2260.82 | 38.86 | -2260.82 | 40°24'04.599"N | 104°16'18.438"W | 0.00 | |
| 8817.00† | 90.000 | 269.117 | 6050.00 | 2360.81 | 37.32 | -2360.80 | 40°24'04.583"N | 104°16'19.730"W | 0.00 | |
| 8917.00† | 90.000 | 269.117 | 6050.00 | 2460.80 | 35.77 | -2460.79 | 40°24'04.568"N | 104°16'21.023"W | 0.00 | |
| 9017.00† | 90.000 | 269.117 | 6050.00 | 2560.78 | 34.23 | -2560.78 | 40°24'04.553"N | 104°16'22.315"W | 0.00 | |
| 9117.00† | 90.000 | 269.117 | 6050.00 | 2660.77 | 32.69 | -2660.77 | 40°24'04.537"N | 104°16'23.608"W | 0.00 | |
| 9217.00† | 90.000 | 269.117 | 6050.00 | 2760.76 | 31.15 | -2760.76 | 40°24'04.522"N | 104°16'24.900"W | 0.00 | |
| 9317.00† | 90.000 | 269.117 | 6050.00 | 2860.75 | 29.61 | -2860.74 | 40°24'04.507"N | 104°16'26.192"W | 0.00 | |
| 9417.00† | 90.000 | 269.117 | 6050.00 | 2960.74 | 28.07 | -2960.73 | 40°24'04.491"N | 104°16'27.485"W | 0.00 | |
| 9517.00† | 90.000 | 269.117 | 6050.00 | 3060.72 | 26.53 | -3060.72 | 40°24'04.476"N | 104°16'28.777"W | 0.00 | |
| 9617.00† | 90.000 | 269.117 | 6050.00 | 3160.71 | 24.98 | -3160.71 | 40°24'04.460"N | 104°16'30.070"W | 0.00 | |
| 9717.00† | 90.000 | 269.117 | 6050.00 | 3260.70 | 23.44 | -3260.70 | 40°24'04.445"N | 104°16'31.362"W | 0.00 | |
| 9817.00† | 90.000 | 269.117 | 6050.00 | 3360.69 | 21.90 | -3360.69 | 40°24'04.430"N | 104°16'32.654"W | 0.00 | |
| 9917.00† | 90.000 | 269.117 | 6050.00 | 3460.68 | 20.36 | -3460.67 | 40°24'04.414"N | 104°16'33.947"W | 0.00 | |
| 10017.00† | 90.000 | 269.117 | 6050.00 | 3560.66 | 18.82 | -3560.66 | 40°24'04.399"N | 104°16'35.239"W | 0.00 | |
| 10117.00† | 90.000 | 269.117 | 6050.00 | 3660.65 | 17.28 | -3660.65 | 40°24'04.384"N | 104°16'36.532"W | 0.00 | |
| 10217.00† | 90.000 | 269.117 | 6050.00 | 3760.64 | 15.74 | -3760.64 | 40°24'04.368"N | 104°16'37.824"W | 0.00 | |
| 10317.00† | 90.000 | 269.117 | 6050.00 | 3860.63 | 14.20 | -3860.63 | 40°24'04.353"N | 104°16'39.117"W | 0.00 | |
| 10417.00† | 90.000 | 269.117 | 6050.00 | 3960.62 | 12.65 | -3960.61 | 40°24'04.338"N | 104°16'40.409"W | 0.00 | |
| 10517.00† | 90.000 | 269.117 | 6050.00 | 4060.60 | 11.11 | -4060.60 | 40°24'04.322"N | 104°16'41.701"W | 0.00 | |
| 10617.00† | 90.000 | 269.117 | 6050.00 | 4160.59 | 9.57 | -4160.59 | 40°24'04.307"N | 104°16'42.994"W | 0.00 | |
| 10717.00† | 90.000 | 269.117 | 6050.00 | 4260.58 | 8.03 | -4260.58 | 40°24'04.291"N | 104°16'44.286"W | 0.00 | |
| 10817.00† | 90.000 | 269.117 | 6050.00 | 4360.57 | 6.49 | -4360.57 | 40°24'04.276"N | 104°16'45.579"W | 0.00 | |
| 10917.00† | 90.000 | 269.117 | 6050.00 | 4460.56 | 4.95 | -4460.55 | 40°24'04.261"N | 104°16'46.871"W | 0.00 | |
| 11017.00† | 90.000 | 269.117 | 6050.00 | 4560.54 | 3.41 | -4560.54 | 40°24'04.245"N | 104°16'48.163"W | 0.00 | |
| 11117.00† | 90.000 | 269.117 | 6050.00 | 4660.53 | 1.86 | -4660.53 | 40°24'04.230"N | 104°16'49.456"W | 0.00 | |
| 11208.26 | 90.000 | 269.117 | 6050.00 ² | 4751.78 | 0.46 | -4751.78 | 40°24'04.216"N | 104°16'50.635"W | 0.00 | End of Tangent |

HOLE & CASING SECTIONS - Ref Wellbore: STATE ANTELOPE W42-C12-13HNB PWB Ref Wellpath: STATE ANTELOPE W42-C12-13HNB PWP (REV-A.0)

| String/Diameter | Start MD [ft] | End MD [ft] | Interval [ft] | Start TVD [ft] | End TVD [ft] | Start N/S [ft] | Start E/W [ft] | End N/S [ft] | End E/W [ft] |
|------------------------|------------------|----------------|------------------|-------------------|-----------------|-------------------|-------------------|-----------------|-----------------|
| 13.5in Open Hole | 17.00 | 1550.00 | 1533.00 | 17.00 | 1543.32 | 0.00 | 0.00 | 13.50 | 110.55 |
| 9.625in Casing Surface | 17.00 | 1550.00 | 1533.00 | 17.00 | 1543.32 | 0.00 | 0.00 | 13.50 | 110.55 |

HOLE & CASING SECTIONS - Ref Wellbore: STATE ANTELOPE W42-C12-13HNB PWB Ref Wellpath: STATE ANTELOPE W42-C12-13HNB PWP (REV-A.0)

| String/Diameter | Start MD [ft] | End MD [ft] | Interval [ft] | Start TVD [ft] | End TVD [ft] | Start N/S [ft] | Start E/W [ft] | End N/S [ft] | End E/W [ft] |
|-----------------|------------------|----------------|------------------|-------------------|-----------------|-------------------|-------------------|-----------------|-----------------|
| 8.5in Open Hole | 1550.00 | 11208.26 | 9658.26 | 1543.32 | 6050.00 | 13.50 | 110.55 | 0.46 | -4751.78 |



Planned Wellpath Report

STATE ANTELOPE W42-C12-13HNB PWP (REV-A.0)
Page 5 of 6



REFERENCE WELLPATH IDENTIFICATION

| | | | |
|----------|---------------------------|----------|---|
| Operator | BONANZA CREEK OIL COMPANY | Slot | SLOT#09 STATE ANTELOPE W42-C12-13HNB (2647'FNL & 510'FEL, SEC.13) |
| Area | COLORADO | Well | STATE ANTELOPE W42-C12-13HNB |
| Field | WELD COUNTY | Wellbore | STATE ANTELOPE W42-C12-13HNB PWB |
| Facility | SEC.13-T5N-R62W | | |

TARGETS

| Name | MD [ft] | TVD [ft] | North [ft] | East [ft] | Grid East [US ft] | Grid North [US ft] | Latitude | Longitude | Shape |
|---|----------|----------|------------|-----------|-------------------|--------------------|----------------|-----------------|---------|
| SEC.13-T5N-R62W | | 0.00 | 60.11 | -0.28 | 3344312.21 | 1391447.38 | 40°24'04.810"N | 104°15'49.219"W | polygon |
| 2) STATE ANTELOPE W42-C12-13HNB BHL (2460'FNL & 10'FWL, SEC.13) | 11208.26 | 6050.00 | 0.46 | -4751.78 | 3339562.20 | 1391321.49 | 40°24'04.216"N | 104°16'50.635"W | point |
| 1) STATE ANTELOPE W42-C12-13HNB LP (2574'FNL & 470'FEL, SEC.13) | 6416.36 | 6050.00 | 74.32 | 39.55 | 3344351.83 | 1391462.14 | 40°24'04.950"N | 104°15'48.704"W | point |

SURVEY PROGRAM - Ref Wellbore: STATE ANTELOPE W42-C12-13HNB PWB Ref Wellpath: STATE ANTELOPE W42-C12-13HNB PWP (REV-A.0)

| Start MD [ft] | End MD [ft] | Positional Uncertainty Model | Log Name/Comment | Wellbore |
|---------------|-------------|------------------------------|------------------|----------------------------------|
| 17.00 | 1550.00 | BHI NaviTrak (Rotating) | | STATE ANTELOPE W42-C12-13HNB PWB |
| 1550.00 | 11208.26 | BHI AutoTrak Curve (Short) | | STATE ANTELOPE W42-C12-13HNB PWB |



Planned Wellpath Report

STATE ANTELOPE W42-C12-13HNB PWP (REV-A.0)
Page 6 of 6



| REFERENCE WELLPATH IDENTIFICATION | | | |
|-----------------------------------|---------------------------|----------|---|
| Operator | BONANZA CREEK OIL COMPANY | Slot | SLOT#09 STATE ANTELOPE W42-C12-13HNB (2647'FNL & 510'FEL, SEC.13) |
| Area | COLORADO | Well | STATE ANTELOPE W42-C12-13HNB |
| Field | WELD COUNTY | Wellbore | STATE ANTELOPE W42-C12-13HNB PWB |
| Facility | SEC.13-T5N-R62W | | |

| DESIGN COMMENTS | | | | |
|-----------------|--------------------|----------------|-------------|----------------|
| MD [ft] | Inclination [°] | Azimuth [°] | TVD [ft] | Comment |
| 17.00 | 0.000 | 83.040 | 17.00 | Tie On |
| 500.00 | 0.000 | 83.040 | 500.00 | End of Tangent |
| 869.72 | 7.394 | 83.040 | 868.69 | End of Build |
| 5442.84 | 7.394 | 83.040 | 5403.78 | End of Tangent |
| 6416.36 | 90.000 | 269.117 | 6050.00 | End of 3D Arc |
| 11208.26 | 90.000 | 269.117 | 6050.00 | End of Tangent |