

Location:	COLORADO	Slot:	SLOT#05 WILLOW 22-18-3L (185'FSL & 1146'FWL,SEC.22)
Field:	WELD COUNTY (NAD83, TRUE NORTH)	Well:	WILLOW 22-18-3L
Facility:	SEC.22-T01N-R65W	Wellbore:	WILLOW 22-18-3L PWB
Plot reference wellpath is WILLOW 22-18-3L PWP (REV-A.0)		Grid System: NAD83 / Lambert Colorado SP, Northern Zone (501), US feet	
True vertical depths are referenced to RIG (17) (RKB)		North Reference: True north	
Measured depths are referenced to RIG (17) (RKB)		Scale: True distance	
RIG (17) (RKB) to Mean Sea Level: 5107 feet		Depths are in feet	
Mean Sea Level to Mud line (At Slot: SLOT#05 WILLOW 22-18-3L (185'FSL & 1146'FWL,SEC.22)): 0 feet		Created by: robale01 on 2019-02-27	
Coordinates are in feet referenced to Slot		Database: WA DENVER	

Targets								
Name	MD (ft)	TVD (ft)	Local N (ft)	Local E (ft)	Grid East (US ft)	Grid North (US ft)	Latitude	Longitude
HARDLINES SEC.10,15,22-T01N-R65W 460N5&EW		-1.00	0.00	-98.01	3236383.46	1254962.14	40°01'48.612"N	104°39'21.060"W
SEC.10-T01N-R65W		-1.00	0.00	-98.01	3236383.46	1254962.14	40°01'48.612"N	104°39'21.060"W
SEC.15-T01N-R65W		-1.00	0.00	-98.01	3236383.46	1254962.14	40°01'48.612"N	104°39'21.060"W
SEC.22-T01N-R65W		-1.00	0.00	-98.01	3236383.46	1254962.14	40°01'48.612"N	104°39'21.060"W
WILLOW 22-18-3L BHL ON PLAT (2179F&SL & 1121F&W,SEC.10)	19958.56	7327.00	1285.47	-9.85	3236351.76	1267547.40	40°03'52.985"N	104°39'19.927"W
WILLOW 22-18-3L LP ON PLAT (470F&SL & 1121F&W,SEC.22)	7660.87	7327.00	287.79	-25.20	3236453.53	1255250.59	40°01'51.456"N	104°39'20.124"W

Well Profile Data								
Design Comment	MD (ft)	Inc (°)	Az (°)	TVD (ft)	Local N (ft)	Local E (ft)	DLS (°/100ft)	VS (ft)
Tie On	17.00	0.000	184.737	17.00	0.00	0.00	0.00	0.00
End of Tangent	700.00	0.000	184.737	700.00	0.00	0.00	0.00	0.00
End of Build	837.17	2.743	184.737	837.11	-3.27	-0.27	2.00	-3.27
End of Tangent	6733.52	2.743	184.737	6726.71	-284.52	-23.58	0.00	-284.50
End of 3D Arc	7660.87	90.000	0.072	7327.00	287.79	-25.20	10.00	287.81
End of Tangent	19958.56	90.000	0.072	7327.00	12585.47	-9.85	0.00	12585.46

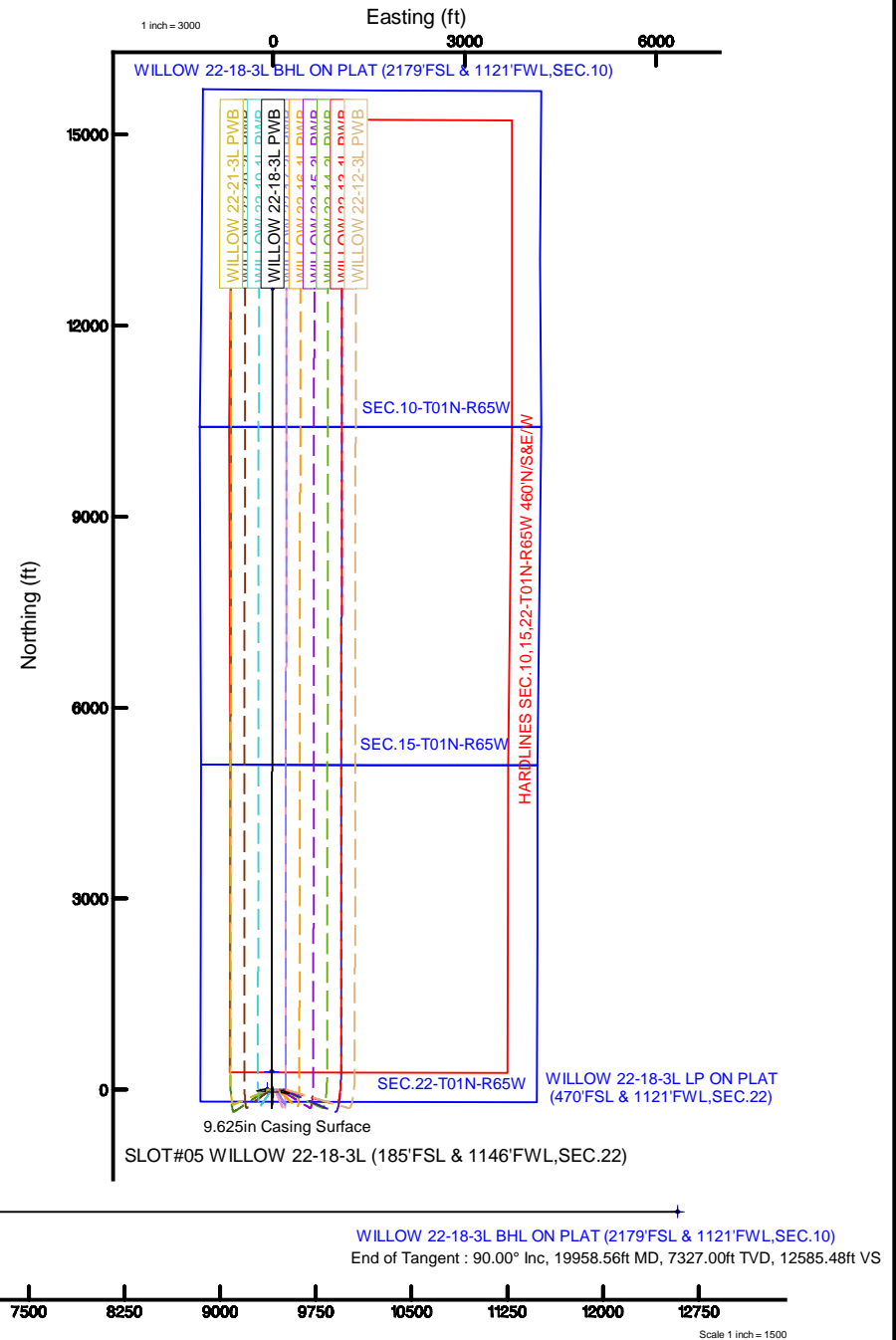

Planned Wellpath Report

WILLOW 22-18-3L PWP (REV-A.0)

Page 1 of 8

REFERENCE WELLPATH IDENTIFICATION

Operator	CONFLUENCE RESOURCES	Slot	SLOT#05 WILLOW 22-18-3L (185'FSL & 1146'FWL,SEC.22)
Area	COLORADO	Well	WILLOW 22-18-3L
Field	WELD COUNTY (NAD83, TRUE NORTH)	Wellbore	WILLOW 22-18-3L PWB
Facility	SEC.22-T01N-R65W		

REPORT SETUP INFORMATION

Projection System	NAD83 / Lambert Colorado SP, Northern Zone (501), US feet	Software System	WellArchitect® 5.1
North Reference	True	User	Robiale01
Scale	0.999964	Report Generated	2/27/2019 at 12:47:19 PM
Convergence at slot	0.55° East	Database/Source file	WA DENVER/WILLOW_22-18-3L_PWP__REV-A.0_.xml

WELLPATH LOCATION

	Local coordinates		Grid coordinates		Geographic coordinates	
	North[ft]	East[ft]	Easting[US ft]	Northing[US ft]	Latitude	Longitude
Slot Location	0.00	98.01	3236481.47	1254963.07	40°01'48.612"N	104°39'19.800"W
Facility Reference Pt			3236383.46	1254962.14	40°01'48.612"N	104°39'21.060"W
Field Reference Pt			3230456.90	1245096.09	40°00'11.664"N	104°40'38.424"W

WELLPATH DATUM

Calculation method	Minimum curvature	RIG (17') (RKB) to Facility Vertical Datum	5107.00ft
Horizontal Reference Pt	Slot	RIG (17') (RKB) to Mean Sea Level	5107.00ft
Vertical Reference Pt	RIG (17') (RKB)	RIG (17') (RKB) to Mud Line at Slot (SLOT#05 WILLOW 22-18-3L (185'FSL & 1146'FWL,SEC.22))	5107.00ft
MD Reference Pt	RIG (17') (RKB)	Section Origin	N 0.00, E 0.00 ft
Field Vertical Reference	Mean Sea Level	Section Azimuth	359.96°

Planned Wellpath Report

WILLOW 22-18-3L PWP (REV-A.0)

Page 2 of 8

REFERENCE WELLPATH IDENTIFICATION

Operator	CONFLUENCE RESOURCES	Slot	SLOT#05 WILLOW 22-18-3L (185'FSL & 1146'FWL,SEC.22)
Area	COLORADO	Well	WILLOW 22-18-3L
Field	WELD COUNTY (NAD83, TRUE NORTH)	Wellbore	WILLOW 22-18-3L PWB
Facility	SEC.22-T01N-R65W		

WELLPATH DATA (206 stations) † = interpolated/extrapolated station

MD [ft]	Inclination [°]	Azimuth [°]	TVD [ft]	Vert Sect [ft]	North [ft]	East [ft]	Latitude	Longitude	DLS [°/100ft]	Comments
0.00†	0.000	184.737	0.00	0.00	0.00	0.00	40°01'48.612"N	104°39'19.800"W	0.00	
17.00	0.000	184.737	17.00	0.00	0.00	0.00	40°01'48.612"N	104°39'19.800"W	0.00	Tie On
117.00†	0.000	184.737	117.00	0.00	0.00	0.00	40°01'48.612"N	104°39'19.800"W	0.00	
217.00†	0.000	184.737	217.00	0.00	0.00	0.00	40°01'48.612"N	104°39'19.800"W	0.00	
317.00†	0.000	184.737	317.00	0.00	0.00	0.00	40°01'48.612"N	104°39'19.800"W	0.00	
417.00†	0.000	184.737	417.00	0.00	0.00	0.00	40°01'48.612"N	104°39'19.800"W	0.00	
517.00†	0.000	184.737	517.00	0.00	0.00	0.00	40°01'48.612"N	104°39'19.800"W	0.00	
617.00†	0.000	184.737	617.00	0.00	0.00	0.00	40°01'48.612"N	104°39'19.800"W	0.00	
700.00	0.000	184.737	700.00	0.00	0.00	0.00	40°01'48.612"N	104°39'19.800"W	0.00	End of Tangent
717.00†	0.340	184.737	717.00	-0.05	-0.05	0.00	40°01'48.612"N	104°39'19.800"W	2.00	
817.00†	2.340	184.737	816.97	-2.38	-2.38	-0.20	40°01'48.588"N	104°39'19.803"W	2.00	
837.17	2.743	184.737	837.11	-3.27	-3.27	-0.27	40°01'48.580"N	104°39'19.803"W	2.00	End of Build
917.00†	2.743	184.737	916.86	-7.08	-7.08	-0.59	40°01'48.542"N	104°39'19.808"W	0.00	
1017.00†	2.743	184.737	1016.74	-11.85	-11.85	-0.98	40°01'48.495"N	104°39'19.813"W	0.00	
1117.00†	2.743	184.737	1116.63	-16.62	-16.62	-1.38	40°01'48.448"N	104°39'19.818"W	0.00	
1217.00†	2.743	184.737	1216.51	-21.39	-21.39	-1.77	40°01'48.401"N	104°39'19.823"W	0.00	
1317.00†	2.743	184.737	1316.40	-26.16	-26.16	-2.17	40°01'48.353"N	104°39'19.828"W	0.00	
1417.00†	2.743	184.737	1416.28	-30.93	-30.93	-2.56	40°01'48.306"N	104°39'19.833"W	0.00	
1517.00†	2.743	184.737	1516.17	-35.70	-35.70	-2.96	40°01'48.259"N	104°39'19.838"W	0.00	
1617.00†	2.743	184.737	1616.05	-40.47	-40.47	-3.35	40°01'48.212"N	104°39'19.843"W	0.00	
1717.00†	2.743	184.737	1715.94	-45.24	-45.24	-3.75	40°01'48.165"N	104°39'19.848"W	0.00	
1817.00†	2.743	184.737	1815.82	-50.01	-50.01	-4.14	40°01'48.118"N	104°39'19.853"W	0.00	
1917.00†	2.743	184.737	1915.71	-54.77	-54.78	-4.54	40°01'48.071"N	104°39'19.858"W	0.00	
2017.00†	2.743	184.737	2015.60	-59.54	-59.55	-4.93	40°01'48.024"N	104°39'19.863"W	0.00	
2117.00†	2.743	184.737	2115.48	-64.31	-64.32	-5.33	40°01'47.976"N	104°39'19.869"W	0.00	
2217.00†	2.743	184.737	2215.37	-69.08	-69.09	-5.73	40°01'47.929"N	104°39'19.874"W	0.00	
2317.00†	2.743	184.737	2315.25	-73.85	-73.86	-6.12	40°01'47.882"N	104°39'19.879"W	0.00	
2417.00†	2.743	184.737	2415.14	-78.62	-78.63	-6.52	40°01'47.835"N	104°39'19.884"W	0.00	
2517.00†	2.743	184.737	2515.02	-83.39	-83.40	-6.91	40°01'47.788"N	104°39'19.889"W	0.00	
2617.00†	2.743	184.737	2614.91	-88.16	-88.17	-7.31	40°01'47.741"N	104°39'19.894"W	0.00	
2717.00†	2.743	184.737	2714.79	-92.93	-92.94	-7.70	40°01'47.694"N	104°39'19.899"W	0.00	
2817.00†	2.743	184.737	2814.68	-97.70	-97.71	-8.10	40°01'47.646"N	104°39'19.904"W	0.00	
2917.00†	2.743	184.737	2914.56	-102.47	-102.48	-8.49	40°01'47.599"N	104°39'19.909"W	0.00	
3017.00†	2.743	184.737	3014.45	-107.24	-107.25	-8.89	40°01'47.552"N	104°39'19.914"W	0.00	
3117.00†	2.743	184.737	3114.33	-112.01	-112.02	-9.28	40°01'47.505"N	104°39'19.919"W	0.00	
3217.00†	2.743	184.737	3214.22	-116.78	-116.79	-9.68	40°01'47.458"N	104°39'19.924"W	0.00	

WELLPATH DATA (206 stations) † = interpolated/extrapolated station										
MD [ft]	Inclination [°]	Azimuth [°]	TVD [ft]	Vert Sect [ft]	North [ft]	East [ft]	Latitude	Longitude	DLS [°/100ft]	Comments
3317.00†	2.743	184.737	3314.11	-121.55	-121.56	-10.07	40°01'47.411"N	104°39'19.929"W	0.00	
3417.00†	2.743	184.737	3413.99	-126.32	-126.33	-10.47	40°01'47.364"N	104°39'19.935"W	0.00	
3517.00†	2.743	184.737	3513.88	-131.09	-131.10	-10.86	40°01'47.316"N	104°39'19.940"W	0.00	
3617.00†	2.743	184.737	3613.76	-135.86	-135.87	-11.26	40°01'47.269"N	104°39'19.945"W	0.00	
3717.00†	2.743	184.737	3713.65	-140.63	-140.64	-11.65	40°01'47.222"N	104°39'19.950"W	0.00	
3817.00†	2.743	184.737	3813.53	-145.40	-145.41	-12.05	40°01'47.175"N	104°39'19.955"W	0.00	
3917.00†	2.743	184.737	3913.42	-150.17	-150.18	-12.44	40°01'47.128"N	104°39'19.960"W	0.00	
4017.00†	2.743	184.737	4013.30	-154.94	-154.95	-12.84	40°01'47.081"N	104°39'19.965"W	0.00	
4117.00†	2.743	184.737	4113.19	-159.70	-159.72	-13.24	40°01'47.034"N	104°39'19.970"W	0.00	

Planned Wellpath Report

WILLOW 22-18-3L PWP (REV-A.0)

Page 3 of 8

REFERENCE WELLPATH IDENTIFICATION

Operator	CONFLUENCE RESOURCES	Slot	SLOT#05 WILLOW 22-18-3L (185'FSL & 1146'FWL,SEC.22)
Area	COLORADO	Well	WILLOW 22-18-3L
Field	WELD COUNTY (NAD83, TRUE NORTH)	Wellbore	WILLOW 22-18-3L PWB
Facility	SEC.22-T01N-R65W		

WELLPATH DATA (206 stations) † = interpolated/extrapolated station

MD [ft]	Inclination [°]	Azimuth [°]	TVD [ft]	Vert Sect [ft]	North [ft]	East [ft]	Latitude	Longitude	DLS [°/100ft]	Comments
4217.00†	2.743	184.737	4213.07	-164.47	-164.49	-13.63	40°01'46.987"N	104°39'19.975"W	0.00	
4317.00†	2.743	184.737	4312.96	-169.24	-169.26	-14.03	40°01'46.939"N	104°39'19.980"W	0.00	
4417.00†	2.743	184.737	4412.84	-174.01	-174.02	-14.42	40°01'46.892"N	104°39'19.985"W	0.00	
4517.00†	2.743	184.737	4512.73	-178.78	-178.79	-14.82	40°01'46.845"N	104°39'19.990"W	0.00	
4617.00†	2.743	184.737	4612.62	-183.55	-183.56	-15.21	40°01'46.798"N	104°39'19.996"W	0.00	
4717.00†	2.743	184.737	4712.50	-188.32	-188.33	-15.61	40°01'46.751"N	104°39'20.001"W	0.00	
4817.00†	2.743	184.737	4812.39	-193.09	-193.10	-16.00	40°01'46.704"N	104°39'20.006"W	0.00	
4917.00†	2.743	184.737	4912.27	-197.86	-197.87	-16.40	40°01'46.657"N	104°39'20.011"W	0.00	
5017.00†	2.743	184.737	5012.16	-202.63	-202.64	-16.79	40°01'46.609"N	104°39'20.016"W	0.00	
5117.00†	2.743	184.737	5112.04	-207.40	-207.41	-17.19	40°01'46.562"N	104°39'20.021"W	0.00	
5217.00†	2.743	184.737	5211.93	-212.17	-212.18	-17.58	40°01'46.515"N	104°39'20.026"W	0.00	
5317.00†	2.743	184.737	5311.81	-216.94	-216.95	-17.98	40°01'46.468"N	104°39'20.031"W	0.00	
5417.00†	2.743	184.737	5411.70	-221.71	-221.72	-18.37	40°01'46.421"N	104°39'20.036"W	0.00	
5517.00†	2.743	184.737	5511.58	-226.48	-226.49	-18.77	40°01'46.374"N	104°39'20.041"W	0.00	
5617.00†	2.743	184.737	5611.47	-231.25	-231.26	-19.16	40°01'46.327"N	104°39'20.046"W	0.00	
5717.00†	2.743	184.737	5711.36	-236.02	-236.03	-19.56	40°01'46.279"N	104°39'20.051"W	0.00	
5817.00†	2.743	184.737	5811.24	-240.79	-240.80	-19.96	40°01'46.232"N	104°39'20.057"W	0.00	
5917.00†	2.743	184.737	5911.13	-245.56	-245.57	-20.35	40°01'46.185"N	104°39'20.062"W	0.00	
6017.00†	2.743	184.737	6011.01	-250.33	-250.34	-20.75	40°01'46.138"N	104°39'20.067"W	0.00	
6117.00†	2.743	184.737	6110.90	-255.10	-255.11	-21.14	40°01'46.091"N	104°39'20.072"W	0.00	
6217.00†	2.743	184.737	6210.78	-259.87	-259.88	-21.54	40°01'46.044"N	104°39'20.077"W	0.00	
6317.00†	2.743	184.737	6310.67	-264.63	-264.65	-21.93	40°01'45.997"N	104°39'20.082"W	0.00	
6417.00†	2.743	184.737	6410.55	-269.40	-269.42	-22.33	40°01'45.949"N	104°39'20.087"W	0.00	
6517.00†	2.743	184.737	6510.44	-274.17	-274.19	-22.72	40°01'45.902"N	104°39'20.092"W	0.00	
6617.00†	2.743	184.737	6610.32	-278.94	-278.96	-23.12	40°01'45.855"N	104°39'20.097"W	0.00	
6717.00†	2.743	184.737	6710.21	-283.71	-283.73	-23.51	40°01'45.808"N	104°39'20.102"W	0.00	
6733.52	2.743	184.737	6726.71	-284.50	-284.52	-23.58	40°01'45.800"N	104°39'20.103"W	0.00	End of Tangent
6817.00†	5.618	357.801	6810.09	-282.41	-282.42	-23.90	40°01'45.821"N	104°39'20.107"W	10.00	
6917.00†	15.615	359.272	6908.25	-264.01	-264.03	-24.26	40°01'46.003"N	104°39'20.112"W	10.00	
7017.00†	25.614	359.606	7001.73	-228.85	-228.87	-24.58	40°01'46.350"N	104°39'20.116"W	10.00	
7117.00†	35.614	359.760	7087.68	-177.99	-178.01	-24.85	40°01'46.853"N	104°39'20.119"W	10.00	
7217.00†	45.614	359.853	7163.50	-112.98	-112.99	-25.07	40°01'47.495"N	104°39'20.122"W	10.00	
7317.00†	55.614	359.919	7226.87	-35.78	-35.80	-25.22	40°01'48.258"N	104°39'20.124"W	10.00	
7417.00†	65.613	359.970	7275.88	51.24	51.22	-25.30	40°01'49.118"N	104°39'20.125"W	10.00	
7517.00†	75.613	0.014	7309.03	145.45	145.43	-25.31	40°01'50.049"N	104°39'20.125"W	10.00	
7617.00†	85.613	0.054	7325.32	243.98	243.96	-25.25	40°01'51.023"N	104°39'20.125"W	10.00	

WELLPATH DATA (206 stations) † = interpolated/extrapolated station										
MD [ft]	Inclination [°]	Azimuth [°]	TVD [ft]	Vert Sect [ft]	North [ft]	East [ft]	Latitude	Longitude	DLS [°/100ft]	Comments
7660.87	90.000	0.072	7327.00 [†]	287.81	287.79	-25.20	40°01'51.456"N	104°39'20.124"W	10.00	End of 3D Arc
7717.00 [†]	90.000	0.072	7327.00	343.94	343.92	-25.13	40°01'52.011"N	104°39'20.123"W	0.00	
7817.00 [†]	90.000	0.072	7327.00	443.94	443.92	-25.01	40°01'52.999"N	104°39'20.121"W	0.00	
7917.00 [†]	90.000	0.072	7327.00	543.94	543.92	-24.88	40°01'53.987"N	104°39'20.120"W	0.00	
8017.00 [†]	90.000	0.072	7327.00	643.94	643.92	-24.76	40°01'54.975"N	104°39'20.118"W	0.00	
8117.00 [†]	90.000	0.072	7327.00	743.94	743.92	-24.63	40°01'55.964"N	104°39'20.117"W	0.00	
8217.00 [†]	90.000	0.072	7327.00	843.94	843.92	-24.51	40°01'56.952"N	104°39'20.115"W	0.00	
8317.00 [†]	90.000	0.072	7327.00	943.94	943.92	-24.38	40°01'57.940"N	104°39'20.113"W	0.00	
8417.00 [†]	90.000	0.072	7327.00	1043.94	1043.92	-24.26	40°01'58.928"N	104°39'20.112"W	0.00	

Planned Wellpath Report

WILLOW 22-18-3L PWP (REV-A.0)

Page 4 of 8

REFERENCE WELLPATH IDENTIFICATION

Operator	CONFLUENCE RESOURCES	Slot	SLOT#05 WILLOW 22-18-3L (185'FSL & 1146'FWL,SEC.22)
Area	COLORADO	Well	WILLOW 22-18-3L
Field	WELD COUNTY (NAD83, TRUE NORTH)	Wellbore	WILLOW 22-18-3L PWB
Facility	SEC.22-T01N-R65W		

WELLPATH DATA (206 stations) † = interpolated/extrapolated station

MD [ft]	Inclination [°]	Azimuth [°]	TVD [ft]	Vert Sect [ft]	North [ft]	East [ft]	Latitude	Longitude	DLS [°/100ft]	Comments
8517.00†	90.000	0.072	7327.00	1143.94	1143.92	-24.13	40°01'59.917"N	104°39'20.110"W	0.00	
8617.00†	90.000	0.072	7327.00	1243.94	1243.92	-24.01	40°02'00.905"N	104°39'20.109"W	0.00	
8717.00†	90.000	0.072	7327.00	1343.94	1343.92	-23.88	40°02'01.893"N	104°39'20.107"W	0.00	
8817.00†	90.000	0.072	7327.00	1443.94	1443.92	-23.76	40°02'02.881"N	104°39'20.105"W	0.00	
8917.00†	90.000	0.072	7327.00	1543.94	1543.92	-23.64	40°02'03.869"N	104°39'20.104"W	0.00	
9017.00†	90.000	0.072	7327.00	1643.94	1643.92	-23.51	40°02'04.858"N	104°39'20.102"W	0.00	
9117.00†	90.000	0.072	7327.00	1743.94	1743.92	-23.39	40°02'05.846"N	104°39'20.101"W	0.00	
9217.00†	90.000	0.072	7327.00	1843.94	1843.92	-23.26	40°02'06.834"N	104°39'20.099"W	0.00	
9317.00†	90.000	0.072	7327.00	1943.94	1943.92	-23.14	40°02'07.822"N	104°39'20.097"W	0.00	
9417.00†	90.000	0.072	7327.00	2043.94	2043.92	-23.01	40°02'08.811"N	104°39'20.096"W	0.00	
9517.00†	90.000	0.072	7327.00	2143.94	2143.92	-22.89	40°02'09.799"N	104°39'20.094"W	0.00	
9617.00†	90.000	0.072	7327.00	2243.94	2243.92	-22.76	40°02'10.787"N	104°39'20.093"W	0.00	
9717.00†	90.000	0.072	7327.00	2343.94	2343.92	-22.64	40°02'11.775"N	104°39'20.091"W	0.00	
9817.00†	90.000	0.072	7327.00	2443.94	2443.92	-22.51	40°02'12.763"N	104°39'20.089"W	0.00	
9917.00†	90.000	0.072	7327.00	2543.94	2543.92	-22.39	40°02'13.752"N	104°39'20.088"W	0.00	
10017.00†	90.000	0.072	7327.00	2643.94	2643.92	-22.26	40°02'14.740"N	104°39'20.086"W	0.00	
10117.00†	90.000	0.072	7327.00	2743.94	2743.92	-22.14	40°02'15.728"N	104°39'20.085"W	0.00	
10217.00†	90.000	0.072	7327.00	2843.94	2843.92	-22.01	40°02'16.716"N	104°39'20.083"W	0.00	
10317.00†	90.000	0.072	7327.00	2943.94	2943.92	-21.89	40°02'17.705"N	104°39'20.081"W	0.00	
10417.00†	90.000	0.072	7327.00	3043.94	3043.92	-21.76	40°02'18.693"N	104°39'20.080"W	0.00	
10517.00†	90.000	0.072	7327.00	3143.93	3143.92	-21.64	40°02'19.681"N	104°39'20.078"W	0.00	
10617.00†	90.000	0.072	7327.00	3243.93	3243.92	-21.51	40°02'20.669"N	104°39'20.077"W	0.00	
10717.00†	90.000	0.072	7327.00	3343.93	3343.92	-21.39	40°02'21.657"N	104°39'20.075"W	0.00	
10817.00†	90.000	0.072	7327.00	3443.93	3443.92	-21.26	40°02'22.646"N	104°39'20.073"W	0.00	
10917.00†	90.000	0.072	7327.00	3543.93	3543.92	-21.14	40°02'23.634"N	104°39'20.072"W	0.00	
11017.00†	90.000	0.072	7327.00	3643.93	3643.92	-21.01	40°02'24.622"N	104°39'20.070"W	0.00	
11117.00†	90.000	0.072	7327.00	3743.93	3743.92	-20.89	40°02'25.610"N	104°39'20.069"W	0.00	
11217.00†	90.000	0.072	7327.00	3843.93	3843.92	-20.76	40°02'26.599"N	104°39'20.067"W	0.00	
11317.00†	90.000	0.072	7327.00	3943.93	3943.92	-20.64	40°02'27.587"N	104°39'20.065"W	0.00	
11417.00†	90.000	0.072	7327.00	4043.93	4043.92	-20.51	40°02'28.575"N	104°39'20.064"W	0.00	
11517.00†	90.000	0.072	7327.00	4143.93	4143.92	-20.39	40°02'29.563"N	104°39'20.062"W	0.00	
11617.00†	90.000	0.072	7327.00	4243.93	4243.92	-20.26	40°02'30.552"N	104°39'20.061"W	0.00	
11717.00†	90.000	0.072	7327.00	4343.93	4343.92	-20.14	40°02'31.540"N	104°39'20.059"W	0.00	
11817.00†	90.000	0.072	7327.00	4443.93	4443.92	-20.02	40°02'32.528"N	104°39'20.057"W	0.00	
11917.00†	90.000	0.072	7327.00	4543.93	4543.92	-19.89	40°02'33.516"N	104°39'20.056"W	0.00	
12017.00†	90.000	0.072	7327.00	4643.93	4643.92	-19.77	40°02'34.504"N	104°39'20.054"W	0.00	

WELLPATH DATA (206 stations) † = interpolated/extrapolated station										
MD [ft]	Inclination [°]	Azimuth [°]	TVD [ft]	Vert Sect [ft]	North [ft]	East [ft]	Latitude	Longitude	DLS [°/100ft]	Comments
12117.00†	90.000	0.072	7327.00	4743.93	4743.92	-19.64	40°02'35.493"N	104°39'20.053"W	0.00	
12217.00†	90.000	0.072	7327.00	4843.93	4843.92	-19.52	40°02'36.481"N	104°39'20.051"W	0.00	
12317.00†	90.000	0.072	7327.00	4943.93	4943.92	-19.39	40°02'37.469"N	104°39'20.049"W	0.00	
12417.00†	90.000	0.072	7327.00	5043.93	5043.92	-19.27	40°02'38.457"N	104°39'20.048"W	0.00	
12517.00†	90.000	0.072	7327.00	5143.93	5143.92	-19.14	40°02'39.446"N	104°39'20.046"W	0.00	
12617.00†	90.000	0.072	7327.00	5243.93	5243.92	-19.02	40°02'40.434"N	104°39'20.045"W	0.00	
12717.00†	90.000	0.072	7327.00	5343.93	5343.92	-18.89	40°02'41.422"N	104°39'20.043"W	0.00	
12817.00†	90.000	0.072	7327.00	5443.93	5443.92	-18.77	40°02'42.410"N	104°39'20.041"W	0.00	
12917.00†	90.000	0.072	7327.00	5543.93	5543.92	-18.64	40°02'43.398"N	104°39'20.040"W	0.00	

Planned Wellpath Report

WILLOW 22-18-3L PWP (REV-A.0)

Page 5 of 8

REFERENCE WELLPATH IDENTIFICATION

Operator	CONFLUENCE RESOURCES	Slot	SLOT#05 WILLOW 22-18-3L (185'FSL & 1146'FWL,SEC.22)
Area	COLORADO	Well	WILLOW 22-18-3L
Field	WELD COUNTY (NAD83, TRUE NORTH)	Wellbore	WILLOW 22-18-3L PWB
Facility	SEC.22-T01N-R65W		

WELLPATH DATA (206 stations) † = interpolated/extrapolated station

MD [ft]	Inclination [°]	Azimuth [°]	TVD [ft]	Vert Sect [ft]	North [ft]	East [ft]	Latitude	Longitude	DLS [°/100ft]	Comments
13017.00†	90.000	0.072	7327.00	5643.93	5643.92	-18.52	40°02'44.387"N	104°39'20.038"W	0.00	
13117.00†	90.000	0.072	7327.00	5743.93	5743.92	-18.39	40°02'45.375"N	104°39'20.036"W	0.00	
13217.00†	90.000	0.072	7327.00	5843.93	5843.92	-18.27	40°02'46.363"N	104°39'20.035"W	0.00	
13317.00†	90.000	0.072	7327.00	5943.93	5943.92	-18.14	40°02'47.351"N	104°39'20.033"W	0.00	
13417.00†	90.000	0.072	7327.00	6043.93	6043.92	-18.02	40°02'48.340"N	104°39'20.032"W	0.00	
13517.00†	90.000	0.072	7327.00	6143.93	6143.92	-17.89	40°02'49.328"N	104°39'20.030"W	0.00	
13617.00†	90.000	0.072	7327.00	6243.93	6243.92	-17.77	40°02'50.316"N	104°39'20.028"W	0.00	
13717.00†	90.000	0.072	7327.00	6343.93	6343.92	-17.64	40°02'51.304"N	104°39'20.027"W	0.00	
13817.00†	90.000	0.072	7327.00	6443.93	6443.92	-17.52	40°02'52.292"N	104°39'20.025"W	0.00	
13917.00†	90.000	0.072	7327.00	6543.93	6543.92	-17.39	40°02'53.281"N	104°39'20.024"W	0.00	
14017.00†	90.000	0.072	7327.00	6643.93	6643.92	-17.27	40°02'54.269"N	104°39'20.022"W	0.00	
14117.00†	90.000	0.072	7327.00	6743.93	6743.92	-17.14	40°02'55.257"N	104°39'20.020"W	0.00	
14217.00†	90.000	0.072	7327.00	6843.93	6843.92	-17.02	40°02'56.245"N	104°39'20.019"W	0.00	
14317.00†	90.000	0.072	7327.00	6943.93	6943.92	-16.89	40°02'57.234"N	104°39'20.017"W	0.00	
14417.00†	90.000	0.072	7327.00	7043.93	7043.92	-16.77	40°02'58.222"N	104°39'20.016"W	0.00	
14517.00†	90.000	0.072	7327.00	7143.93	7143.92	-16.64	40°02'59.210"N	104°39'20.014"W	0.00	
14617.00†	90.000	0.072	7327.00	7243.93	7243.92	-16.52	40°03'00.198"N	104°39'20.012"W	0.00	
14717.00†	90.000	0.072	7327.00	7343.93	7343.92	-16.40	40°03'01.186"N	104°39'20.011"W	0.00	
14817.00†	90.000	0.072	7327.00	7443.93	7443.92	-16.27	40°03'02.175"N	104°39'20.009"W	0.00	
14917.00†	90.000	0.072	7327.00	7543.93	7543.92	-16.15	40°03'03.163"N	104°39'20.008"W	0.00	
15017.00†	90.000	0.072	7327.00	7643.93	7643.92	-16.02	40°03'04.151"N	104°39'20.006"W	0.00	
15117.00†	90.000	0.072	7327.00	7743.93	7743.92	-15.90	40°03'05.139"N	104°39'20.004"W	0.00	
15217.00†	90.000	0.072	7327.00	7843.93	7843.92	-15.77	40°03'06.128"N	104°39'20.003"W	0.00	
15317.00†	90.000	0.072	7327.00	7943.92	7943.92	-15.65	40°03'07.116"N	104°39'20.001"W	0.00	
15417.00†	90.000	0.072	7327.00	8043.92	8043.92	-15.52	40°03'08.104"N	104°39'20.000"W	0.00	
15517.00†	90.000	0.072	7327.00	8143.92	8143.91	-15.40	40°03'09.092"N	104°39'19.998"W	0.00	
15617.00†	90.000	0.072	7327.00	8243.92	8243.91	-15.27	40°03'10.080"N	104°39'19.996"W	0.00	
15717.00†	90.000	0.072	7327.00	8343.92	8343.91	-15.15	40°03'11.069"N	104°39'19.995"W	0.00	
15817.00†	90.000	0.072	7327.00	8443.92	8443.91	-15.02	40°03'12.057"N	104°39'19.993"W	0.00	
15917.00†	90.000	0.072	7327.00	8543.92	8543.91	-14.90	40°03'13.045"N	104°39'19.992"W	0.00	
16017.00†	90.000	0.072	7327.00	8643.92	8643.91	-14.77	40°03'14.033"N	104°39'19.990"W	0.00	
16117.00†	90.000	0.072	7327.00	8743.92	8743.91	-14.65	40°03'15.022"N	104°39'19.988"W	0.00	
16217.00†	90.000	0.072	7327.00	8843.92	8843.91	-14.52	40°03'16.010"N	104°39'19.987"W	0.00	
16317.00†	90.000	0.072	7327.00	8943.92	8943.91	-14.40	40°03'16.998"N	104°39'19.985"W	0.00	
16417.00†	90.000	0.072	7327.00	9043.92	9043.91	-14.27	40°03'17.986"N	104°39'19.984"W	0.00	
16517.00†	90.000	0.072	7327.00	9143.92	9143.91	-14.15	40°03'18.975"N	104°39'19.982"W	0.00	

WELLPATH DATA (206 stations) † = interpolated/extrapolated station										
MD [ft]	Inclination [°]	Azimuth [°]	TVD [ft]	Vert Sect [ft]	North [ft]	East [ft]	Latitude	Longitude	DLS [°/100ft]	Comments
16617.00†	90.000	0.072	7327.00	9243.92	9243.91	-14.02	40°03'19.963"N	104°39'19.980"W	0.00	
16717.00†	90.000	0.072	7327.00	9343.92	9343.91	-13.90	40°03'20.951"N	104°39'19.979"W	0.00	
16817.00†	90.000	0.072	7327.00	9443.92	9443.91	-13.77	40°03'21.939"N	104°39'19.977"W	0.00	
16917.00†	90.000	0.072	7327.00	9543.92	9543.91	-13.65	40°03'22.927"N	104°39'19.976"W	0.00	
17017.00†	90.000	0.072	7327.00	9643.92	9643.91	-13.52	40°03'23.916"N	104°39'19.974"W	0.00	
17117.00†	90.000	0.072	7327.00	9743.92	9743.91	-13.40	40°03'24.904"N	104°39'19.972"W	0.00	
17217.00†	90.000	0.072	7327.00	9843.92	9843.91	-13.27	40°03'25.892"N	104°39'19.971"W	0.00	
17317.00†	90.000	0.072	7327.00	9943.92	9943.91	-13.15	40°03'26.880"N	104°39'19.969"W	0.00	
17417.00†	90.000	0.072	7327.00	10043.92	10043.91	-13.02	40°03'27.869"N	104°39'19.968"W	0.00	

Planned Wellpath Report

WILLOW 22-18-3L PWP (REV-A.0)

Page 6 of 8

REFERENCE WELLPATH IDENTIFICATION

Operator	CONFLUENCE RESOURCES	Slot	SLOT#05 WILLOW 22-18-3L (185'FSL & 1146'FWL,SEC.22)
Area	COLORADO	Well	WILLOW 22-18-3L
Field	WELD COUNTY (NAD83, TRUE NORTH)	Wellbore	WILLOW 22-18-3L PWB
Facility	SEC.22-T01N-R65W		

WELLPATH DATA (206 stations) † = interpolated/extrapolated station

MD [ft]	Inclination [°]	Azimuth [°]	TVD [ft]	Vert Sect [ft]	North [ft]	East [ft]	Latitude	Longitude	DLS [°/100ft]	Comments
17517.00†	90.000	0.072	7327.00	10143.92	10143.91	-12.90	40°03'28.857"N	104°39'19.966"W	0.00	
17617.00†	90.000	0.072	7327.00	10243.92	10243.91	-12.78	40°03'29.845"N	104°39'19.964"W	0.00	
17717.00†	90.000	0.072	7327.00	10343.92	10343.91	-12.65	40°03'30.833"N	104°39'19.963"W	0.00	
17817.00†	90.000	0.072	7327.00	10443.92	10443.91	-12.53	40°03'31.821"N	104°39'19.961"W	0.00	
17917.00†	90.000	0.072	7327.00	10543.92	10543.91	-12.40	40°03'32.810"N	104°39'19.959"W	0.00	
18017.00†	90.000	0.072	7327.00	10643.92	10643.91	-12.28	40°03'33.798"N	104°39'19.958"W	0.00	
18117.00†	90.000	0.072	7327.00	10743.92	10743.91	-12.15	40°03'34.786"N	104°39'19.956"W	0.00	
18217.00†	90.000	0.072	7327.00	10843.92	10843.91	-12.03	40°03'35.774"N	104°39'19.955"W	0.00	
18317.00†	90.000	0.072	7327.00	10943.92	10943.91	-11.90	40°03'36.763"N	104°39'19.953"W	0.00	
18417.00†	90.000	0.072	7327.00	11043.92	11043.91	-11.78	40°03'37.751"N	104°39'19.951"W	0.00	
18517.00†	90.000	0.072	7327.00	11143.92	11143.91	-11.65	40°03'38.739"N	104°39'19.950"W	0.00	
18617.00†	90.000	0.072	7327.00	11243.92	11243.91	-11.53	40°03'39.727"N	104°39'19.948"W	0.00	
18717.00†	90.000	0.072	7327.00	11343.92	11343.91	-11.40	40°03'40.715"N	104°39'19.947"W	0.00	
18817.00†	90.000	0.072	7327.00	11443.92	11443.91	-11.28	40°03'41.704"N	104°39'19.945"W	0.00	
18917.00†	90.000	0.072	7327.00	11543.92	11543.91	-11.15	40°03'42.692"N	104°39'19.943"W	0.00	
19017.00†	90.000	0.072	7327.00	11643.92	11643.91	-11.03	40°03'43.680"N	104°39'19.942"W	0.00	
19117.00†	90.000	0.072	7327.00	11743.92	11743.91	-10.90	40°03'44.668"N	104°39'19.940"W	0.00	
19217.00†	90.000	0.072	7327.00	11843.92	11843.91	-10.78	40°03'45.657"N	104°39'19.939"W	0.00	
19317.00†	90.000	0.072	7327.00	11943.92	11943.91	-10.65	40°03'46.645"N	104°39'19.937"W	0.00	
19417.00†	90.000	0.072	7327.00	12043.92	12043.91	-10.53	40°03'47.633"N	104°39'19.935"W	0.00	
19517.00†	90.000	0.072	7327.00	12143.92	12143.91	-10.40	40°03'48.621"N	104°39'19.934"W	0.00	
19617.00†	90.000	0.072	7327.00	12243.92	12243.91	-10.28	40°03'49.609"N	104°39'19.932"W	0.00	
19717.00†	90.000	0.072	7327.00	12343.92	12343.91	-10.15	40°03'50.598"N	104°39'19.931"W	0.00	
19817.00†	90.000	0.072	7327.00	12443.92	12443.91	-10.03	40°03'51.586"N	104°39'19.929"W	0.00	
19917.00†	90.000	0.072	7327.00	12543.92	12543.91	-9.90	40°03'52.574"N	104°39'19.927"W	0.00	
19958.56	90.000	0.072	7327.00 ²	12585.48	12585.47	-9.85	40°03'52.985"N	104°39'19.927"W	0.00	End of Tangent

HOLE & CASING SECTIONS - Ref Wellbore: WILLOW 22-18-3L PWB Ref Wellpath: WILLOW 22-18-3L PWP (REV-A.0)

String/Diameter	Start MD [ft]	End MD [ft]	Interval [ft]	Start TVD [ft]	End TVD [ft]	Start N/S [ft]	Start E/W [ft]	End N/S [ft]	End E/W [ft]
9.625in Casing Surface	17.00	1500.00	1483.00	17.00	1499.19	0.00	0.00	-34.89	-2.89

Planned Wellpath Report

WILLOW 22-18-3L PWP (REV-A.0)

Page 7 of 8

REFERENCE WELLPATH IDENTIFICATION

Operator	CONFLUENCE RESOURCES	Slot	SLOT#05 WILLOW 22-18-3L (185'FSL & 1146'FWL,SEC.22)
Area	COLORADO	Well	WILLOW 22-18-3L
Field	WELD COUNTY (NAD83, TRUE NORTH)	Wellbore	WILLOW 22-18-3L PWB
Facility	SEC.22-T01N-R65W		

TARGETS

Name	MD [ft]	TVD [ft]	North [ft]	East [ft]	Grid East [US ft]	Grid North [US ft]	Latitude	Longitude	Shape
HARDLINES SEC.10,15,22-T01N-R65W 460'N/S&E/W		-1.00	0.00	-98.01	3236383.46	1254962.14	40°01'48.612"N	104°39'21.060"W	polygon
SEC.10-T01N-R65W		-1.00	0.00	-98.01	3236383.46	1254962.14	40°01'48.612"N	104°39'21.060"W	polygon
SEC.15-T01N-R65W		-1.00	0.00	-98.01	3236383.46	1254962.14	40°01'48.612"N	104°39'21.060"W	polygon
SEC.22-T01N-R65W		-1.00	0.00	-98.01	3236383.46	1254962.14	40°01'48.612"N	104°39'21.060"W	polygon
2) WILLOW 22-18-3L BHL ON PLAT (2179'FSL & 1121'FWL,SEC.10)	19958.56	7327.00	12585.47	-9.85	3236351.76	1267547.40	40°03'52.985"N	104°39'19.927"W	point
1) WILLOW 22-18-3L LP ON PLAT (470'FSL & 1121'FWL,SEC.22)	7660.87	7327.00	287.79	-25.20	3236453.53	1255250.59	40°01'51.456"N	104°39'20.124"W	point

SURVEY PROGRAM - Ref Wellbore: WILLOW 22-18-3L PWB Ref Wellpath: WILLOW 22-18-3L PWP (REV-A.0)

Start MD [ft]	End MD [ft]	Positional Uncertainty Model	Log Name/Comment	Wellbore
17.00	1500.00	BHI NaviTrak (Rotating+Axial Corr)		WILLOW 22-18-3L PWB
1500.00	19958.56	BHI AutoTrak Curve (Axial Corr, Short spacing)		WILLOW 22-18-3L PWB

Planned Wellpath Report

WILLOW 22-18-3L PWP (REV-A.0)

Page 8 of 8

REFERENCE WELLPATH IDENTIFICATION

Operator	CONFLUENCE RESOURCES	Slot	SLOT#05 WILLOW 22-18-3L (185'FSL & 1146'FWL,SEC.22)
Area	COLORADO	Well	WILLOW 22-18-3L
Field	WELD COUNTY (NAD83, TRUE NORTH)	Wellbore	WILLOW 22-18-3L PWB
Facility	SEC.22-T01N-R65W		

DESIGN COMMENTS

MD [ft]	Inclination [°]	Azimuth [°]	TVD [ft]	Comment
17.00	0.000	184.737	17.00	Tie On
700.00	0.000	184.737	700.00	End of Tangent
837.17	2.743	184.737	837.11	End of Build
6733.52	2.743	184.737	6726.71	End of Tangent
7660.87	90.000	0.072	7327.00	End of 3D Arc
19958.56	90.000	0.072	7327.00	End of Tangent