

AS-BUILT ELEVATION: 5053.9'
 EXISTING AREA OF DISTURBANCE: ±1.9 ACRES
 APPROXIMATE PAD AREA: ±0.6 ACRES
 DRAINS TO COLORADO RIVER

STORMWATER BMP's

CONSTRUCTION BMP's WILL BE
 INSTALLED IN ACCORDANCE WITH
 CDPHE CONSTRUCTION PERMIT AND
 BEST PRACTICES AS IDENTIFIED BY
 THE CDPHE. ONCE CONSTRUCTION
 IS COMPLETED, THE SITE WILL BE
 REVIEWED BY CERTIFIED STORM
 WATER PERSONNEL AND
 PERMANENT BMP's WILL BE
 INSTALLED WHERE DEEMED
 NECESSARY TO MANAGE SEDIMENT
 MIGRATION OFFSITE.

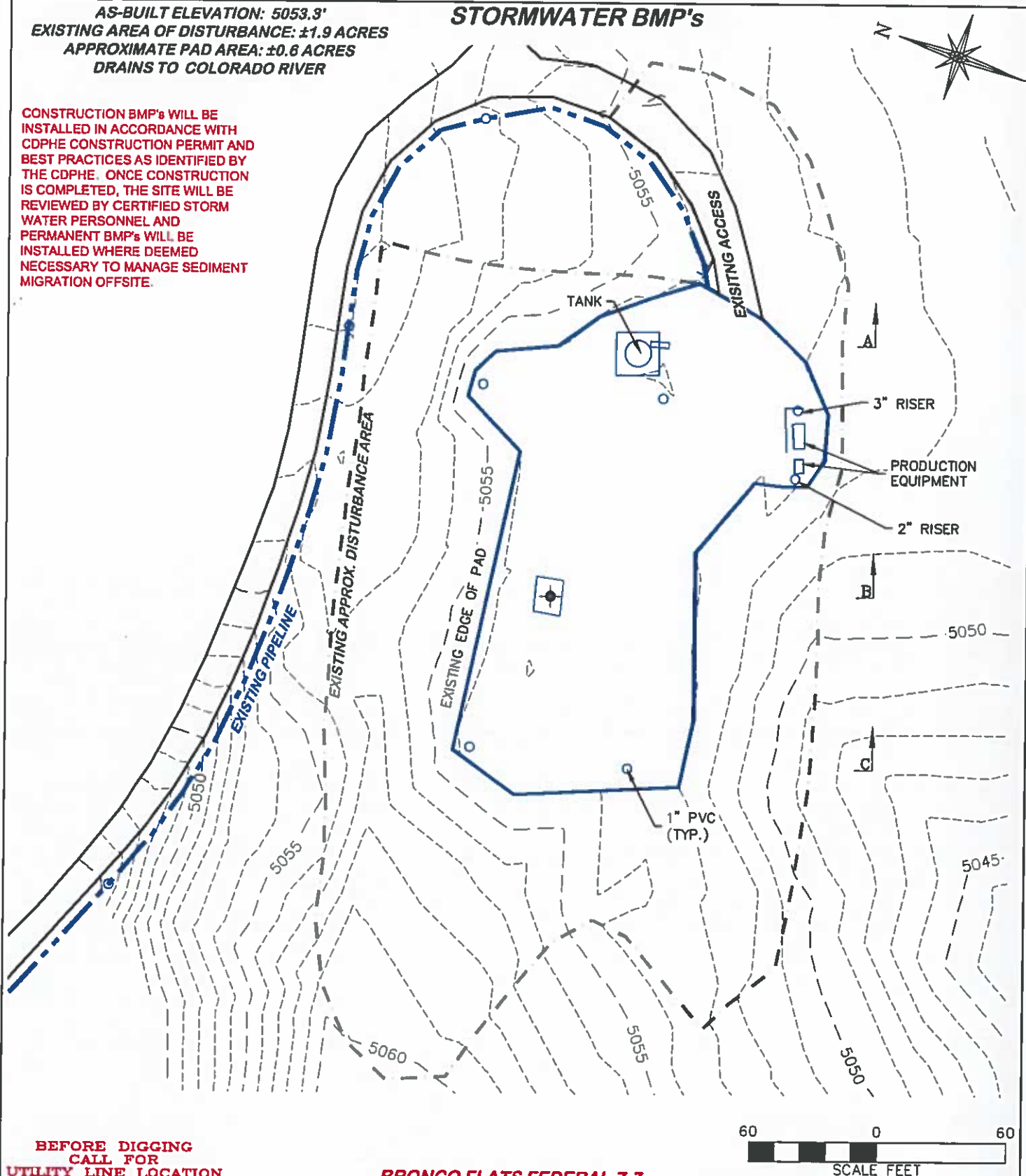

BEFORE DIGGING
 CALL FOR
 UTILITY LINE LOCATION

BRONCO FLATS FEDERAL 7-7

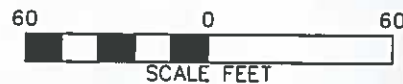

DRG RIFFIN & ASSOCIATES, INC.
 (307) 382-5028 1414 ELK ST., ROCK SPRINGS, WY 82901

DRAWN: 12/7/2018 - TCM	SCALE: 1" = 60'
REVISED: 1/2/2019 - TCM	DRG JOB No. 21691
MISC. REVISIONS	06 STM WTR

STORMWATER BMP's

LARAMIE ENERGY, LLC.
 BRONCO FLATS FEDERAL 7-7
 SWNE, SECTION 7, T.9 S., R.97 W, 6th P.M.,
 MESA COUNTY, COLORADO