

LEGEND:

- = PROPOSED WELLHEAD.
- = TARGET BOTTOM HOLE.
- ◆ = PRODUCTION INTERVAL.
- ▲ = SECTION CORNERS LOCATED. (NAD 83)

NOTE:

Distances referenced on plat to section lines are perpendicular.

T5N, R61W, 6th P.M.

LINE TABLE		
LINE	DIRECTION	LENGTH
L1	S62°11'22"W	1353.95'
L2	S00°11'41"E	460.05'
L3	S00°11'15"E	100.00'

2006 Alum. Cap,  
#7735, 2.7'  
Below Ground  
Lat: 40.423153°  
Long: 104.185047°

2017 Alum. Cap,  
#38458, 1.2'  
Below Ground  
Lat: 40.423243°  
Long: 104.165813°

1996 Alum. Cap,  
#13895,  
Flush W/ Ground  
Lat: 40.408482°  
Long: 104.185192°

Iron Pipe, Center  
of 2-Track  
Lat: 40.408609°  
Long: 104.165999°

S89°06'55"W - 5357.12' (Meas.)

GROTHER 5-61 11B-14-23-1  
Elev. Ungraded Ground = 4689.8'

S88°58'00"W - 5346.76' (Meas.)

L1

L2

Beg. Prod. Interval

2880'

2465'

14

S89°13'33"W - 5337.44' (Meas.)

2011 Alum. Cap,  
#37897,  
Flush W/ Ground  
Lat: 40.393935°  
Long: 104.185300°

2011 Alum. Cap,  
#37897, 0.4' High  
Lat: 40.393996°  
Long: 104.166144°

N00°12'12"W - 5301.08' (Meas.)

N00°06'23"W - 5325.39' (Meas.)

N00°11'04"W - 2650.85' (Meas.)

N00°07'00"W - 5325.30' (Meas.)

2011 Alum. Cap,  
#37897,  
Flush W/ Ground  
Lat: 40.386661°  
Long: 104.185357°

23

S00°11'41"E  
9708.50'

See Detail "A"  
@ Above Right

2880'

2451'

2880'

2451'

2011 Alum. Cap,  
#37897, 0.4'  
Below Ground  
Lat: 40.379387°  
Long: 104.185414°

S89°28'42"W - 5330.81' (Meas.)

2011 Alum. Cap,  
#37897, 0.3' High  
Lat: 40.379384°  
Long: 104.166285°

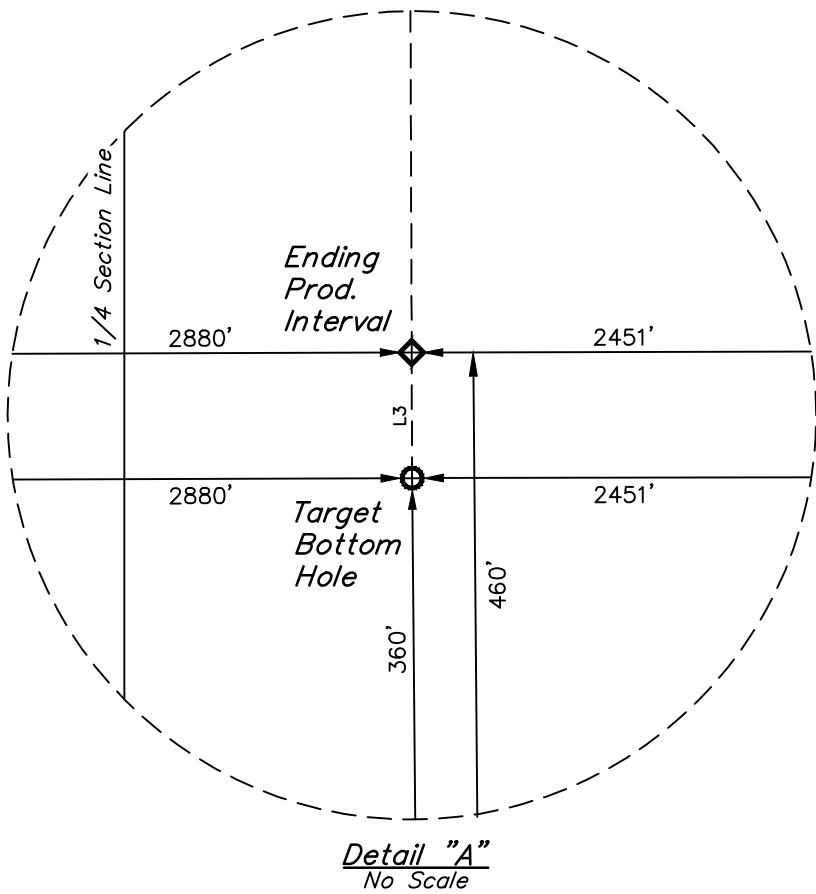

PDOP = 1.4



SURFACE LOCATION 610' FSL 1269' FEL	BEG. PROD. INTERVAL 460' FNL 2880' FWL 2465' FEL	ENDING PROD. INTERVAL 460' FSL 2880' FWL 2451' FEL	TARGET BOTTOM HOLE 360' FSL 2880' FWL 2451' FEL
NAD 83 (SURFACE LOCATION) LATITUDE = 40°24'36.91" (40.410254°) LONGITUDE = 104°10'13.92" (104.170533°)	NAD 83 (BEG. PROD. INTERVAL) LATITUDE = 40°24'26.24" (40.407289°) LONGITUDE = 104°10'29.50" (104.174862°)	NAD 83 (ENDING PROD. INTERVAL) LATITUDE = 40°22'50.33" (40.380648°) LONGITUDE = 104°10'30.25" (104.175069°)	NAD 83 (TARGET BOTTOM HOLE) LATITUDE = 40°22'49.34" (40.380373°) LONGITUDE = 104°10'30.26" (104.175071°)
NAD 27 (SURFACE LOCATION) LATITUDE = 40°24'36.97" (40.410270°) LONGITUDE = 104°10'12.10" (104.170027°)	NAD 27 (BEG. PROD. INTERVAL) LATITUDE = 40°24'26.30" (40.407306°) LONGITUDE = 104°10'27.68" (104.174357°)	NAD 27 (ENDING PROD. INTERVAL) LATITUDE = 40°22'50.39" (40.380665°) LONGITUDE = 104°10'28.43" (104.174563°)	NAD 27 (TARGET BOTTOM HOLE) LATITUDE = 40°22'49.41" (40.380391°) LONGITUDE = 104°10'28.44" (104.174565°)
STATE PLANE NAD 83 (CO. NORTH) N: 1395070.91' E: 3370200.59'	STATE PLANE NAD 83 (CO. NORTH) N: 1393972.85' E: 3369011.12'	STATE PLANE NAD 83 (CO. NORTH) N: 1384267.94' E: 3369098.55'	STATE PLANE NAD 83 (CO. NORTH) N: 1384167.98' E: 3369099.44'
STATE PLANE NAD 27 (CO. NORTH) N: 395072.20' E: 2370351.18'	STATE PLANE NAD 27 (CO. NORTH) N: 393974.19' E: 2369161.68'	STATE PLANE NAD 27 (CO. NORTH) N: 384269.61' E: 2369249.16'	STATE PLANE NAD 27 (CO. NORTH) N: 384169.65' E: 2369250.05'

BASIS OF BEARINGS  
TRANSVERSE MERCATOR PROJECTION WITH  
A CENTRAL MERIDIAN OF W105°00'00".

BASIS OF ELEVATION  
OPUS SOLUTION GENERATED NAVD 88

UELS, LLC  
Corporate Office \* 85 South 200 East  
Vernal, UT 84078 \* (435) 789-1017



CERTIFICATE OF REGISTRATION  
THIS IS TO CERTIFY THAT THE ABOVE IS A TRUE AND CORRECT COPY OF THE NOTES OF ACTUAL SURVEYS MADE AND CONDUCTED UNDER MY SUPERVISION AND THAT THE SAME ARE TRUE AND CORRECT TO THE BEST OF MY KNOWLEDGE AND BELIEF.  
REGISTERED LAND SURVEYOR  
REGISTRATION NO. 28285  
STATE OF COLORADO  
02-18-19

REV: 1 02-27-19 CJVIE (SURFACE LOCATION MOVE)

BISON OIL & GAS II

GROTHER 5-61 11B-14-23-1  
SE 1/4 SE 1/4, SECTION 11, T5N, R61W, 6th P.M.  
WELD COUNTY, COLORADO

SURVEYED BY	RYAN WILLIAMS, O.R.	02-18-19	SCALE
DRAWN BY	K.B.	02-19-19	1" = 1000'

WELL LOCATION PLAT