

**LEGEND:**

 PROPOSED LOCATION



**BISON OIL & GAS II**

**GROTHEER 5-61 11B PAD**  
SE 1/4 SE 1/4 SECTION 11, T5N, R61W, 6th P.M.  
WELD COUNTY, COLORADO



**UELS, LLC**  
Corporate Office \* 85 South 200 East  
Vernal, UT 84078 \* (435) 789-1017

SURVEYED BY	R.W, O.R.	02-18-19	SCALE
DRAWN BY	J.L.G.	02-21-19	1 : 100,000
<b>ACCESS ROAD MAP</b>			<b>TOPO A</b>



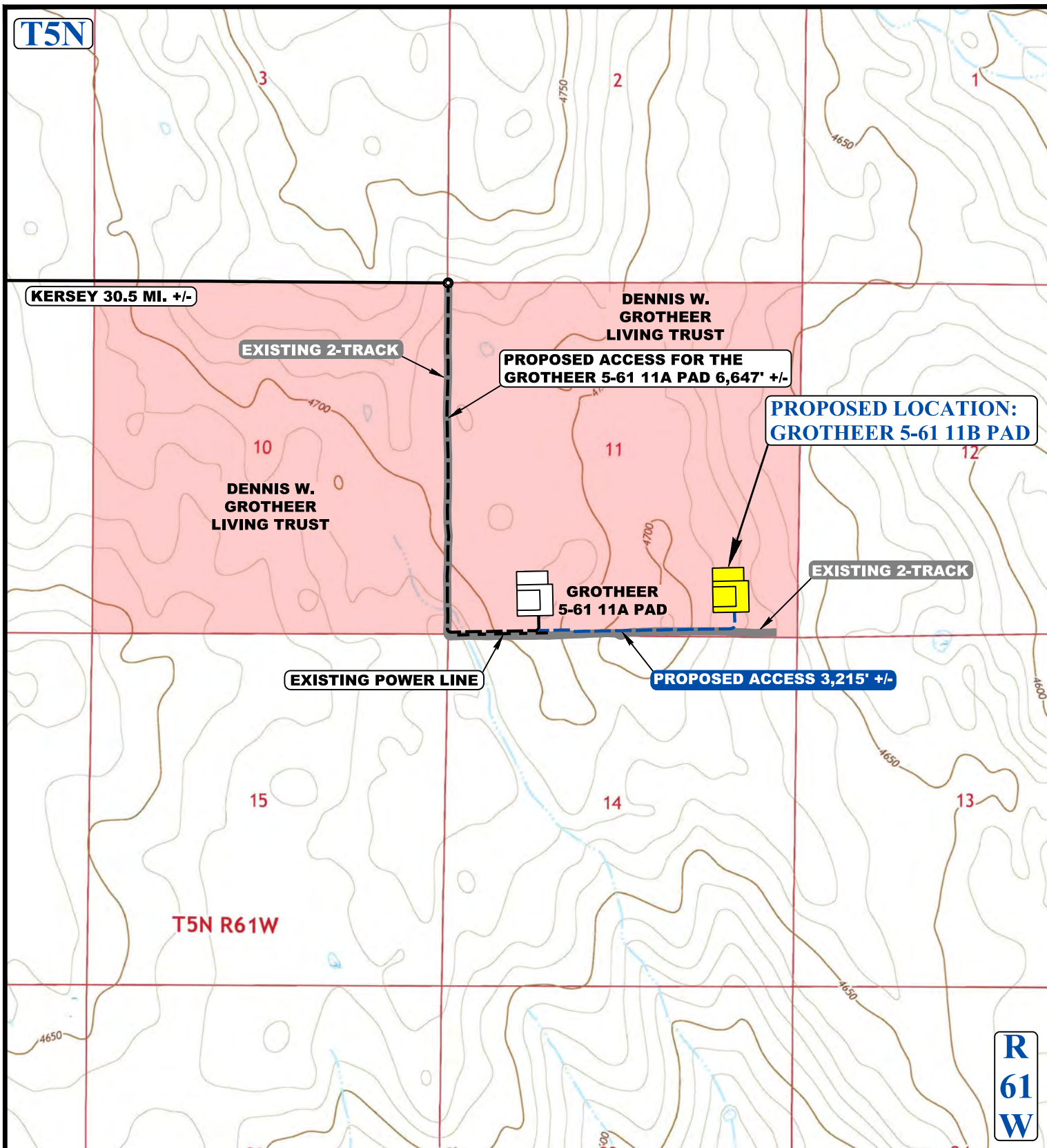

NOTE: PARCEL DATA SHOWN HAS BEEN OBTAINED FROM VARIOUS SOURCES AND SHOULD BE USED FOR MAPPING, GRAPHIC AND PLANNING PURPOSES ONLY. NO WARRANTY IS MADE BY UINTAH ENGINEERING AND LAND SURVEYING (UELS) FOR ACCURACY OF THE PARCEL DATA.

#### LEGEND:

- EXISTING ROAD
- - - PROPOSED ROAD
- - - EXISTING POWER LINE
- - - PROPOSED ROAD (SERVICING OTHER WELLS)
- EXISTING 2-TRACK



**UELS, LLC**  
Corporate Office \* 85 South 200 East  
Vernal, UT 84078 \* (435) 789-1017



#### BISON OIL & GAS II

**GROTHEER 5-61 11B PAD**  
**SE 1/4 SE 1/4 SECTION 11, T5N, R61W, 6th P.M.**  
**WELD COUNTY, COLORADO**

SURVEYED BY	R.W. O.R.	02-18-19	SCALE
DRAWN BY	J.L.G.	02-21-19	1 : 24,000
<b>ACCESS ROAD MAP</b>			<b>TOPO B</b>