

LEGEND:

- = PROPOSED WELLHEAD.
- ◆ = PRODUCTION INTERVAL.
- = TARGET BOTTOM HOLE.
- ▲ = SECTION CORNERS LOCATED. (NAD 83)

NOTE:

Distances referenced on plat to section lines are perpendicular.

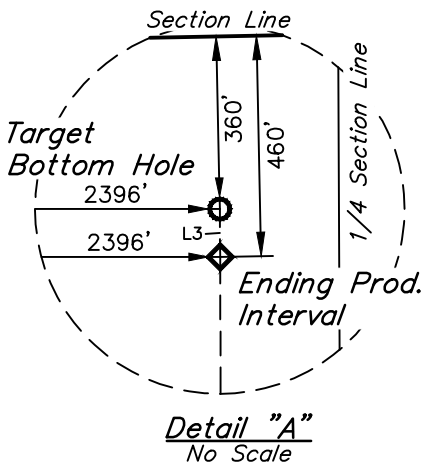

2006 Alum. Cap,  
#7735,  
Flush W/ Ground  
Lat: 40.437633°  
Long: 104.184992°

2012 Alum. Cap,  
#38307,  
0.8' Below Ground  
Lat: 40.437807°  
Long: 104.165684°

2006 Alum. Cap,  
#7735,  
2.7' Below Ground  
Lat: 40.423153°  
Long: 104.185047°

2017 Alum. Cap,  
#38458,  
1.2' Below Ground  
Lat: 40.423243°  
Long: 104.165813°

LINE TABLE

LINE	DIRECTION	LENGTH
L1	S69°16'43"E	1241.07'
L2	N06°28'22"W	462.08'
L3	N00°21'43"W	100.01'

<b>SURFACE LOCATION</b> 460' FSL 1237' FWL
<b>NAD 83 (SURFACE LOCATION)</b> LATITUDE = 40°24'35.19" (40.409774°) LONGITUDE = 104°10'50.66" (104.180739°)
<b>NAD 27 (SURFACE LOCATION)</b> LATITUDE = 40°24'35.25" (40.409791°) LONGITUDE = 104°10'48.84" (104.180233°)
<b>STATE PLANE NAD 83 (CO. NORTH)</b> N: 1394853.77' E: 3367361.44'
<b>STATE PLANE NAD 27 (CO. NORTH)</b> N: 394855.10' E: 2367511.95'

1996 Alum. Cap,  
#13895,  
Flush W/ Ground  
Lat: 40.408482°  
Long: 104.185192°

PDOP = 1.5



BEG. PROD. INTERVAL 460' FSL 2346' FWL	ENDING PROD. INTERVAL 460' FNL 2396' FWL	TARGET BOTTOM HOLE 360' FNL 2396' FWL
<b>NAD 83 (BEG. PROD. INTERVAL)</b> LATITUDE = 40°24'35.28" (40.409801°) LONGITUDE = 104°10'36.33" (104.176758°)	<b>NAD 83 (ENDING PROD. INTERVAL)</b> LATITUDE = 40°26'11.22" (40.436449°) LONGITUDE = 104°10'35.01" (104.176392°)	<b>NAD 83 (TARGET BOTTOM HOLE)</b> LATITUDE = 40°26'12.20" (40.436723°) LONGITUDE = 104°10'35.01" (104.176391°)
<b>NAD 27 (BEG. PROD. INTERVAL)</b> LATITUDE = 40°24'35.34" (40.409818°) LONGITUDE = 104°10'34.51" (104.176252°)	<b>NAD 27 (ENDING PROD. INTERVAL)</b> LATITUDE = 40°26'11.28" (40.436465°) LONGITUDE = 104°10'33.19" (104.175886°)	<b>NAD 27 (TARGET BOTTOM HOLE)</b> LATITUDE = 40°26'12.26" (40.436740°) LONGITUDE = 104°10'33.19" (104.175885°)
<b>STATE PLANE NAD 83 (CO. NORTH)</b> N: 1394880.00' E: 3368469.64'	<b>STATE PLANE NAD 83 (CO. NORTH)</b> N: 1404588.37' E: 3368426.66'	<b>STATE PLANE NAD 83 (CO. NORTH)</b> N: 1404688.34' E: 3368425.47'
<b>STATE PLANE NAD 27 (CO. NORTH)</b> N: 394881.31' E: 2368620.19'	<b>STATE PLANE NAD 27 (CO. NORTH)</b> N: 404589.35' E: 2368577.15'	<b>STATE PLANE NAD 27 (CO. NORTH)</b> N: 404689.32' E: 2368575.96'

BASIS OF BEARINGS

TRANSVERSE MERCATOR PROJECTION WITH  
A CENTRAL MERIDIAN OF W105°00'00".

BASIS OF ELEVATION

OPUS SOLUTION GENERATED NAVD 88



UELS, LLC  
Corporate Office \* 85 South 200 East  
Vernal, UT 84078 \* (435) 789-1017



BISON OIL & GAS II

GROTHER 5-61 11A-2-5  
SW 1/4 SW 1/4, SECTION 11, T5N, R61W, 6th P.M.  
WELD COUNTY, COLORADO

SURVEYED BY	ALLEN SHAFFETT, C.M.	02-18-19	SCALE
DRAWN BY	C.IVIE	02-19-19	1" = 1000'

WELL LOCATION PLAT

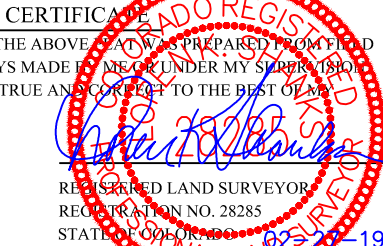

CERTIFICATE OF SURVEY  
THIS IS TO CERTIFY THAT THE ABOVE PLAT WAS PREPARED FROM FIELD  
NOTES OF ACTUAL SURVEYS MADE BY ME OR UNDER MY SUPERVISION  
AND THAT THE SAME ARE TRUE AND CORRECT TO THE BEST OF MY  
KNOWLEDGE AND BELIEF.

REV: 1 02-27-19 C.IVIE (SL & BPI MOVE)