

LINE TABLE		
LINE	DIRECTION	LENGTH
L1	S01°E	423'
L2	S01°E	458'
L3	N72°W	589'

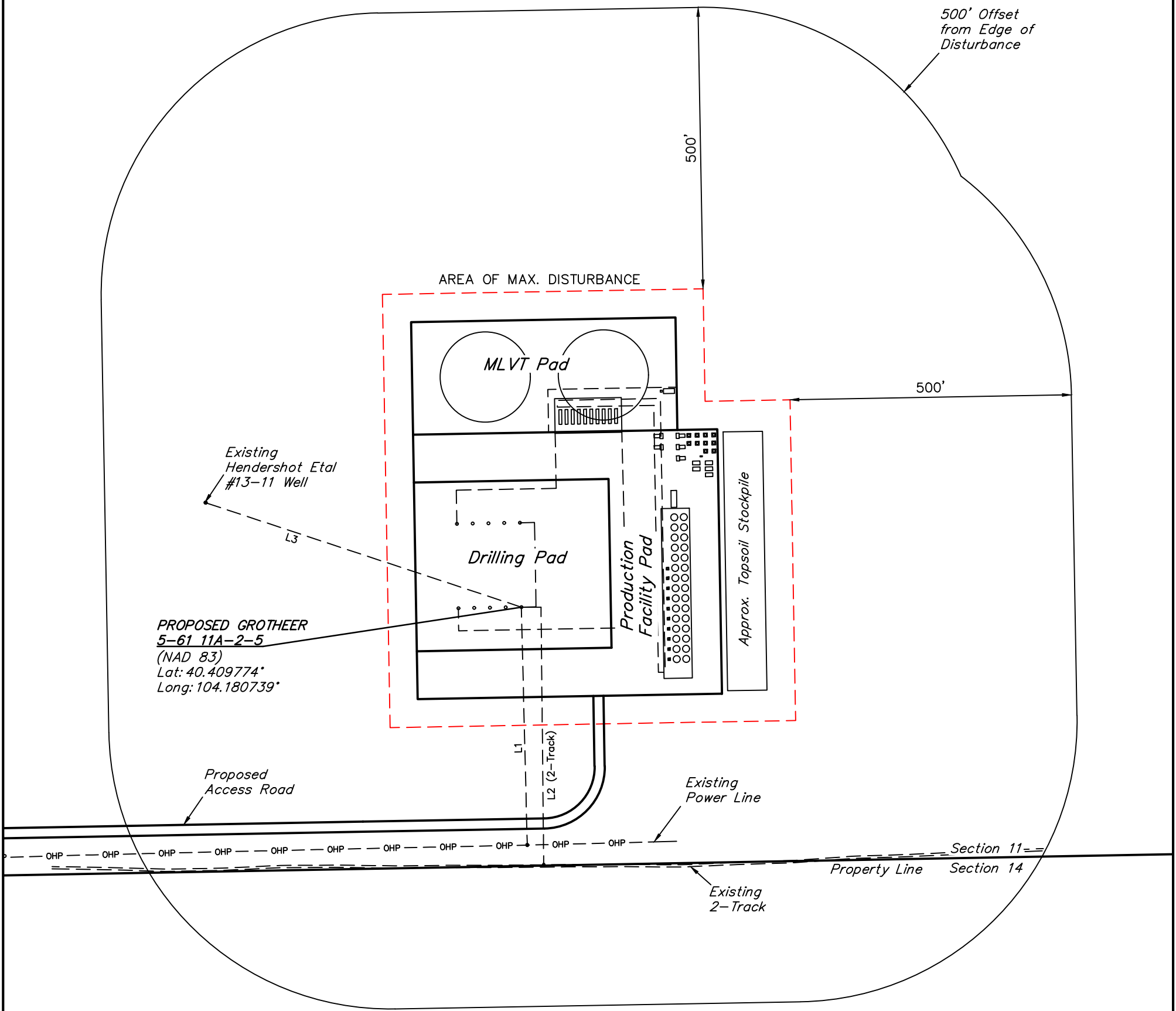

REV: 1 02-27-19 C.IVIE (SURFACE LOCATION MOVE)

PLANT COMMUNITY <input type="checkbox"/> DISTURBED GRASSLAND <input checked="" type="checkbox"/> NATIVE GRASSLAND <input type="checkbox"/> SHRUB LAND <input type="checkbox"/> PLAINS RIPARIAN <input type="checkbox"/> MOUNTAIN RIPARIAN <input type="checkbox"/> FOREST LAND <input type="checkbox"/> WETLANDS AQUATIC <input type="checkbox"/> ALPINE <input type="checkbox"/> OTHER (Describe): _____	CURRENT LAND USE					
	CROP LAND:	<input type="checkbox"/> IRRIGATED	<input type="checkbox"/> DRY LAND	<input type="checkbox"/> IMPROVED PASTURE	<input type="checkbox"/> HAY MEADOW	<input type="checkbox"/> CRP
	NON-CROP LAND:	<input checked="" type="checkbox"/> RANGELAND	<input type="checkbox"/> TIMBER	<input type="checkbox"/> RECREATIONAL	<input type="checkbox"/> OTHER (Describe)	
	SUBDIVIDED:	<input type="checkbox"/> INDUSTRIAL	<input type="checkbox"/> COMMERCIAL	<input type="checkbox"/> RESIDENTIAL	_____	
	FUTURE LAND USE					
	CROP LAND:	<input type="checkbox"/> IRRIGATED	<input type="checkbox"/> DRY LAND	<input type="checkbox"/> IMPROVED PASTURE	<input type="checkbox"/> HAY MEADOW	<input type="checkbox"/> CRP
	NON-CROP LAND:	<input checked="" type="checkbox"/> RANGELAND	<input type="checkbox"/> TIMBER	<input type="checkbox"/> RECREATIONAL	<input type="checkbox"/> OTHER (Describe)	
	SUBDIVIDED:	<input type="checkbox"/> INDUSTRIAL	<input type="checkbox"/> COMMERCIAL	<input type="checkbox"/> RESIDENTIAL	_____	

NOTES:

BISON OIL & GAS II

GROTHEER 5-61 11A PAD
SW 1/4 SW 1/4, SECTION 11, T5N, R61W, 6th P.M.
WELD COUNTY, COLORADO



UELS, LLC
Corporate Office * 85 South 200 East
Vernal, UT 84078 * (435) 789-1017

SURVEYED BY	ALLEN SHAFFETT, C.M.	02-18-19	SCALE
DRAWN BY	C.IVIE	02-19-19	1" = 200'
LOCATION DRAWING		FIGURE #2	