

T5N

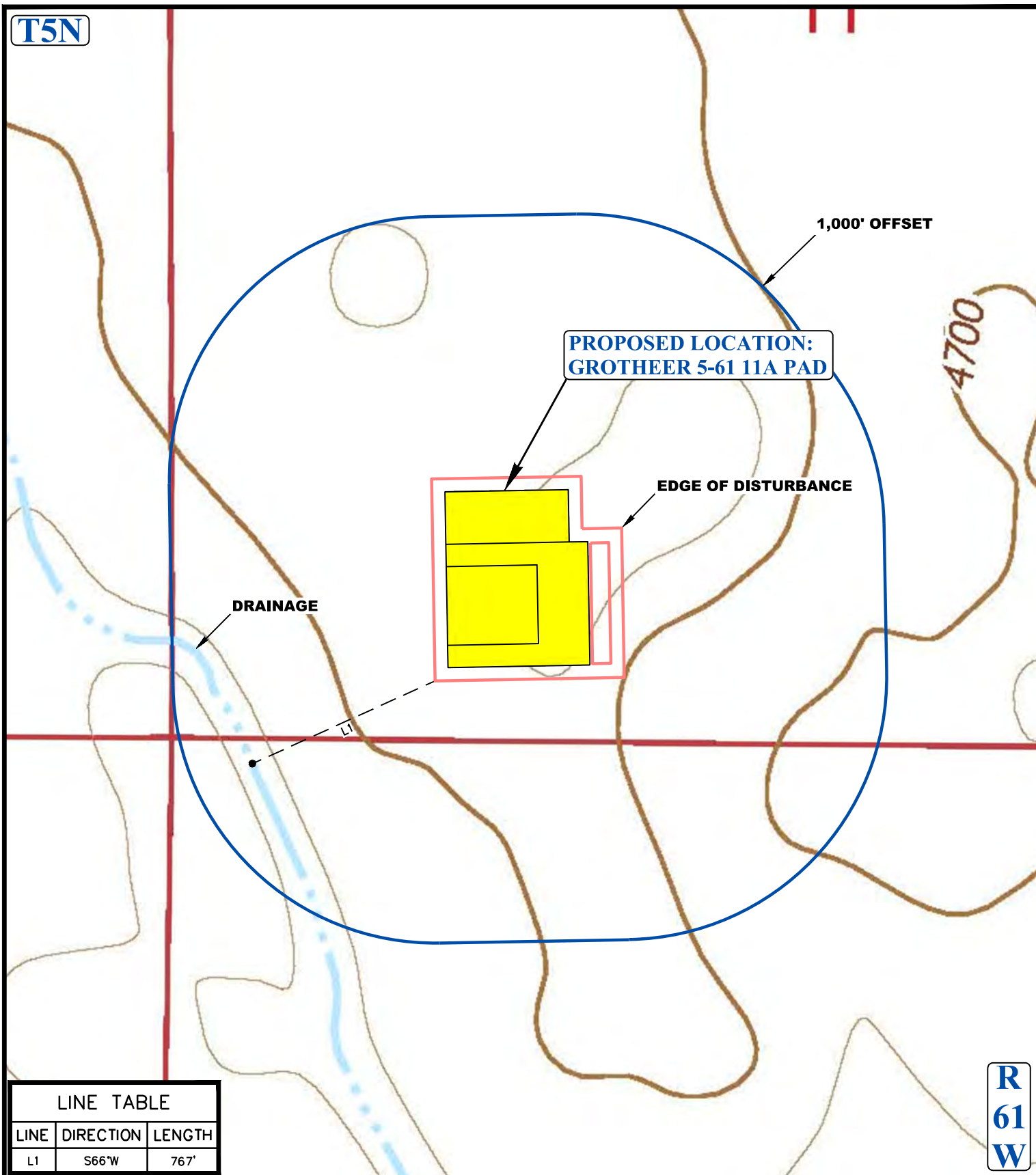

LINE TABLE

LINE	DIRECTION	LENGTH
L1	S66°W	767'

LEGEND:

- EXISTING DRAINAGE
- 1000' OFFSET BOUNDARY
- EDGE OF DISTURBANCE



UELS, LLC
Corporate Office * 85 South 200 East
Vernal, UT 84078 * (435) 789-1017



BISON OIL & GAS II

GROTHEER 5-61 11A PAD
SECTION 11, T5N, R61W, 6th P.M.
WELD COUNTY, COLORADO

SURVEYED BY	A.S., C.M.	02-18-19	SCALE
DRAWN BY	J.L.G.	02-20-19	1 : 6,000
HYDROLOGY MAP			TOPO W